

4941 ALLISON ST., ARVADA, COLORADO 80002
UNITS 13 | 2,870SF



DIRECT LEASE OR SUBLEASE



INDUSTRIAL SPACE WITH GREAT I-70 VISIBILITY AND ACCESS FOR LEASE

Great access to Wadsworth and Kipling and within walking distance of convenient services including restaurants and retail shopping.



PROPERTY FEATURES

- Flexible building design allows for variety of industrial/flex tenants with abundant parking for easy access of staff and clients.
- Zoning: I-1 (Light Industrial)
- Construction Type: Steel frame, reinforced concrete, twin and triple tee panels
- Year Built: 1979 and 1983
- Clear Heights: 15 - 16'
- Parking Ratio: 2 per 1,000

FOR MORE INFORMATION CONTACT:

MELISSA SHEILS | 303.408.1542 | msheils@berkeleypartners.com

berkeleypartners.com

UNIT 4941, 13

2,870 SF AVAILABLE

UNIT FEATURES

- Office Space: 1,673 SF
- Warehouse Space: 1,197 SF
- Clear Height: 15' - 15'9"
- Loading: 1 Drive-in (10' x 12')
- Power: 200 Amp, 120/208v, 3 phase (to be verified)
- Sublease expires August 2026

FLOOR PLAN

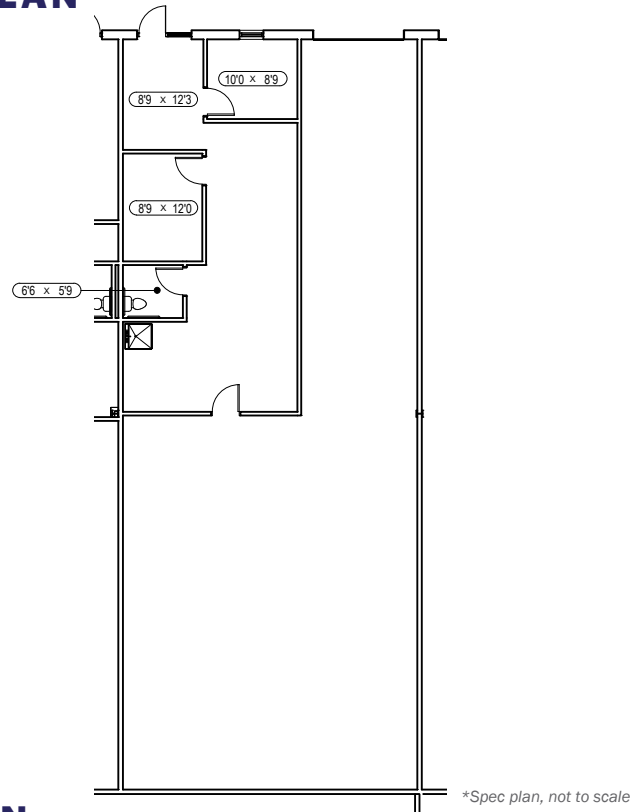

SITE PLAN

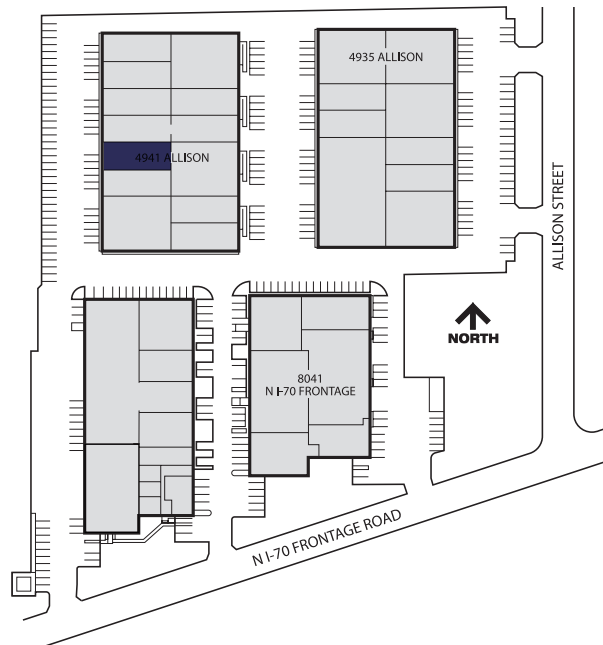

FOR MORE INFORMATION CONTACT:

MELISSA SHEILS
303.408.1542
msheils@berkeleypartners.com

4941 ALLISON ST., ARVADA, COLORADO 80002
UNITS 13 | 2,870 SF



© 2025 Berkeley Partners. This information has been obtained from sources believed reliable. We have not verified it and make no guarantee, warranty or representation about it. Any projections, opinions, assumptions or estimates used are for example only and do not represent the current or future performance of the property. You and your advisors should conduct a careful, independent investigation of the property to determine to your satisfaction the suitability of the property for your needs. Photos herein are the property of their respective owners and use of these images without the express written consent of the owner is prohibited.

berkeleypartners.com