

FOR LEASE: RETAIL SPACE

CREEKWOOD COMMONS

NE ENGLEWOOD ROAD
& N OAK TRAFFICWAY
KANSAS CITY, MO

PEAK

Real Estate Partners



PEAK

Real Estate Partners

PEAK REAL ESTATE PARTNERS

8700 State Line Road, Suite 300
Leawood, KS 66206

(913) 214-6445

www.peakrealestatepartners.com

KIMBERLY TRANBARGER

Partner

(913) 406-8875

kimberly@peakrep.com

PROPERTY HIGHLIGHTS

CREEKWOOD COMMONS

- **AVAILABLE:**
 - **0.5 ACRES AVAILABLE FOR GROUND LEASE**
- Anchored by a high volume Price Chopper grocery store and Rush Funplex amusement center.
- Densely populated surrounding neighborhoods with 77,426 people in a 3-mile radius.
- Convenient access to I-29, Highway 169 and I-35.
- Excellent mix of national and local tenants.
- Join Wingstop, Pet Supplies Plus, Tropical Smoothie Café, T-Mobile, Chipotle, Panera, Hallmark Cards, Great Clips, GameStop, Anytime Fitness & 54th Street Grill & Bar.
- Ground lease opportunity on a small pad in front of the center.



DEMOGRAPHICS	1-MILE	3-MILE	5-MILE
POPULATION	10,018	77,757	161,300
DAYTIME POPULATION	5,569	39,075	103,820
AVERAGE HOUSEHOLD INCOME	\$96,153	\$100,985	\$103,735
MEDIAN HOUSEHOLD INCOME	\$65,162	\$74,992	\$81,191
NUMBER OF HOUSEHOLDS	4,517	33,526	69,718

AERIAL & AMENITIES

CREEKWOOD COMMONS

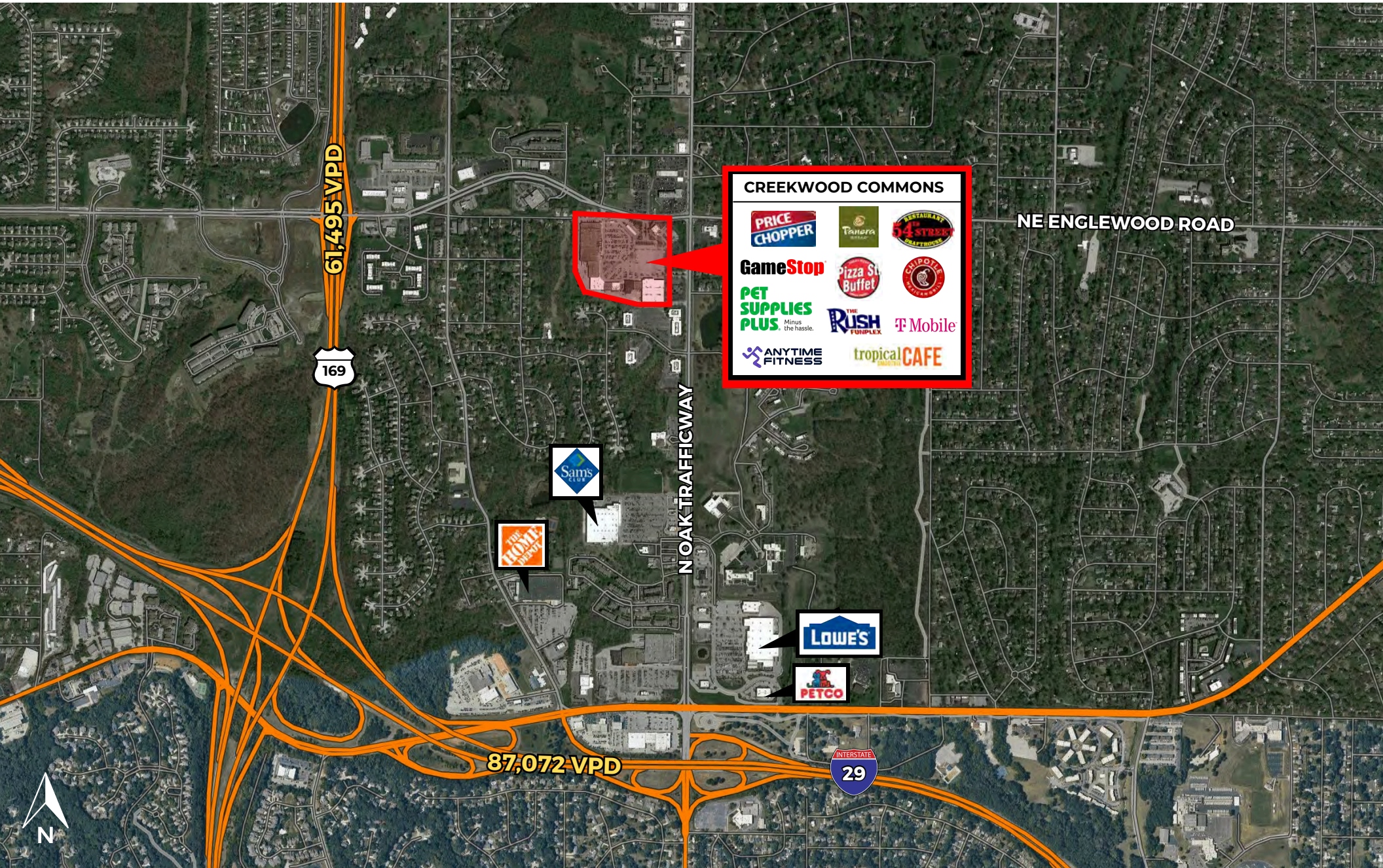

SITE PLAN

CREEKWOOD COMMONS



SITE
CREEKWOOD
COMMONS



20,805 VPD

NE ENGLEWOOD ROAD

12,521 VPD

NOAK TRAFFICWAY



SITE PLAN

CREEKWOOD COMMONS



UNIT	TENANT	SF
203A	H&R Block	2,569
203D	Soho Nails	1,463
203H-B	Wingstop	1,750
203H	Tropical Smoothie Cafe	1,750
203I	Chipotle	2,853
207	Price Chopper	77,000
215	Aaron's	8,775
215B	GameStop	2,400
215C	Great Clips	1,200
215D	Dragonfly Tea Zone	1,676
215E	Capital Beauty Supply	3,407
301B	Anytime Fitness	6,575
303	Diagnostic Imaging	10,925
303A	Amy's Hallmark	4,951
303E	T-Mobile	2,040
303F/303G	54th Street Bar & Grill	5,139
305	Pet Supplies Plus	7,200
305A	District Fish + Pasta House	2,119
307A	The Tutoring Center	1,135
307B	Pizza Street	5,290
309	The Rush Funplex	55,695

PROPERTY PHOTOS

CREEKWOOD COMMONS

