



# FOR LEASE

**2700-2772 82nd Street East  
Bloomington, MN 55425**



## Features

- Great access to major thoroughfares and Minneapolis/St. Paul International Airport
- Near numerous area amenities including restaurants, retail services, banks, hotels, and Mall of America
- Abundant parking (6.5 per 1,000 SF)
- Ribbon glass line
- Single-story flex office/warehouse space
- 82nd Ave lightrail station located directly across the street
- Walking distance to the Mall of America



## Space & Building Specifications

<b>Size:</b>	Suite 2700 - 6,129 SF (office & warehouse) Suite 2708 - 744 SF (warehouse only) Suite 2740 - 9,222 SF (office only)
<b>Clear Height:</b>	14'
<b>Building Size:</b>	31,085 SF
<b>Parking Ratio:</b>	6.5/1,000 SF
<b>Net Lease Rate:</b>	Office: \$11.00-\$13.00/SF Warehouse: \$5.50-\$6.00/SF
<b>2025 Estimated Tax/CAM:</b>	\$7.30/SF
<b>Year Built:</b>	1985
	*Sewer and water included.



**TaTonka Real Estate Advisors**  
150 South 5th St., #1400  
Minneapolis, MN 55402  
www.TaTonkaRE.com

**Tim Stewart**  
612.466.7304  
tcs@tatonkare.com

**Brad Mateer**  
612.466.7313  
bmateer@tatonkare.com

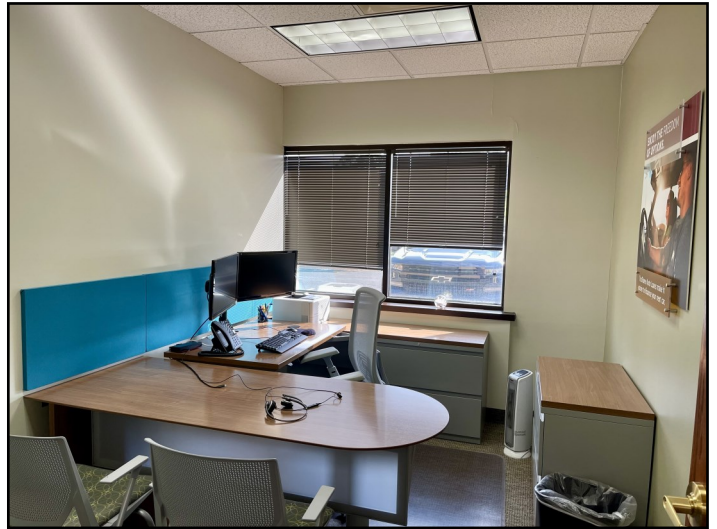

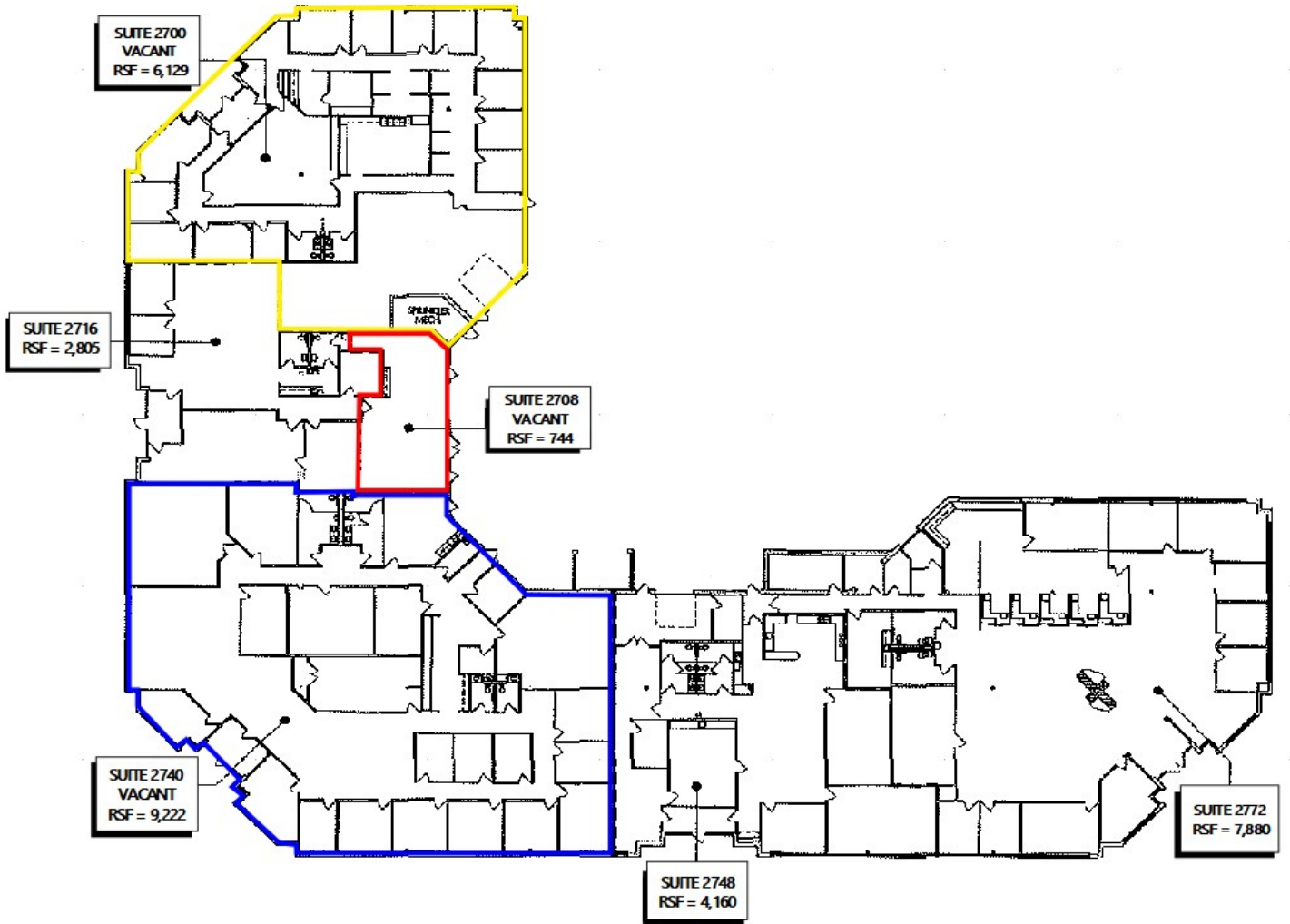

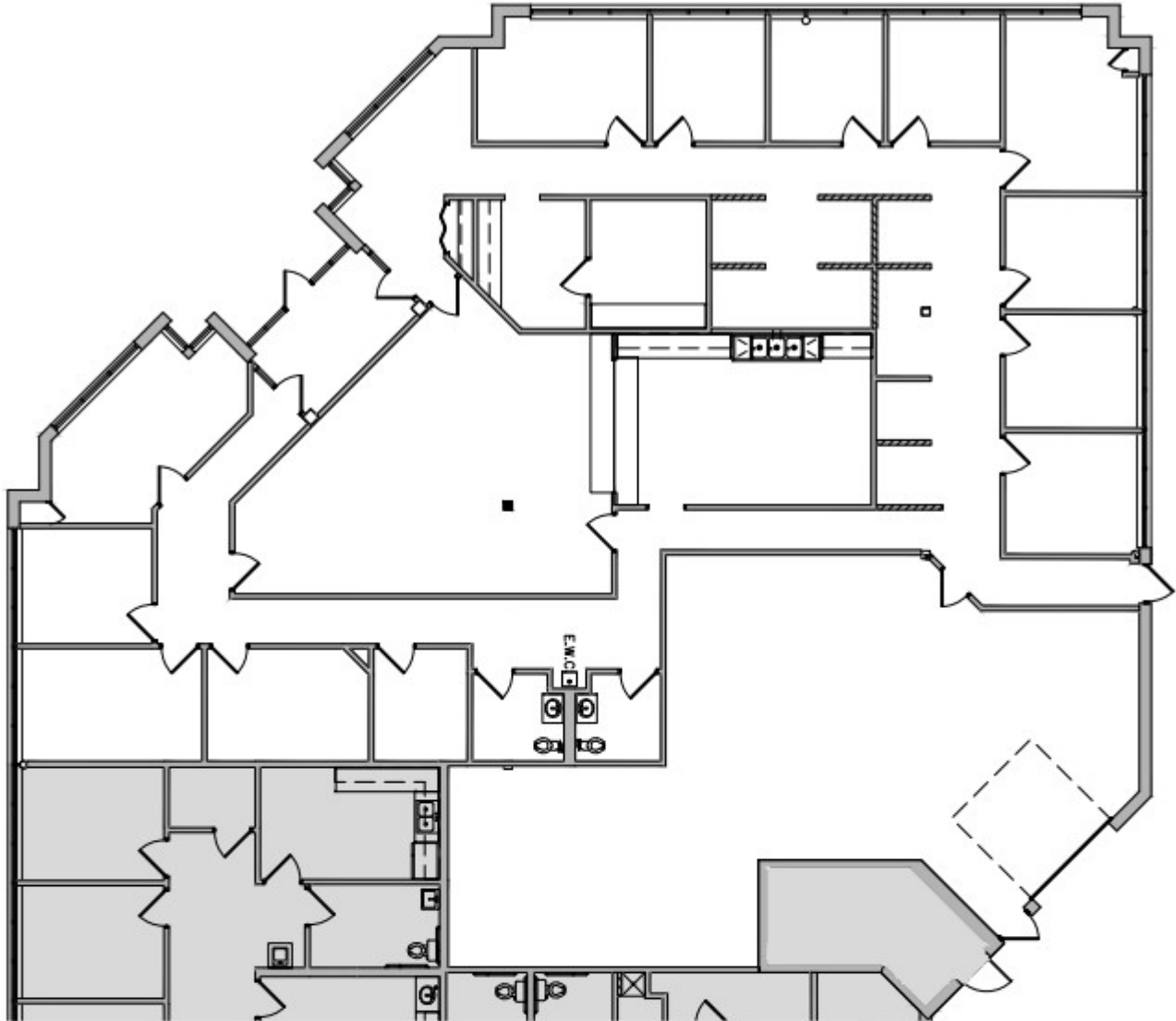

SUITE 2700	
OFFICE:	4,689 SF
WAREHOUSE:	1,440 SF
TOTAL:	6,129 SF

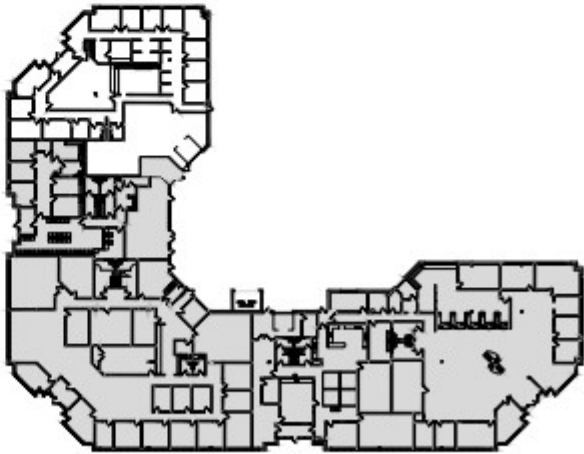

**SUITE 2700**  
BLOOMINGTON, MN  
APRIL 19, 2023

**ALPHA OFFICE TECH BUILDING**



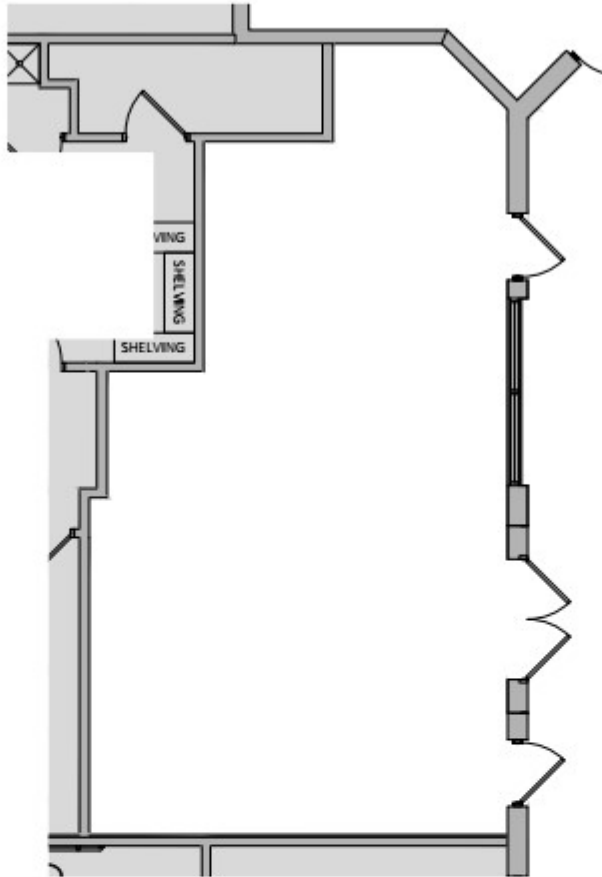

<u>SUITE 2708</u>	
WAREHOUSE:	744 SF
TOTAL:	744 SF



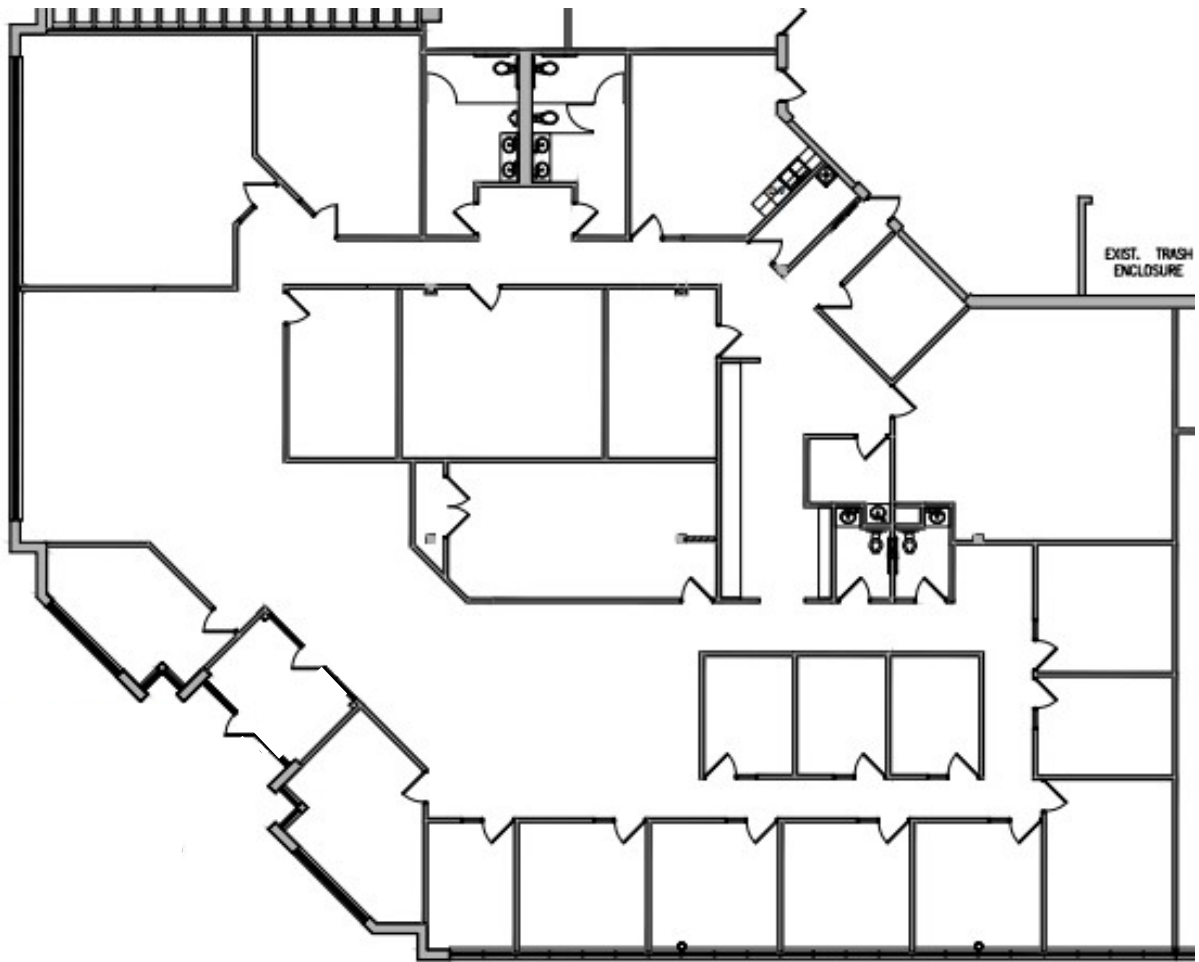

<u>SUITE 2740</u>	
<u>OFFICE:</u>	<u>9,222 SF</u>
<u>TOTAL:</u>	<u>9,222 SF</u>

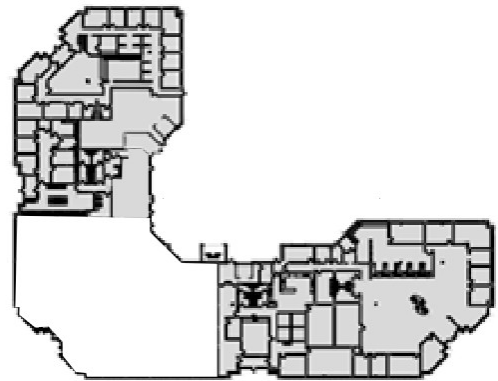



## Location Facts & Demographics

Demographics are determined by a 10 minute drive from 2700-2780 E 82nd St, Bloomington, MN 55425

CITY, STATE	<b>Bloomington, MN</b>
POPULATION	<b>86,150</b>
AVG. HH SIZE	<b>2.38</b>
MEDIAN HH INCOME	<b>\$59,692</b>
HOME OWNERSHIP	
Renters:	<b>13,936</b>
Owners:	<b>21,865</b>

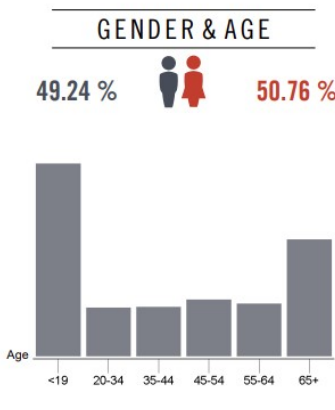
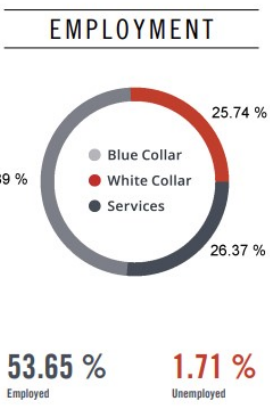

### RACE & ETHNICITY

White:	<b>36.20 %</b>
Asian:	<b>4.58 %</b>
Native American:	<b>0.36 %</b>
Pacific Islanders:	<b>0.00 %</b>
African-American:	<b>15.32 %</b>
Hispanic:	<b>23.42 %</b>
Two or More Races:	<b>20.12 %</b>

### EDUCATION

High School Grad:	<b>25.92 %</b>
Some College:	<b>24.90 %</b>
Associates:	<b>7.68 %</b>
Bachelors:	<b>32.33 %</b>

## Catylist Research

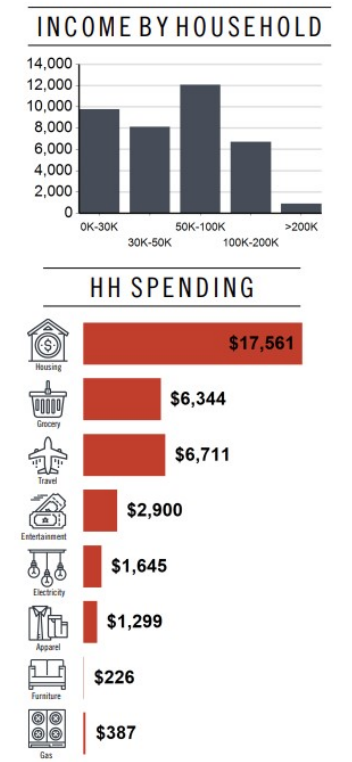

This information supplied herein is from sources we deem reliable. It is provided without any representation, warranty or guarantee, expressed or implied as to its accuracy. Prospective Buyer or Tenant should conduct an independent investigation and verification of all matters deemed to be material, including, but not limited to, statements of income and expenses. Consult your attorney, accountant, or other professional advisor.