

FOR SUBLEASE

# 425 VIGER WEST



CBRE

WELCOME TO

425 VIGER WEST



## AVAILABLE FOR IMMEDIATE OCCUPANCY

- + Private entrance available at tenant's option
  - + Partially furnished with high end modern equipment
  - + Prominent building signage opportunity (conditions apply)
  - + Food services in the building including recently opened Neotokyo Isakaya along with 2 new bar and restaurant offerings opening soon!
  - + Close proximity to many of the finest dining establishments the city has to offer
  - + Ample parking available in immediate vicinity
  - + Directly on the Montreal bike path with private tenant bike room and showers
  - + 3-minute walk to Square-Victoria metro station entrance and access to future REM station.
- + Newly redeveloped Trophy-class loft-style office building
  - + BOMA Gold Certification and brand new high performance systems
  - + 24-hour on-site security

# TYPICAL FLOOR PLATE

## Sublease Deal Terms

<b>Terms</b>	6 years & 8 months
<b>Lease expiry</b>	October 31 <sup>st</sup> , 2030
<b>Net Rent</b>	Contact agent
<b>Additional Rent</b> Hydro sub-metered	\$23.73/SF (2024 est.)

## Availabilities

<b>Suite 100 (1<sup>st</sup> floor)</b>	21,430 sq. ft
Suite 200 (2 <sup>nd</sup> floor)	Leased
<b>Leasing total</b>	<b>21,430</b> sq. ft.

Suite 100

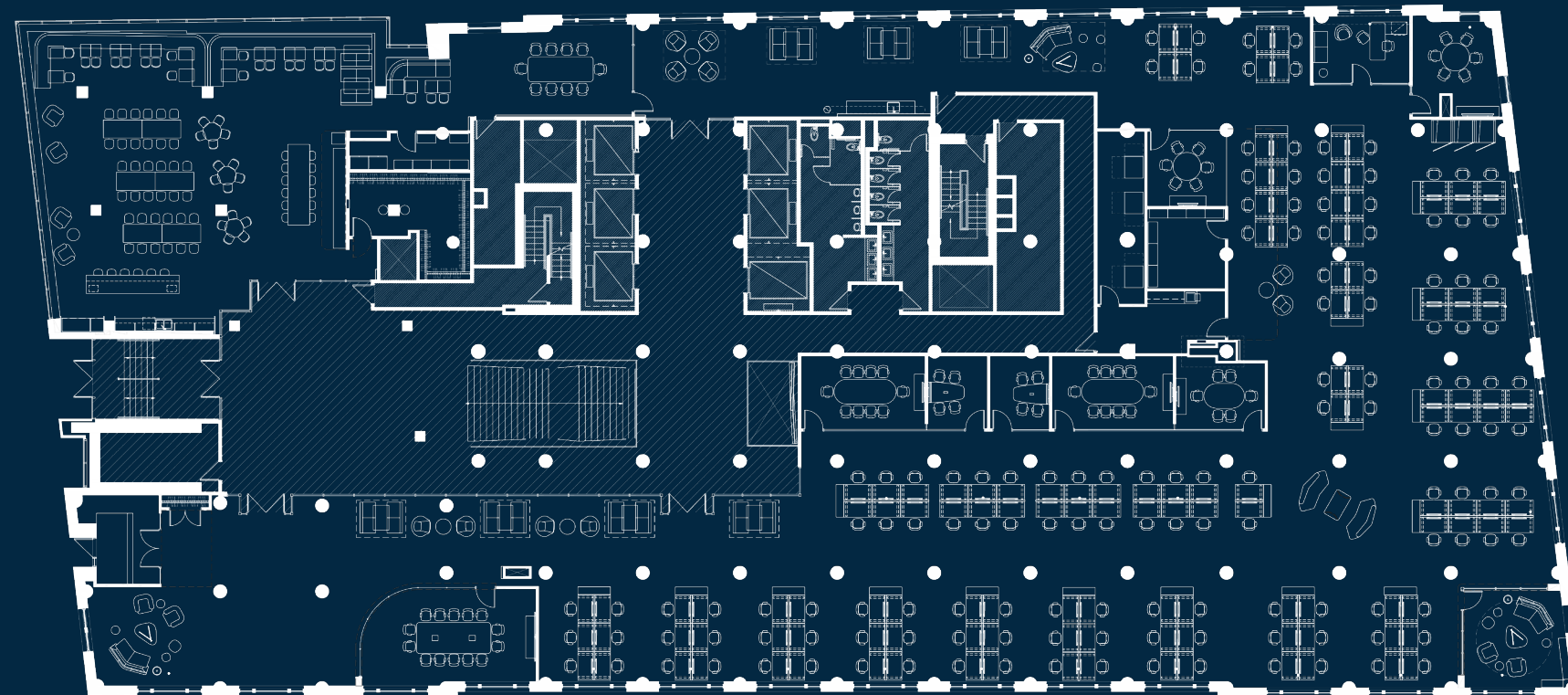



## Contact Us

**David Cervantes**  
Executive Vice President  
+1 514 906 1056  
david.cervantes@cbre.com  
Real Estate Broker

**Christopher Rundle**  
Vice President  
+1 514 375 0818  
christopher.rundle@cbre.com  
Real Estate Broker

**Erica Deschênes**  
Vice President  
+1 514 375 0238  
erica.deschenes@cbre.com  
Real Estate Broker

**Nari Aznavour**  
Associate Vice President  
+1 514 849 3298  
nari.aznavour@cbre.com  
Commercial Real Estate Broker

\* Real Estate Broker carrying out his activities with the business corporation David Garcia-Cervantes Real Estate Brokerage Inc.

**CBRE Limited, Real Estate Agency**  
1250 René-Lévesque Boulevard West, Suite 2800, Montréal, Québec H3B 4W8 T +1 514 849 6000 | www.cbre.ca

This disclaimer shall apply to CBRE Limited, Real Estate Agency, and to all other divisions of the Corporation, to include all employees and independent contractors ("CBRE"). The information set out herein, including, without limitation, any projections, images, opinions, assumptions and estimates obtained from third parties (the "Information") has not been verified by CBRE, and CBRE does not represent, warrant or guarantee the accuracy, correctness and completeness of the Information. CBRE does not accept or assume any responsibility or liability, direct or consequential, for the Information or the recipient's reliance upon the Information. The recipient of the Information should take such steps as the recipient may deem necessary to verify the Information prior to placing any reliance upon the Information. The Information may change and any property described in the Information may be withdrawn from the market at any time without notice or obligation to the recipient from CBRE. CBRE and the CBRE logo are the service marks of CBRE Limited and/or its affiliated or related companies in other countries. All other marks displayed on this document are the property of their respective owners. All Rights Reserved. Mapping Sources: Canadian Mapping Services canadamapping@cbre.com; DMTI Spatial, Environics Analytics, Microsoft Bing, Google Earth.

**CBRE**