



FOR LEASE

5400A NE ANTIOCH ROAD, KANSAS CITY, MO

ANTIOCH ANNEX SHOPPING CENTER



GROUND LEASE • ATM PAD SITES



6,258 sq ft
\$1,550 per month

Tenant Responsible for Utilities

Broker Incentive of 5%



Dan Sweeney • 816-414-5226 • dsweeney@curryre.com
2700 Kendallwood Pkwy., Gladstone, MO 64119
www.curryre.com



5400A NE ANTIOCH ROAD, KANSAS CITY, MO

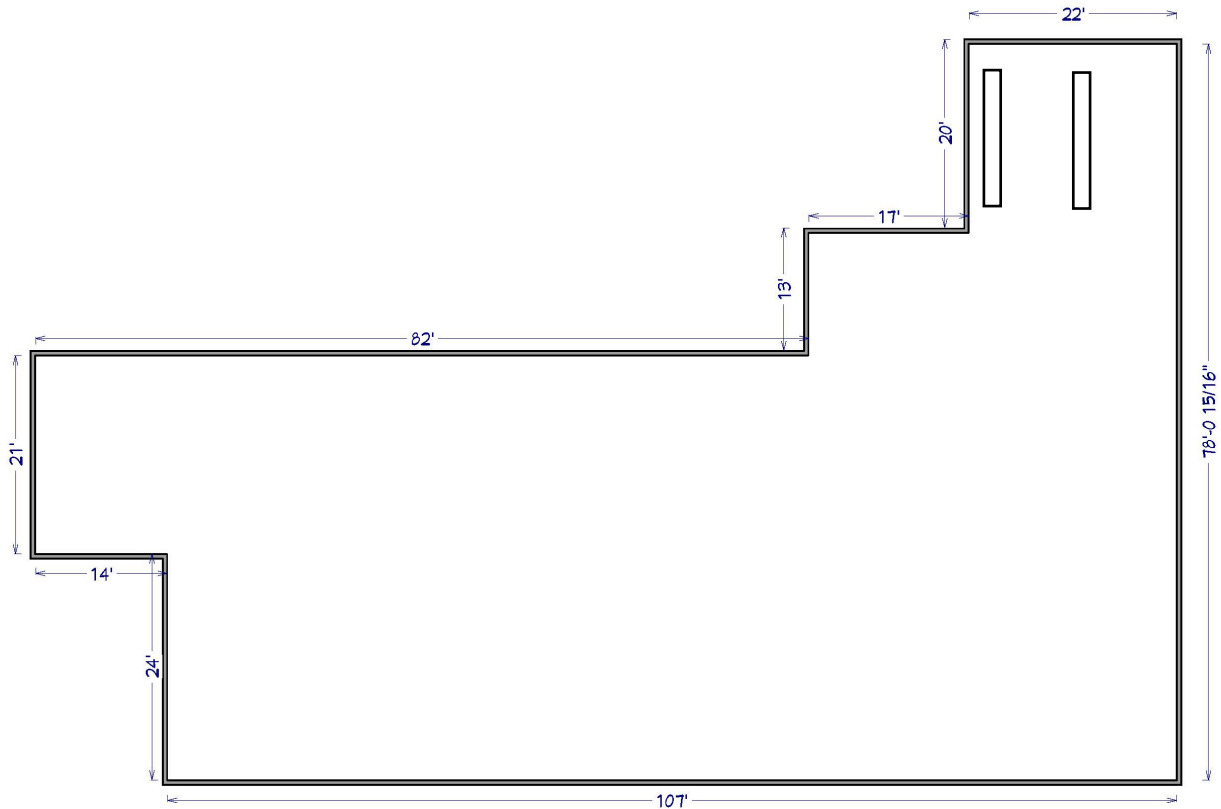

Household Income (Avg.)



1-mile: \$74,965
 3-mile: \$78,387
 5-mile: \$83,345

Total Population



1-mile: 10,954
 3-mile: 83,475
 5-mile: 148,910

Median Home Value



1-mile: \$166,973
 3-mile: \$179,936
 5-mile: \$199,621

Developments are bringing new resources and amenities to the area. Projects include mixed-use developments with retail, senior housing and office spaces, enhancing the overall appeal and functionality of the neighborhood.

Property Highlights

- Located directly West of Antioch Crossing where the Walmart Neighborhood Market is anchored.
- Excellent location near two interstates (I-29 & I-35).
- Northland trade area has over 180,000 people in close proximity to the shopping center.
- Traffic counts in excess of 38,000 (Antioch & Vivion Road).
- Strong, stable demographics - Proven.



5400A NE ANTIOCH ROAD, KANSAS CITY, MO

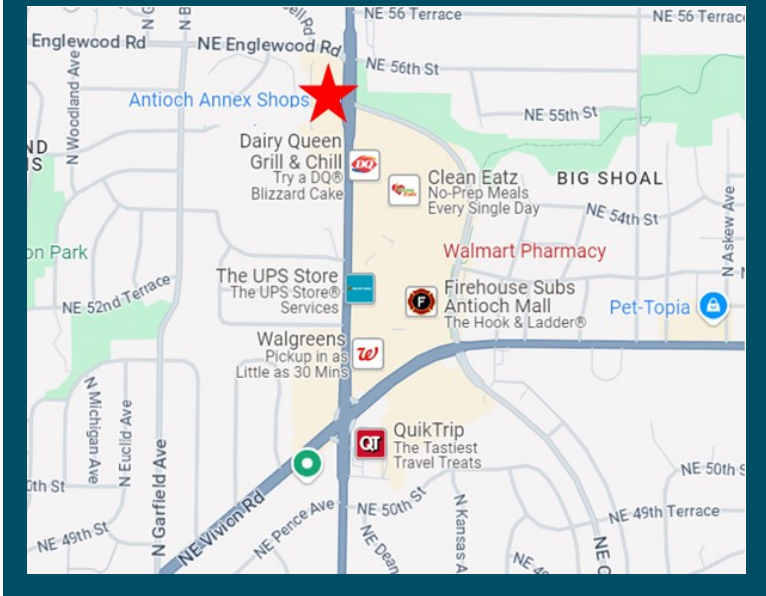

Increased Foot Traffic:
Shopping centers naturally attract a steady stream of visitors, which can lead to more potential customers discovering your business.

Community Support:
Locating your business in a shopping center can foster a sense of community, as local shoppers often prefer to support nearby businesses.

Economic Boost:
Small businesses contribute significantly to the local economy by creating jobs and increasing property values.

Networking Opportunities:
Being in a shopping center allows you to connect with other business owners.

Current Tenants

2,940 sf
Godfathers Pizza
ARC Physical Therapy
Red Wing Shoes
Antioch Bar & Grill
Level Up
Animal Clinic
Dental Office
Sherwin Williams
Big Biscuit
Elwood Staffing
True Balance
American Hear
Penmac NKC
JiuJitsu
Fantastic Sam's
DOLLAR TREE
Democrats
Twisted Scissor
Duck Donuts

All information furnished regarding property for sale or lease is from sources deemed reliable, but no warranty or representation is made as to the accuracy thereof and the same is subject to errors, omissions, changes of prices, rental or other conditions, prior sale or lease or withdrawal without notice.



CURRY
Real Estate Services

Dan Sweeney • 816-414-5226 • dsweeney@curryre.com
2700 Kendallwood Pkwy., Gladstone, MO 64119
www.curryre.com