

MULTI-TENANT BUSINESS PARK IN OAKBROOK AREA OF SUMMERVILLE

FOR LEASE

1,161 SF OFFICE/MEDICAL SUITE

\$15.00/SF NNN

301 OAKBROOK LN., STE. 355



RE/MAX SOUTHERN SHORES
Robert Pratt, CCIM, SIOR
(843) 343-6085:cell
robert@robertpratt.com

RE/MAX
COMMERCIAL®

301 OAKBROOK LN., STE. 355

| SUMMERVILLE |

SOUTH CAROLINA



- **Approximately 1,161sf office/medical suite in multi-tenant business park**
- **Suite offers large reception area, 4 private offices, 2 bathrooms and small kitchenette**
- **Ample parking that is shared with the business park tenants**
- **Tenant responsible for monthly base rent of \$15.00/sf plus NNN fee currently estimated at \$1.10/sf. NNN includes CAM, water and sewer. Total monthly rent is \$1,557.68.**
- **Zoned R-4 in Dorchester County**
- **Excellent location near the corner of Dorchester Rd. and Old Trolley Rd. and in close proximity to Summerville Medical Center**

RE/MAX SOUTHERN SHORES
Robert Pratt, CCIM, SIOR
(843) 343-6085:cell
robert@robertpratt.com





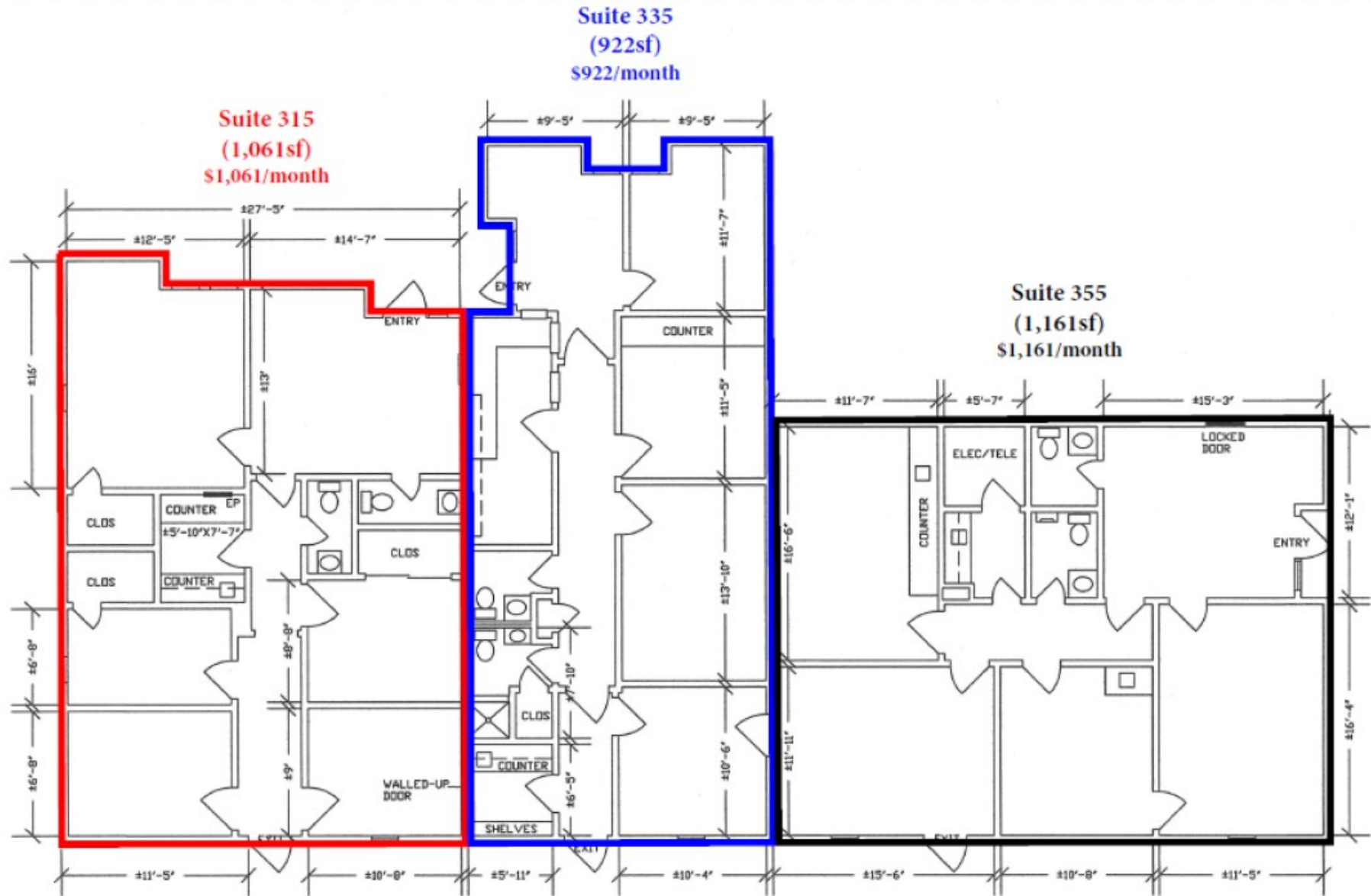



301 OAKBROOK LN., STE. 355

| SUMMERVILLE |

SOUTH CAROLINA