

# PREMIER OFFICE SPACE FOR LEASE

# THE QUINN BUILDING



911 Main Street | Vancouver, WA 98660

**WHOLE FLOOR AVAILABLE NOW**  
 10,788 RSF (DEMISABLE TO 3,500 RSF)

W EVERGREEN BLVD

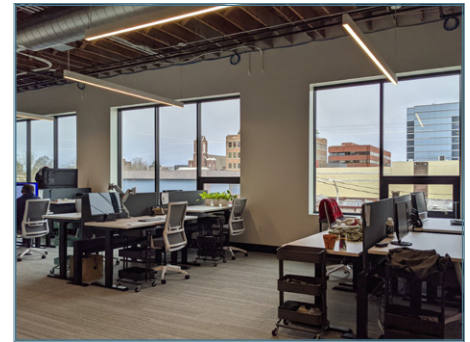
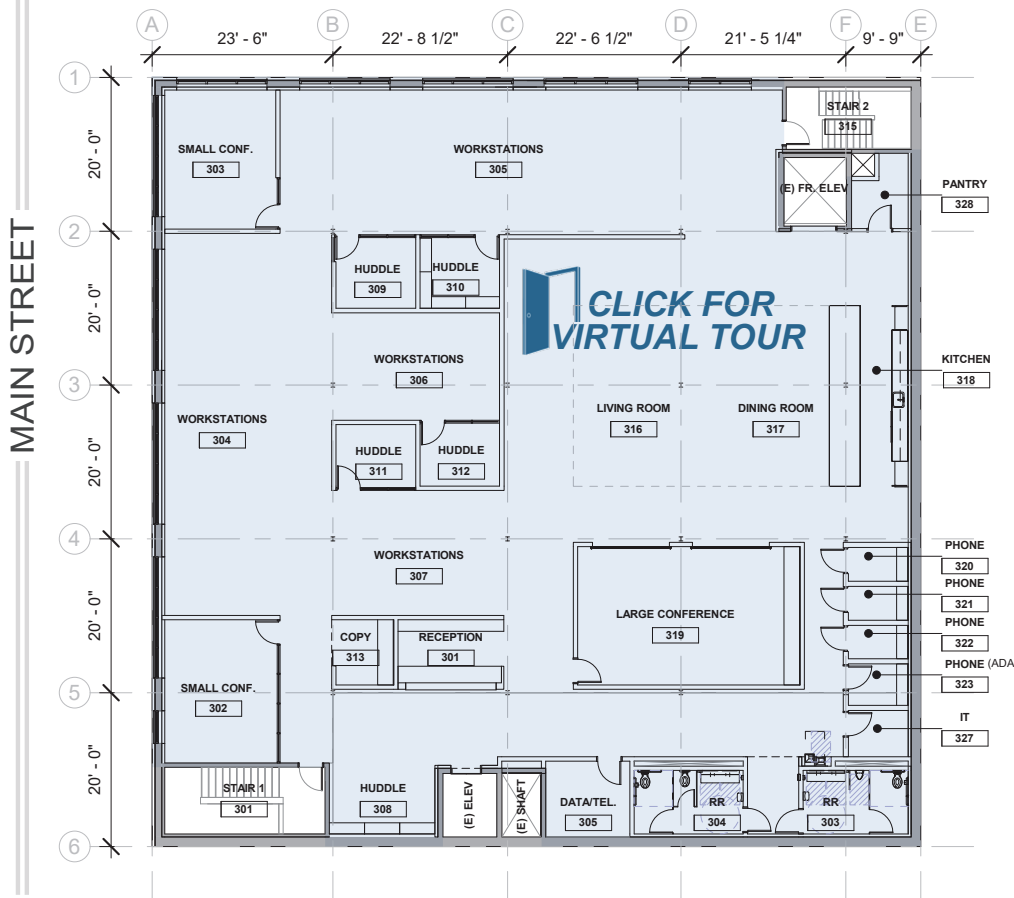

**Click to see Buildout**  
 Turnkey space with  
 all furniture included 



**CONTACT US** CAPACITY COMMERCIAL GROUP // 700 Washington, Suite 608 // Vancouver, WA 98660  
 360.946.4830 // info@capacitycommercial.com // www.capacitycommercial.com

**ERIC ANDERSON**  
*Vice President*

p. 360.946.4831  
 e. eric@capacitycommercial.com

**TAMARA J. FULLER, CCIM**  
*Senior Vice President*

p. 360.946.4832  
 e. tamara.fuller@capacitycommercial.com

**CHARLIE KLEIER, CCIM**  
*Senior Vice President*

p. 360.946.4829  
 e. charlie.kleier@capacitycommercial.com



The information contained herein is believed to be accurate but is not warranted as to its accuracy and may change or be updated without notice. Seller or Landlord makes no representation as to the environmental condition of the property and recommends purchaser's or tenant's independent investigation.