

# FOR LEASE

±3,000 SF Flex Building in Rock Hill, SC  
1190 Constitution Blvd.



# Executive Summary

1190 Constitution Blvd | Rock Hill, SC



## Property Highlights:

- **Building Size:** ±3,000 SF
  - **Warehouse Space:** ±2,800 SF
  - **Office Space:** ±200 SF
- 2 Drive-in doors (12'x12')
- Ceiling heights: ±12'
- Conveniently located between Cherry Road and Herlong Ave
- ±25 miles from Charlotte, NC

## Offering Summary

**Lease Info:** \$13/SF (NNN)

*Acreage, square footage, taxes, utilities, and lot dimensions to be verified by Agent or prospective Buyer/Tenant*



# Property Photos



# Floorplan

1190 Constitution Blvd | Rock Hill, SC

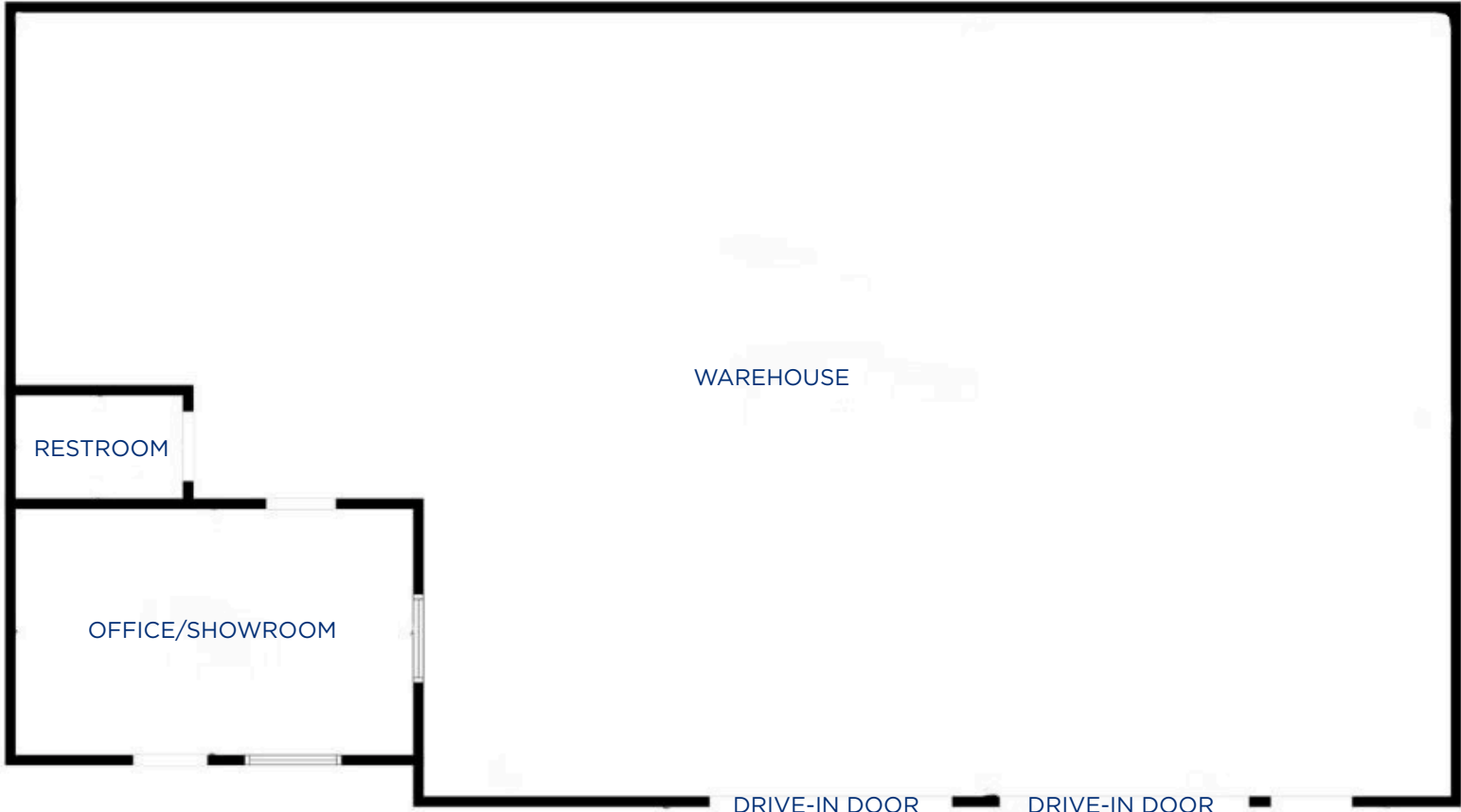

# Aerial View



# Location Map

Rock Hill, SC

REEDY

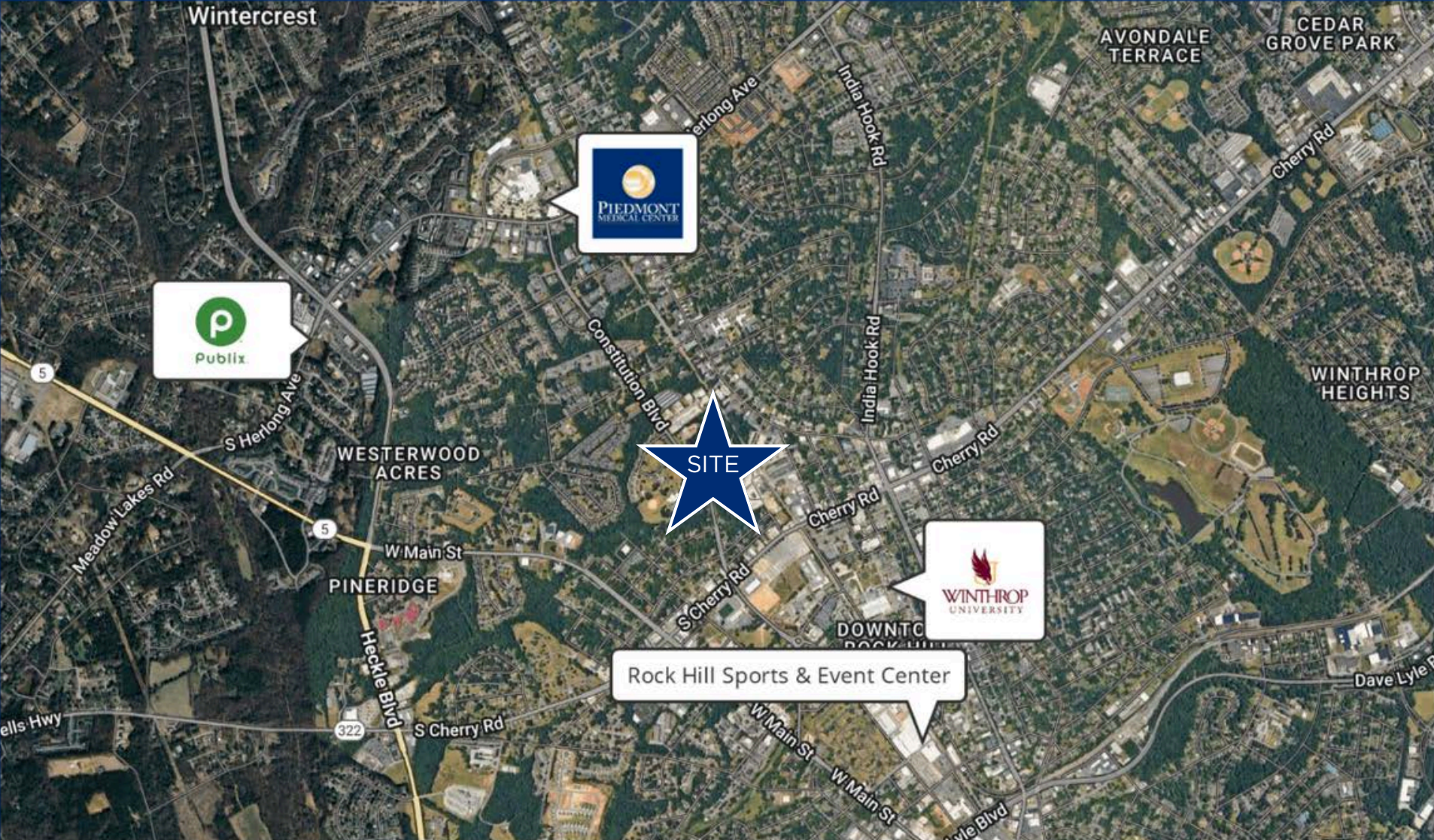

# Confidentiality & Disclaimer

Reedy Property Group



All materials and information received or derived from Reedy Property Group its directors, officers, agents, advisors, affiliates and/or any third party sources are provided without representation or warranty as to completeness, veracity, or accuracy, condition of the property, compliance or lack of compliance with applicable governmental requirements, developability or suitability, financial performance of the property, projected financial performance of the property for any party's intended use or any and all other matters.

Neither Reedy Property Group its directors, officers, agents, advisors, or affiliates makes any representation or warranty, express or implied, as to accuracy or completeness of the any materials or information provided, derived, or received. Materials and information from any source, whether written or verbal, that may be furnished for review are not a substitute for a party's active conduct of its own due diligence to determine these and other matters of significance to such party. Reedy Property Group will not investigate or verify any such matters or conduct due diligence for a party unless otherwise agreed in writing.

EACH PARTY SHALL CONDUCT ITS OWN INDEPENDENT INVESTIGATION AND DUE DILIGENCE.

Any party contemplating or under contract or in escrow for a transaction is urged to verify all information and to conduct their own inspections and investigations including through appropriate third party independent professionals selected by such party. All financial data should be verified by the party including by obtaining and reading applicable documents and reports and consulting appropriate independent professionals. Reedy Property Group makes no warranties and/or representations regarding the veracity, completeness, or relevance of any financial data or assumptions. Reedy Property Group does not serve as a financial advisor to any party regarding any proposed transaction. All data and assumptions regarding financial performance, including that used for financial modeling purposes, may differ from actual data or performance. Any estimates of market rents and/or projected rents that may be provided to a party do not necessarily mean that rents can be established at or increased to that level. Parties must evaluate any applicable contractual and governmental limitations as well as market conditions, vacancy factors and other issues in order to determine rents from or for the property.

Legal questions should be discussed by the party with an attorney. Tax questions should be discussed by the party with a certified public accountant or tax attorney. Title questions should be discussed by the party with a title officer or attorney. Questions regarding the condition of the property and whether the property complies with applicable governmental requirements should be discussed by the party with appropriate engineers, architects, contractors, other consultants and governmental agencies. All properties and services are marketed by Reedy Property Group in compliance with all applicable fair housing and equal opportunity laws.

# Contact Information

Reedy Property Group

## WE KNOW THE MARKET

### BECAUSE WE'RE INVESTED HERE TOO

At Reedy Commercial, we care about the why behind a commercial property as much as the what.

That's because we believe resilient communities, and portfolios that weather any market, start with people who have a vision beyond a quick profit.

Our network is as valuable as our net worth because this is our market, too.

We're invested in every asset class of commercial real estate right where our roots run deepest. That's how we uncover powerful investments in unexpected locations that yield incredible returns. It's why our clients trust us over the latest trends. And, it's what ignites our deepest passion - turning real estate investments into legacies.



**Chandler Ayers**

864-201-2221

cayers@reedypg.com



**Bennett Mahon**

864-683-7244

bmahon@reedypg.com

