

LAST UNIT  
REMAINING!

15495

15495 TAMAMI TRAIL N  
SHOPPES AT AUDUBON  
NAPLES, FL 34112

FOR LEASE

HIGH-END RETAIL

IDEAL SHOWROOM | GYM | PILATES

# AVAILABILITY: **800± SF**

SUITE	SIZE (SF)	LEASE RATE (PSF)	MONTHLY BASE RENT	CAM (PSF)	MONTHLY CAM	TOTAL MONTHLY RENT
103	800	\$35.00	\$2,333.33	\$7.25	\$483.33	\$2,816.67

LEASE RATE: **\$35.00 PSF NNN**

CAM: **\$7.25 PSF (2026 Est.)**

ZONING: **PUD**

YEAR BUILT: **2000**

## PROPERTY FEATURES

- High-end retail space ideal for showroom, fitness, Pilates, gym, physical therapy, wellness, and specialty retail uses
- Located at Shoppes at Audubon, a prime retail destination along US 41 (Tamiami Trail N) at the Collier / Lee County line
- 600± linear feet of frontage along US 41 (Tamiami Trail N) providing exceptional visibility and brand exposure
- Exposure to over 41,500 vehicles per day
- Ample surface parking with convenient ingress and egress



# LAYOUT

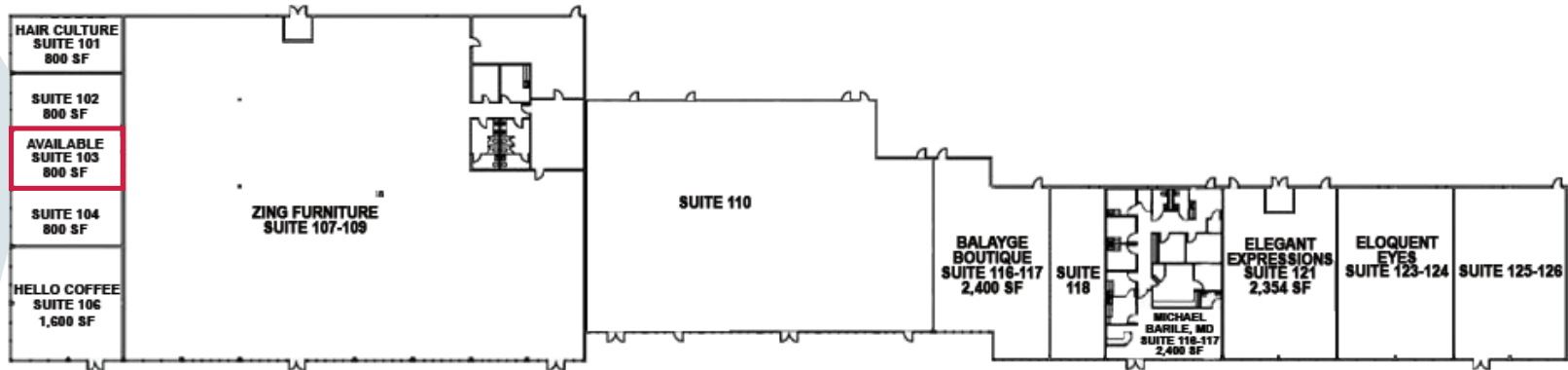
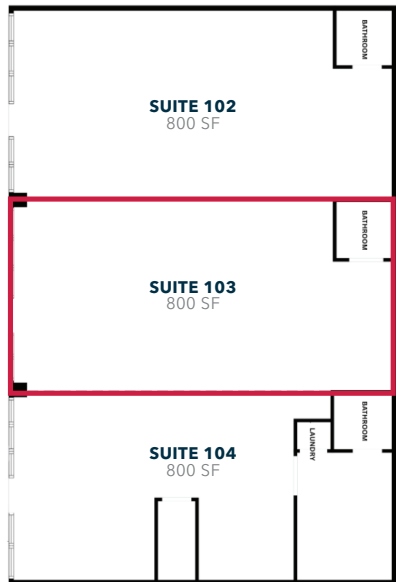



## LOCATION DEMOGRAPHICS

	1 MILE	3 MILES	5 MILES
2025 POPULATION	5,456	38,229	94,510
HOUSEHOLDS	3,061	18,922	45,870
MEDIAN HOUSEHOLD INCOME	\$94,616	\$96,413	\$102,339
AVG. HOUSEHOLD INCOME	\$153,396	\$160,354	\$160,588

## TRAFFIC COUNTS

VOLUME (AADT)	YEAR
41,500 (Tamiami Trail N - US 41)	2024
17,600 (Old US 41)	

# 15495 TAMAMI TRAIL N

## SHOPPES AT AUDUBON

### NAPLES, FL 34112

#### EXCLUSIVE LEASING AGENTS:

##### **BROCK RASMUSSEN**

Principal

**239.209.0458**

[brasmussen@lee-associates.com](mailto:brasmussen@lee-associates.com)

##### **GARY BARLOW**

Senior Vice President

**239.877.4980**

[gbarlow@lee-associates.com](mailto:gbarlow@lee-associates.com)

All information furnished regarding property for sale, rental or financing is from sources deemed reliable, but no warranty or representation is made to the accuracy thereof and same is submitted to errors, omissions, change of price, rental or other conditions prior to sale, lease or financing or withdrawal without notice. No liability of any kind is to be imposed on the broker herein.

06/22/26