

# RARE SOUTH ASHEVILLE ESTATE FARM ON ±80 ACRES

52 CHAPEL HILL CHURCH ROAD | ASHEVILLE, NC

SALE INFORMATION

**\$4,495,000**

**ASHEVILLE, NC - PRIVATE ESTATE FOR SALE**



52 Chapel Hill Church Road, Asheville, NC 28803

Set amid nearly 79 breathtaking acres in the heart of the Blue Ridge Mountains, this exceptional gated estate offers a rare combination of privacy, convenience to Asheville, natural beauty, and vintage Appalachian character.

Expansive open pastures, gently rolling topography, and sweeping mountain vistas provide an idyllic setting for a family retreat, equestrian property, or private legacy estate.

The property also includes an existing 3,600-square-foot mid-century home built in 1978, featuring a stacked-stone chimney and two wood-burning fireplaces. The striking floor-to-ceiling chimney showcases stacked stone harvested from the property, creating a seamless connection between the home's interior and exterior. Whether enjoyed as a residence, guest house, caretaker's quarters, or future renovation project, the home provides an established presence on the property while allowing the land itself to remain the defining feature.

Complementing the home is a classic Appalachian barn, enhancing the property's rich mountain heritage and functionality.

Offering an exceptional balance of privacy and accessibility, the estate is located just 18 minutes from Asheville Regional Airport, 20 minutes to Downtown Asheville, and 3.5 miles from the Blue Ridge Parkway. Large contiguous tracts with this combination of usable pastureland, mountain views, and proximity to Asheville are















52 Chapel Hill Church Rd, Asheville, NC

Main Floor Finished Area 2452.52 sq ft  
Unfinished Area 595.40 sq ft



PREPARED: 2026/05/20



White regions are excluded from total floor area in IGUIDE floor plans. All room dimensions and floor areas must be considered approximate and are subject to independent verification.

52 Chapel Hill Church Rd, Asheville, NC

2nd Floor Finished Area 655.96 sq ft



PREPARED: 2026/05/20



White regions are excluded from total floor area in IGUIDE floor plans. All room dimensions and floor areas must be considered approximate and are subject to independent verification.

52 Chapel Hill Church Rd, Asheville, NC

Basement (Below Grade) Unfinished Area 1850.51 sq ft

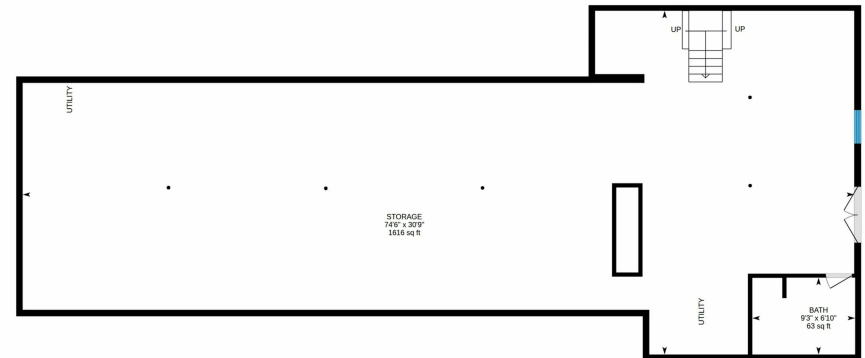

PREPARED: 2026/05/20

White regions are excluded from total floor area in IGUIDE floor plans. All room dimensions and floor areas must be considered approximate and are subject to independent verification.

Tim.Bramley@deweypa.com

NC #271946

Tim Bramley, CCIM, SIOR









LOCATION



Biltmore Forest Country Club



Blue Ridge Parkway



Asheville Racquet Club South

RACQUET CLUB VILLAGE



Royal Pines



# REGIONAL MAP

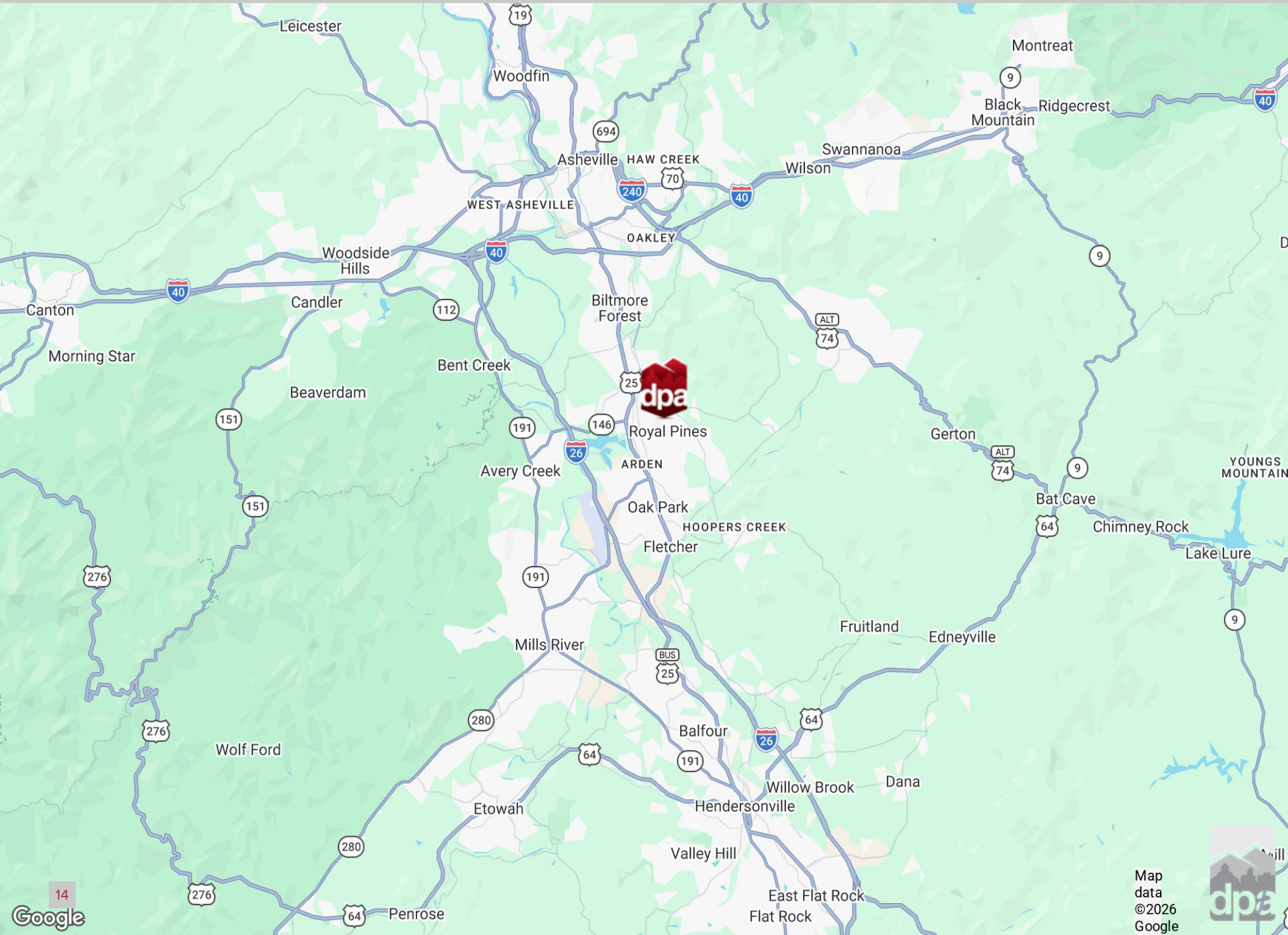



**Dewey**  
Property  
Advisors

Sale Contact:

Tim Bramley, CCIM, SIOR | NC #271946

[Tim.Bramley@deweypa.com](mailto:Tim.Bramley@deweypa.com)

**Dewey Property Advisors**

1 Page Avenue

Asheville, NC 28801

Office: 828.548.0090

Cell: 828.424.1141

[www.deweypa.com](http://www.deweypa.com)