

FOR SUBLEASE
5913 Executive Drive
Lansing, MI 48911

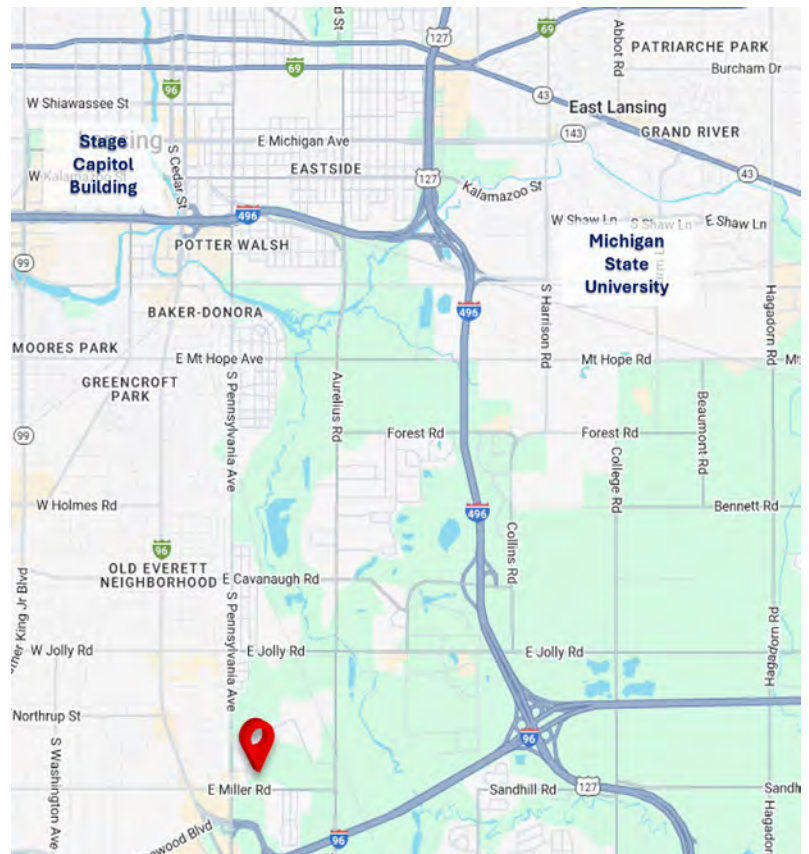

SPACE HIGHLIGHTS

- 16,000 SF on the first floor
- Parking: 3.44/1000 SF
- Some FF&E available
- Sublease through September 2028
- 1/2 mile from I-96
- 5 miles from Michigan State Capitol
- Rate: Negotiable



BRIAN PIERGENTILI, ESQ
Executive Managing Director
+1 248 358 6103
brian.piergentili@cushwake.com

FOR SUBLEASE

**5913 Executive Drive
Lansing, MI 48911**



PROPERTY INFORMATION

Address	5913 Executive Drive Lansing, MI 48911
Total Building Area	123,405 SF RBA
Available Area	16,000 SF on the first floor
Primary Use	Office
Property Class	A
Year Built	1989
Total Acreage	10
Auto Parking	3.44/1000 SF
Rent and Operating Expenses	Contact broker

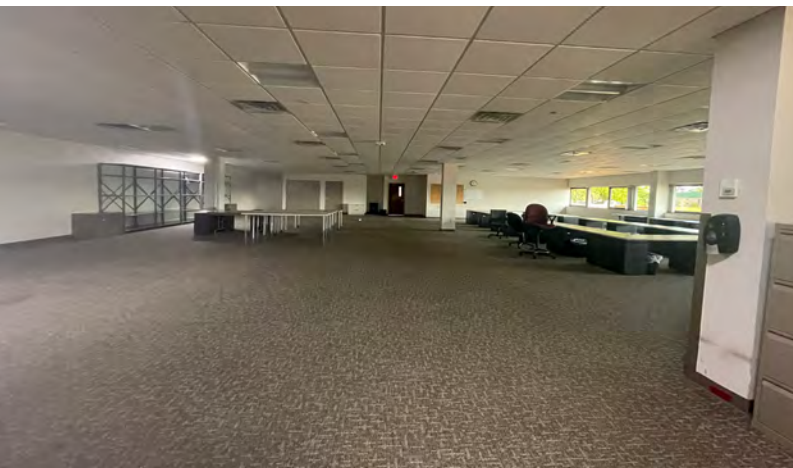

BRIAN PIERGENTILI, ESQ
Executive Managing Director
+1 248 358 6103
brian.piergentili@cushwake.com

FLOOR PLAN

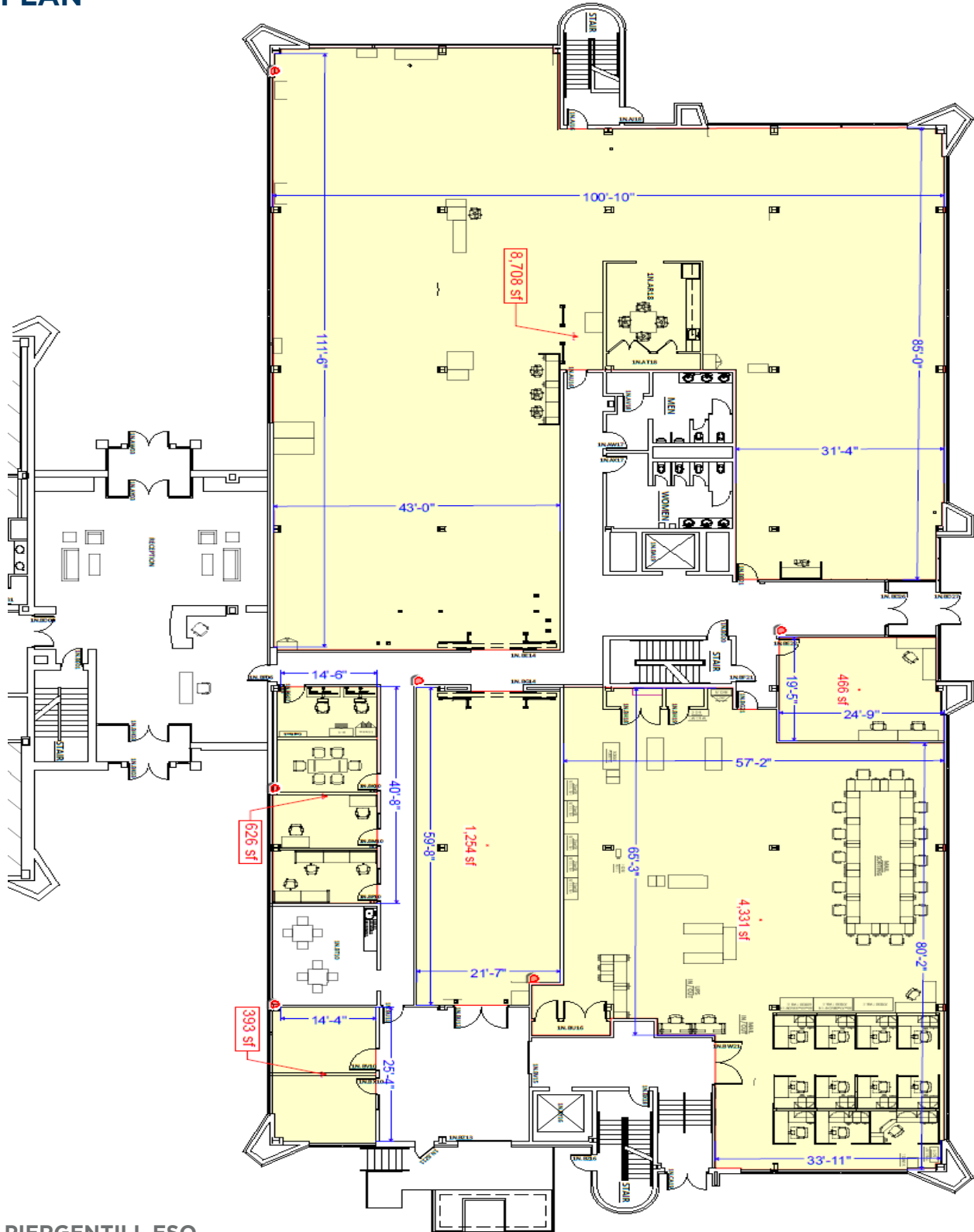

BRIAN PIERGENTILI, ESQ
Executive Managing Director
+1 248 358 6103
brian.piergentili@cushwake.com

SITE MAP

