

861 SF FORMER OPTICAL SPACE AVAILABLE FOR SUBLEASE IN CLASS A OPTUM BUILDING

5150 Journal Center Blvd NE ALBUQUERQUE, NM 87109





- 861 RSF Former Optical Space @ Main Building Entrance for Variety of Medical Related &/or Retail Uses Complementary to a Med Office Atmosphere
- Proposed Uses Include, Optical, Optometry, Audiology for Hearing Aids or Other Medical Consulting Services
- Steady Stream of Building Patients, Employees & Visitors to Serve
- Great Exposure Opportunity for a Business Looking for Med Office Exposure
- Located on Ground Floor of Optum's Multi-Specialty Medical Facility in Premier Journal Center Location
- Existing Sink, Podium and Open Area Allow Variety of Uses and Layouts
- Adjacent Open Seating "Cafeteria" Dining Area Not Included in Leasable Area
- Centrally Located Near Paseo Del Norte / Interstate 25 Interchange
- Non-abutting 1,177 SF Kitchen Space Also Available for Sublease
- Sublease Rate Negotiable Inquire with Agent

Contact:
Mark or Mariah Edwards



Leasing ♦ Brokerage ♦ Development

Executive West Bldg. 2929 Coors Blvd. NW Ste, #202
Albuquerque, NM 87120
505-998-7298 Cell 505-350-8211 505-228-2258 Fax 505-998-7299

Mark.Edwards@EdwardsCommercialRealty.com

Mariah@EdwardsCommercialRealty.com

This information was obtained from sources deemed reliable. No warranty is made by Edwards Commercial Realty, LLC as to the accuracy or completeness of this material. The pricing and sale/lease terms are subject to change

FLOORPLAN

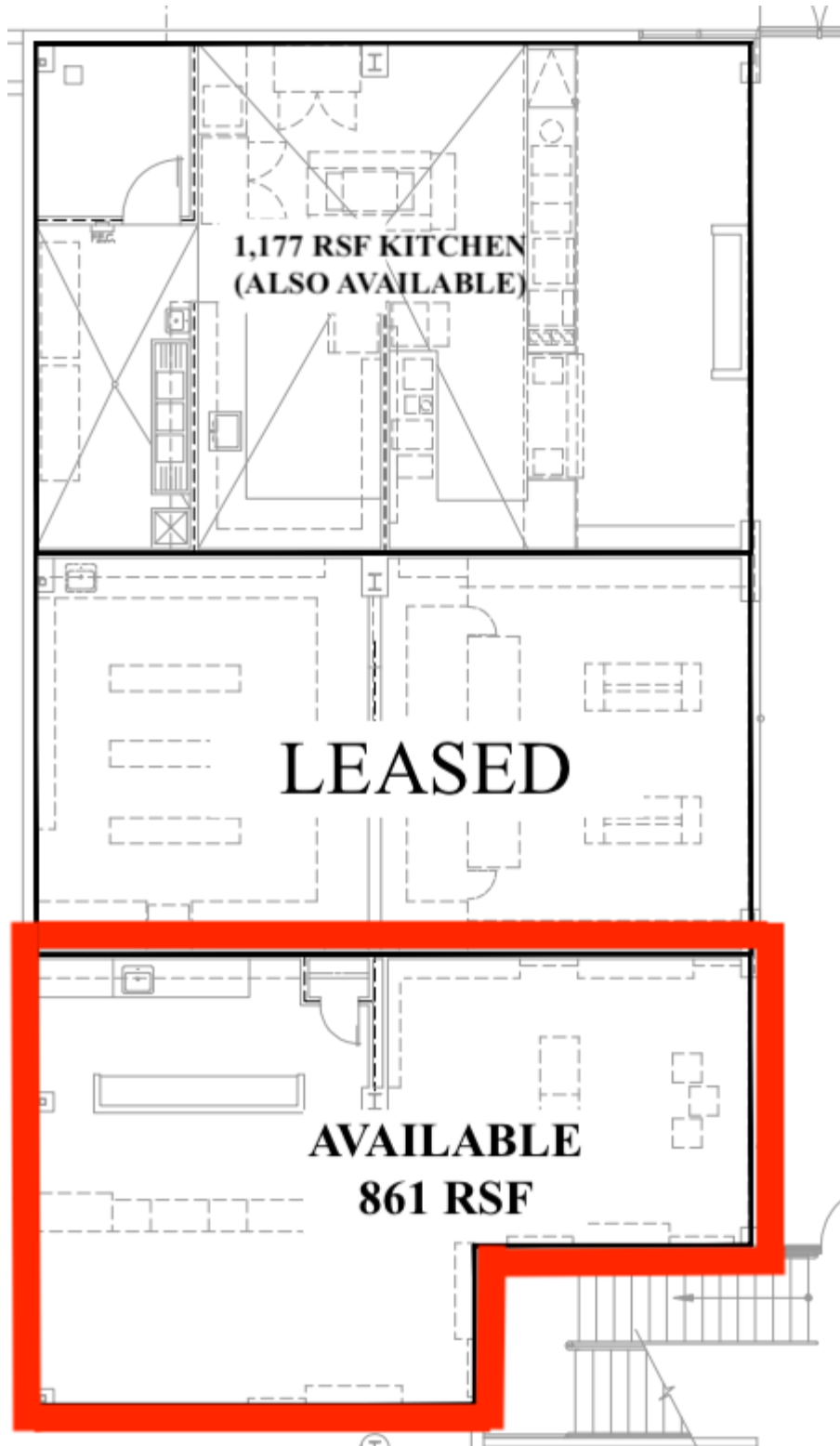

PIX

