



LACEY INDUSTRIAL CENTER

FOR LEASE

93,493 SF AVAILABLE | SUITE A

2621 HOGUM BAY ROAD
LACEY, WA 98516



**18 TRAILER
STALLS**

OR 34K SF YARD

3,107 SF

EXISTING OFFICE

1.5 MILES TO I-5

AT EXIT 111
ACCESSIBLE VIA
INTERCITY TRANSIT

26 DOCK DOORS

(7 DOCK PACKAGES)
2 DRIVE-IN DOORS



93,493 SF AVAILABLE

Office:	3,107 SF
Clear Height:	32'
Dock Doors:	26 (7 Dock Packages)
Drive-In Doors:	2
Trailer Stalls:	18 stalls perimeter fenced and exclusive to space

28TH COURT NE

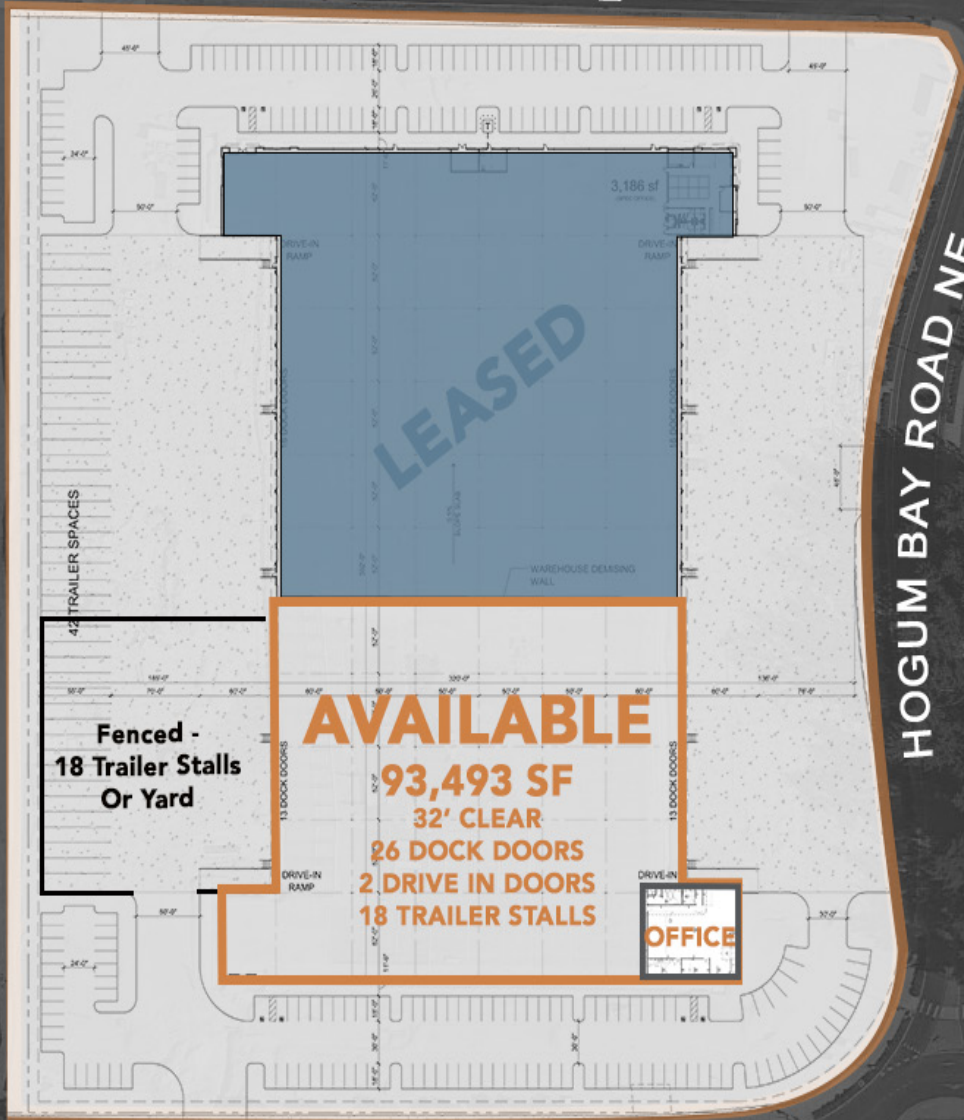

HOGUM BAY ROAD NE

WILLAMETTE DRIVE NE







PROXIMITY

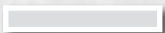

Lacey Industrial Center offers convenient access to I-5, a short 1.5 mile drive, and other area highways. With the Port of Tacoma 26 miles from the property, and Seattle-Tacoma International Airport and the Port of Seattle 50 and 53 miles away, respectively, the site provides an excellent location for distribution.

NEIGHBORHOOD SERVICES

INTERCITY TRANSIT

-  Regular Route
-  15-Min Weekday Service
-  Bus Stops
-  Park & Ride





LACEY INDUSTRIAL CENTER

2621 HOGUM BAY ROAD
LACEY, WA 98516

FOR MORE INFORMATION, CONTACT:

VANESSA HERZOG, SIOR, CCIM
D (253) 444-3020
vherzog@lee-associates.com

BRUCE VALENTINE
D (253) 779-2400
bvalentine@neilwalter.com

CAMERON VALENTINE
D (253) 779-2400
cvalentine@neilwalter.com



LBALogistics 