

# FINANCIAL PLAZA

7720 & 7730 E. BELLEVUE | GREENWOOD VILLAGE, CO



**EXCITING PROPERTY UPGRADES AND OFFICE SPEC SUITES UNDERWAY**

**NEWMARK**

**LIONROCK**

For Leasing Information Contact:

**Pete Staab**  
**Keith Bell**

303.260.4346  
303.260.4332

[pete.staab@nmrk.com](mailto:pete.staab@nmrk.com)  
[keith.bell@nmrk.com](mailto:keith.bell@nmrk.com)

# FINANCIAL PLAZA

## PROPERTY HIGHLIGHTS

- A 5.27-acre office campus consisting of 142,397 SF in two buildings with new activated outdoor spaces and patios
- 3.65:1,000 SF parking ratio of with nearly half covered, in a two-level parking structure
- Newly renovated common areas and amenities (New fitness center with showers & lockers, lounge, conference facility and outdoor gathering spaces)
- New spec suites white boxing, and other vacancy prep



## OUTDOOR AMENITIES

- Putting Green
- Ornamental Plants & Trees
- Grill & Countertop
- Fire Pit with Lounge Chairs
- Ornamental Grasses & Plantings
- Abundant Seating Areas

**TYPICAL FLOORPLATE**

21,164 SF



**TYPICAL FLOORPLATE**

11,649 SF

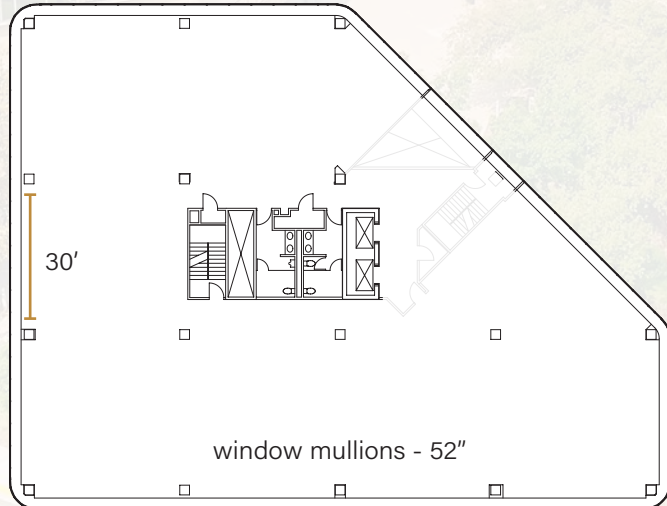

7730 E. BELLEVUE AVE | BUILDING A

5 STORIES | 97,883 SF  
*(Divisible to 1,125 SF)*

7720 E. BELLEVUE AVE | BUILDING B

4 STORIES | 44,514 SF  
*(Divisible to 869 SF)*

# AERIAL VIEW & AMENITIES

# FINANCIAL PLAZA

**MULTIPLE DINING AND RETAIL OPTIONS IN THE IMMEDIATE VICINITY, INCLUDING THE ADJACENT BELLEVIEW PROMENADE**



**IMMEDIATE ACCESS TO/FROM I-25 AT BELLEVIEW – 15 MINUTES TO DOWNTOWN AND 25 MINUTES TO DIA**