



LAND FOR SALE



# 261224 RANGE ROAD 290, RURAL ROCKY VIEW COUNTY

Angela McNeill, Associate

403-510-0866 / [amcneillrealestate@gmail.com](mailto:amcneillrealestate@gmail.com)



## Listing Information

Address:	261224 Range Road 290
Municipality:	Rural Rocky View County
Total Size:	20.58 ± Acres
Asking Price:	\$10,804,500.00 or \$525,000.00 per acre

## Existing On-Site Improvements

- Large Steel Quonset: 155' x 56' uninsulated, zipper-lock galvanized steel structure with 14' H x 20' W doors.
- Heated Shop: 34' x 50' fully insulated and heated shop/building.

## Key Highlights

- **Strategic Location:** 20.58 acres situated in the rapidly expanding industrial hub of East Balzac, Rocky View County.
- **Favorable Zoning Potential:** Currently zoned R-RUR within the East Balzac ASP (SDA5), with a rezoning application to I-HVY (Heavy Industrial) presently under review.
- **Exceptional Connectivity:** Direct, high-quality access to major transportation corridors: Dwight McLellan Trail, Métis Trail, Stoney Trail, QEII Highway, and CrossIron Drive.
- **Airport Access:** Convenient proximity to the Calgary International Airport.

Angela McNeill, Associate

403-510-0866 / amcneillrealestate@gmail.com

# FUTURE MASTER-PLANNED BUSINESS PARK

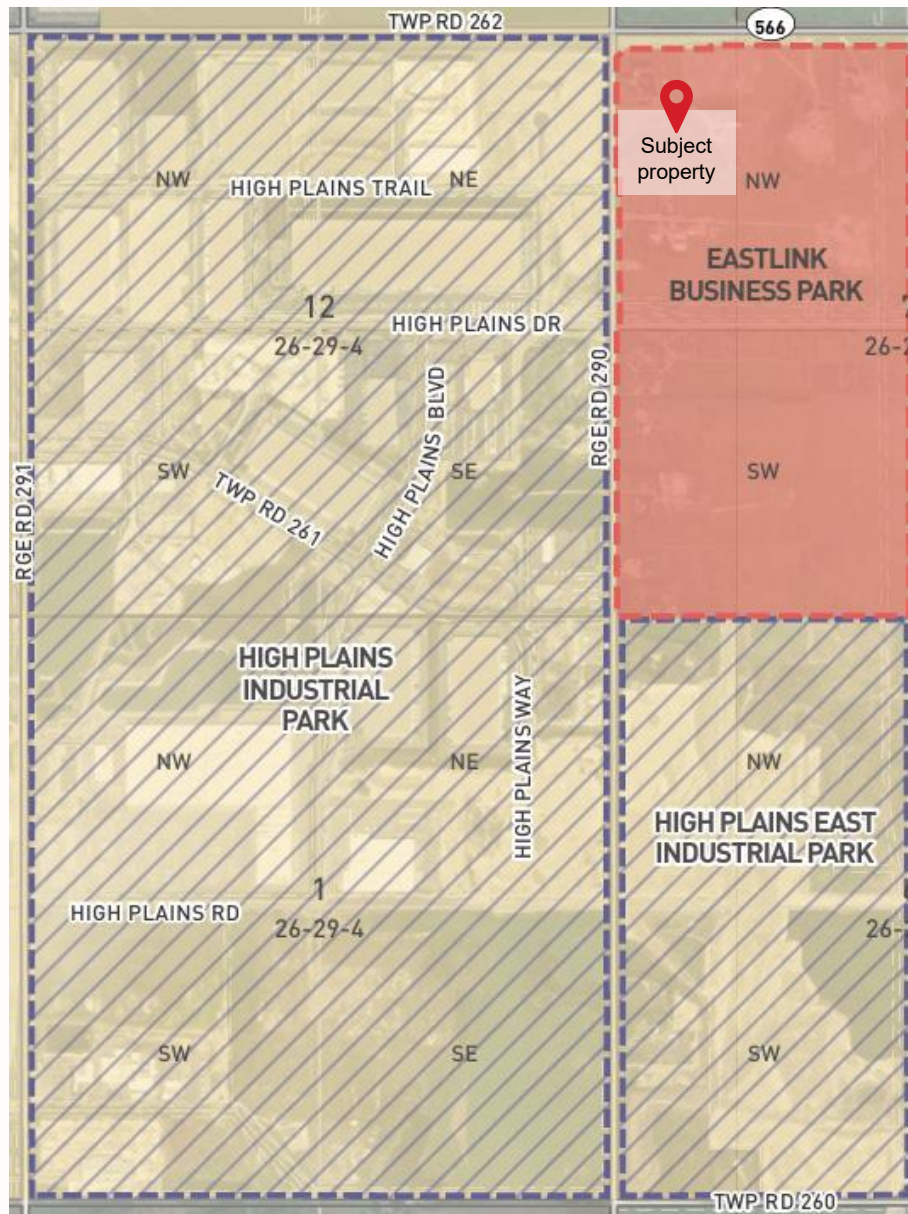

- **Part of the Proposed Eastlink Business Park:** Conceptual Scheme and Land Use Amendment applications have been submitted to transition this parcel into a fully serviced industrial park.
- **Elite Corporate Neighbors:** Immediate neighbors include Amazon (YYC1) and Walmart's Western Canada E-Commerce Node.
- **Thriving Industrial Hub:** The adjacent High Plains Industrial Park hosts major brands such as Sobeys, Home Depot, RONA/Lowe's, Conagra, Wolseley, Dollarama, Sysco, and Gordon Food Services.
- **Premier Logistics Access:** Dedicated national freight carriers, including Bison, Charger, and Canada Cartage, operate directly within the immediate area.

Angela McNeill, Associate

403-510-0866 / amcneillrealestate@gmail.com

# PROPERTY PHOTOS

**PRESTIGE**  
COMMERCIAL GROUP



Angela McNeill, Associate

403-510-0866 / [amcneillrealestate@gmail.com](mailto:amcneillrealestate@gmail.com)



# PROPOSED LAND USES

## I-HVY Industrial, Heavy District

**444 PURPOSE:** To provide for a range of industrial activity that may have off-site nuisance impacts, including support services and storage.

<b>445 PERMITTED USES:</b>	<b>PERMITTED USE IN AN EXISTING APPROVED BUILDING; DISCRETIONARY USE OTHERWISE:</b>	<b>DISCRETIONARY USES:</b>
Accessory Building ≤ 500 m <sup>2</sup> (5381.96 ft <sup>2</sup> )	Office	Accessory Building > 500 m <sup>2</sup> (5381.96 ft <sup>2</sup> )
Communications Facility (Type A)	Industrial (Light)	Alcohol Production
Communications Facility (Type B)		Auctioneering
Communications Facility (Type C)		Cannabis Cultivation
Industrial (Logistics)		Cannabis Processing
Industrial (Medium)		Cannabis Retail Store
		Dwelling Unit, accessory to principal use
		Film Production
		Industrial (Heavy)
		Outdoor Storage
		Recycling/Compost Facility
		Shipping Container (parcels greater than 3.95 acres)
		Special Function Business
		Station (Bulk Fuel)

Those uses which are not otherwise defined in the Bylaw, which in the opinion of the Development Authority are similar to the above and conform to the purpose of this District may be Discretionary Uses.

### 446 MINIMUM PARCEL SIZE:

- 1.0 ha (2.47 ac)
- The minimum size of parcels designated with the letter "p" is the number indicated on the [Land Use Map](#)

### 447 MAXIMUM BUILDING HEIGHT:

- 20.0 m (65.61 ft.)
- The maximum height on parcels designated with the letter "h" is the number indicated on the [Land Use Map](#)

### 448 MINIMUM SETBACKS (for Buildings):

<b>Front Yard</b>	<b>Side Yard</b>	<b>Rear Yard</b>
15.0 m (49.21 ft.)	15.0 m (49.21 ft.)	15.0 m (49.21 ft.)
	6.0 m (19.69 ft.) from an Industrial District	6.0 m (19.69 ft.) from an Industrial District

### 449 MINIMUM SETBACKS (for Parking and Storage):

<b>Front Yard</b>	<b>Side Yard</b>	<b>Rear Yard</b>
15.0 m (49.21 ft.) from Highway/County road	15.0 m (49.21 ft.) from Highway/County road	15.0 m (49.21 ft.) from any road
8.0 m (26.25 ft.) from service roads	8.0 m (26.25 ft.) from service roads	No setback from an Industrial District
	No setback from an Industrial District	6.0 m (19.69 ft.) from other parcels

### 450 ADDITIONAL REQUIREMENTS:

- A minimum of 10% of the lands shall be landscaped
- Storage shall be screened from public ROWs and adjacent parcels

**Note:** Please note that this land use designation is currently proposed and pending municipal approval.

Angela McNeill, Associate

403-510-0866 / amcneillrealestate@gmail.com

# PRESTIGE

COMMERCIAL GROUP

RE/MAX  
COMMERCIAL

RE/MAX  
Complete Realty



BUSINESS



HOSPITALITY



INDUSTRIAL



INVESTMENT



LAND



MULTI-FAMILY



OFFICE



PROJECT  
MANAGEMENT



RETAIL

320, 180 Quarry Park Boulevard S.E. Calgary, Alberta T2C 3G3

This brochure is intended for information purposes only and should not be relied upon for accurate factual information by the recipient hereof. The information contained herein is based on information which Prestige Commercial deems reliable. However, Prestige Commercial assumes no responsibility for the degree of accuracy such information, nor does Prestige Commercial represent or warrant information contained herein. Recipient should conduct their own investigation to determine the accuracy of information contained herein. The information herein is subject to change without notice.

Angela McNeill, Associate

403-510-0866 / amcneillrealestate@gmail.com