



COMMERCIAL REAL ESTATE SERVICES
RALEIGH • DURHAM • WILMINGTON

CLASS A OFFICE SPACE FOR LEASE

CROSSPOINTE II

2840 PLAZA PLACE, RALEIGH, NC 27612

Overview

CROSSPOINTE II is a four-story, beautiful mirrored glass and marble office building in a desirable NW Raleigh area. Located at the intersection of Creedmoor Road and Plaza Place, in a wooded, suburban setting just one mile North of iconic Crabtree Valley Mall. Crosspointe II is minutes from I-440 Beltline and convenient to Glenwood Avenue, Downtown Raleigh, and RDU International Airport.

PROPERTY HIGHLIGHTS

- 92,600 SF Class A office building
- Renovated 2-story lobby featuring Italian marble floors and wood paneled walls
- New computer controlled HVAC
- Renovated restrooms
- Extensive landscaping with annual plantings
- FedEx and UPS boxes on-site
- Stop light access on Creedmoor Rd
- Abundant parking
- Shopping center adjacent to property with numerous restaurants and other walkable amenities

AVAILABILITY

- Suite 111: 2,337 RSF, \$27.50/SF, Avail. 8/1/26, partially furnished
- Suite 200: 3,828 RSF, \$26.50/SF, Avail. 6/1/26
- Suite 260: 3,347 RSF, \$26.50/SF
- Suite 340: 5,634 RSF, \$26.50/SF, Avail. 6/1/26
- Lease rates are Full Service

Brian Farmer, SIOR

bfarmer@lee-associates.com
919.730.6584



First Floor

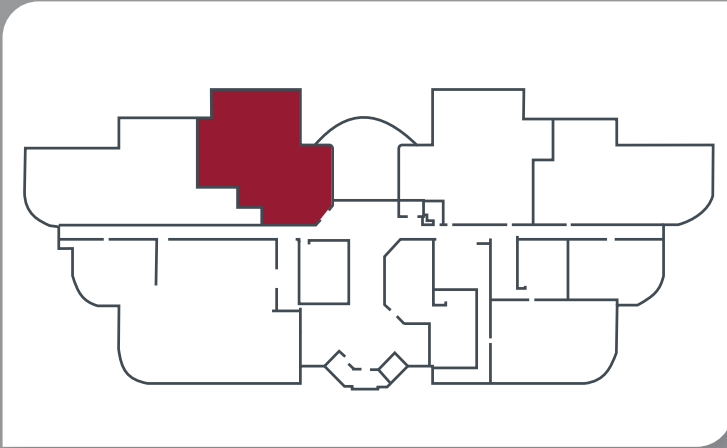

FIRST FLOOR | SUITE 111
2,337 RSF
AVAILABLE 8/1/26

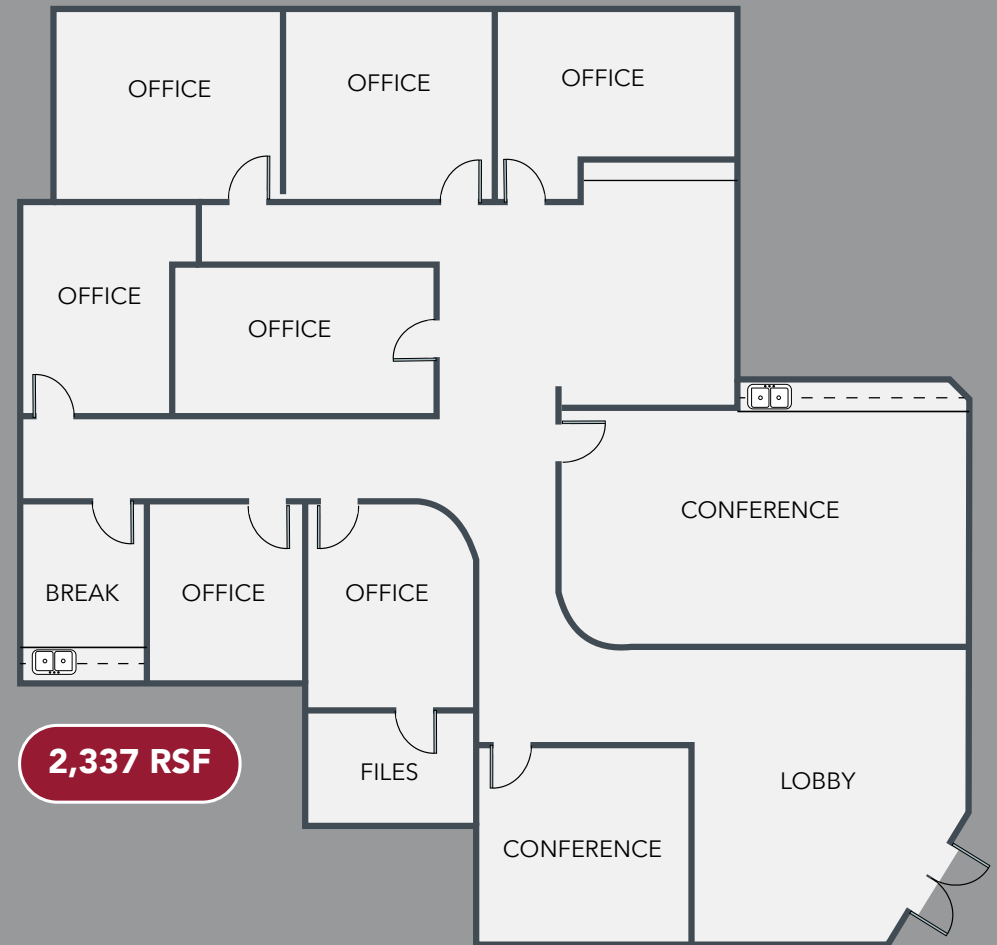

Brian Farmer, SIOR
bfarmer@lee-associates.com
919.730.6584

All information furnished regarding property for sale, rental or financing is from sources deemed reliable, but no warranty or representation is made to the accuracy thereof and same is submitted to errors, omissions, change of price, rental or other conditions prior to sale, lease or financing or withdrawal without notice. No liability of any kind is to be imposed on the broker herein.

 LEE &
ASSOCIATES

Second Floor

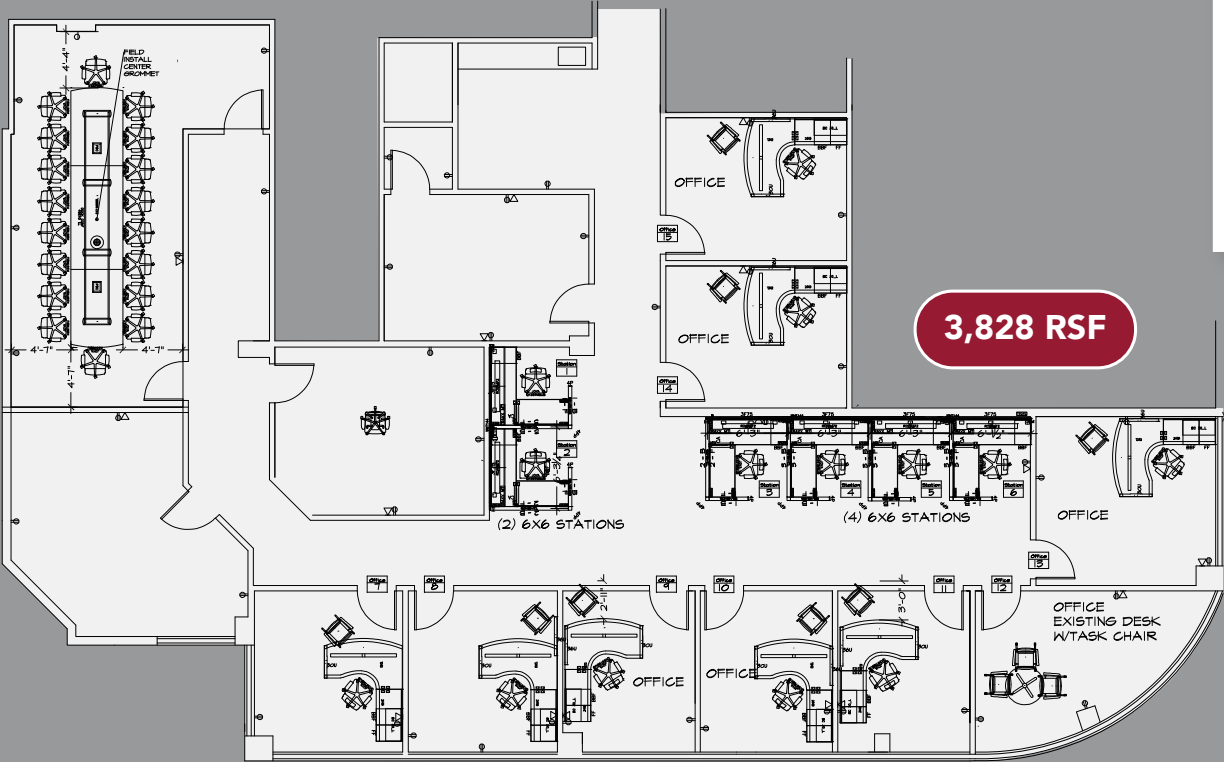

FURNITURE NOT INCLUDED

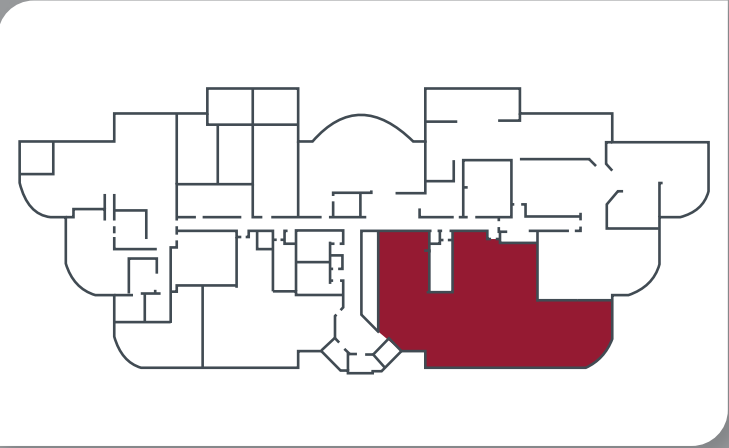

SECOND FLOOR | SUITE 200
3,828 RSF
AVAILABLE 6/1/26

Brian Farmer, SIOR
bfarmer@lee-associates.com
919.730.6584

All information furnished regarding property for sale, rental or financing is from sources deemed reliable, but no warranty or representation is made to the accuracy thereof and same is submitted to errors, omissions, change of price, rental or other conditions prior to sale, lease or financing or withdrawal without notice. No liability of any kind is to be imposed on the broker herein.



Second Floor

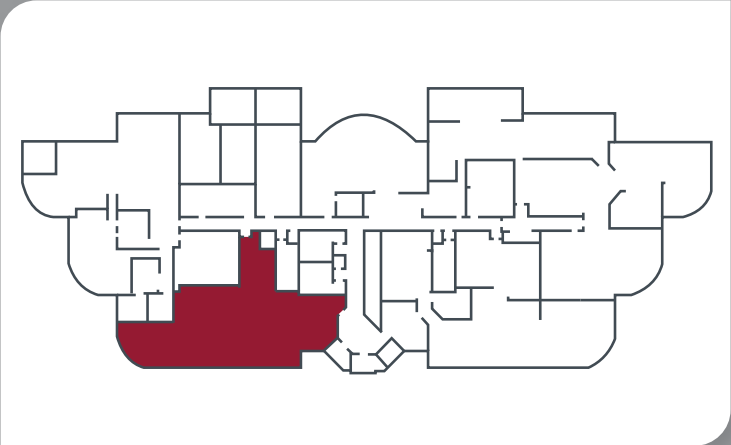

SECOND FLOOR | SUITE 260
3,347 RSF AVAILABLE

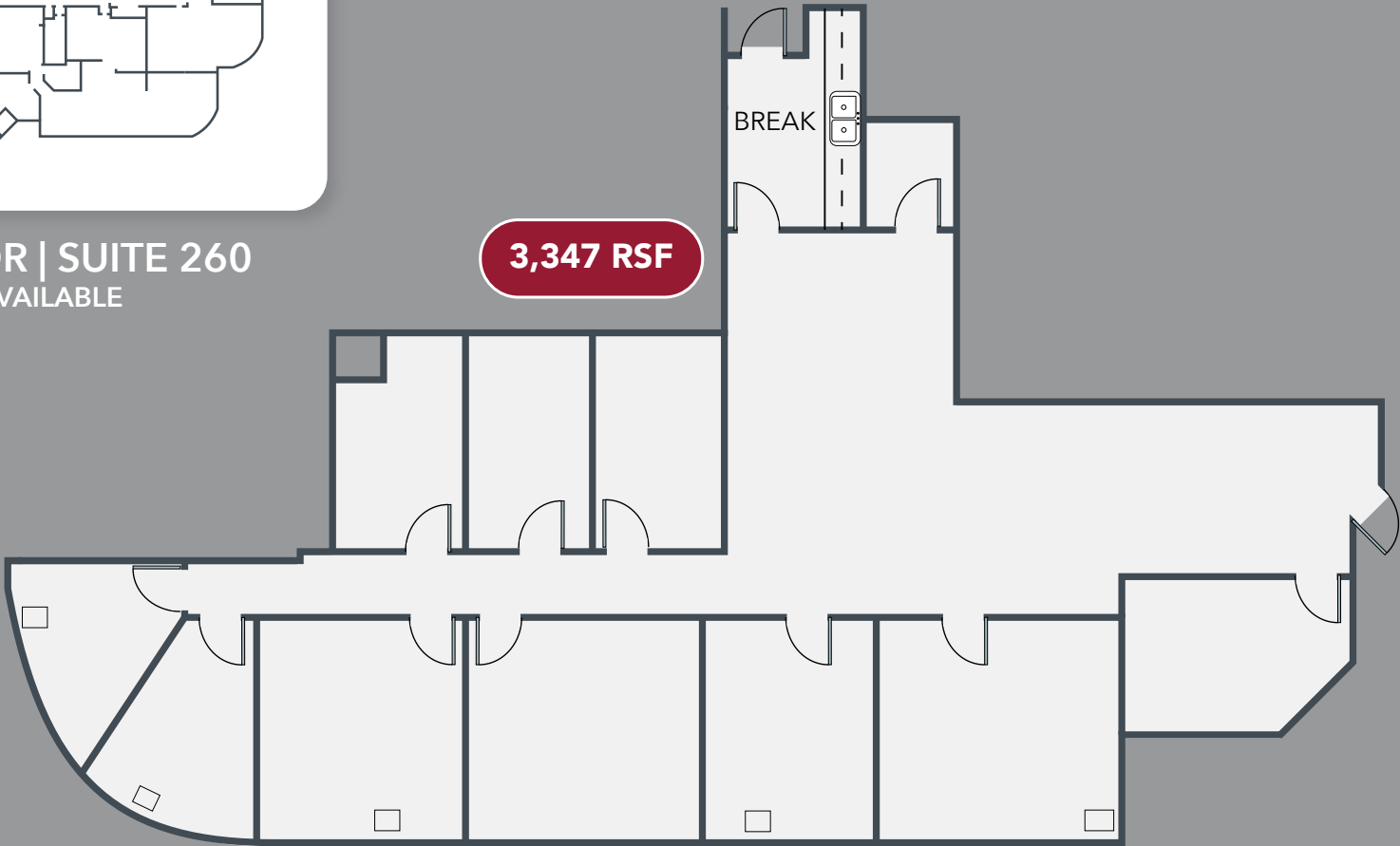

Brian Farmer, SIOR
bfarmer@lee-associates.com
919.730.6584

All information furnished regarding property for sale, rental or financing is from sources deemed reliable, but no warranty or representation is made to the accuracy thereof and same is submitted to errors, omissions, change of price, rental or other conditions prior to sale, lease or financing or withdrawal without notice. No liability of any kind is to be imposed on the broker herein.



Third Floor

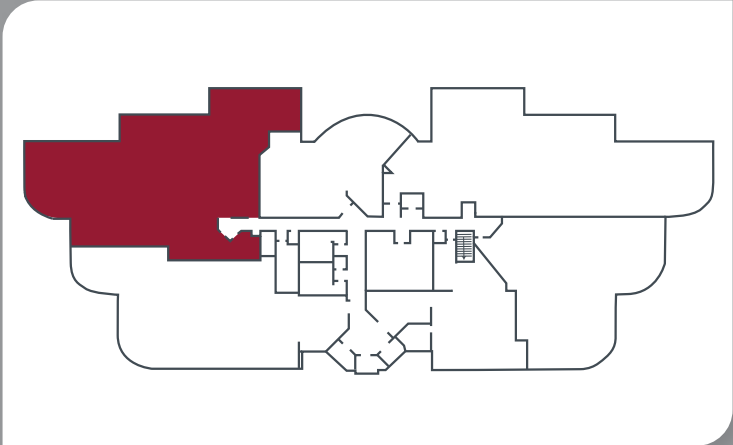

THIRD FLOOR | SUITE 340
5,634 RSF AVAILABLE 6/1/26



5,6334 RSF

FURNITURE NOT INCLUDED

Brian Farmer, SIOR
bfarmer@lee-associates.com
919.730.6584

All information furnished regarding property for sale, rental or financing is from sources deemed reliable, but no warranty or representation is made to the accuracy thereof and same is submitted to errors, omissions, change of price, rental or other conditions prior to sale, lease or financing or withdrawal without notice. No liability of any kind is to be imposed on the broker herein.



Features

- » *Renovated 2-story lobby featuring Italian marble floors and wood paneled walls*
- » *New computer-controlled HVAC*
- » *Extensive landscaping with annual plantings*
- » *Renovated restrooms*
- » *FedEx and UPS boxes on-site*
- » *Numerous restaurants and walkable amenities nearby*



Brian Farmer, SIOR
bfarmer@lee-associates.com
919.730.6584

Area Amenities

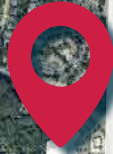

I-440
1.5 MILES

DOWNTOWN RALEIGH
7.3 MILES

RDU AIRPORT
11.9 MILES

RESEARCH TRIANGLE PARK
17.9 MILES



CRABTREE VALLEY MALL

