



AVAILABLE FOR SALE @ VICTORIA CROSSING
1,275± SF Modern Commercial Condominium Suite
2475 Victoria Avenue, San Luis Obispo, California

Central Coast | **Sotheby's**
INTERNATIONAL REALTY



Modern Commercial Condominium Suites

Welcome to Victoria Crossing in San Luis Obispo, CA. The community features 33 residential flats and three (3) modern commercial suites at ground level. An exceptional opportunity for an owner-user or investor, the commercial suites are new construction featuring high ceilings, ample natural light, and a prominent street presence. Located in a blossoming urban area just moments from downtown SLO, the property is perfect for entrepreneurs seeking to capitalize on the thriving local economy, an abundance of nearby amenities, and a built-in customer base in the many flats and condos in close proximity. Suite C1 (\$369,900) is 1,275 SF and

features floor-to-ceiling windows and extensive outdoor patio space. In addition to open street parking on both sides of Victoria and Caudill, the suites benefit from 11 onsite parking spaces dedicated to commercial use. Suite C1 has access to a grease trap and venting systems, making this space ideal for a restaurant or café. Zoning is C-R-SF (Retail Commercial with Special Focus Area Overlay); consult the City of San Luis Obispo to confirm allowable uses. Inquire today to schedule a showing and for details, including a site plan and technical specifications. This is a rare opportunity to invest in a commercial property with amazing growth potential.

Modern Commercial Condominium Suite

2475 VICTORIA AVENUE, SAN LUIS OBISPO, CA

- Close to Downtown
- Modern with built-in customer base
- Lots of natural light
- APN: 004-921-027 (San Luis Obispo County)
- Suite is in shell condition

For additional information please contact:



Chris Richardson
 Managing Broker | DRE #01200458
 805.801.9091
chris.richardson@sothebysrealty.com



Erik Berg-Johansen
 Sales Associate | DRE # 02061242
 805.805.538.1828
erik.bergjohansen@sothebysrealty.com

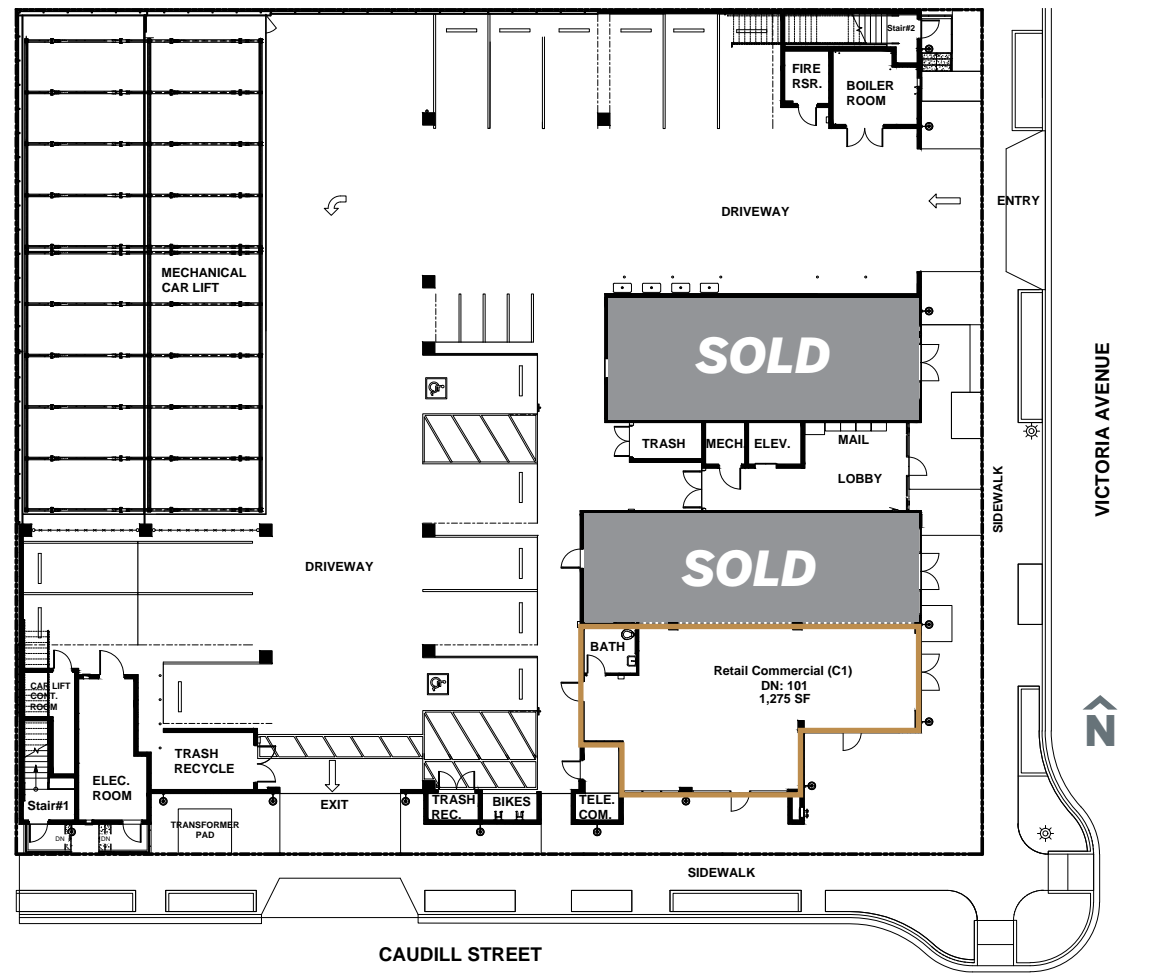

UNIT C1

Unit Size: 1,275± SF
Price: \$369,900
Use: Retail

SOLD - UNIT C2

Unit Size: 1,021± SF
Price: \$190,000
Use: Retail

SOLD - UNIT C3

Unit Size: 1,073± SF
Price: \$209,000
Use: Office/Retail

Central Coast Sotheby's International Realty | 711 Tank Farm Road, Suite 100, San Luis Obispo, CA 93401 | centralcoastsir.com

© 2026 Central Coast Sotheby's International Realty. All rights reserved. Sotheby's International Realty® and the Sotheby's International Realty Logo are service marks licensed to Sotheby's International Realty Affiliates LLC and used with permission. Central Coast Sotheby's International Realty fully supports the principles of the Fair Housing Act and the Equal Opportunity Act. Each office is independently owned and operated. Any services or products provided by independently owned and operated franchisees are not provided by, affiliated with or related to Sotheby's International Realty Affiliates LLC nor any of its affiliated companies. If your property is listed with a real estate broker, please disregard. It is not our intention to solicit the offerings of other real estate brokers. All data, including all measurements and calculations are obtained from various sources and has not and will not be verified by Broker. All information shall be independently reviewed and verified for accuracy.



Modern Commercial Condominium Suite

2475 VICTORIA AVENUE
SAN LUIS OBISPO, CA

1

Dollar Tree

Broad Street Barber Shop
J&L Hawaii BBQ
Doggie Salon & Spa
Mechanics Bank

2

Staples

All Season Digital
Full Circle Photo
The Fitting Image
Bonzi Software

3

Cool Cat Cafe

My Dreams Spa
Le Ciel Crepes Cafe
Visiting Angels
Birdhouse Tatoo Collective

4

Lemo's Feed & Pet Supply

Sushi's Eyebrow Threading
Thai Boat
Taco Roco
XGT Fitness
Beida's Biergarten
Subway



Open Space

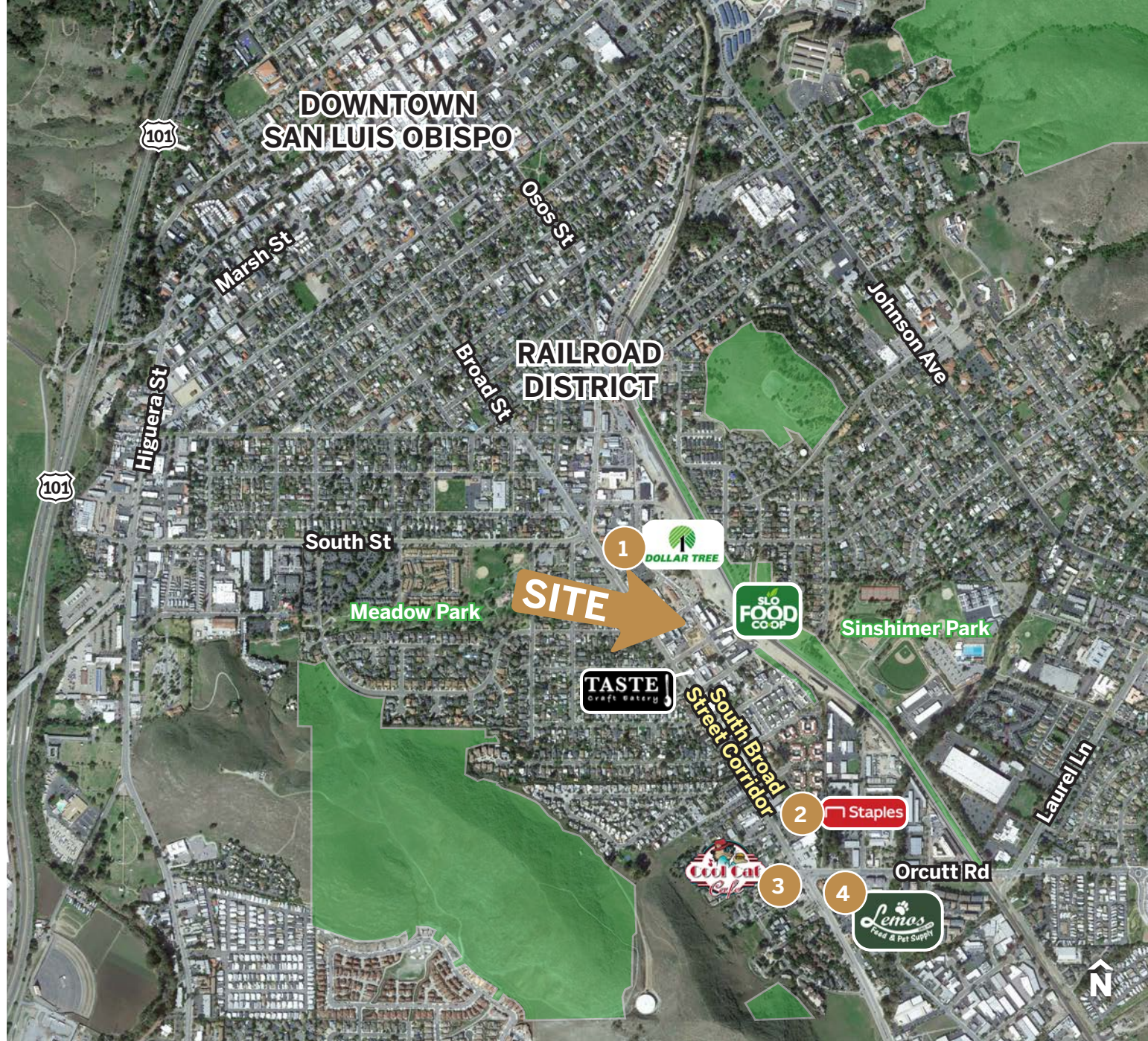

Central Coast Sotheby's International Realty | 711 Tank Farm Road, Suite 100, San Luis Obispo, CA 93401 | centralcoastsir.com

© 2026 Central Coast Sotheby's International Realty. All rights reserved. Sotheby's International Realty® and the Sotheby's International Realty Logo are service marks licensed to Sotheby's International Realty Affiliates LLC and used with permission. Central Coast Sotheby's International Realty fully supports the principles of the Fair Housing Act and the Equal Opportunity Act. Each office is independently owned and operated. Any services or products provided by independently owned and operated franchisees are not provided by, affiliated with or related to Sotheby's International Realty Affiliates LLC nor any of its affiliated companies. If your property is listed with a real estate broker, please disregard. It is not our intention to solicit the offerings of other real estate brokers. All data, including all measurements and calculations are obtained from various sources and has not and will not be verified by Broker. All information shall be independently reviewed and verified for accuracy.

Central Coast | Sotheby's
INTERNATIONAL REALTY