

KOLLMANN

LISTING / 235 SECOND ST

DISTRICT SOMA

CLASS A

STATUS AVAILABLE / SUBLEASE

235

SECOND ■ STREET

01 / DESCRIPTION

A turn-key creative office sublease through November 2029 in one of SoMa's most distinctive Class A addresses — furnished, finished, and ready to occupy. Shared boardrooms, a tenant lounge, on-site fitness, and a courtyard that quietly outclasses the block.

SUITE

120

AREA

5,444 RSF

TYPE

Sublease

TERM

Thru 11.2029

Cody Kollmann

cody@kollmann.co
(415) 535.3313

Christian Torres

christian@kollmann.co
(707) 673.3807

DRE 02270300

KOLLMANN

LOCATION / COORDINATES

LAT 37.7864° N
LNG 122.3970° W
ZIP 94105
ELEV +16 ft

235 / CLASS A

THE ADDRESS

ID 235.SF

BUILDING

235 Second St

DISTRICT

SoMa

CLASS

A

COURTYARD

Yes

FITNESS

On-site

BIKE

Storage

Two Hundred Thirty · Five

SECOND ST / SAN FRANCISCO / 94105

KOLLMANN

■ FURNISHED SUBLEASE / THROUGH NOV 2029

Suite No. 120

5,444

RENTABLE SF

■ SPECIFICATION REV. 01

LEASE *Sublease*

TERM Through Nov 2029

AREA 5,444 RSF

FLOOR Ground

CEILING *High*, exposed

OFFICES 3 private / mtg

KITCHEN Dedicated, full

FURNITURE Included

FINISHES *New*, creative

STATUS ► **READY**



PLAN / SUITE 120 NTS · N↑

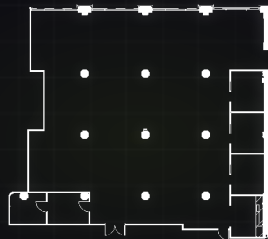

5,444 RSF

ORIENT N↑

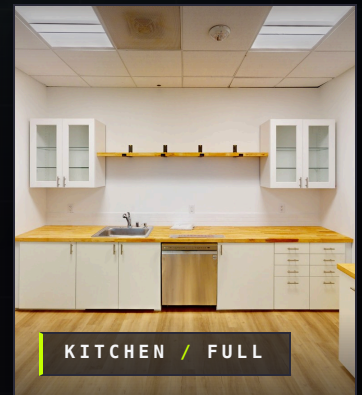

+ THE BUILDING

- + Two shared boardrooms
- + Game room & tenant lounge
- + On-site fitness center
- + Bike storage
- + Landscaped courtyard

360° MATTERPORT

Walk the suite from anywhere

VIRTUAL TOUR →

Cody Kollmann

DRE 02048359

cody@kollmann.co

(415) 535.3313

Christian Torres

DRE 02374367

christian@kollmann.co

(707) 673.3807

KOLLMANN

DRE 02270300

The information herein has been obtained from sources believed reliable; however, Kollmann, Inc. makes no guarantees, warranties, or representations as to the completeness or accuracy thereof. Presentation of this property is submitted subject to errors, omissions, change of price or conditions, prior sale or lease, or withdrawal without notice. © 2026 Kollmann, Inc.