

2811 Faber Street, Union City, CA 94587

±32,886 SF Available For Sale or Lease



±32,886
Square Feet



±1.64
Acres

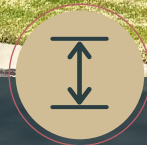

±24'
Clear Height



4 Dock Doors
2 Grade Doors



2,000 Amps
Power

Sam Higgins, SIOR
+1 415 987 8798
sam.higgins@kbcadvisors.com
DRE License# 01329023

Kevin Kennick
+1 925 330 1601
kevin.kennick@kbcadvisors.com
DRE License# 02110600

Property Overview

PROPERTY SPECS

BUILDING SIZE	±32,886 SF
ACRES	±1.64
OFFICE SIZE	±9,500 SF (2-Story)
CLEAR HEIGHT	±24'
DOCK DOORS	4
DRIVE-IN DOORS	2
COLUMN SPACING	±28' x 24'
POWER	2,000 Amps @ 277/480 Volts*
PARKING SPACES	±45

SPRINKLER SYSTEM	0.33 GPM / 3,000 SF
ACCESS	Immediate Access to I-880 & Close to Highway 92/San Mateo Bridge
ZONING	ML (Light Industrial)
APN	463-45-80
YEAR BUILT	1986
AVAILABLE	Now
LEASE RATE	\$1.35 PSF/NNN (\$0.22 OpEx)
SALE PRICE	\$11,500,000 (\$349 PSF)

* Tenant to confirm

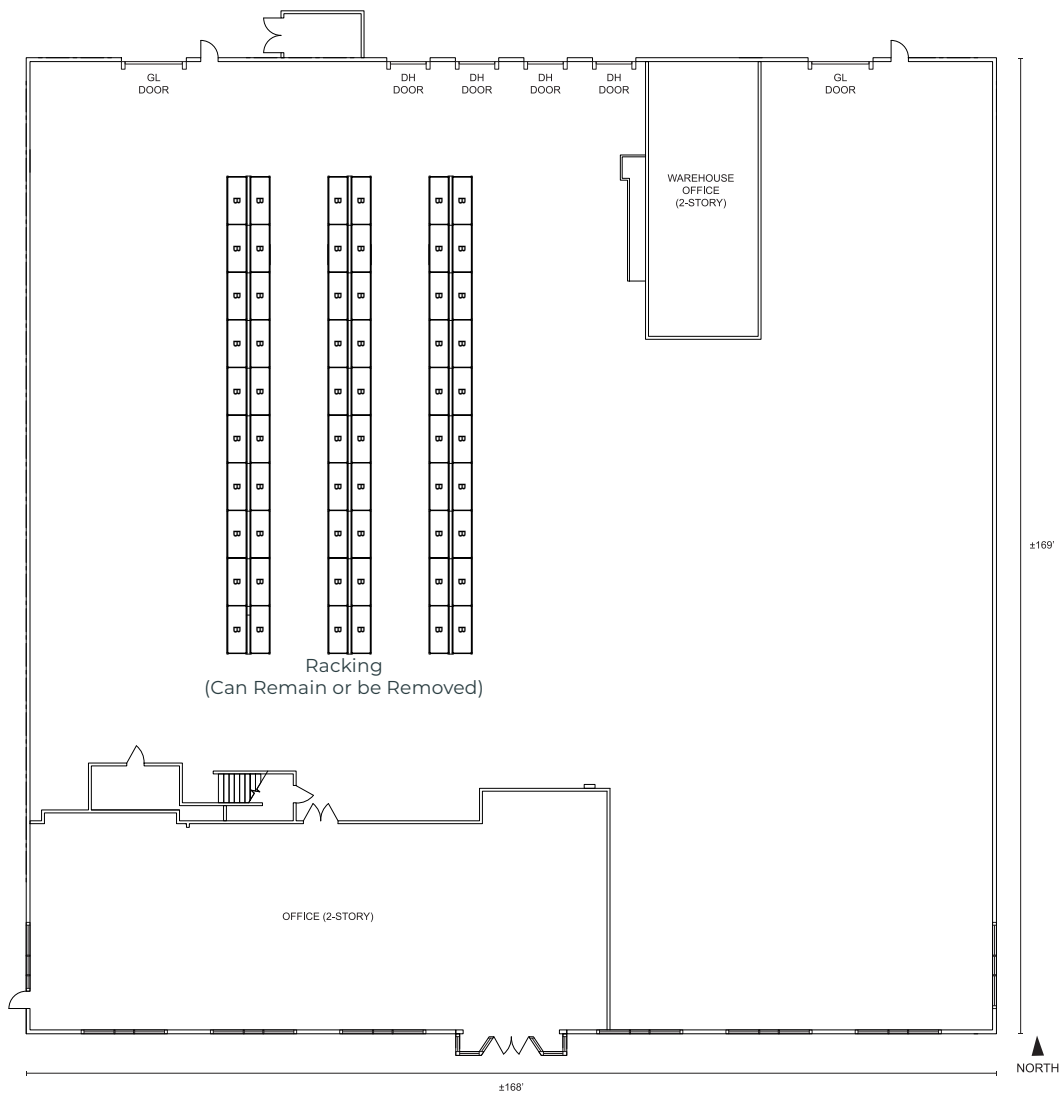

Plans not to scale & subject to change

Access Map

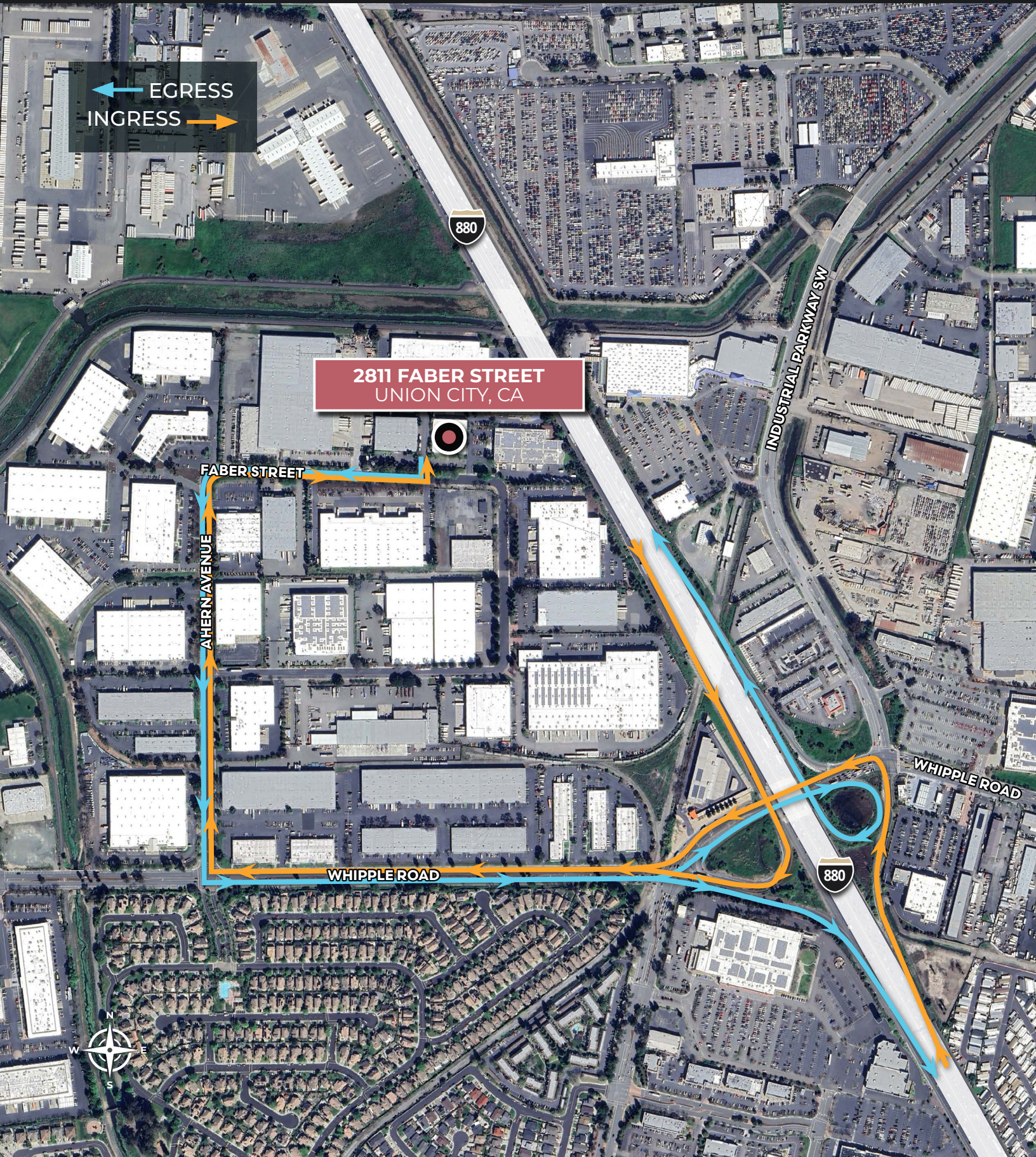

← EGRESS
INGRESS →

2811 FABER STREET
UNION CITY, CA

FABER STREET

AHERN AVENUE

WHIPPLE ROAD

INDUSTRIAL PARKWAY SW

WHIPPLE ROAD

880

880



Regional Map

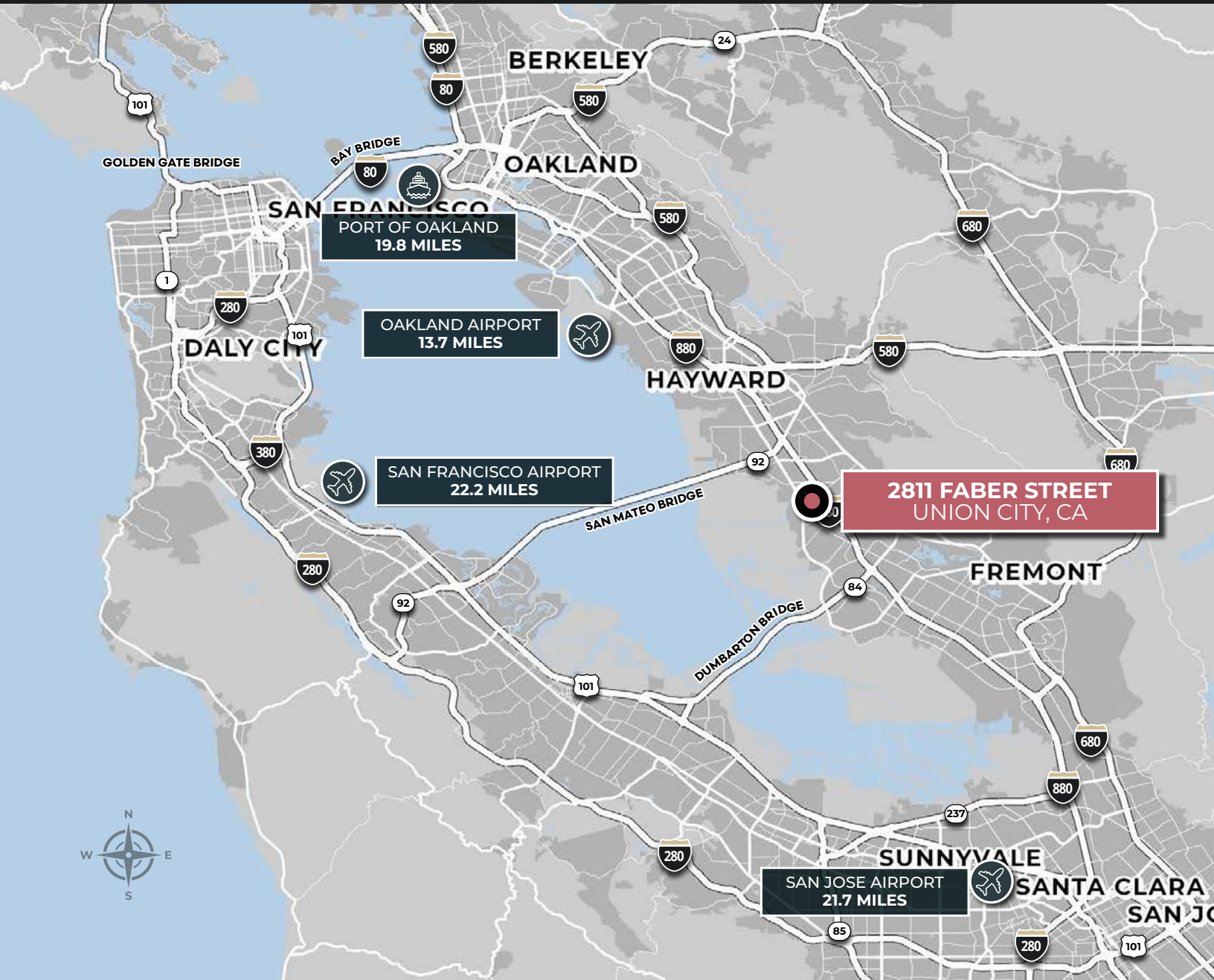

Sam Higgins, SIOR
+1 415 987 8798
sam.higgins@kbcadvisors.com
DRE License# 01329023

Kevin Kennick
+1 925 330 1601
kevin.kennick@kbcadvisors.com
DRE License# 02110600

© 2026 KBC ADVISORS This information has been obtained from sources believed to be reliable but has not been verified for accuracy or completeness, and KBC Advisors disclaims any guarantees, warranties or representations, express or implied, as to the completeness or accuracy as to the information contained herein. You should conduct a careful, independent investigation of the property and verify all information. Any reliance on this information is solely at your own risk. The KBC ADVISORS logo is a service mark of KBC ADVISORS. All other marks displayed on this document are the property of their respective owners. Photos herein are the property of their respective owners. Use of these images without the express written consent of the owners is prohibited.

