

BUILDING #12

461,832 SF - CROSS DOCK

| DIVISIBLE TO 113,000 SF

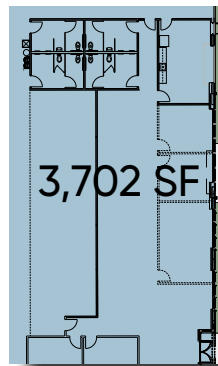
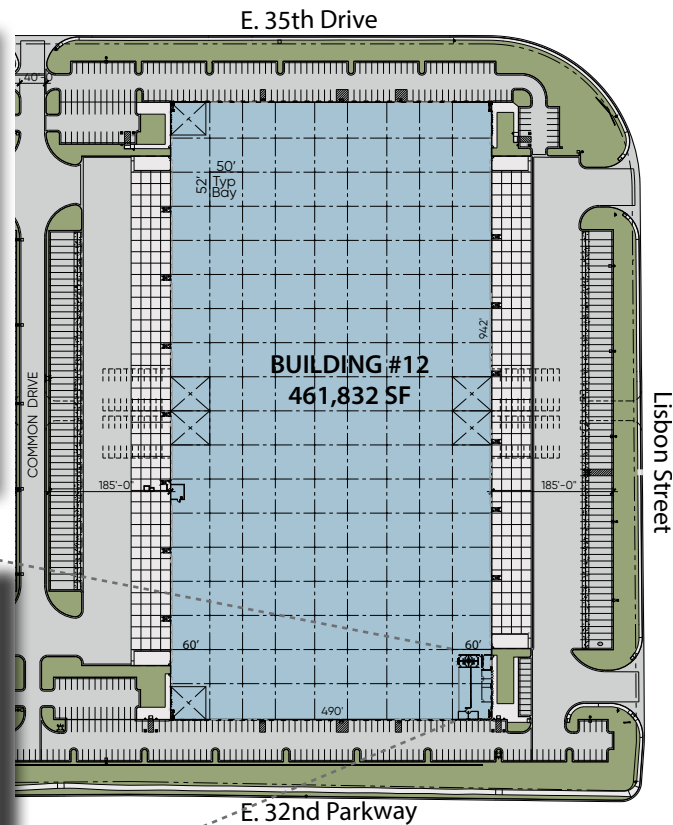

Majestic Commercenter Features

- 1,600 Acre Master Planned Business Park
- 10 Million Square Feet Developed
- 20,000 to 1,500,000 Square Feet Available
- Spec Product and Build-to-Suit
- Immediate Access to I-70 at Tower Road
- I-70 and E-470 Frontage
- 5 miles South of Denver International Airport
- Federal Opportunity Zone
- Adams County Enterprise Zone
- Foreign Trade Zone 123
- Xcel Energy Certified Site

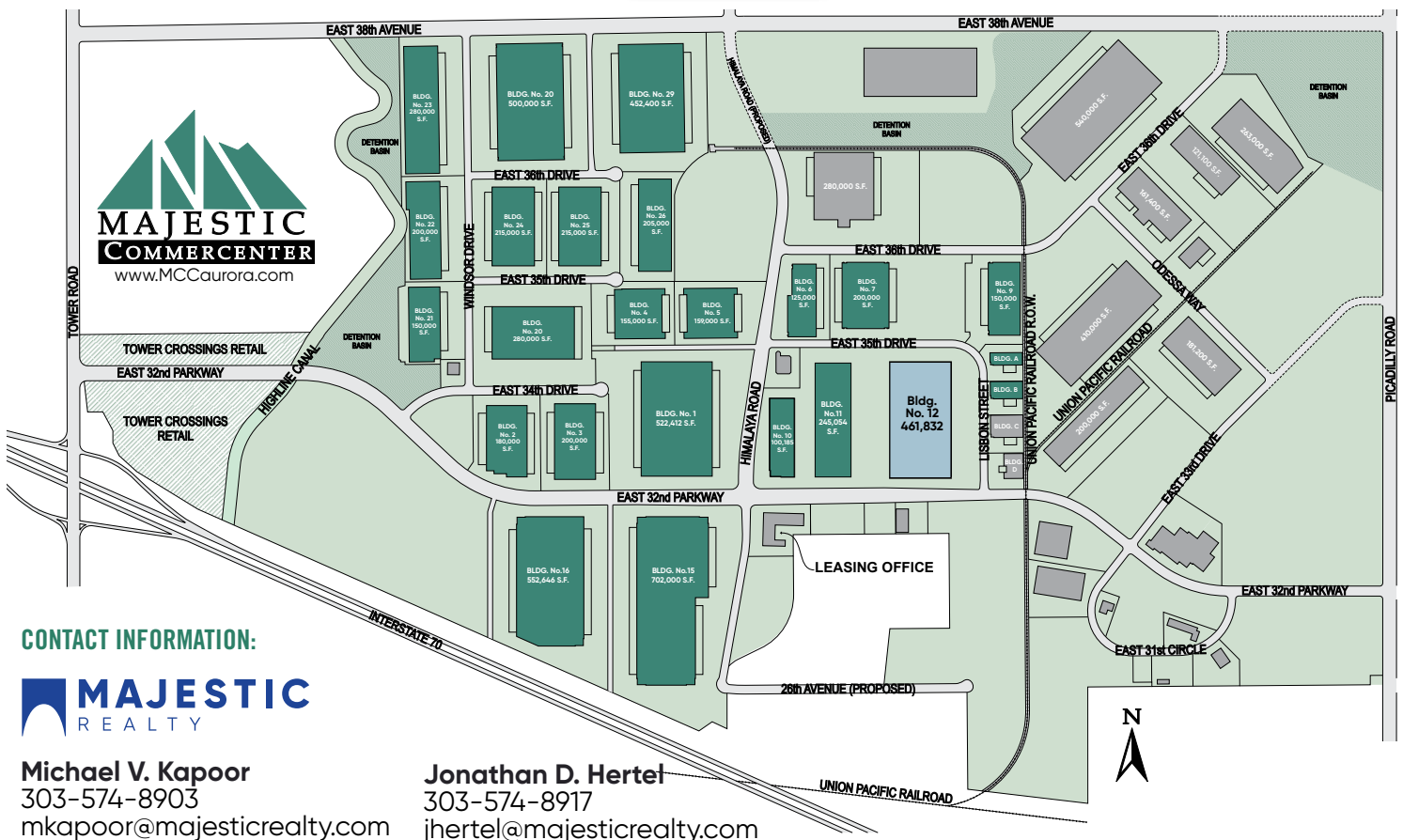

CONTACT INFORMATION:



Michael V. Kapoor
 303-574-8903
 mkapoor@majesticrealty.com

Jonathan D. Hertel
 303-574-8917
 jhertel@majesticrealty.com