

Lakeland Interstate Business Park
2855 Interstate Drive
Lakeland, Florida 33805

BUCKNER
COMMERCIAL PROPERTIES

WAREHOUSE SPACE



- **Up To 30,109 Sq. Ft.**
- **Square Footage Options**
 - A. 15,356
 - B. 20,475
 - C. 30,109
- **Immediate Availability**
- **Easy Access to I-4**

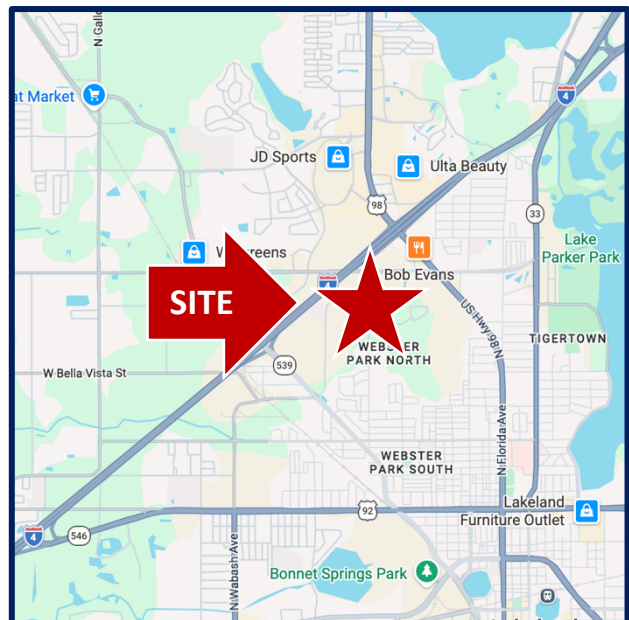

Contact: David A. Buckner, SIOR

Office: (863) 686-7770 | Mobile: (863) 640-8843

E-mail: david@bucknercommercial.com | Website: www.bucknercommercial.com

Information concerning this offer is from sources deemed reliable, but no warranty is made as to the accuracy thereof.

Lakeland Interstate Business Park
2855 Interstate Drive
Lakeland, Florida 33805

BUCKNER
COMMERCIAL PROPERTIES

AVAILABLE PREMISES

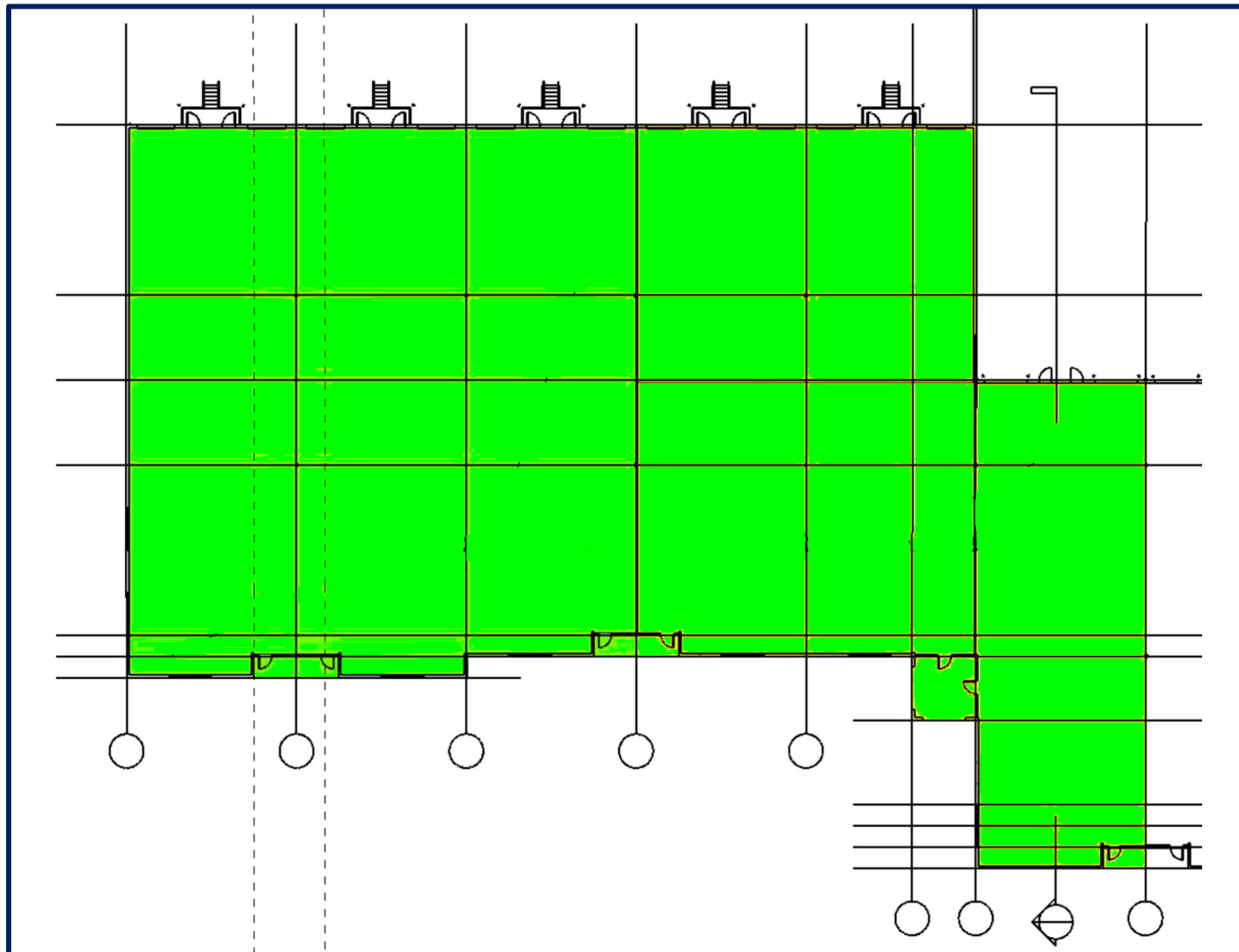

Information concerning this offer is from sources deemed reliable, but no warranty is made as to the accuracy thereof.

Lakeland Interstate Business Park
2855 Interstate Drive
Lakeland, Florida 33805

BUCKNER
COMMERCIAL PROPERTIES

SITE/BUILDING PLAN

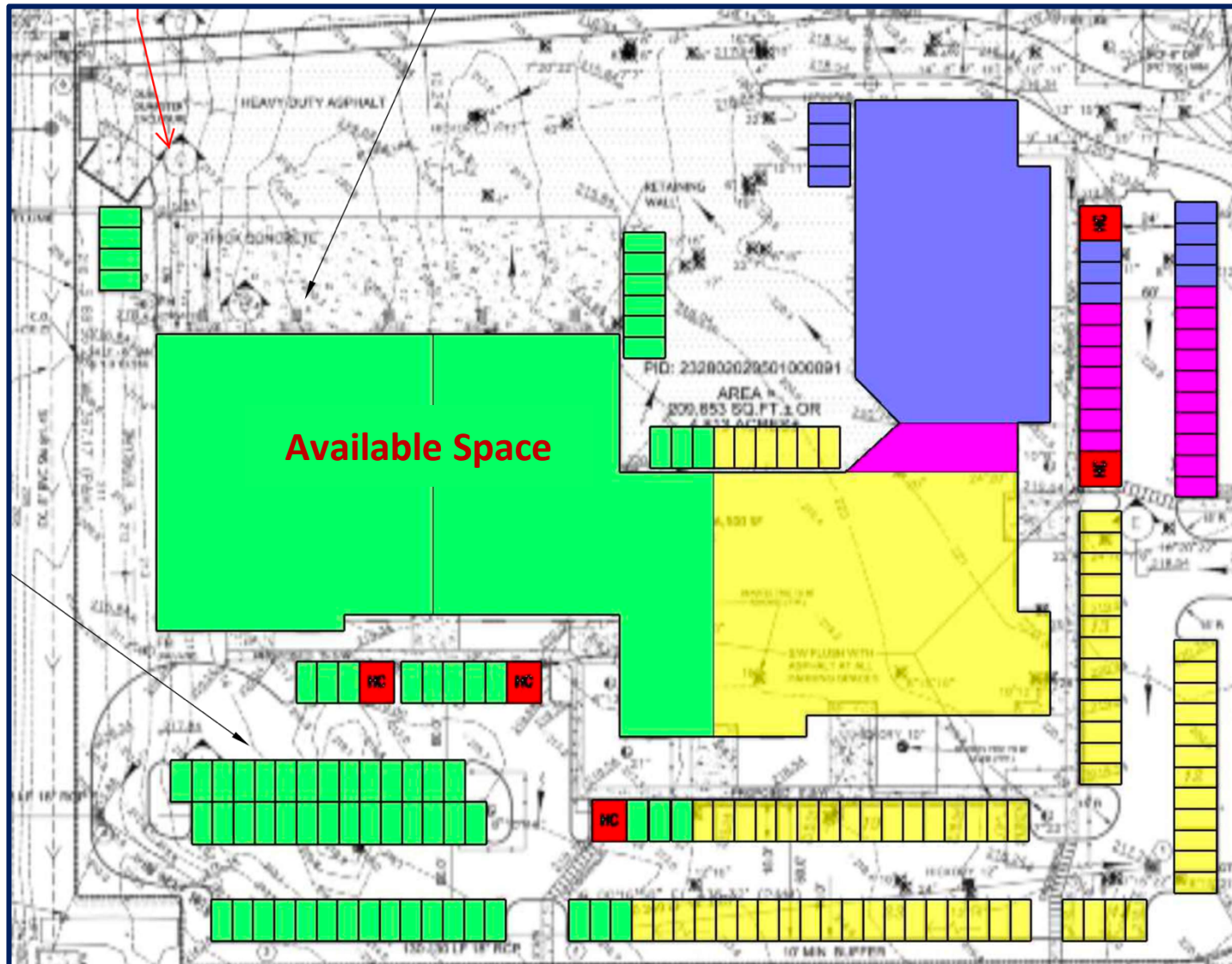

Information concerning this offer is from sources deemed reliable, but no warranty is made as to the accuracy thereof.

Lakeland Interstate Business Park
2855 Interstate Drive
Lakeland, Florida 33805

BUCKNER
COMMERCIAL PROPERTIES

AERIAL



Contact: David A. Buckner, SIOR

Office: (863) 686-7770 | Mobile: (863) 640-8843

E-mail: david@bucknercommercial.com | Website: www.bucknercommercial.com

Information concerning this offer is from sources deemed reliable, but no warranty is made as to the accuracy thereof.