

±42,875 SF FOR SALE OR LEASE | IMMEDIATE I-15 ACCESS & VISIBILITY

**CBRE**



**9455 Hyssop Dr.**  
Rancho Cucamonga, CA

# 9455 Hyssop Dr.

Is well suited for warehouse, distribution, or light industrial users seeking a functional space in a strong logistics corridor with convenient access to major transportation routes, surrounding business amenities, and a large regional labor pool.



# Building Features



± 42,875 SF  
Freestanding Building



134' secured  
truck court



±4,667 of two-  
story offices and  
restrooms



800 amp, 277/480  
volt panel



28' minimum  
clearance height



49 parking  
spaces



ESFR sprinkler  
system with K-25  
heads



Ample trailer and  
car parking spaces



2 dock high  
loading doors  
(expandable to 4)



Large secured  
yard



LED warehouse  
lighting



Freeway frontage



2 ground level  
doors



Immediate access  
to the I-15, I-10 &  
60 Freeways

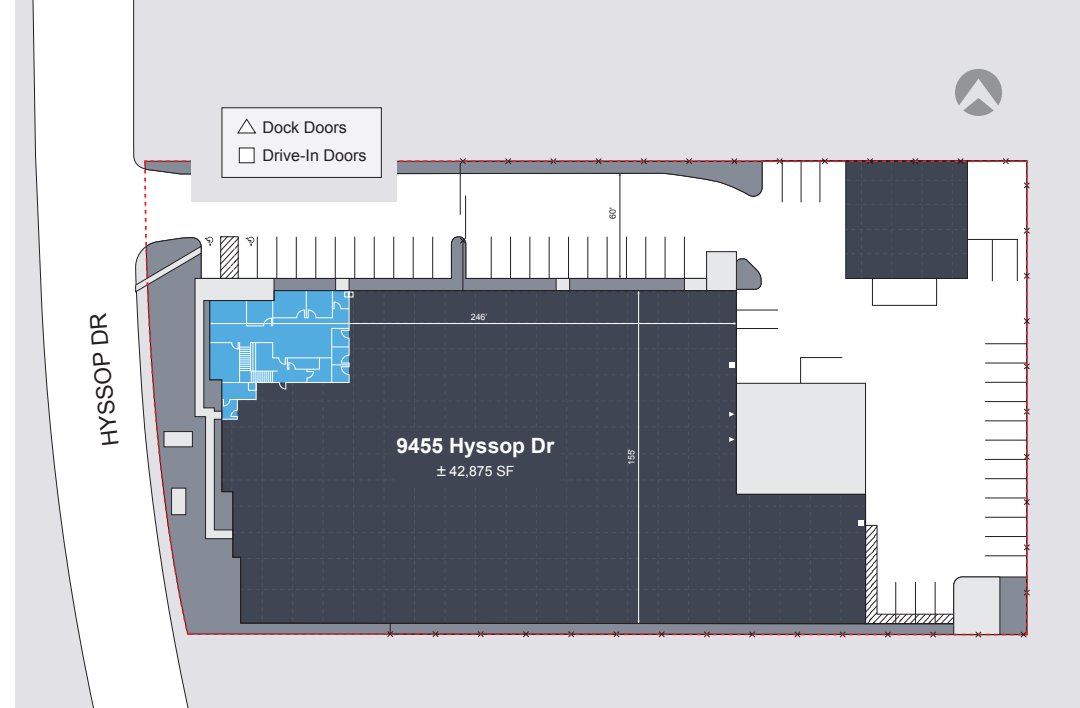



**9455**  
**Hyssop Dr.**

**FOR MORE INFORMATION, PLEASE CONTACT:**

**WES JONES**

Executive Vice President  
+1 909 418 2070  
wes.jones@cbre.com  
Lic. 01783489

**JAMES TOOMARIAN**

First Vice President  
+1 909 418 2083  
james.toomarian@cbre.com  
Lic. 02030414

**ANDREW CHAFFEE**

Senior Associate  
+1 909 418 2098  
andrew.chaffee@cbre.com  
Lic. 02168894



©2026 CBRE, Inc. All rights reserved. This information has been obtained from sources believed reliable, but has not been verified for accuracy or completeness. You should conduct a careful, independent investigation of the property and verify all information. Any reliance on this information is solely at your own risk. CBRE and the CBRE logo are service marks of CBRE, Inc. All other marks displayed on this document are the property of their respective owners, and the use of such logos does not imply any affiliation with or endorsement of CBRE. Photos herein are the property of their respective owners. Use of these images without the express written consent of the owner is prohibited.