

865 Muirfield Drive

INDUSTRIAL BUILDING FOR SUBLEASE

865 Muirfield Drive, Hanover Park, IL 60133

[Property Website](#)

±46,559 SF
for Sublease

Sublease through
April 30, 2028

Flexible Deal
Terms Available

Overflow / Short-term
Storage Available



Joe Karmin, SIOR

Executive Vice President
(847) 287-4567

joe.karmin@transwestern.com

Michael Marconi, SIOR

Sr. EVP & Designated Managing Broker
(630) 202-8636

michael.marconi@transwestern.com

The information provided herein was obtained from sources believed reliable; however, Transwestern makes no guarantees, warranties, or representations as to the completeness or accuracy thereof. The presentation of this information is submitted subject to errors, omissions, change of price or conditions, prior sale or lease, or withdrawal without notice. Copyright © 2026 Transwestern.



Property Highlights

- Sublease through April 30, 2028
- Flexible deal terms available
- Overflow/short-term storage available
- High-image, standalone facility
- Well-distributed 480 volt power
- Abundant 60-car parking
- Two mezzanine areas
- In-place office furniture available
- Close proximity to I-390 (Elgin-O'Hare Tollway)

BUILDING SIZE	±46,559 SF
LAND AREA	±3.28 AC
OFFICE SIZE	±7,272 SF
CEILING HEIGHT	24'
LOADING	4 Ext Docks / 1 DID
POWER	800A 480V
PARKING	±60 Cars
SPRINKLERS	Yes
HEATING	Gas
YEAR BUILT	1993
ZONING	I (Industrial)
CONSTRUCTION	Precast
SUBLEASE RATE	\$11.25 PSF MG

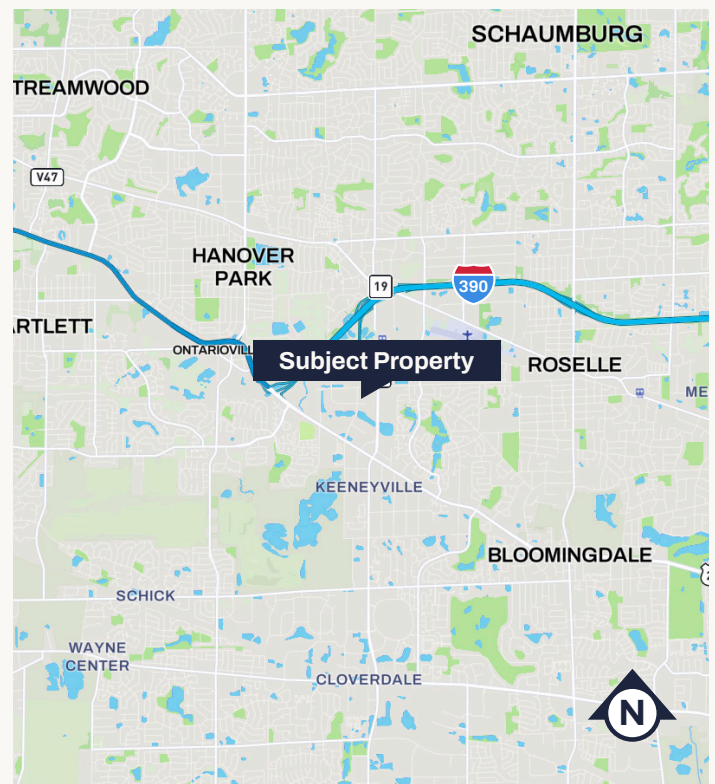

Joe Karmin, SIOR

Executive Vice President
(847) 287-4567
joe.karmin@transwestern.com

Michael Marconi, SIOR

Sr. EVP & Designated Managing Broker
(630) 202-8636
michael.marconi@transwestern.com

The information provided herein was obtained from sources believed reliable; however, Transwestern makes no guarantees, warranties, or representations as to the completeness or accuracy thereof. The presentation of this information is submitted subject to errors, omissions, change of price or conditions, prior sale or lease, or withdrawal without notice. Copyright © 2026 Transwestern.

865 Muirfield Drive

INDUSTRIAL BUILDING FOR SUBLEASE

865 Muirfield Drive, Hanover Park, IL 60133

[Property Website](#)

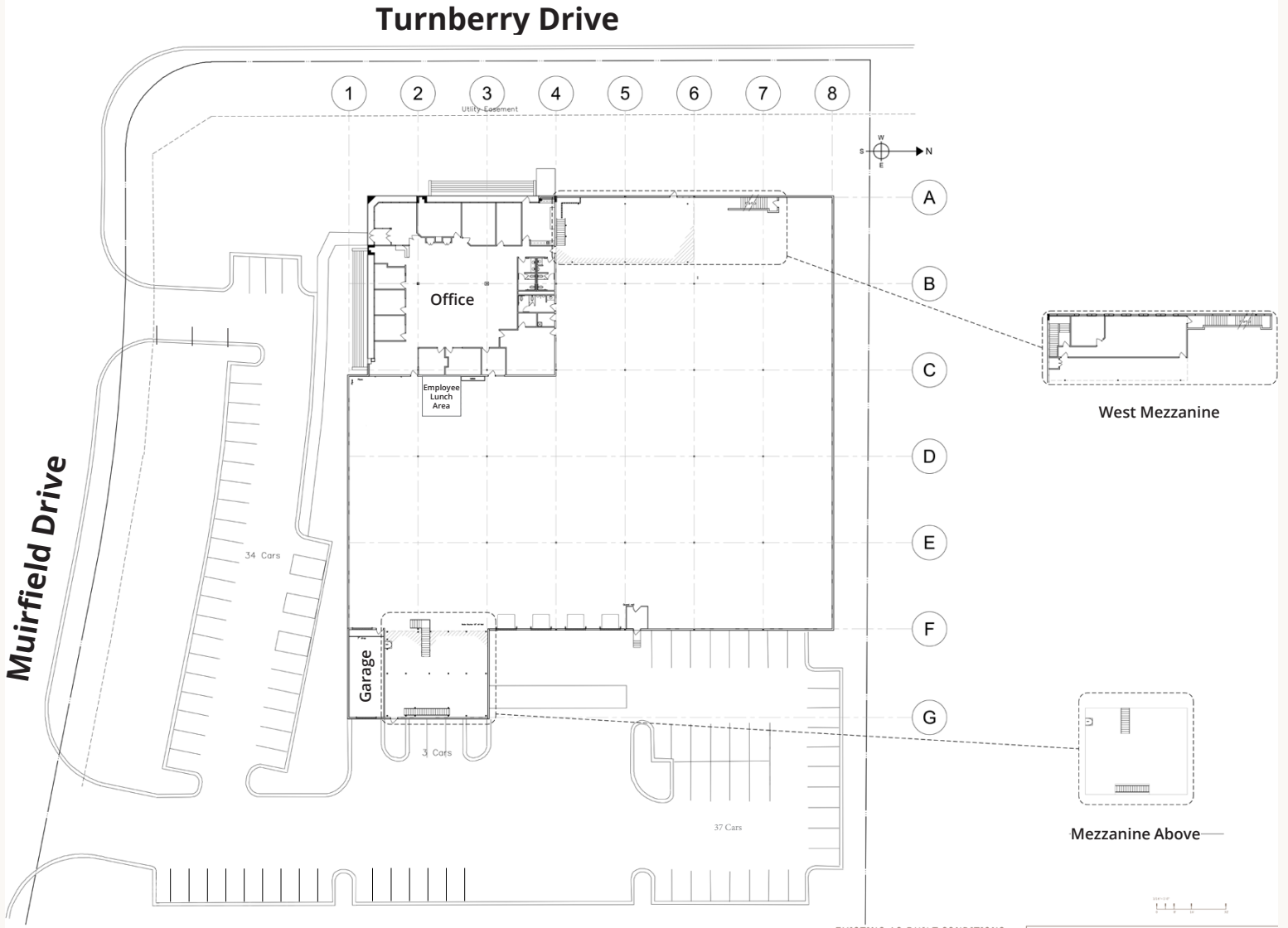

SITE PLAN

Joe Karmin, SIOR

Executive Vice President
(847) 287-4567
joe.karmin@transwestern.com

Michael Marconi, SIOR

Sr. EVP & Designated Managing Broker
(630) 202-8636
michael.marconi@transwestern.com

The information provided herein was obtained from sources believed reliable; however, Transwestern makes no guarantees, warranties, or representations as to the completeness or accuracy thereof. The presentation of this information is submitted subject to errors, omissions, change of price or conditions, prior sale or lease, or withdrawal without notice. Copyright © 2026 Transwestern.

865 Muirfield Drive

INDUSTRIAL BUILDING FOR SUBLEASE

865 Muirfield Drive, Hanover Park, IL 60133

[Property Website](#)



DRIVE-IN DOOR



LOADING DOCKS



BIRD'S EYE VIEW

Joe Karmin, SIOR

Executive Vice President
(847) 287-4567

joe.karmin@transwestern.com

Michael Marconi, SIOR

Sr. EVP & Designated Managing Broker
(630) 202-8636

michael.marconi@transwestern.com

The information provided herein was obtained from sources believed reliable; however, Transwestern makes no guarantees, warranties, or representations as to the completeness or accuracy thereof. The presentation of this information is submitted subject to errors, omissions, change of price or conditions, prior sale or lease, or withdrawal without notice. Copyright © 2026 Transwestern.