

FOR LEASE

7300

WEST BOSTON STREET



CHANDLER, AZ

CBRE

PROPERTY HIGHLIGHTS



±38,651 SF
AVAILABLE
(15,650 SF OFFICE)



BLDG: ±73,953 SF
LAND: ±6.04 ACRES



±19,419 SF
EVAP COOLED WAREHOUSE
(A/C POTENTIAL)



24' CLEAR HEIGHT



7 DOCK DOORS



PROXIMITY TO THE
LOOP 101, LOOP
202, I-10 AND US
60 FREEWAYS



13 MINUTES
FROM SKY HARBOR
INTERNATIONAL
AIRPORT



AMPLE
PARKING



EXCESS LAND
±0.85 ACRES (PARKING
OR STORAGE)



SECURE, FENCED,
PAVED YARD



RENTAL RATE
\$1.39/SF NNN



GILA RIVER INDIAN RESERVATION



ESTRELLA MOUNTAINS



PHOENIX SOUTH MOUNTAIN PRESERVE



LIV AHWATUKEE
±458 UNITS

CLEARWATER
AHWATUKEE
±137 UNITS

KOHL'S

CVS

DISCOUNT TIRE

Wendy's

McDonald's

EMERALD SUITES

7300

WEST BOSTON STREET



±77,932 VPD



BOSTON STREET

MK
TECH CENTER



SOUTHGATE DRIVE



Bashas'
DISTRIBUTION CENTER

54TH STREET



CHANDLER BOULEVARD
±28,060 VPD

GB INVESTMENTS
PROPOSED INDUSTRIAL





MAIN FLOOR OFFICE/SHOWROOM



2ND FLOOR OFFICE

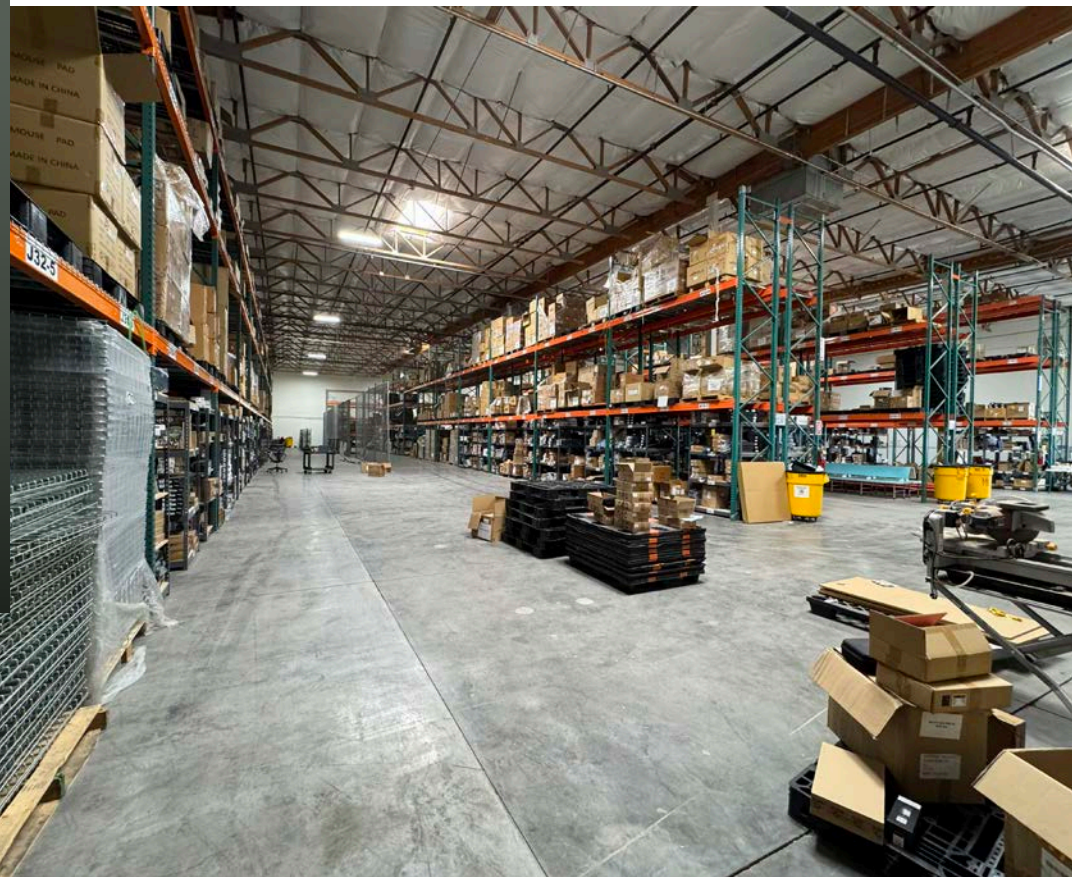
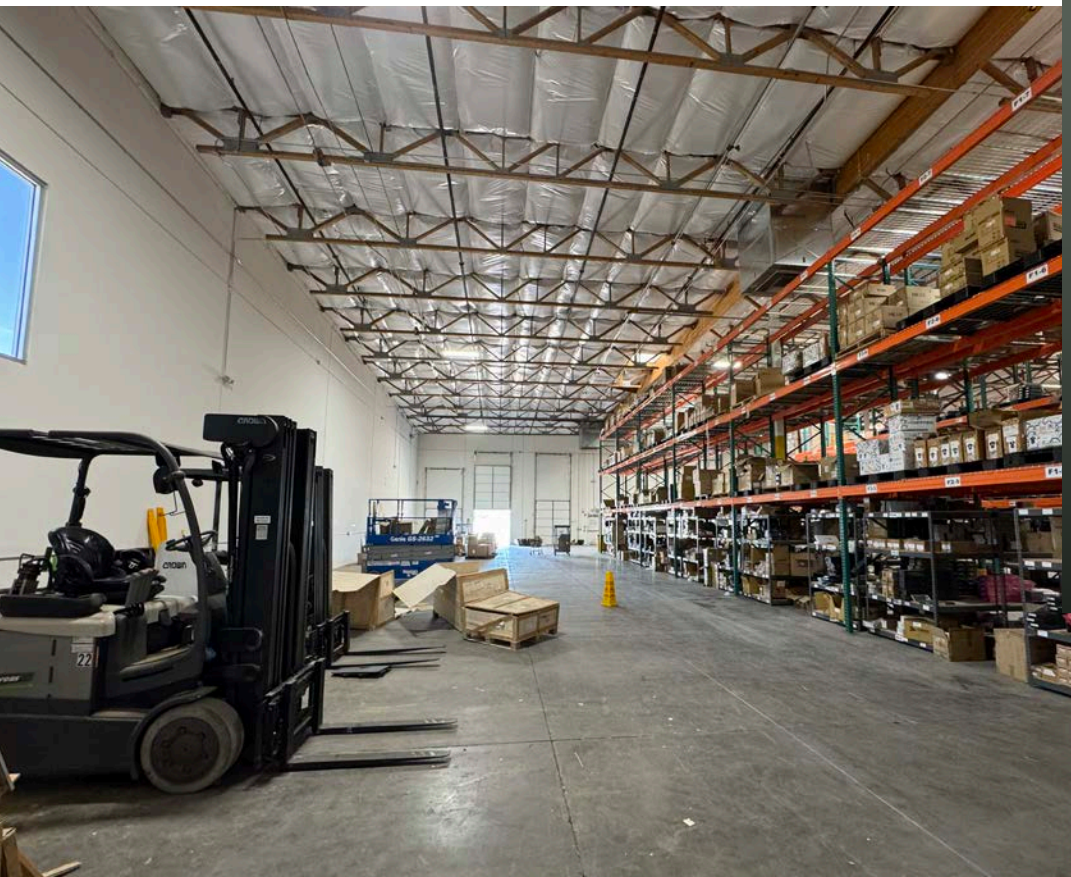

FLOOR PLAN

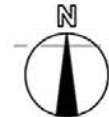
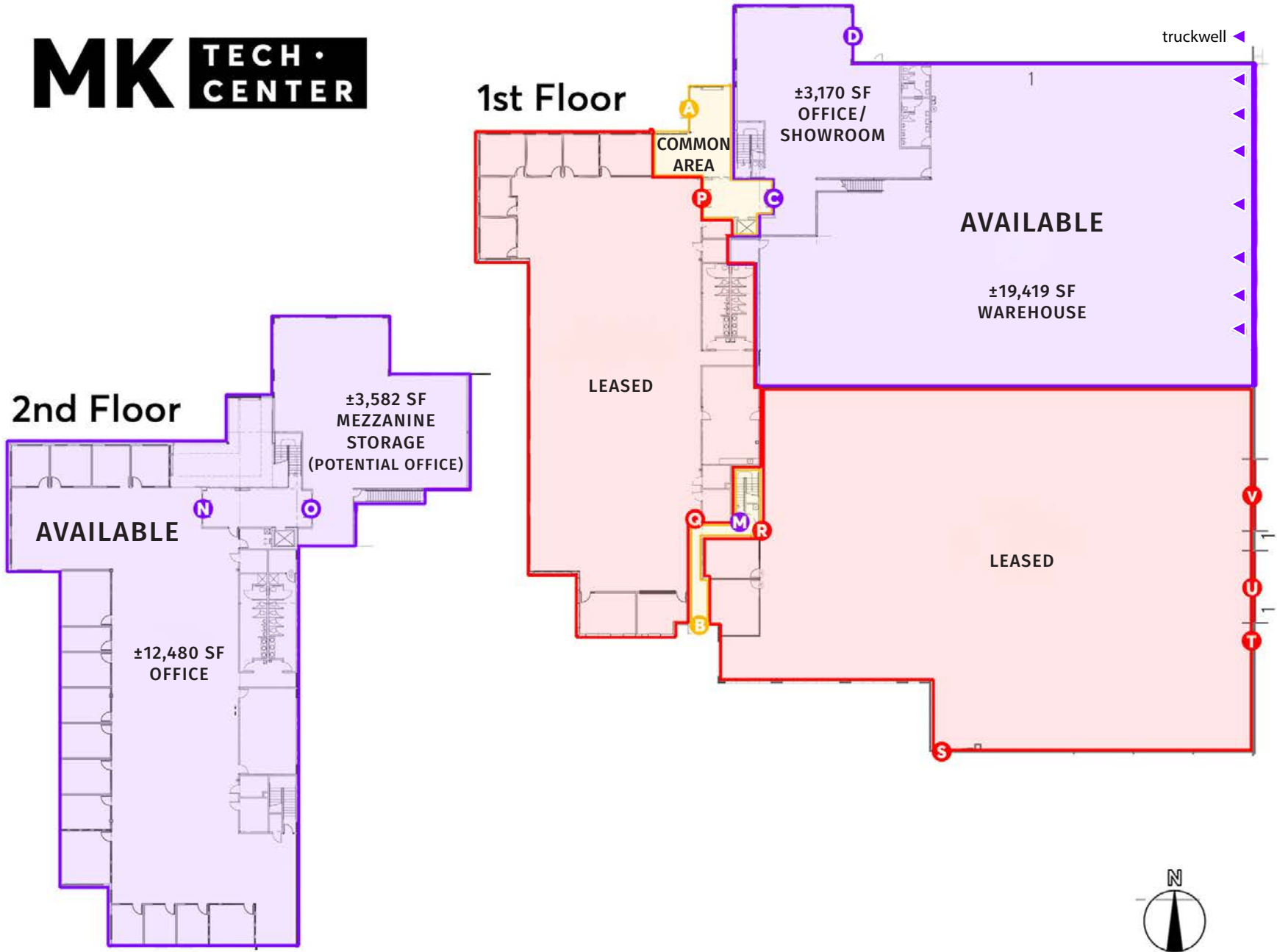



MIKE PARKER
 Executive Vice President
 +1 602 614 7877
 mike.parker6@cbre.com

EVAN KOPLAN, SIOR, CCIM
 Executive Vice President
 +1 602 614 9462
 evan.koplan@cbre.com

7300

WEST BOSTON STREET

© 2025 CBRE, Inc. All rights reserved. This information has been obtained from sources believed reliable but has not been verified for accuracy or completeness. CBRE, Inc. makes no guarantee, representation or warranty and accepts no responsibility or liability as to the accuracy, completeness, or reliability of the information contained herein. You should conduct a careful, independent investigation of the property and verify all information. Any reliance on this information is solely at your own risk. CBRE and the CBRE logo are service marks of CBRE, Inc. All other marks displayed on this document are the property of their respective owners, and the use of such marks does not imply any affiliation with or endorsement of CBRE. Photos herein are the property of their respective owners. Use of these images without the express written consent of the owner is prohibited.

