

## Building Sketch

Borrower	n/a						
Property Address	1927 E Crocus Dr						
City	Phoenix	County	Maricopa	State	AZ	Zip Code	85022
Lender/Client	Gerchick Real Estate						

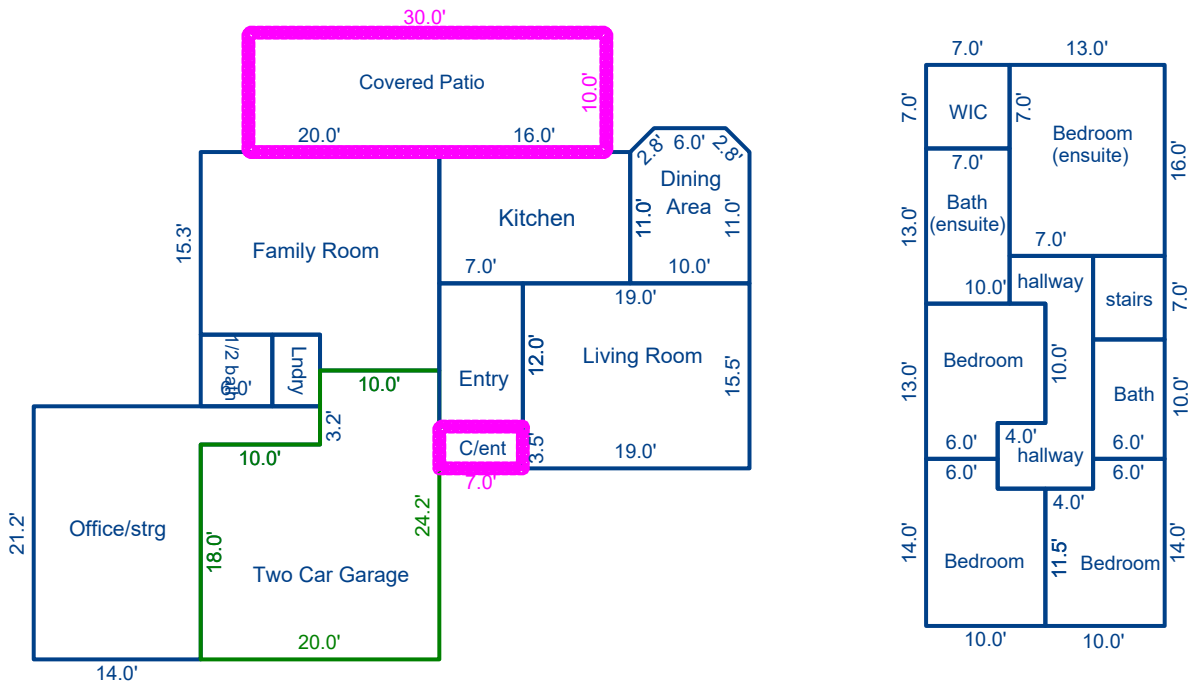

Sketch by ApexSketch

AREA CALCULATIONS SUMMARY						AREA CALCULATIONS BREAKDOWN					
Code	Description	Factor	Net Size	Perimeter	Net Totals	Name	Base x	Height x	Width =	Area	
GLA1	Office/strg	1.0	328.8	90.4	1405.3	Office/strg		21.2 x	14.0 =	296.8	
	1/2 Bath	1.0	36.0	24.0		1/2 Bath		10.0 x	3.2 =	32.0	
	Family Room	1.0	336.0	76.6		Family Room		6.0 x	6.0 =	36.0	
	Laundry	1.0	24.0	20.0		Laundry		20.0 x	15.3 =	306.0	
	Kitchen	1.0	176.0	54.0		Kitchen		10.0 x	3.0 =	30.0	
	Dining Area	1.0	126.0	43.7		Dining Area		6.0 x	2.0 =	12.0	
	Entry	1.0	84.0	38.0		Entry		0.5 x	2.8 x	1.4 =	2.0
	Living Room	1.0	294.5	69.0		Living Room		0.5 x	2.8 x	1.4 =	2.0
	Guest Bath	1.0	60.0	32.0		Guest Bath		12.0 x	7.0 =	84.0	
	Ensuite Bedroom	1.0	208.0	58.0		Ensuite Bedroom		19.0 x	3.5 =	66.5	
GLA2	WIC	1.0	49.0	28.0	WIC		19.0 x	12.0 =	228.0		
	Ensuite Bath	1.0	91.0	40.0	Ensuite Bath		11.5 x	10.0 =	115.0		
	Bedroom	1.0	118.0	46.0	Bedroom		6.0 x	2.5 =	15.0		
	staircase	1.0	42.0	26.0	staircase						
	Bedroom	1.0	130.0	48.0	Bedroom						
	Hallway	1.0	112.0	61.0	Hallway						
	4 addl items				4 addl items						
	Net LIVABLE	cnt	17	(rounded)	2,345	Net LIVABLE			(rounded)	2,345	
						28 total items					