



## Kensington Park

7610-7644 Lyndale Avenue South, Minneapolis, MN 55423

### Property Description

Kensington Park is a premier mixed-use center that includes a mix of national and local tenants, with Potbelly and Chipotle anchoring the center. The property has excellent visibility along Lyndale Avenue with combined traffic counts exceeding 32,000 VPD. Kensington adjacent to the premier Shops At Lyndale Center home to Sierra, Best Buy, Golf Galaxy, Aldi, Lands End, Burlington, and PetSmart.

### Property Highlights

- Former restaurant space available!
- One block north of I-494 which sees over 140,000 VPD
- Over 116,000 residents within 3 miles
- Daytime population of over 165,000 people within 3 miles
- Parking ratio of 5.1 per 1,000
- 150 luxury condominiums above building



### Building Summary

Building Size:	28,135 SF
Available SF:	1,633 - 2,532 SF
Lease Rate:	Negotiable
Operating Expenses:	\$17.50/SF



# Site Plan

## Kensington Park

7610-7644 Lyndale Avenue South, Minneapolis, MN 55423

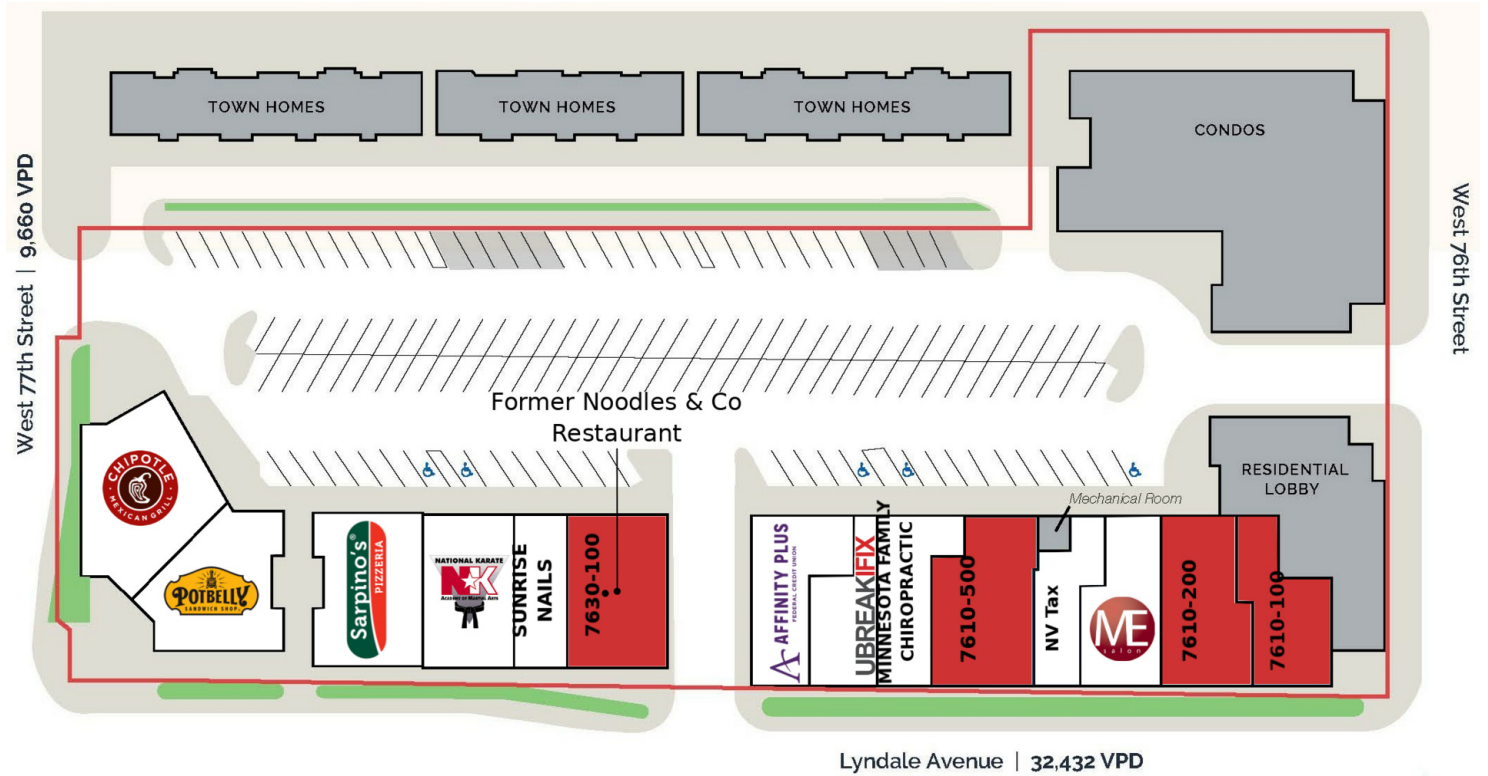

SUITE	TENANT NAME	SPACE SIZE	SUITE	TENANT NAME	SPACE SIZE
7644-200	Chipotle	3,077 SF	7610-700	uBreakiFix	1,344 SF
7644-100	Potbelly	2,611 SF	7610-600	Minnesota Family Chiropractic	1,759 SF
7630-400	Sarpino's Pizza	1,903 SF	<b>7610-500</b>	<b>Available</b>	<b>2,532 SF</b>
7630-300	National Karate	2,089 SF	7610-400	NV Tax	1,324 SF
7630-200	Sunrise Nails	1,192 SF	7610-300	Mark Evans Salon	1,932 SF
<b>7630-100</b>	<b>Available</b>	<b>2,452 SF</b>	<b>7610-200</b>	<b>Available</b>	<b>1,987 SF</b>
7610-800	Affinity Plus Credit Union	1,700 SF	<b>7610-100</b>	<b>Available</b>	<b>1,633 SF</b>

Tim Maly  
614.358.2089  
tmaly@goblackgate.com



# Additional Photos

## Kensington Park

7610-7644 Lyndale Avenue South, Minneapolis, MN 55423



Tim Maly  
614.358.2089  
tmaly@goblackgate.com



The information contained herein was obtained from sources believed reliable; however, Black Gate Partners LLC makes no guarantees, warranties, or representations as to the completeness or accuracy thereof. The presentation of this property is submitted subject to errors, omissions, change of price or conditions prior to sale or lease, or withdrawal without notice.

# Additional Photos

## Kensington Park

7610-7644 Lyndale Avenue South, Minneapolis, MN 55423



Tim Maly  
614.358.2089  
tmaly@goblackgate.com



The information contained herein was obtained from sources believed reliable; however, Black Gate Partners LLC makes no guarantees, warranties, or representations as to the completeness or accuracy thereof. The presentation of this property is submitted subject to errors, omissions, change of price or conditions prior to sale or lease, or withdrawal without notice.

# Aerial

## Kensington Park

7610-7644 Lyndale Avenue South, Minneapolis, MN 55423



Tim Maly  
614.358.2089  
tmaly@goblackgate.com



# Aerial

## Kensington Park

7610-7644 Lyndale Avenue South, Minneapolis, MN 55423



Tim Maly  
614.358.2089  
tmaly@goblackgate.com

 BlackGate

The information contained herein was obtained from sources believed reliable; however, Black Gate Partners LLC makes no guarantees, warranties, or representations as to the completeness or accuracy thereof. The presentation of this property is submitted subject to errors, omissions, change of price or conditions prior to sale or lease, or withdrawal without notice.

# Demographics Map & Report

## Kensington Park

7610-7644 Lyndale Avenue South, Minneapolis, MN 55423

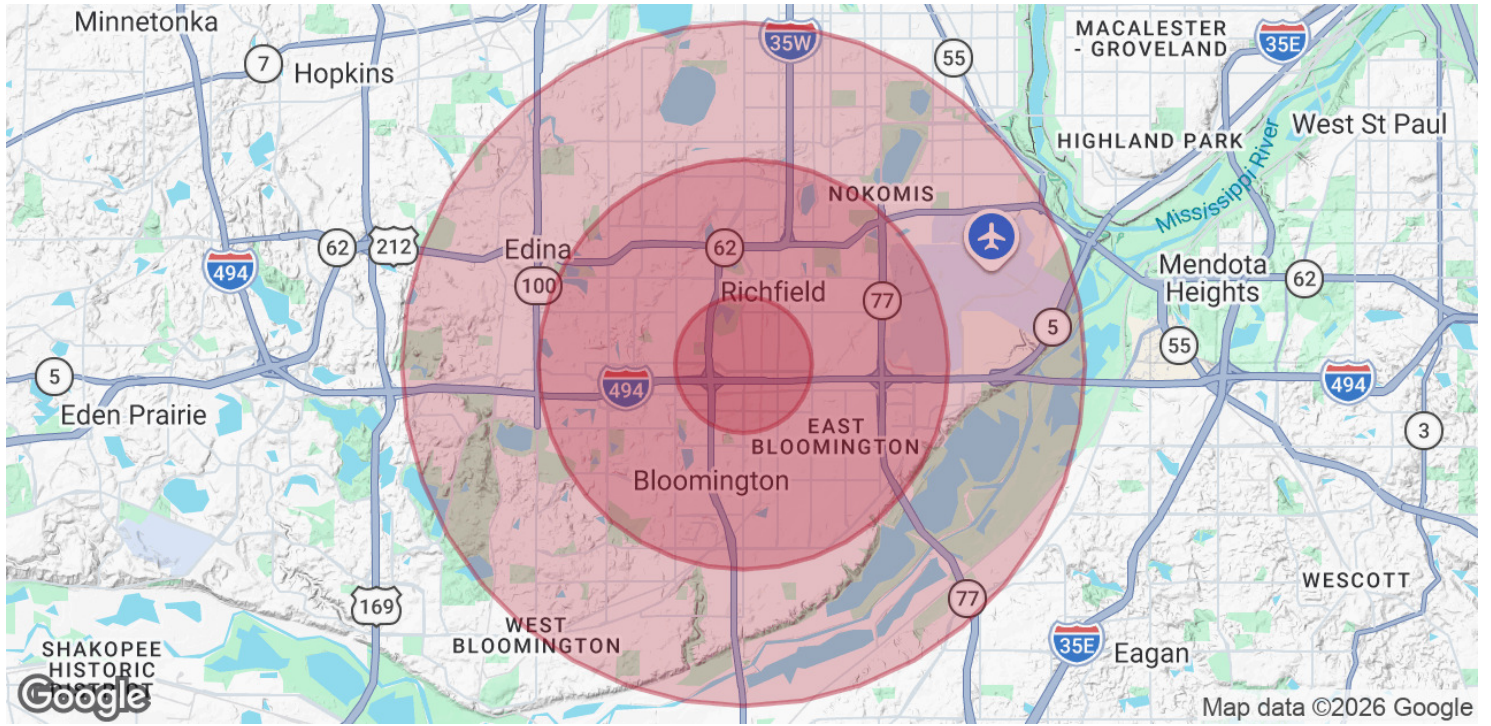

<b>POPULATION</b>	<b>1 MILE</b>	<b>3 MILES</b>	<b>5 MILES</b>
Total Population	11,164	115,587	243,040
Average Age	41	41	41
Average Age (Male)	39	40	40
Average Age (Female)	42	42	42
<b>HOUSEHOLDS &amp; INCOME</b>	<b>1 MILE</b>	<b>3 MILES</b>	<b>5 MILES</b>
Total Households	4,785	49,535	102,204
# of Persons per HH	2.3	2.3	2.4
Average HH Income	\$107,137	\$118,879	\$142,141
Average House Value	\$346,242	\$389,562	\$477,801

Demographics data derived from AlphaMap