

HIGH-TECH EDUCATION SPACE

# Kaslo East

2808 Bradfield Court

FOR SUBLEASE

---

## THE OPPORTUNITY

# 2808 Bradfield Court

Kaslo East offers two turnkey sublease opportunities on the 4th and 6th floors, each purpose-built for educational use. Both floors feature modern layouts with high-end finishes, built-in furnishings, and an efficient mix of classrooms and collaborative spaces. The spaces are equipped with infrastructure for video, sound, and recording, while the 6th floor also includes a raised floor to support future adaptability.

Units	4th Floor & 6th Floor
Area	~12,000–24,000 SF
Term	5 Years, or longer
Availability	Available with Notice
Basic Rent	Contact Listing Agent
Additional Rent	\$19.25 PSFPA (2026 est.)
Furniture	Brand New

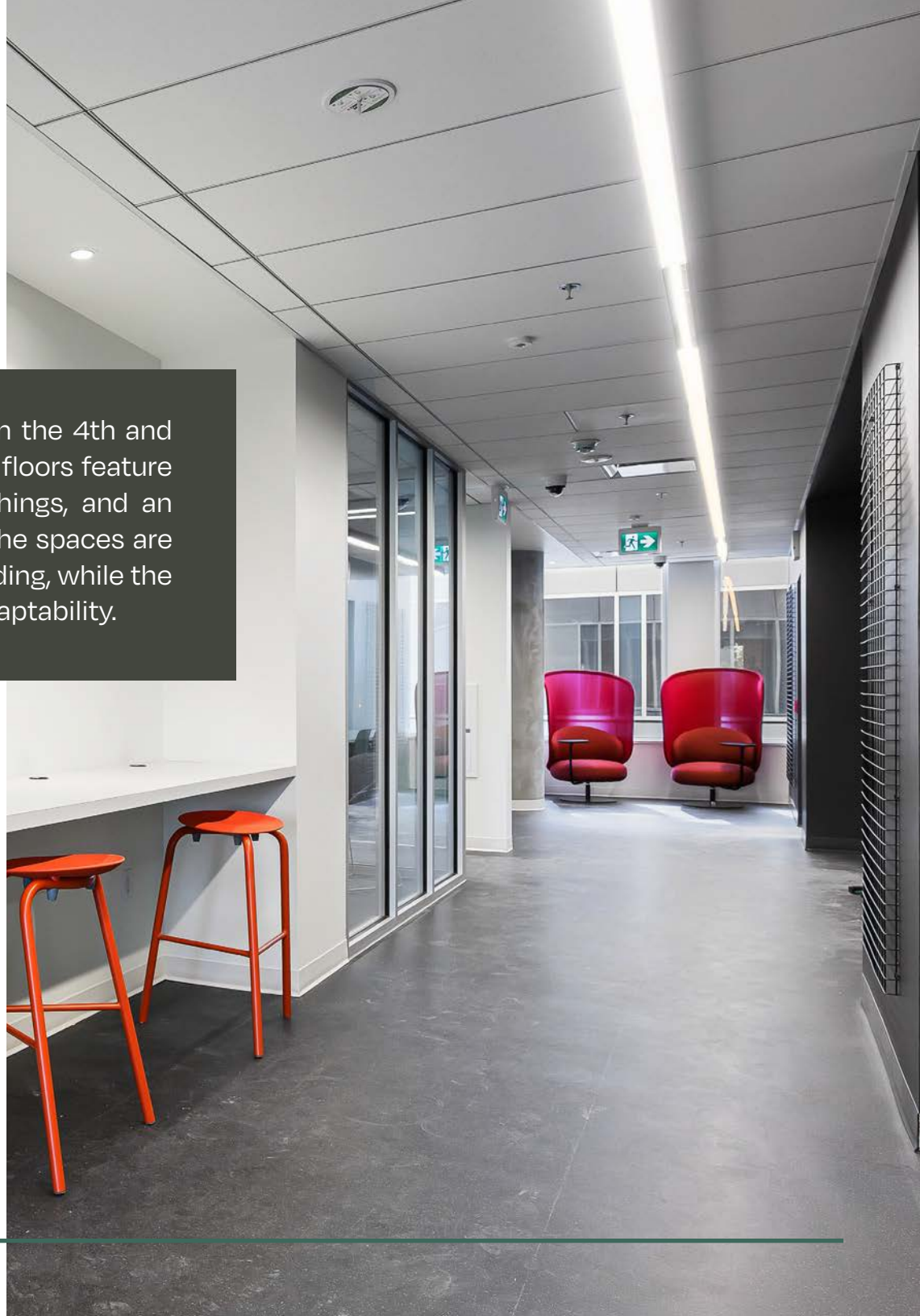

## THE LOCATION

Kaslo East at 2808 Bradfield Court offers a rare turnkey sublease in Vancouver's Renfrew District, just a 2-minute walk from Renfrew SkyTrain Station. Located on a transit-oriented campus with excellent accessibility and shared amenities including a rooftop venue, event space, and food services, this is a unique opportunity to secure fully improved, school-ready space.



KASLO EAST

2  
MIN



RENFREW STATION

# FLOOR PLAN

4th Floor | ~12,000 SF



[Virtual Tour](#)

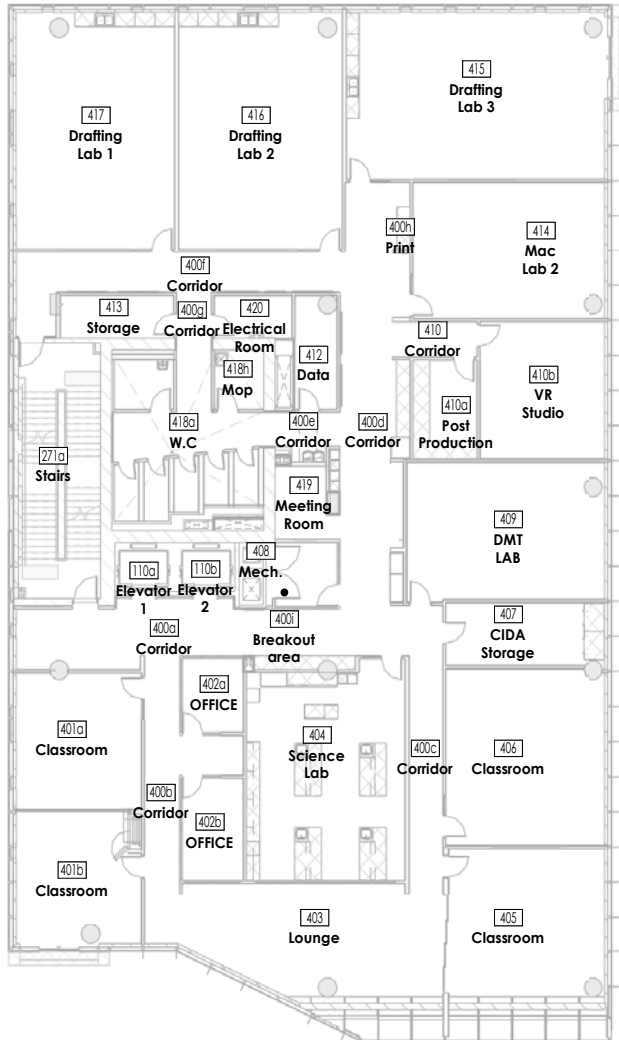

# FLOOR PLAN

6th Floor | ~12,000 SF



[Virtual Tour](#)

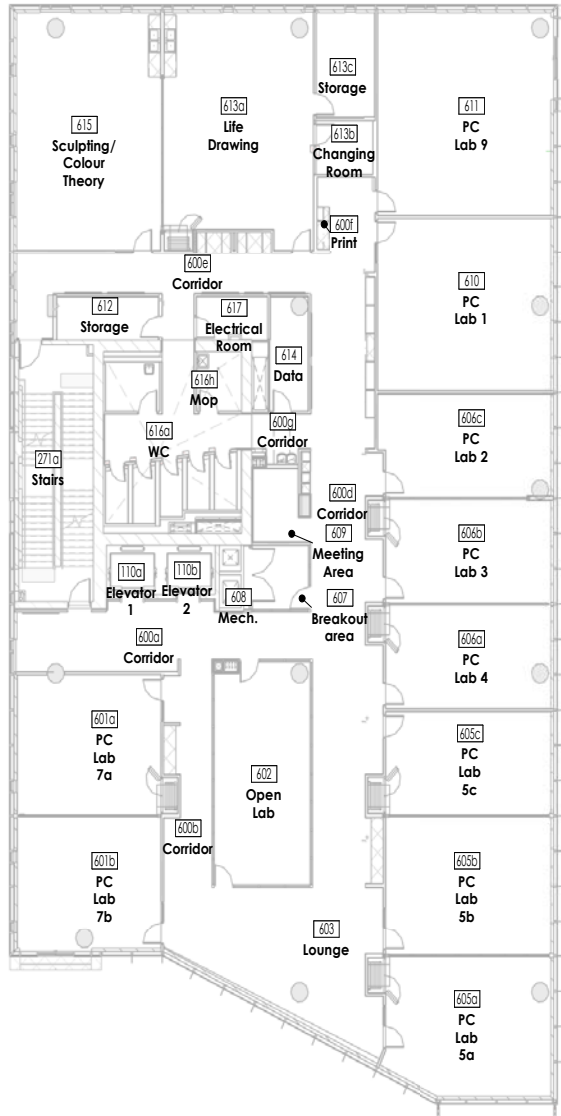



Common Area

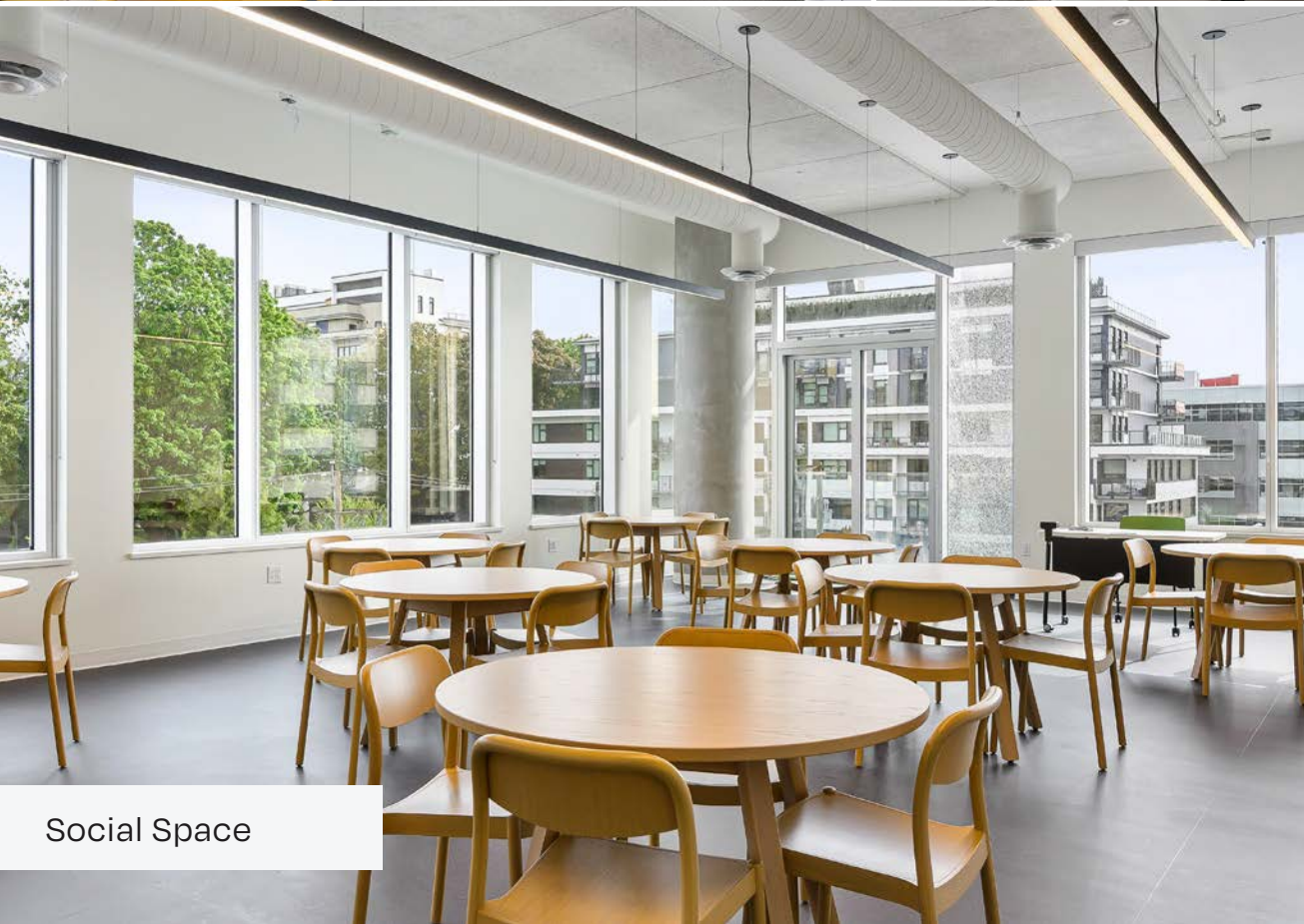

Social Space



Classroom



Lounge Area



Common Area



Classroom

## THE BUILDING

# Cutting-Edge Design with Exceptional Features

- Purpose-built educational space with brand new improvements and furniture
- Cutting-edge infrastructure for video, sound, recording, and seamless BYOD
- Access to spacious, furnished skyview deck with unparalleled North Shore views
- Full glazing and 12' ceilings create a bright, open environment - 85% of the building receives natural daylight
- 18 meeting rooms and breakout spaces
- 18 movable walls for flexible configurations
- Potential access to specialized spaces for culinary, media and recording arts, design, photography, drama, and rooftop horticulture

Rooftop Seating Area

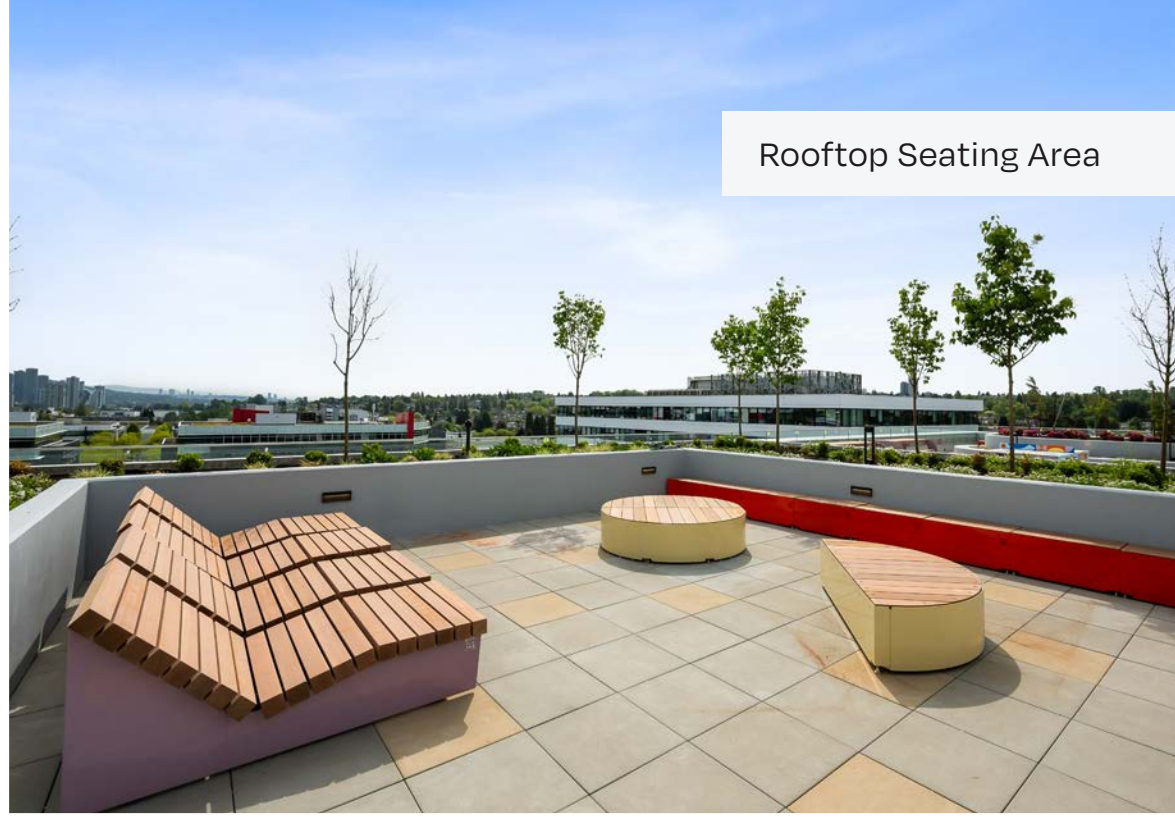

Rooftop Deck



## THE BUILDING

# Wellness, Sustainability & Shared Campus Benefits

- LEED® Gold, Fitwel, and Rick Hansen certified
- Ample onsite parking, including EV charging stalls
- Shared lobby, rooftop venue, and event space with suspended theatre
- On-site food services, café, bookstore, and student commons
- Rooftop planters for growing food or horticulture

Rooftop View



Rooftop Garden

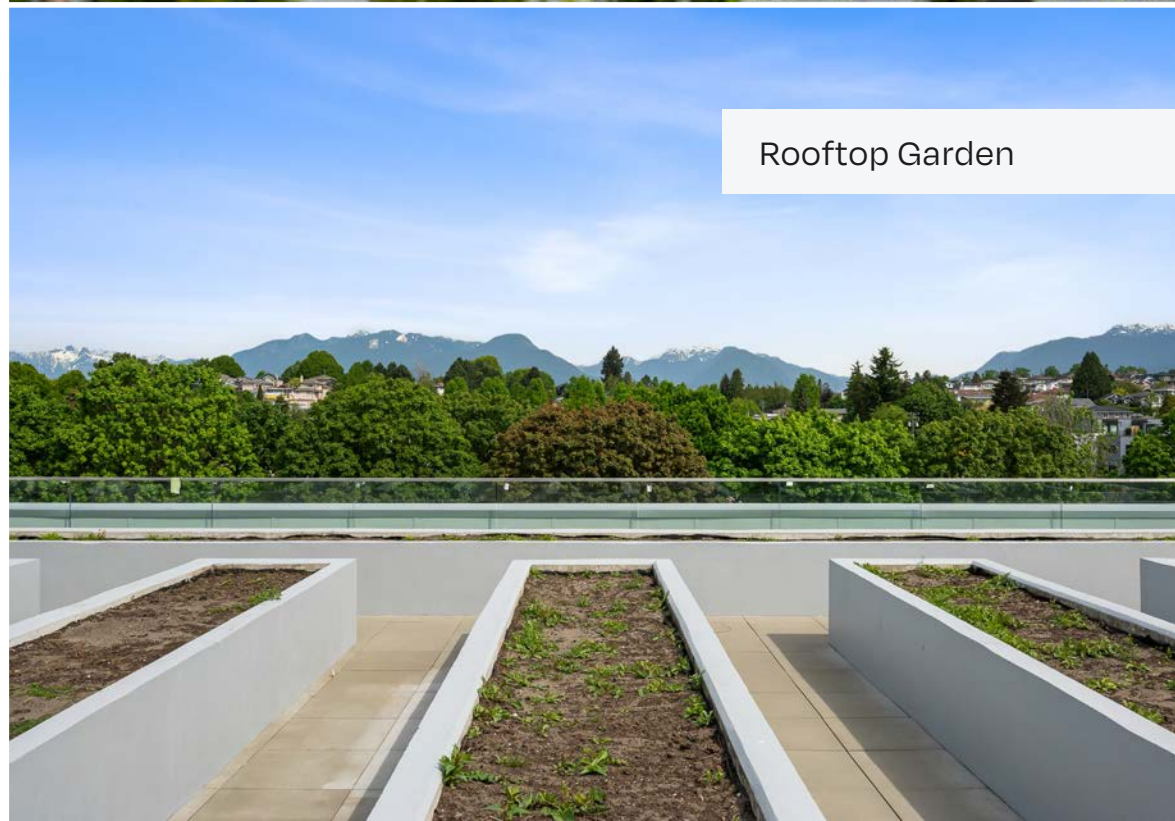



## LOCAL AMENITIES



Renfrew Station

1. T&T Supermarket
2. Staples
3. Walmart
4. Whole Foods Market
5. The Amazing Brentwood
6. Sopra Sotto Pizzeria
7. Subway
8. RBC Royal Bank
9. Breka Bakery & Cafe

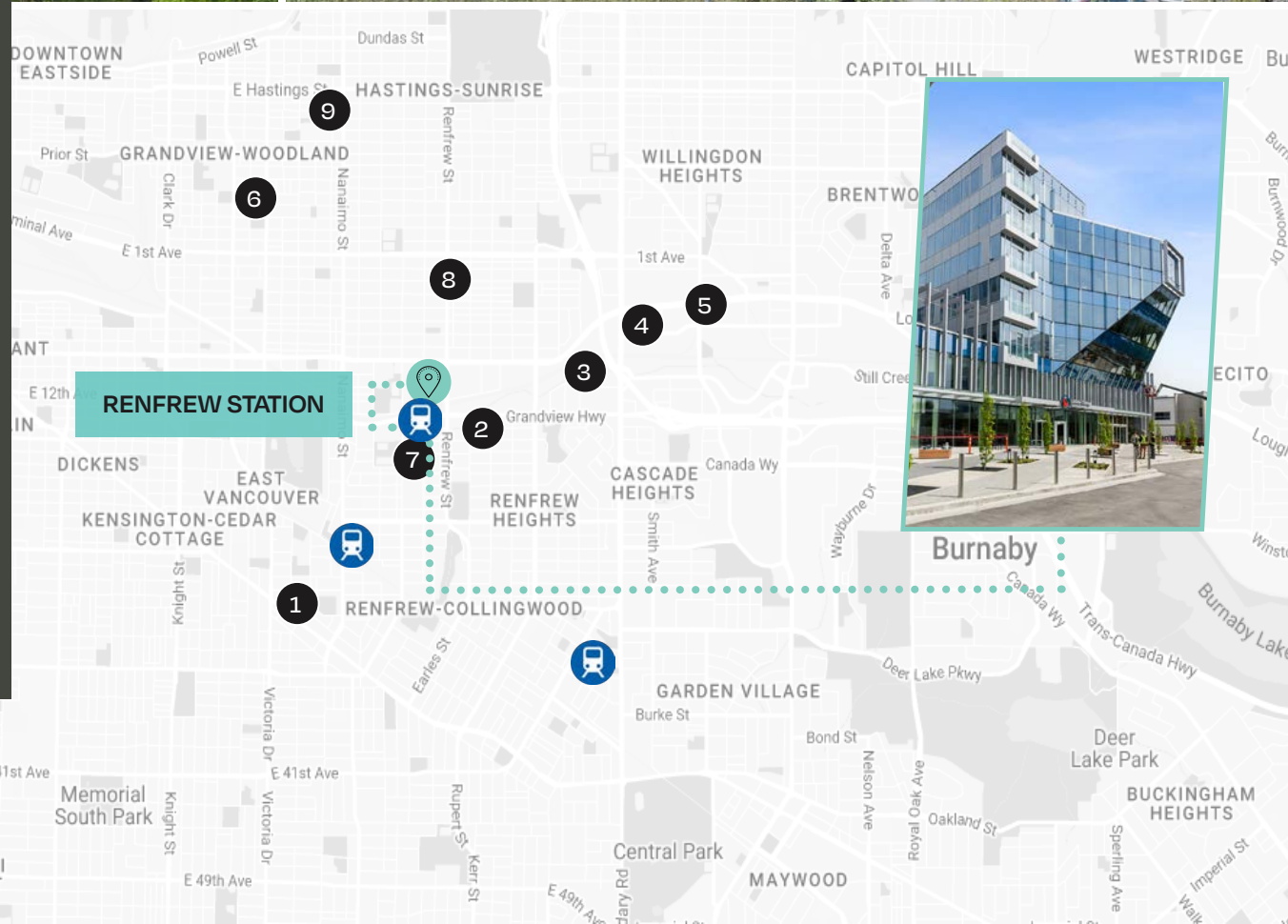



For more information, please contact:

## Willow King

Personal Real Estate Corporation

**ASSOCIATE VICE PRESIDENT**

+1 604 210 2150

[willow@floorspace.ca](mailto:willow@floorspace.ca)

## Matt Carlson

Personal Real Estate Corporation

**EXECUTIVE MANAGING DIRECTOR**

+1 604 328 4603

[matt@floorspace.ca](mailto:matt@floorspace.ca)

---

## FLOORSPACE

900 West Hastings, Suite 520

Vancouver, BC Canada

V6C 1E5

[www.floorspace.ca](http://www.floorspace.ca)

THIS DOCUMENT HAS BEEN PREPARED BY FLOORSPACE COMMERCIAL INC. FOR ADVERTISING AND GENERAL INFORMATION ONLY. ALL INFORMATION CONTAINED HEREIN IS FROM SOURCES WE DEEM RELIABLE, AND WE HAVE NO REASON TO DOUBT ITS ACCURACY; HOWEVER, NO GUARANTEE OR RESPONSIBILITY IS ASSUMED THEREOF, AND IT SHALL NOT FORM ANY PART OF FUTURE CONTRACTS. PROPERTY INFORMATION IS SUBMITTED SUBJECT TO ERRORS AND OMISSIONS AND ALL INFORMATION SHOULD BE CAREFULLY VERIFIED. ANY INTERESTED PARTY SHOULD UNDERTAKE THEIR OWN INQUIRIES AS TO THE ACCURACY OF THE INFORMATION. ALL MEASUREMENTS QUOTED HEREIN ARE APPROXIMATE. THIS PUBLICATION IS THE COPYRIGHTED PROPERTY OF FLOORSPACE COMMERCIAL INC. AND/OR ITS LICENSOR(S). COPYRIGHT © 2026 FLOORSPACE COMMERCIAL INC.

