



463 Etheridge Blvd
Canal Fulton, Ohio 44614

LEASE RATE	\$3,000/mo/+ gas & electric
AVAILABLE SQ FT	3,000
YEAR BUILT	1986
PARCELS	9502534
ZONING	B2
ACRES	1.05
CLEAR HEIGHT	12'
OVERHEAD DOORS	4 - 12' x 12'

Property Features

- 3,000/SF warehouse space available in Canal Fulton.
- Dimensions 60' x 50'.
- Single office with restroom.
- 3 Phase 200 Amp service.
- Overhead radiant tube heating.
- Additional 650/SF of covered exterior storage space.
- Large parking field can be utilized for additional exterior storage.

Joe Jackson

330 933 6349
joe@naispring.com

463 Etheridge Blvd

Canal Fulton, Ohio 44614

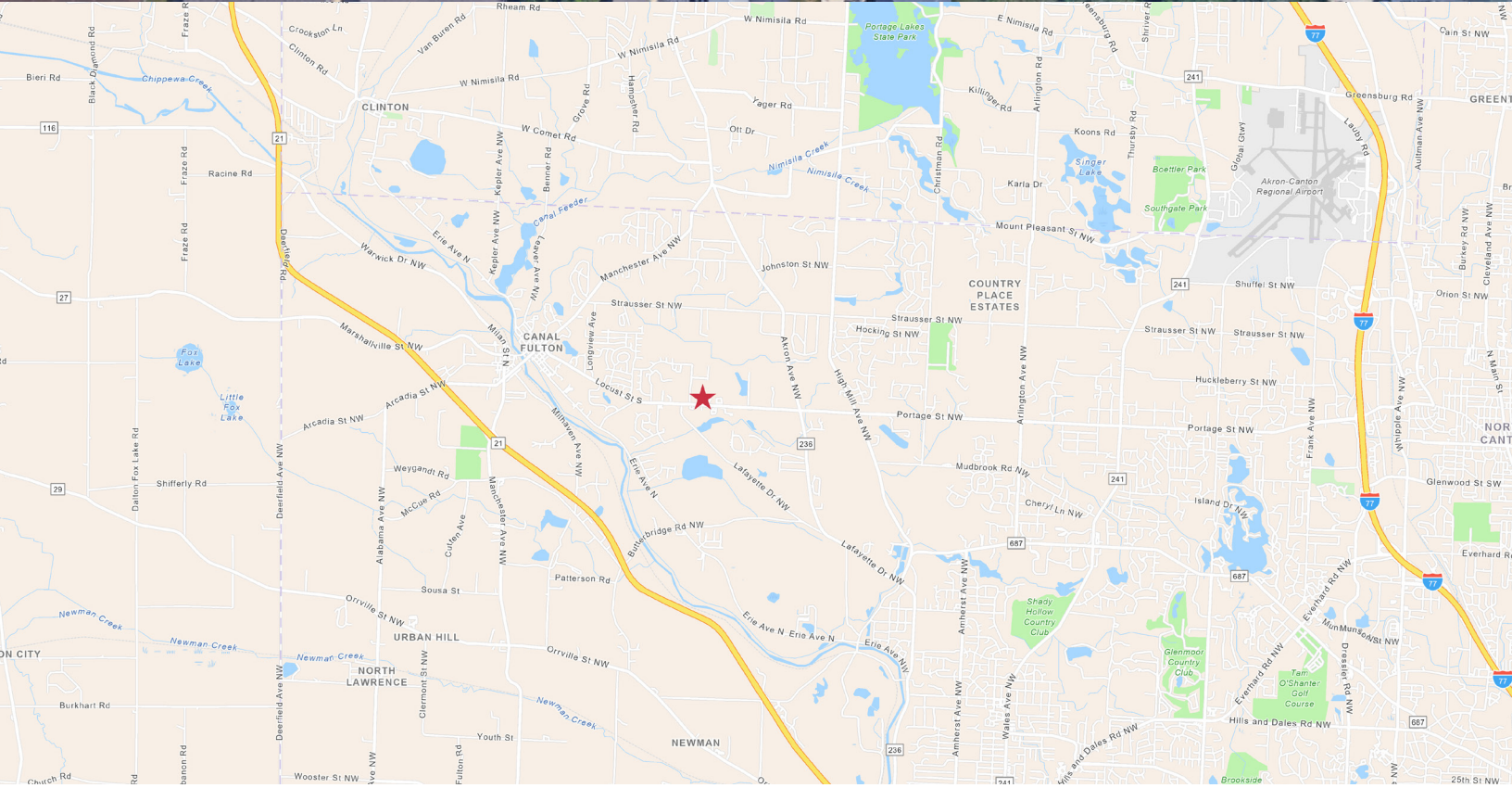

NO WARRANTY OR REPRESENTATION, EXPRESS OR IMPLIED, IS MADE AS TO THE ACCURACY OF THE INFORMATION CONTAINED HEREIN, AND THE SAME IS SUBMITTED SUBJECT TO ERRORS, OMISSIONS, CHANGE OF PRICE, RENTAL OR OTHER CONDITIONS, PRIOR SALE, LEASE OR FINANCING, OR WITHDRAWAL WITHOUT NOTICE, AND OF ANY SPECIAL LISTING CONDITIONS IMPOSED BY OUR PRINCIPALS NO WARRANTIES OR REPRESENTATIONS ARE MADE AS TO THE CONDITION OF THE PROPERTY OR ANY HAZARDS CONTAINED THEREIN ARE ANY TO BE IMPLIED.

8234 Pittsburg Ave NW
North Canton, OH 44720
+1 330 966 8800
naispring.com