



CONTINUOUS CAMPUS

10200 & 10201 Abilities Way, Kansas City, KS 66111





370,689 SF
PLUG-AND PLAY
SPACE AVAILABLE



FIRST CLASS
AMENITIES



EXCELLENT
LOCATION



The Continuous Campus stands as a prominent fixture in Kansas City, offering an impressive 648,000 square feet of prime real estate. This expansive property currently has 380,927 square feet of Class A office space available for lease, presenting a significant opportunity for businesses seeking flexible space solutions. The Continuous Campus is poised to become a dynamic hub for various industries, fostering collaboration and innovation in the heart of Kansas City's business landscape.

FIRST CLASS AMENITIES



SMALL MEETING SPACE



HUDDLE ROOM



FITNESS CENTER



CAFETERIA



FITNESS CENTER



SHARED COVERED DOCK



POTENTIALLY SHARED CONFERENCE CENTER



CONFERENCE ROOM



CAFÉ SEATING

AVAILABILITIES

10200 ABILITIES WAY – NORTH BUILDING

Floors 1-5 are available: 126,861 SF contiguous

*All square footages are approximate and subject to further verification



INTERIOR GLASS OFFICES

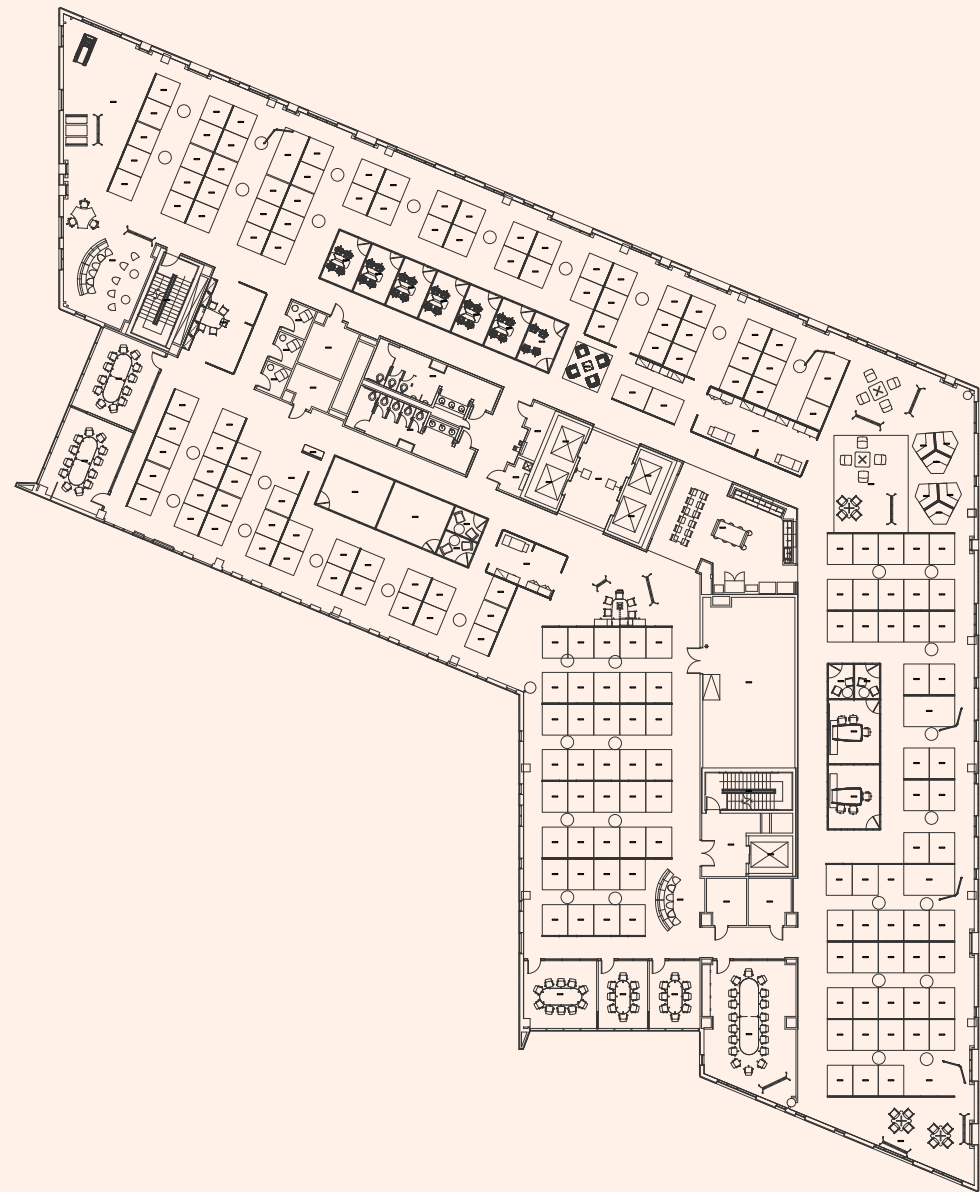

3RD FLOOR – 31,718 SF

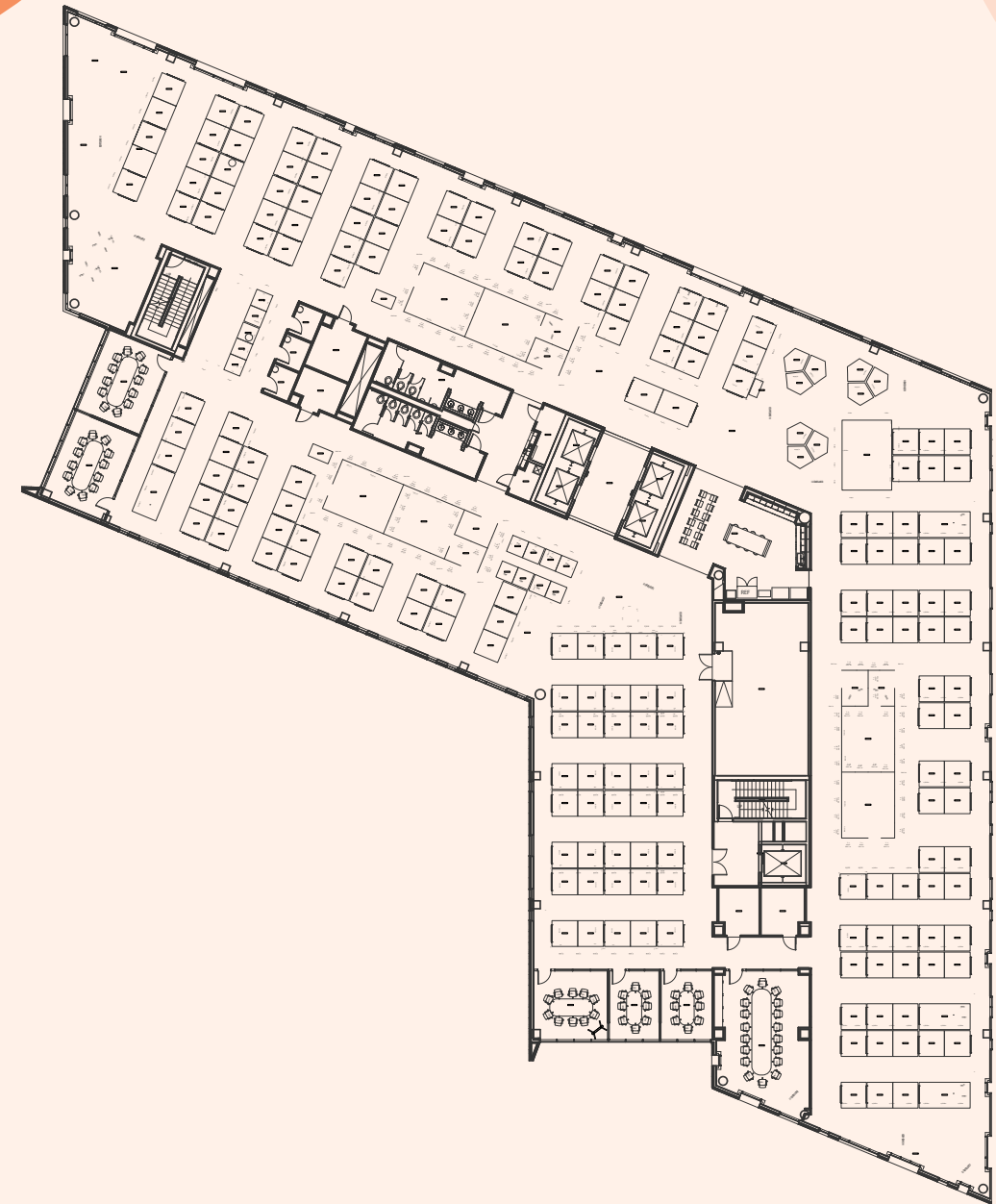

4TH FLOOR – 31,698 SF

AVAILABILITIES

10200 ABILITIES WAY – NORTH BUILDING

Floors 1-5 are available: 126,861 SF contiguous

*All square footages are approximate and subject to further verification

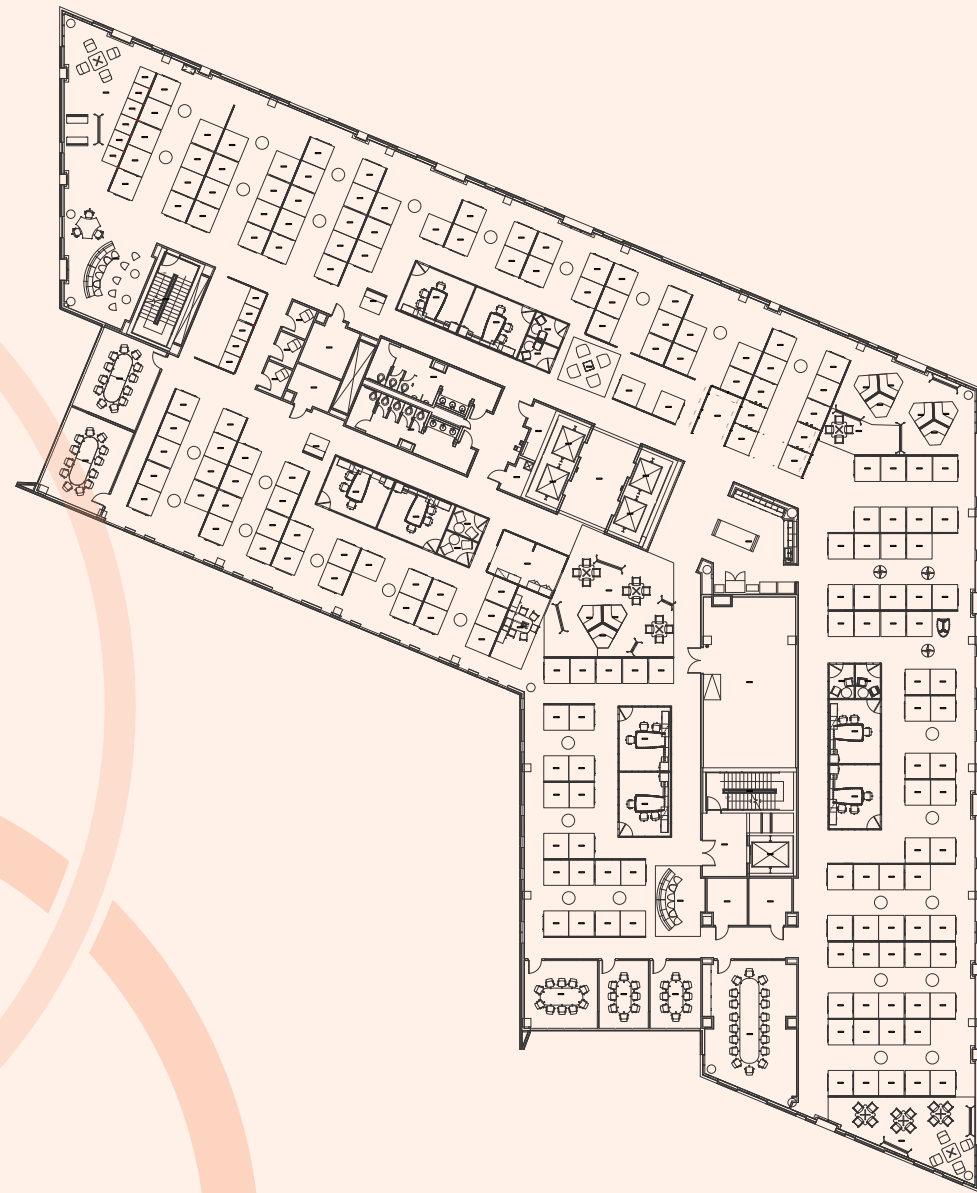

5TH FLOOR – 31,723 SF

10201 ABILITIES WAY – SOUTH BUILDING

Entire building available: 243,828 SF

*All square footages are approximate and subject to further verification

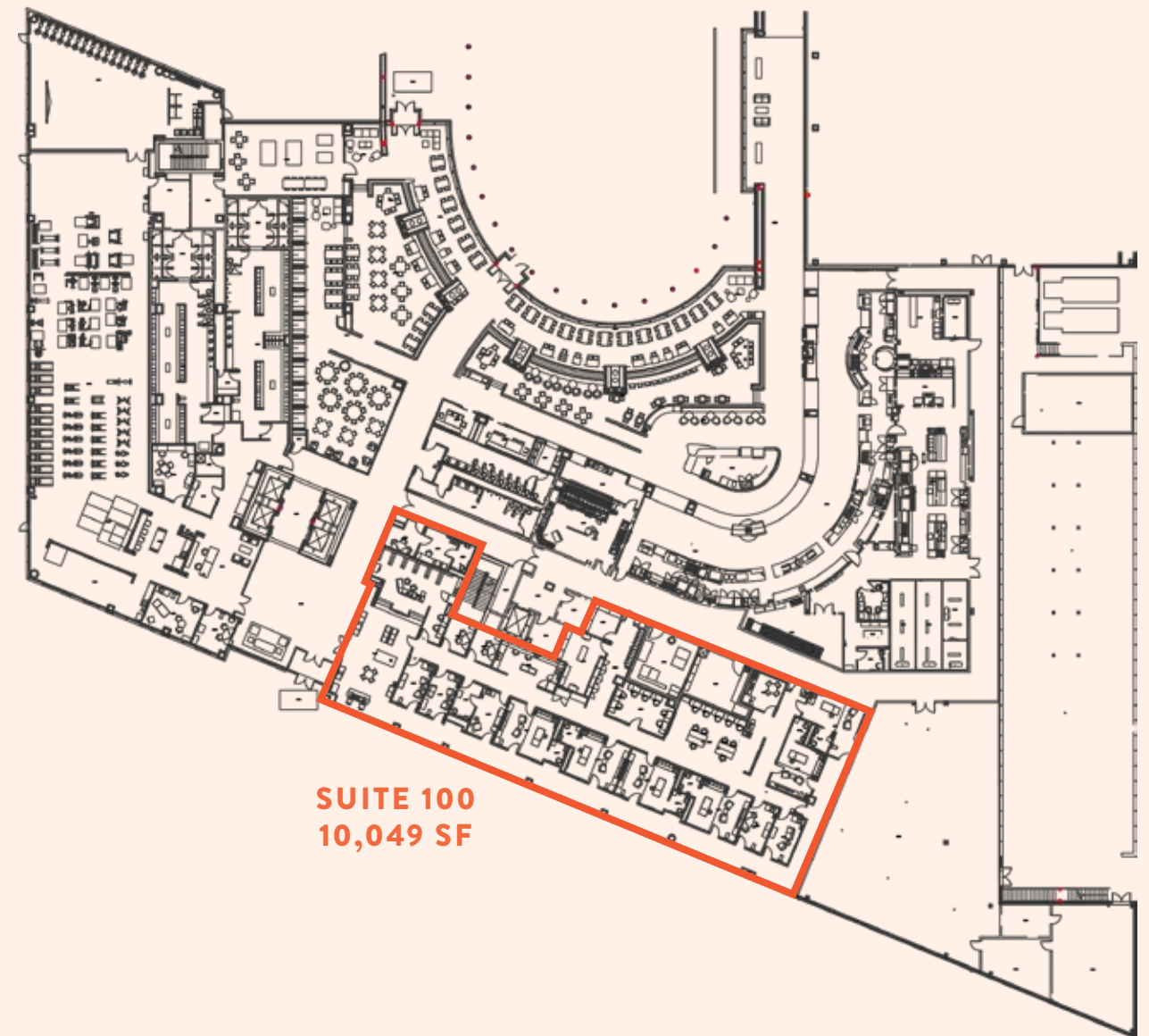

**SUITE 100
10,049 SF**

1ST FLOOR - 20,044 SF

AVAILABILITIES

10201 ABILITIES WAY – SOUTH BUILDING

Entire building available: 254,066 SF

*All square footages are approximate and subject to further verification



WORKSTATIONS AVAILABLE

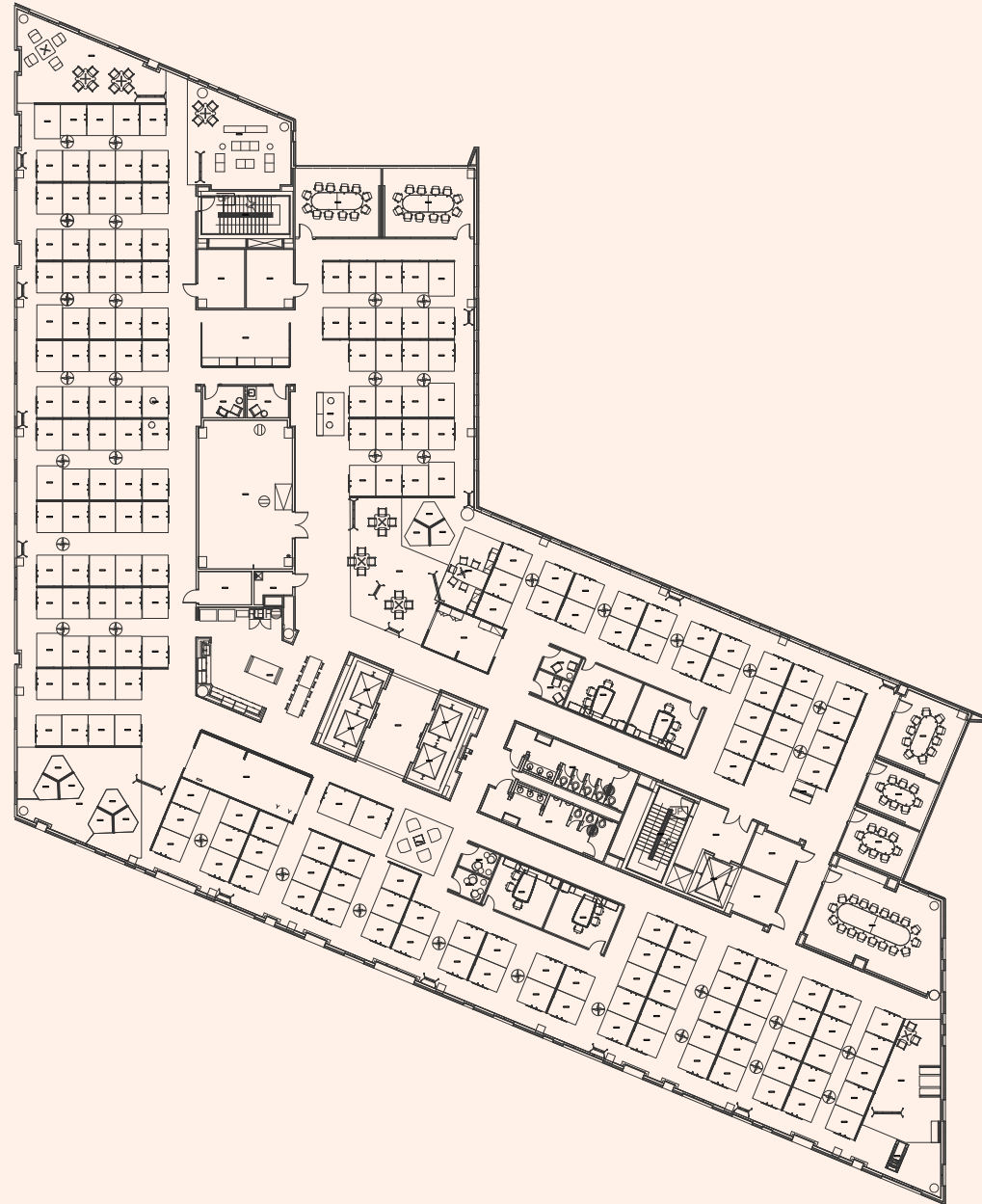

2ND FLOOR – 31,761 SF

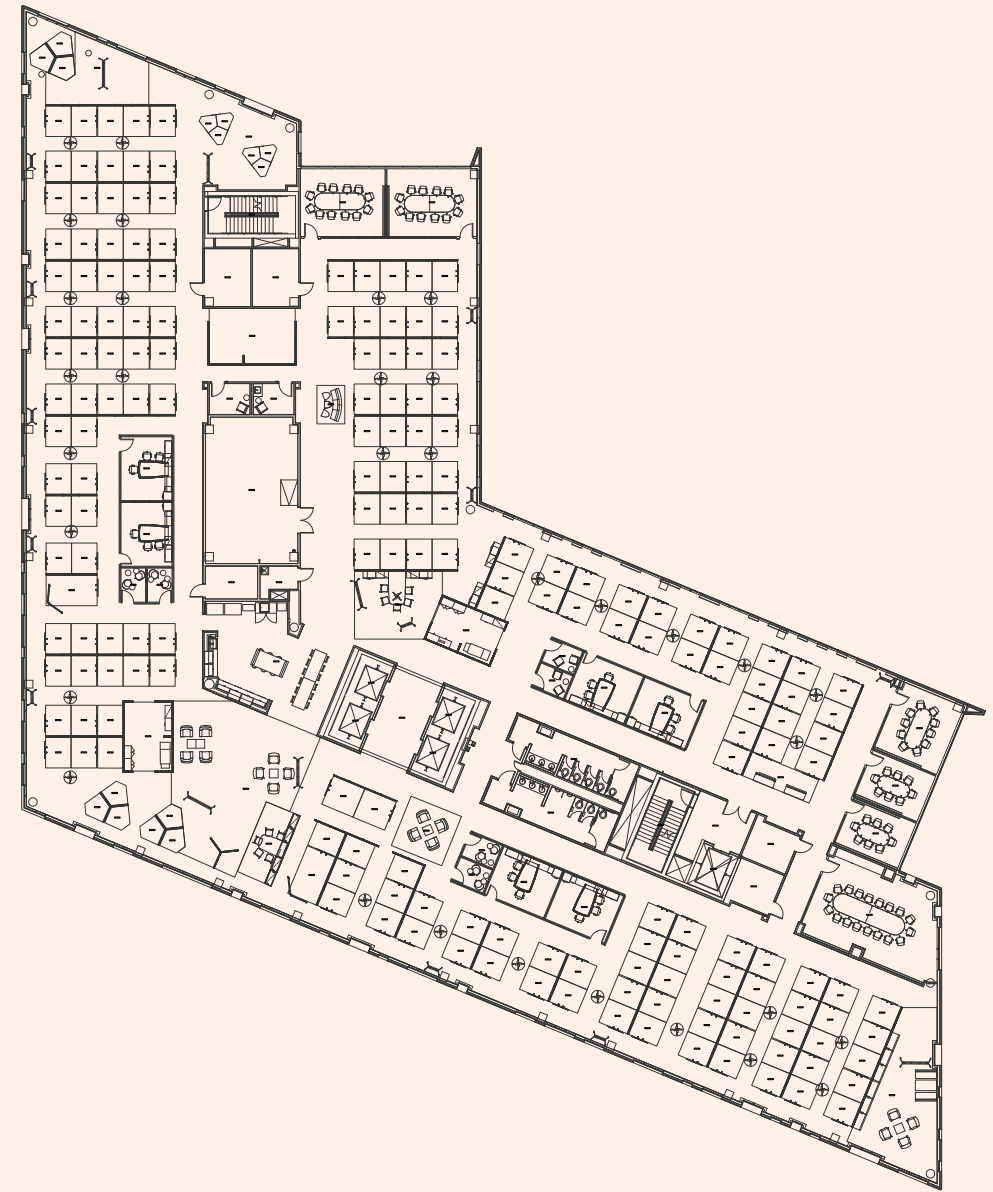

3RD FLOOR – 31,753 SF

AVAILABILITIES

10201 ABILITIES WAY – SOUTH BUILDING

Entire building available: 254,066 SF

*All square footages are approximate and subject to further verification



BREAK ROOM

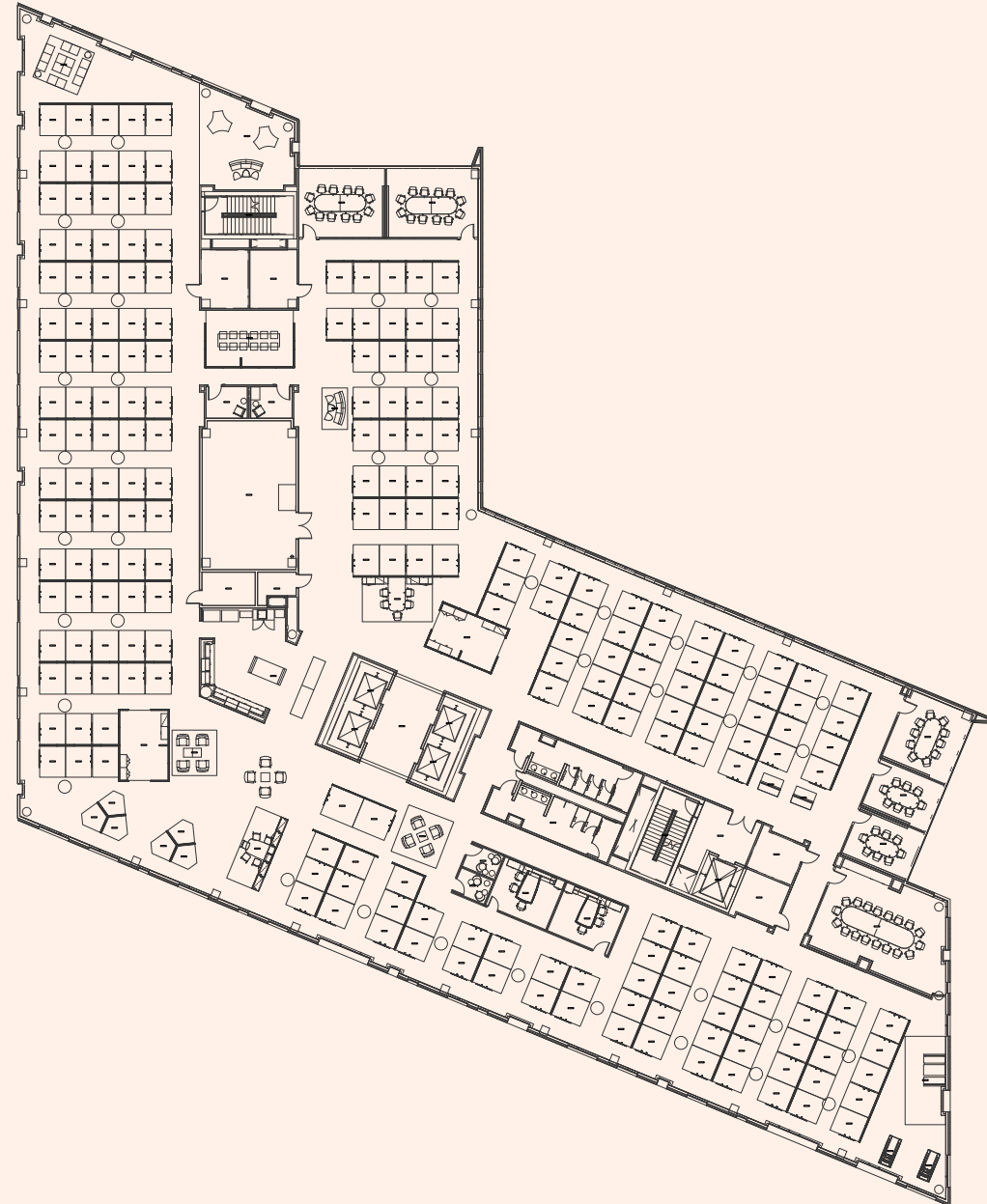

4TH FLOOR – 31,722 SF

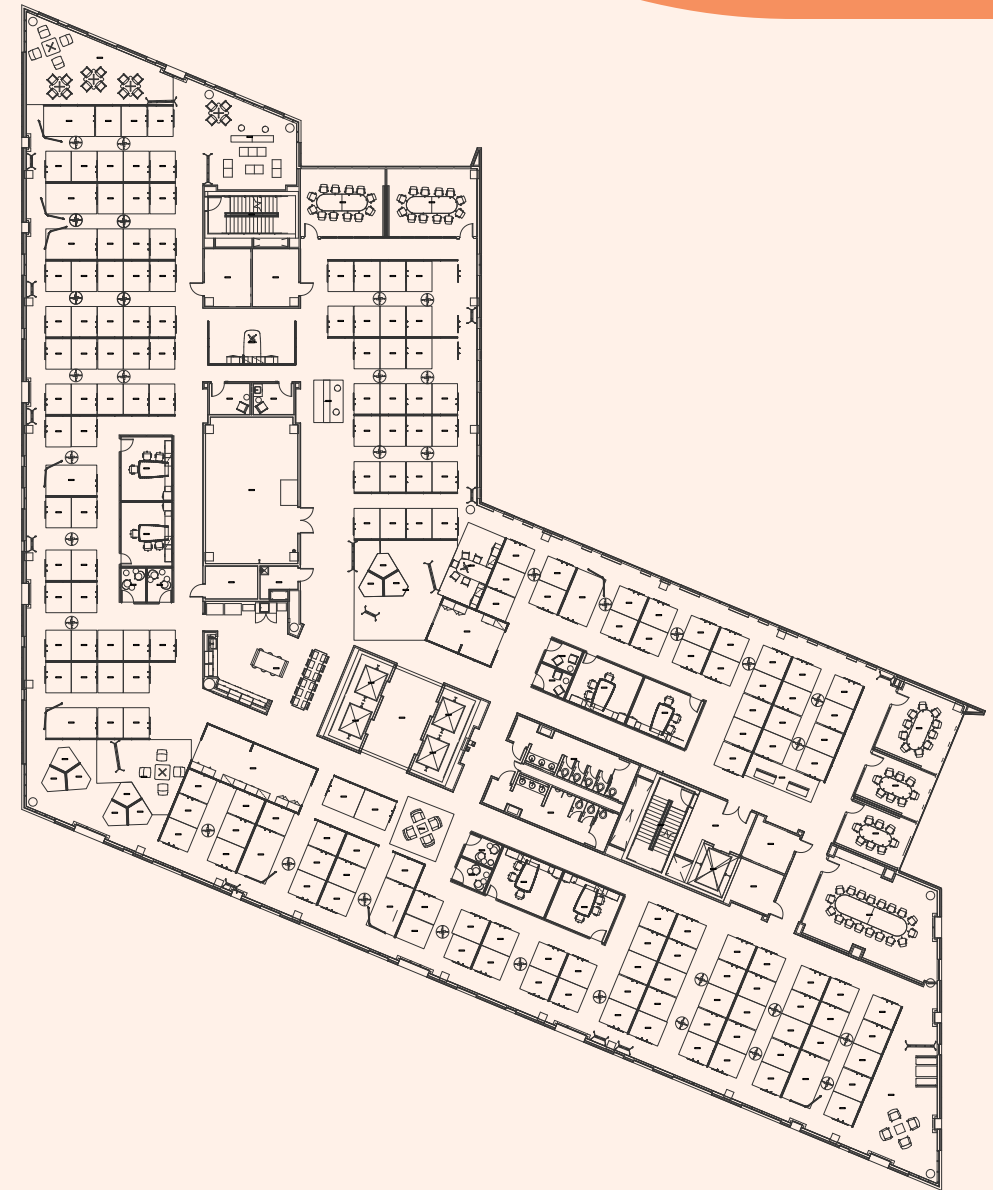

5TH FLOOR – 31,764 SF

AVAILABILITIES

10201 ABILITIES WAY – SOUTH BUILDING

Entire building available: 254,066 SF

*All square footages are approximate and subject to further verification

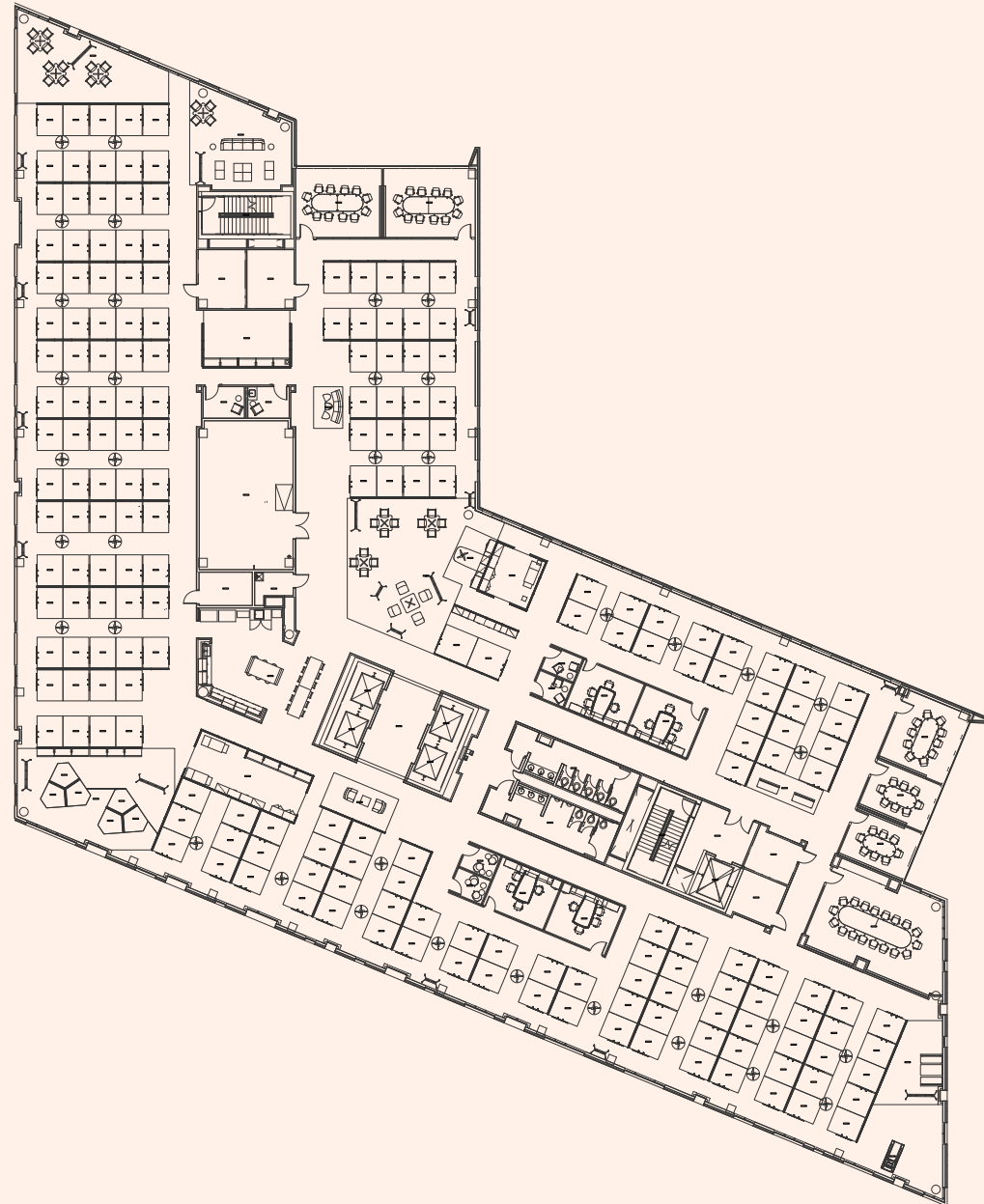

6TH FLOOR – 31,762 SF

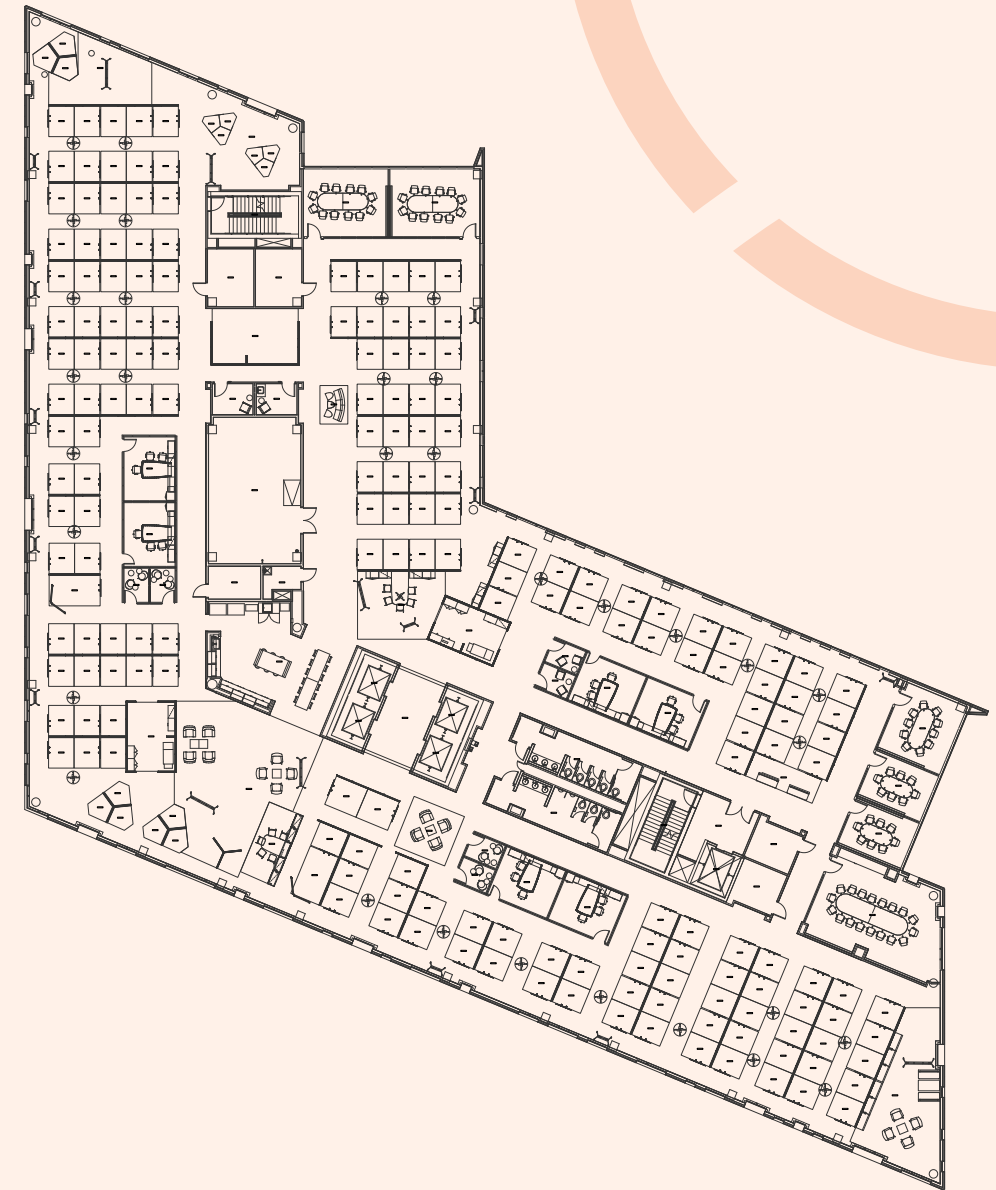

7TH FLOOR – 31,757 SF



WORKSTATIONS AVAILABLE

AVAILABILITIES

10201 ABILITIES WAY – SOUTH BUILDING

Entire building available: 254,066 SF

*All square footages are approximate and subject to further verification

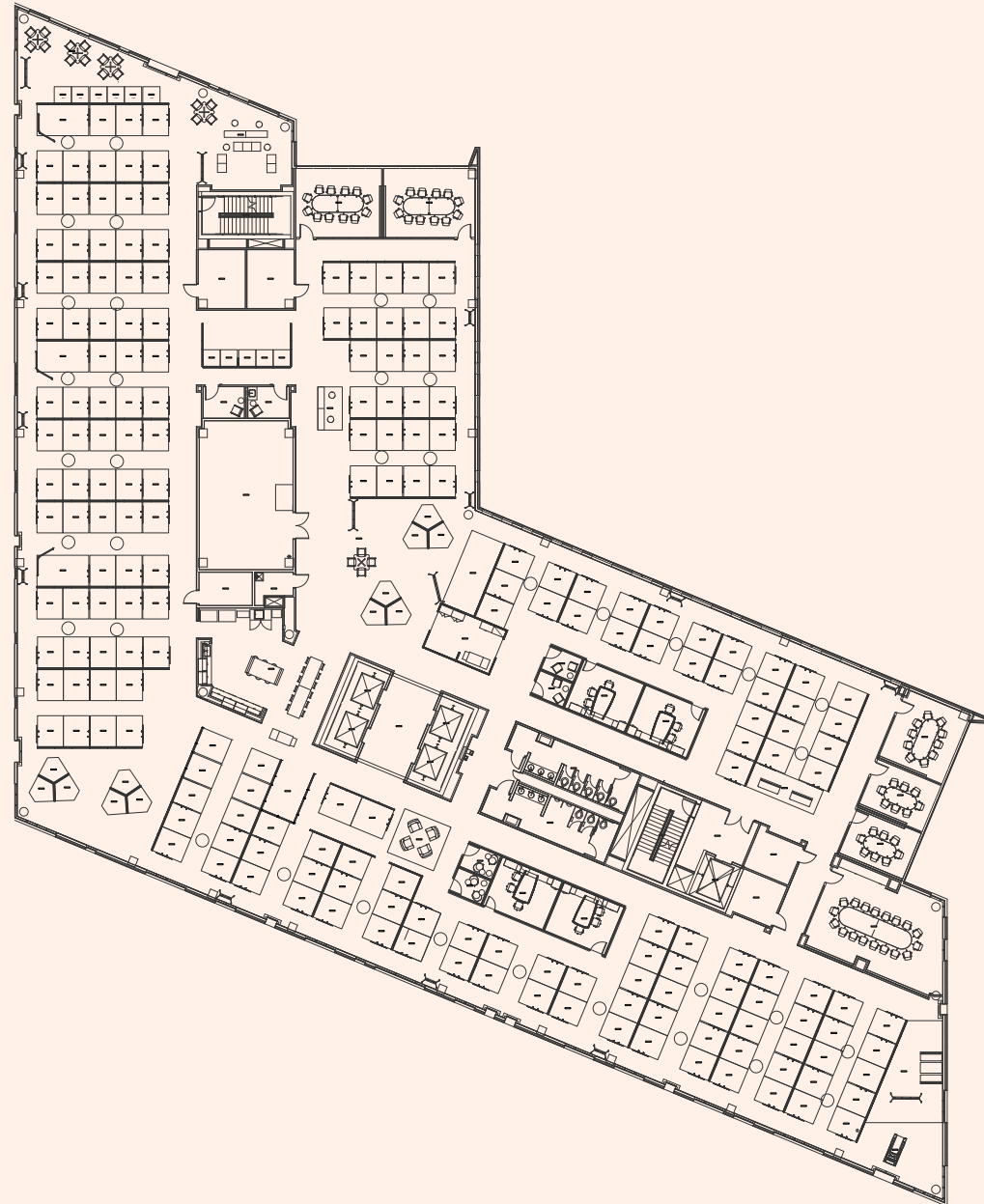

8TH FLOOR – 31,810 SF

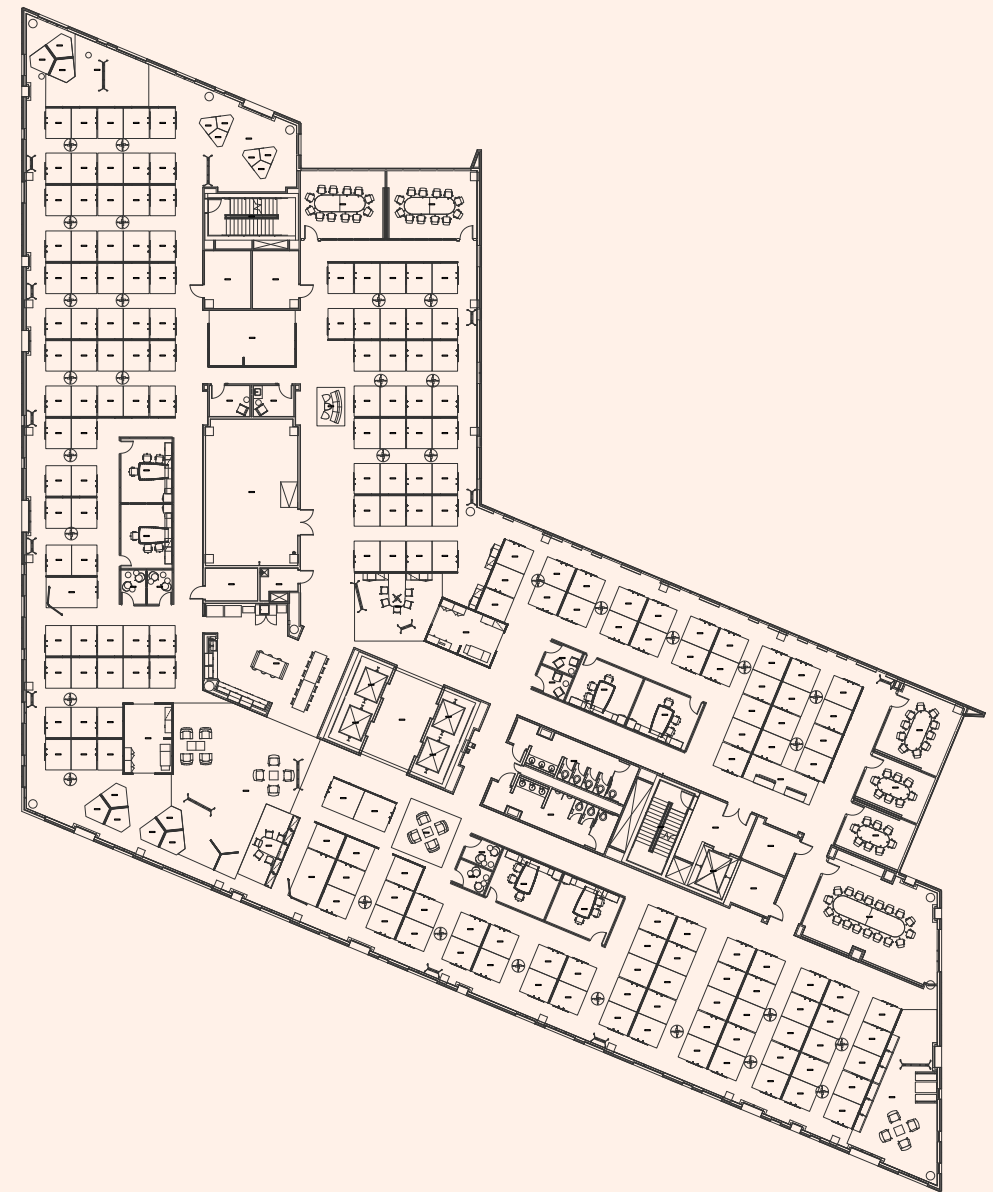

9TH FLOOR – 31,737 SF

STRATEGIC ACCESS TO KANSAS CITY'S PREMIER DESTINATIONS

NEARBY NOTABLE ATTRACTIONS



The Legends Outlets

Just a 2-minute drive away, the Legends Outlets offers a convenient and diverse shopping experience. This premier destination features over 100 designer outlets, along with an array of retail stores, dining establishments, and entertainment options, providing employees and visitors with ample choices for shopping, dining, and leisure activities.



Children's Mercy Park

Home of Kansas City's MLS team Sporting KC



The Kansas Speedway

A world-class motorsports facility, hosts several high-profile NASCAR events each year, drawing thousands of racing enthusiasts and adding to the area's vibrant entertainment offerings.



Drive times:

- Direct access to I-70 & I-435
- Kansas City CBD – 18 Minutes
- Kansas City International Airport (MCI) – 24 Minutes

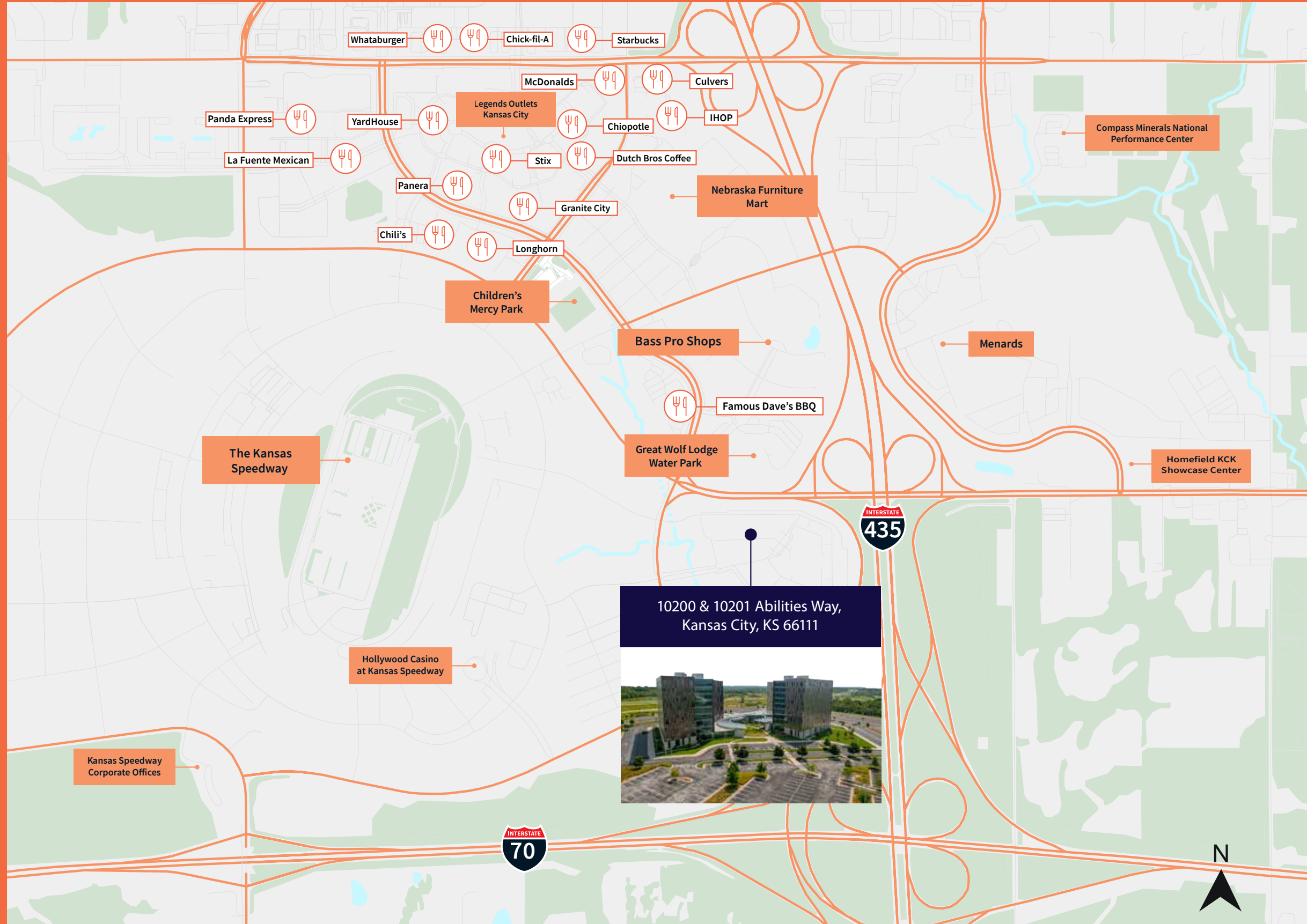

KANSAS CITY AT A GLANCE

Kansas City International Airport (KCI) offers coast-to-coast connectivity within three hours. The newly completed \$1.5 billion single-terminal renovation in 2023 has transformed KCI into a modern, efficient 39-gate facility with state-of-the-art amenities, marking the largest infrastructure project in the city's history.

As the second-largest rail center in the U.S. and the leader in freight volume, Kansas City boasts extensive rail infrastructure. Major players like **BNSF, Union Pacific, CPKC, and Norfolk Southern** operate intermodal facilities, enhancing the region's logistics capabilities.

Kansas City has been selected as a host city for the **2026 FIFA World Cup**, scheduled to hold matches in the Group Stage, Round of 32, and Quarterfinal stages, showcasing the city's growing international profile.

The city's economic stability is rooted in its diversity, with no single industry comprising more than **15% of regional employment**. This balanced economic structure has historically enabled **Kansas City** to navigate economic downturns more effectively than many coastal metropolitan areas, demonstrating consistent job growth and resilience.





RJ TROWBRIDGE

Executive Vice President
+1 913 469 4637
rj.trowbridge@jll.com

Although information has been obtained from sources deemed reliable, JLL does not make any guarantees, warranties or representations, express or implied, as to the completeness or accuracy as to the information contained herein. Any projections, opinions, assumptions or estimates used are for example only. There may be differences between projected and actual results, and those differences may be material. JLL does not accept any liability for any loss or damage suffered by any party resulting from reliance on this information. If the recipient of this information has signed a confidentiality agreement with JLL regarding this matter, this information is subject to the terms of that agreement. ©2025 Jones Lang LaSalle Brokerage, Inc. All rights reserved.