

# MIDVALE MANN

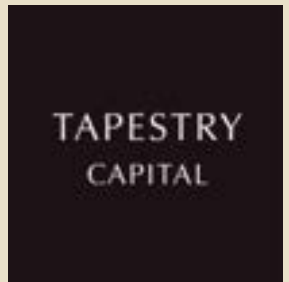



TO OGDEN

SALT LAKE CITY

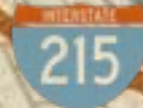

MIDVALE



UTA TRAX

TO PROVO

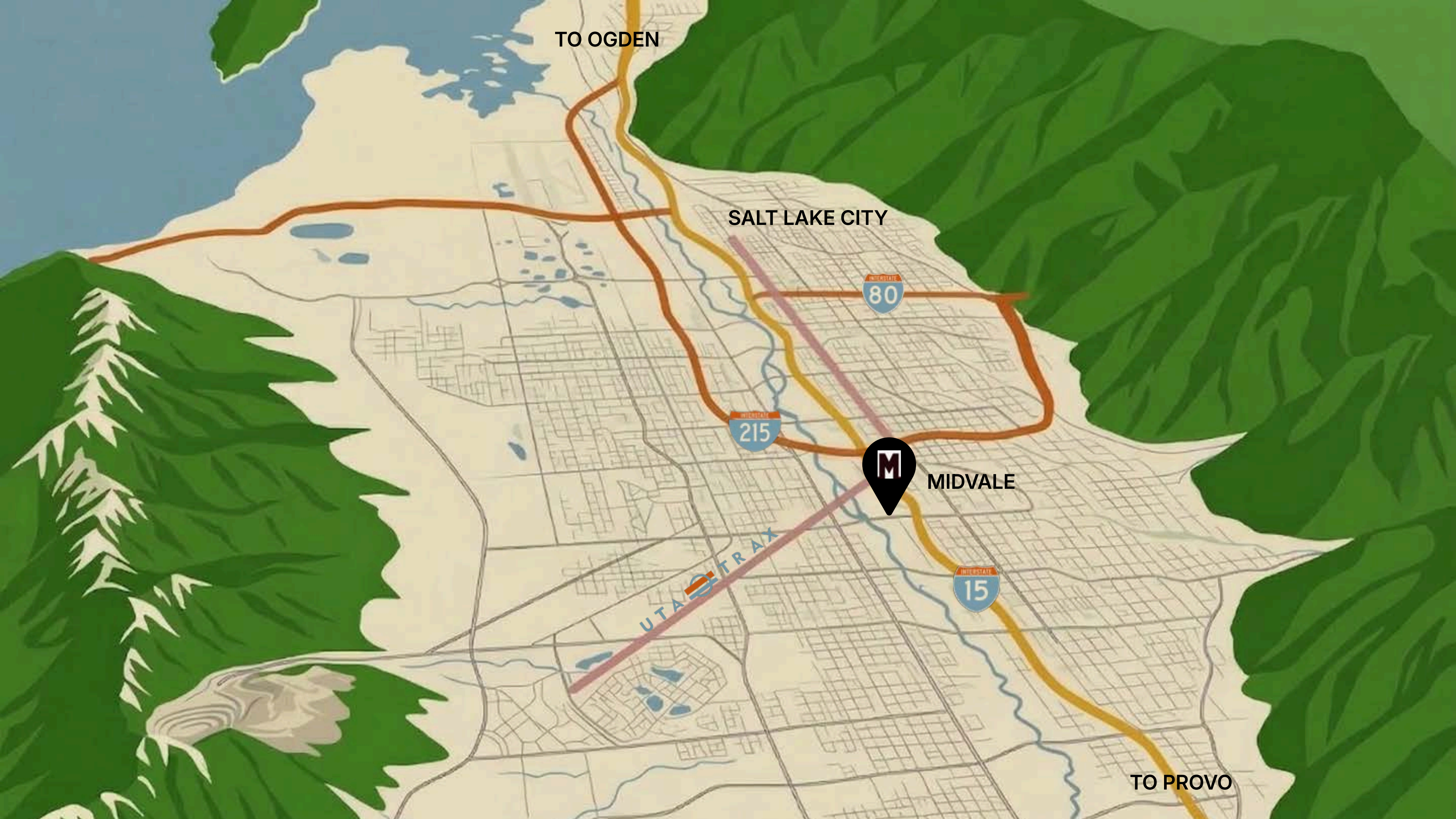



**UTAH'S INDEPENDENT  
ART, FOOD, AND  
ENTERTAINMENT  
DISTRICT**



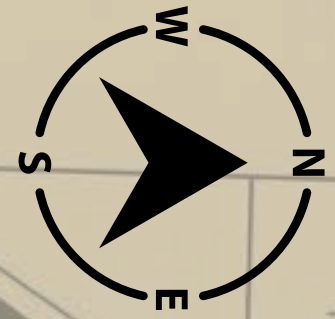

# Bars and Restaurants

CENTER ST.

MAIN ST.

1

2

3

4

5

6

7

8

9

10

11

- 1 The Bambino
- 2 Old Town Tavern
- 3 Blacksmith
- 4 SaltFire Brewing
- 5 Copper Cafe
- 6 Food Truck Plaza

- 7 La Fondita
- 8 Tres Gatos
- 9 Senor Pollo
- 10 Honeysuckle
- 11 Greek Streak



### **The Bambino**

Wood-fired pizza where Sandlot was filmed



### **SaltFire Brewing**

Handcrafted beers and brewpub food



### **Honeysuckle**

Craft drinks & pastries in AM, BBQ in PM



### **Old Town Tavern**

Beloved dive bar with pool tables, karaoke



### **Blacksmith Ice Cream**

Small-batch, hand churned artisan ice cream



### **Greek Streak**

Cooked-to-order, authentic Greek dishes



# Art and Entertainment

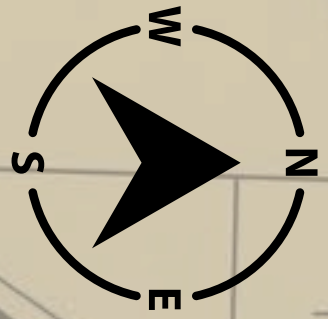

CENTER ST.

MAIN ST.

4

5

1

2

3

6

- 1 The Clubhouse
- 2 Big Mountain Gym
- 3 Ruhe Collective
- 4 The Pearl
- 5 Art House
- 6 Maivie



### **The Pearl**

Historic theater with regular live events



### **Art House**

Creative hub & studio featuring local artists



### **The Clubhouse**

Indoor haven for baseball enthusiasts



### **Maivie**

Experiential pressed flower workshop



### **Ruhe Collective**

Collective of beauty & wellness practitioners



### **Big Mountain Gym**

State-of-the-art, private training facility



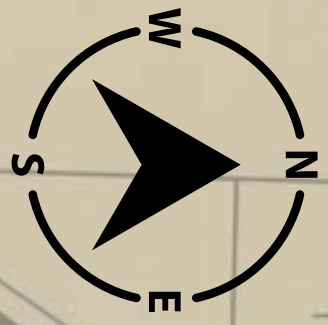

# Shops and Boutiques

CENTER ST.

MAIN ST.

1

2

3

4

5

6

- 1 Cactus & Tropicals
- 2 Needlepoint Shoppe
- 3 Farmer & Chemist
- 4 Rebel Paw
- 5 Grocery (El Potrero)
- 6 Artisan Bloom



### **Cactus & Tropicals**

Shop and greenhouse for plant enthusiasts



### **Needlepoint Shoppe**

New-age needlepoint craft store



### **Farmer & Chemist**

Health and wellness focused boutique



### **Rebel Paw**

Local, handcrafted pet treats and products



### **Grocery (El Potrero)**

Family-owned grocery and butcher shop



### **Artisan Bloom**

Award-winning floral design studio



**WHY  
MIDVALE  
MAIN?**

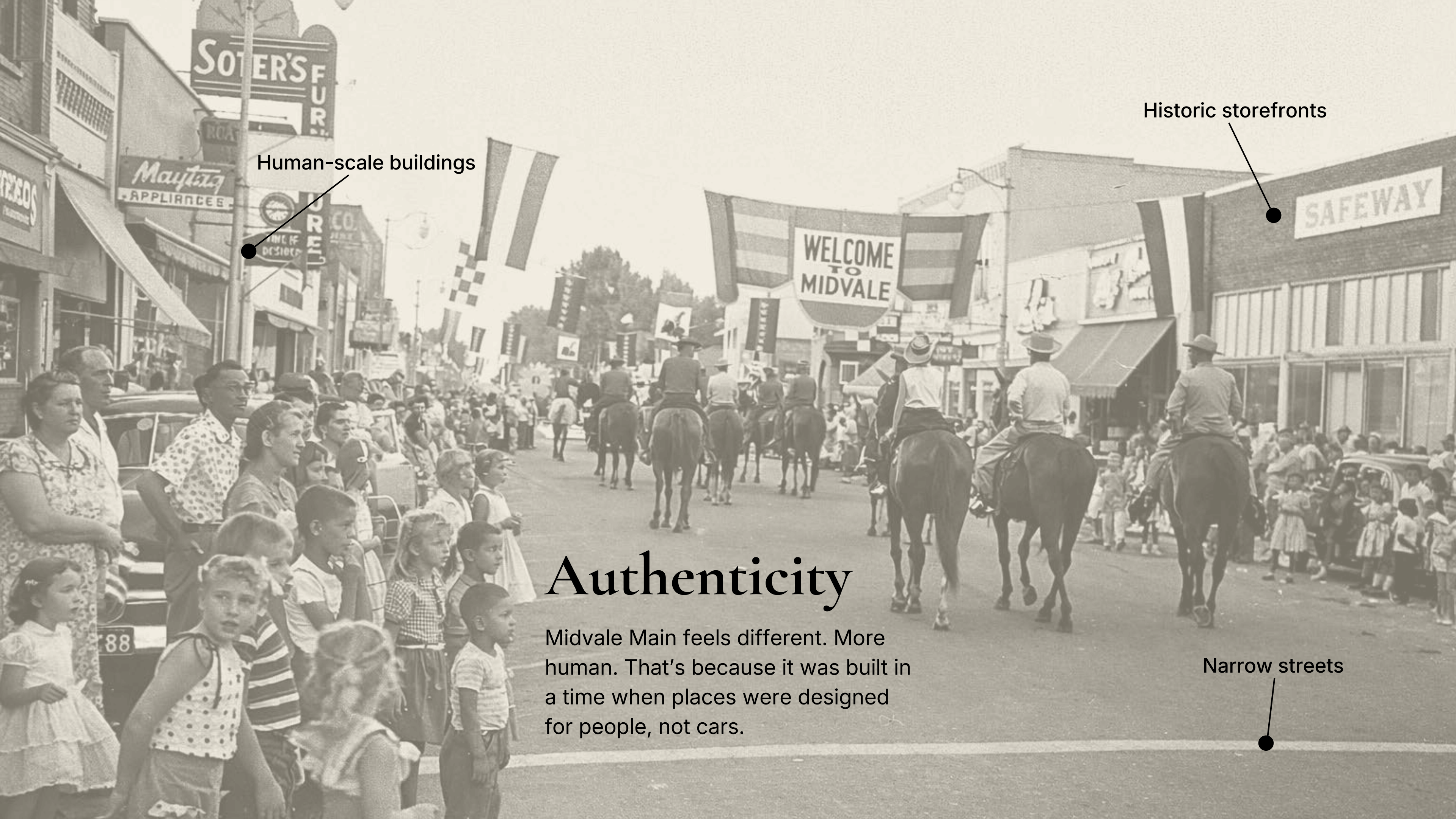

Human-scale buildings

Historic storefronts

# Authenticity

Midvale Main feels different. More human. That's because it was built in a time when places were designed for people, not cars.

Narrow streets

# City Support

From zoning reform to facade grants, small business lending, programming, and public realm investment, the city is providing the sustained, foundational support needed for Midvale Main to thrive as a vibrant commercial district.



Small business loan

Facade grant

Programming (Mural Fest)

Streetscape

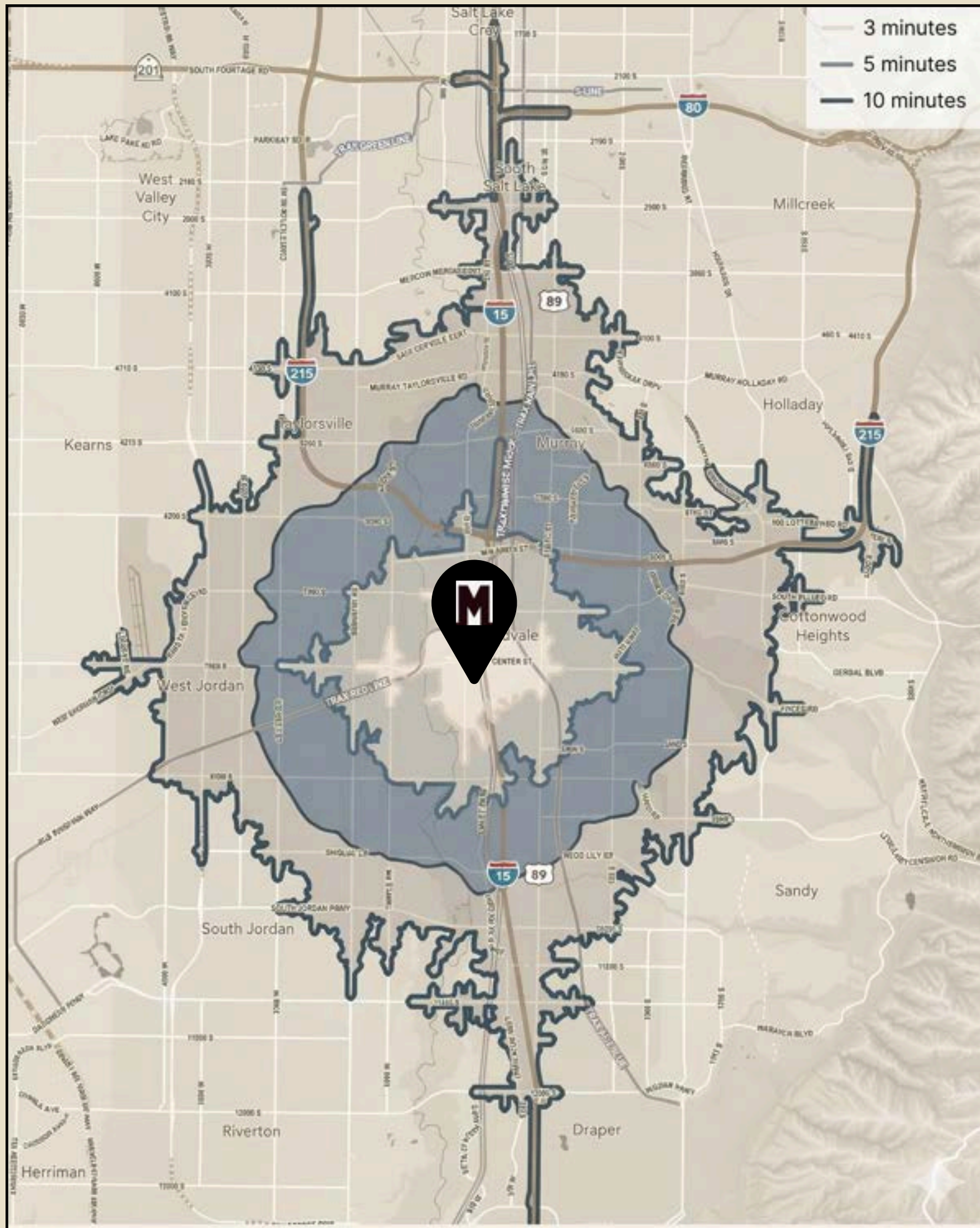

# Central Location

Midvale Main benefits from exceptional regional connectivity, with direct access to I-15, I-215, and TRAX at the center of the Salt Lake Valley. In one of Utah's most dynamic growth corridors, it offers a more compelling alternative to the area's dominant retail formats of strip centers and malls.

	Population	Daytime Population	Households	Avg. HH Income
1 min	16,795	17,630	6,736	\$101,317
5 min	33,934	27,668	13,390	\$106,210
10 min	162,911	138,770	61,894	\$120,534
1 mile	15,131	9,866	6,051	\$95,195
3 mile	128,165	119,235	48,160	\$123,630
5 mile	351,638	289,415	127,443	\$133,098

AVAILABLE  
SPACES

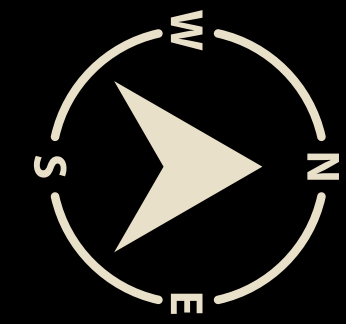

THE BANK

WEST MAIN

THE CANARY

CENTER ST.

MAIN ST.





MIDVALE STATE BANK

# THE BANK

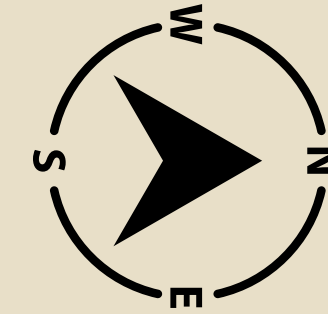

CENTER ST.

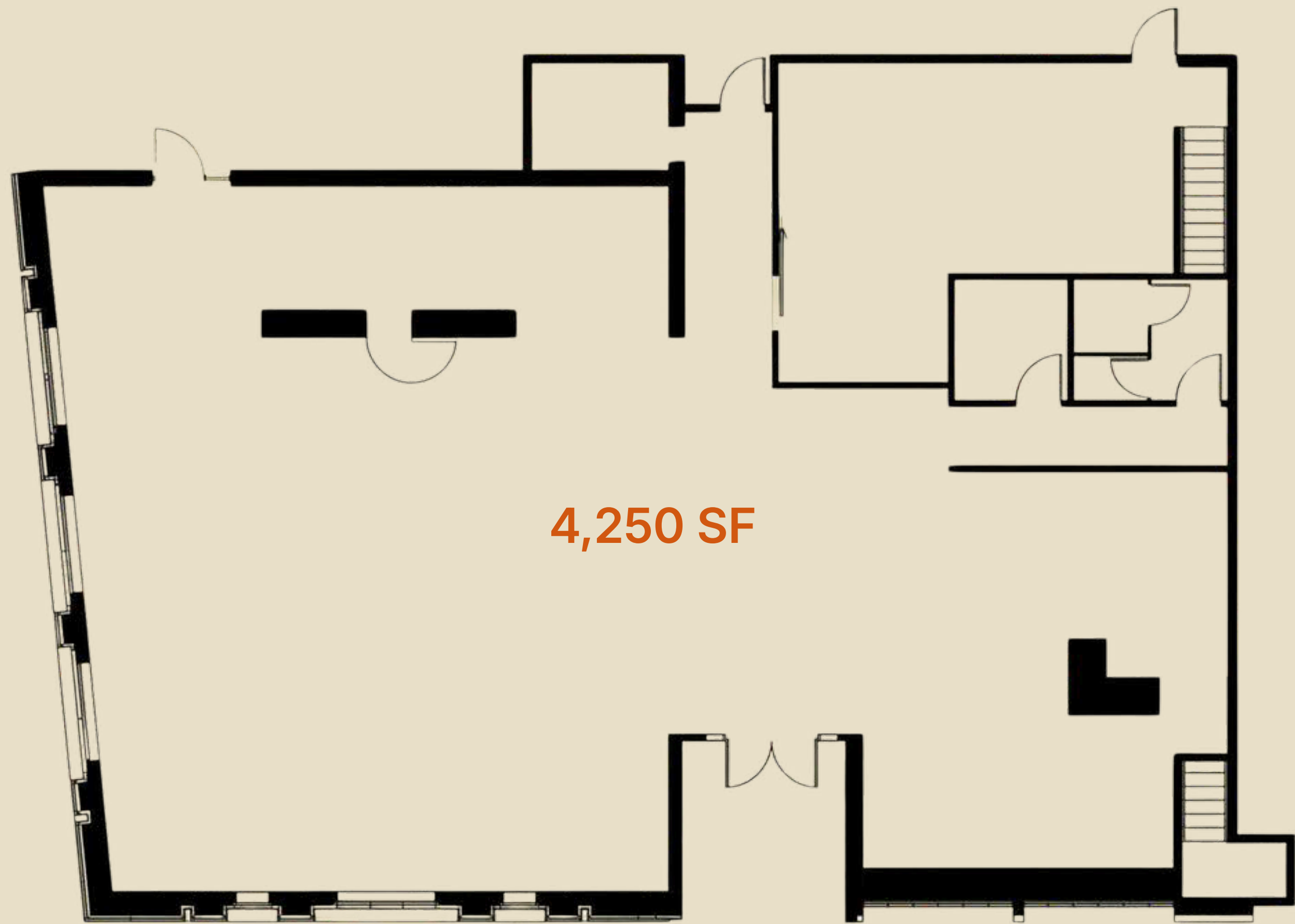

4,250 SF

MAIN ST.

# WEST MAIN

**Blacksmith**  
ICE CREAM CO

Pop-up Boutique

7512



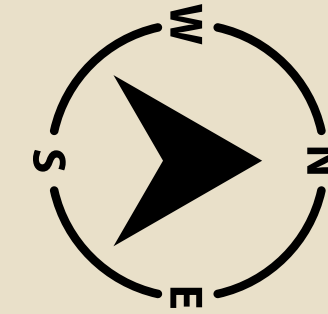

DEPOT ST.



2,445 SF

BLACKSMITH  
[Anvil icon]

2,386 SF

MAIN ST.

# THE CANARY



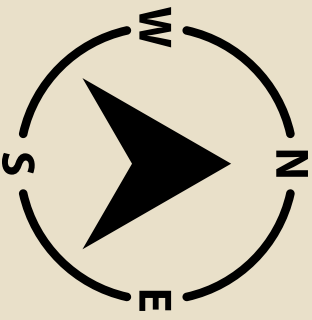

**MAIN ST.**

**2,357 SF**

**FIFTH AVE.**

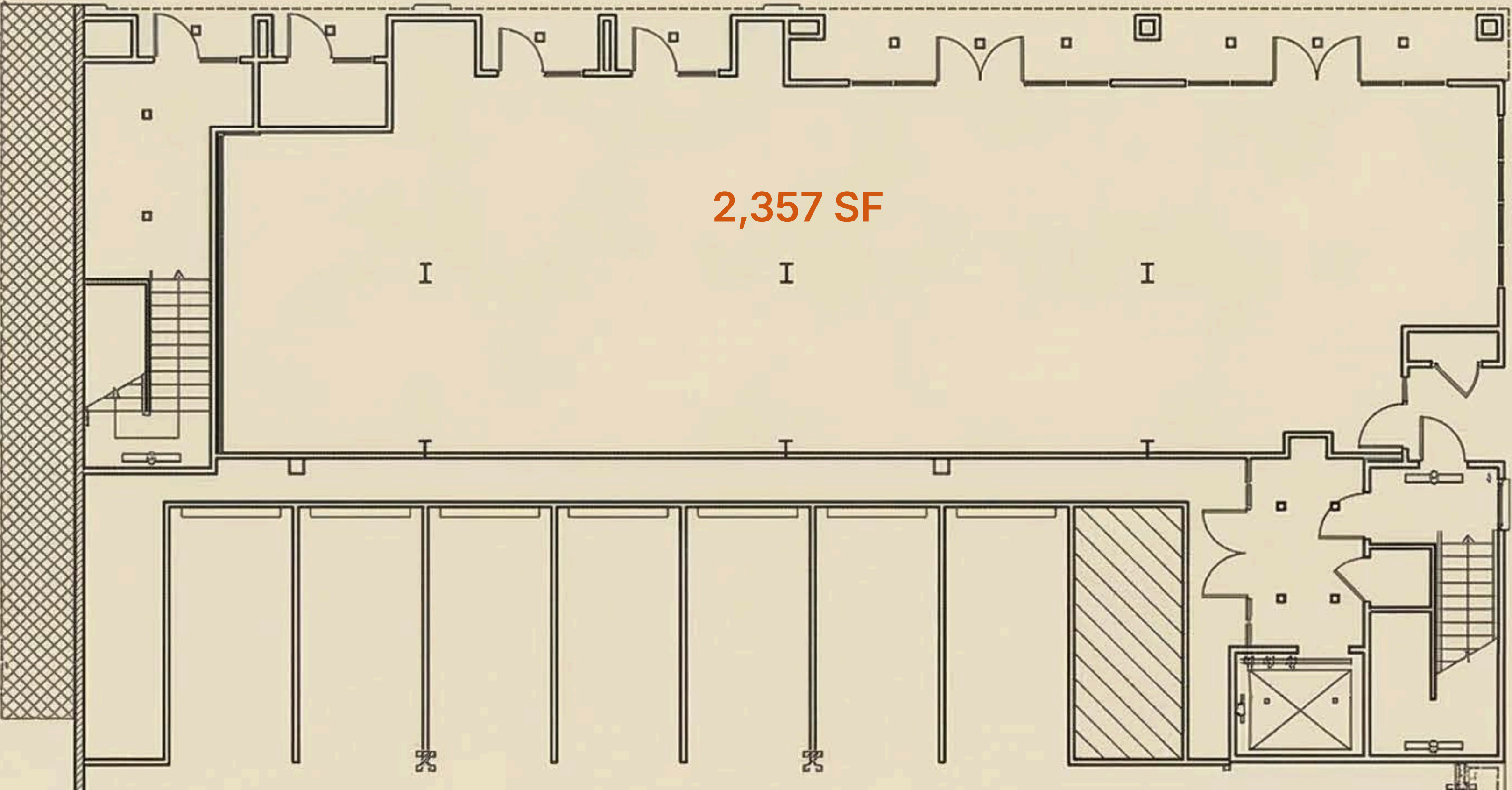

# CONTACT

**Stephanie Buranek**

[sburanek@newmarkmw.com](mailto:sburanek@newmarkmw.com)

(801) 755-1191

**Brandon Beck**

[brandon@tapestrycp.com](mailto:brandon@tapestrycp.com)

(801) 550-3811