

5680 176A ST

CLOVERDALE BC

Rare freestanding
medical/professional
owner-user opportunity
near the future Surrey
Hospital.



COMMERCIAL
PROPERTIES
GROUP.CA

George Richmond PREC*

Commercial Sales & Leasing

+ 1 604 786 1094

George@commercialpropertiesgroup.ca

Rebecca MacLeod PREC*

Commercial Sales & Leasing

+ 1 778 316 3092

Rebecca@commercialpropertiesgroup.ca

*PREC represents Personal Real Estate Corporation

A Rare Owner-Occupier Opportunity

IN THE HEART OF CLOVERDALE

5680 176A Street presents a unique opportunity for medical, professional, and commercial owner-users to secure a highly visible and strategically positioned property within one of Surrey's fastest-evolving commercial nodes.

Located just minutes from the future Surrey Hospital and BC Cancer Centre in Cloverdale, the property is exceptionally well-positioned to benefit from significant long-term growth, increased healthcare demand, and continued investment throughout the surrounding area.

The existing improvements provide functional and flexible space suitable for a variety of professional and medical uses, while the property's prominent location offers excellent accessibility, exposure, and convenience for both staff and clientele.

As healthcare infrastructure, population growth, and commercial activity continue to expand throughout Cloverdale, opportunities to establish a long-term presence in the immediate area are becoming increasingly limited.

In addition to immediate owner-user functionality, the property also offers future redevelopment and land appreciation potential within an evolving commercial corridor, providing purchasers with both operational utility today and strategic upside over the long term.

IDEAL FOR

- Medical clinics
- Dental practices
- Specialist healthcare users
- Physiotherapy & rehabilitation
- Counselling & wellness services
- Professional offices
- Legal & accounting firms
- Educational or community uses
- Long-term owner-occupiers

PROPERTY HIGHLIGHTS

- Rare freestanding commercial building in the heart of Cloverdale
- Approx. 5,054 SF single-storey professional office building
- Excellent owner-occupier opportunity for medical and professional users
- Existing layout includes reception area, private offices, boardroom, lunchroom & file room
- Minutes from the future Surrey Hospital & BC Cancer Centre
- Prominent corner exposure to both 176A Street and 57 Avenue
- Functional and approachable building design ideal for client-facing businesses
- Approx. 20 on-site parking stalls plus additional street parking
- Well-maintained existing improvements
- Strong long-term growth corridor within Cloverdale Town Centre
- Future redevelopment and land appreciation potential
- Full municipal servicing in place
- Strategic location with excellent accessibility throughout Surrey and Langley
- Located within one of Surrey's most established and recognizable commercial communities

SALIENT DETAILS

CIVIC ADDRESS 5680 176A Street, Cloverdale, BC

LEGAL DESCRIPTION LOT "B" (X34576E) BLOCK 14 SECTION 8 TOWNSHIP 8 NEW WESTMINSTER DISTRICT PLAN 2107

PID 002-047-306

PROPERTY TYPE Single Storey Commercial Office Building

SITE SIZE 15,844.35 sq. ft.

BUILDING SIZE 5,054 sq. ft.

ZONING C15 – Town Centre Commercial Zone

OFFICIAL COMMUNITY PLAN Town Centre

YEAR BUILT 1984

PARKING Paved surface parking with 20 stalls, plus street parking available

OCCUPANCY VACANT POSSESSION

PROPERTY TAXES \$22,952.24

ASKING PRICE Contact Listing Brokers for price guidance

POSITIONED

NEAR SURREY'S NEW HEALTHCARE HUB

Located just minutes from the future Surrey Hospital and BC Cancer Centre, the property is strategically positioned to benefit from one of the largest healthcare infrastructure investments currently underway in the Fraser Valley.

The new regional hospital and cancer centre is expected to significantly expand healthcare services, employment, patient traffic, and supporting professional demand throughout the Cloverdale area, further strengthening the long-term appeal of nearby medical and professional office locations.

As the surrounding healthcare ecosystem evolves, opportunities for owner-users to secure established freestanding commercial properties in close proximity to the hospital campus are expected to become increasingly limited.



The New Surrey Hospital and BC Cancer Centre

Level 2:
Oncology ambulatory care
Oncology pharmacy
Systemic therapy
Medical physics / dosimetry

Level 1:
Main entrance
Emergency department
Ambulatory care
Radiation therapy
Public space
CT simulator
Cyclotron

Levels P1-P2:
Underground parking

Levels 7-9:
Inpatient beds

Level 6:
Virtual health
Administration
Inpatient beds (oncology)

Level 5 / 5i:
Medical device reprocessing
Mechanical

Level 4:
Medical imaging
Perioperative
MRI Simulator

Level 3:
Molecular imaging and therapy
Pharmacy
Laboratory
Public space
Meeting and education



STRATEGICALLY LOCATED

IN THE HEART OF CLOVERDALE

The property is ideally situated within Cloverdale Town Centre, one of Surrey's most established and rapidly growing commercial districts. Positioned at the corner of 176A Street and 57 Avenue, the property offers excellent accessibility and exposure with convenient connections to Highway 10, Highway 15, Langley, and the broader Fraser Valley.

Located just minutes from the future Surrey Hospital and BC Cancer Centre, the property is exceptionally well suited for medical and professional users seeking long-term presence within an emerging healthcare corridor. The surrounding area features a strong mix of commercial businesses, professional offices, retail amenities, restaurants, and residential neighbourhoods, supporting continued growth and long-term value within the Cloverdale community.





FLOOR PLAN

5,054 sq.ft.

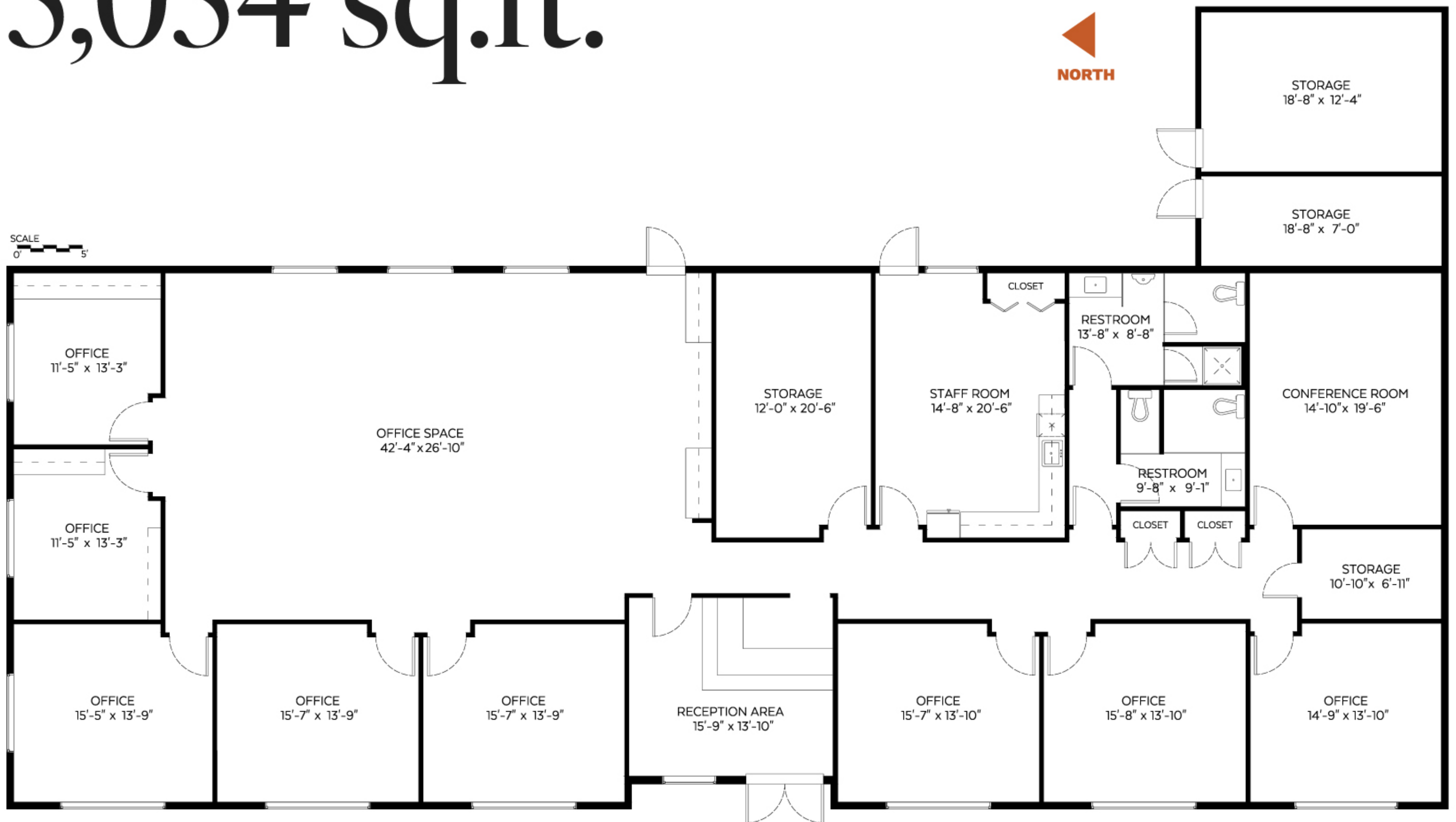

Future Redevelopment & Intensification Potential

Located within Surrey's evolving Cloverdale Town Centre, the property benefits from both its existing C-15 Town Centre Commercial zoning and the long-term planning framework established under the Surrey 2050 Official Community Plan.

Under the current Surrey 2050 framework, properties within this area may fall under the Low-Rise II (LOW2) or Mid-Rise II (MID2) land use designations, supporting future mixed-use commercial and residential development subject to municipal approvals and rezoning. The City's updated planning direction for Cloverdale reflects continued investment in housing, healthcare infrastructure, and commercial intensification throughout the Town Centre area.

| | Current | Surrey 2050 Direction |
|-------------------|-----------------------------|--|
| Zoning | C-15 Town Centre Commercial | Unchanged (until rezoning) |
| OCP Designation | Town Centre | Likely Low-Rise II or Mid-Rise II |
| Density potential | Low-rise commercial | 6–25 storeys mixed-use (if Mid-Rise II) |
| Ground Floor | Commercial | Commercial required on arterial frontage |

DEVELOPMENT HIGHLIGHTS

- Strong underlying land value fundamentals
- Located within a growing commercial and industrial corridor
- Potential future intensification opportunities
- Strategic long-term hold opportunity
- Limited regional land supply supporting future demand

The information contained herein has been obtained from sources believed to be reliable; however, no warranty or representation is made as to its accuracy or completeness. Prospective purchasers should conduct their own independent investigations and due diligence regarding the property and all related matters.

This offering is subject to prior sale, withdrawal, price change, or modification without notice.

5680 176A ST

CLOVERDALE BC



WWW.COMMERCIALPROPERTIESGROUP.CA

GEORGE RICHMOND

PERSONAL REAL ESTATE CORPORATION

Commercial Sales & Leasing

604.786.1094

George@commercialpropertiesgroup.ca

REBECCA MACLEOD

PERSONAL REAL ESTATE CORPORATION

Commercial Sales & Leasing

778.316.3092

Rebecca@commercialpropertiesgroup.ca

