

SUITES 201 | 202 | 203 | 204
 Plug & Play Fitted+ Labs - Available Now



360° VIRTUAL TOUR

SUITE 202: ±5,710 SF

SUITE 203: ±7,105 SF

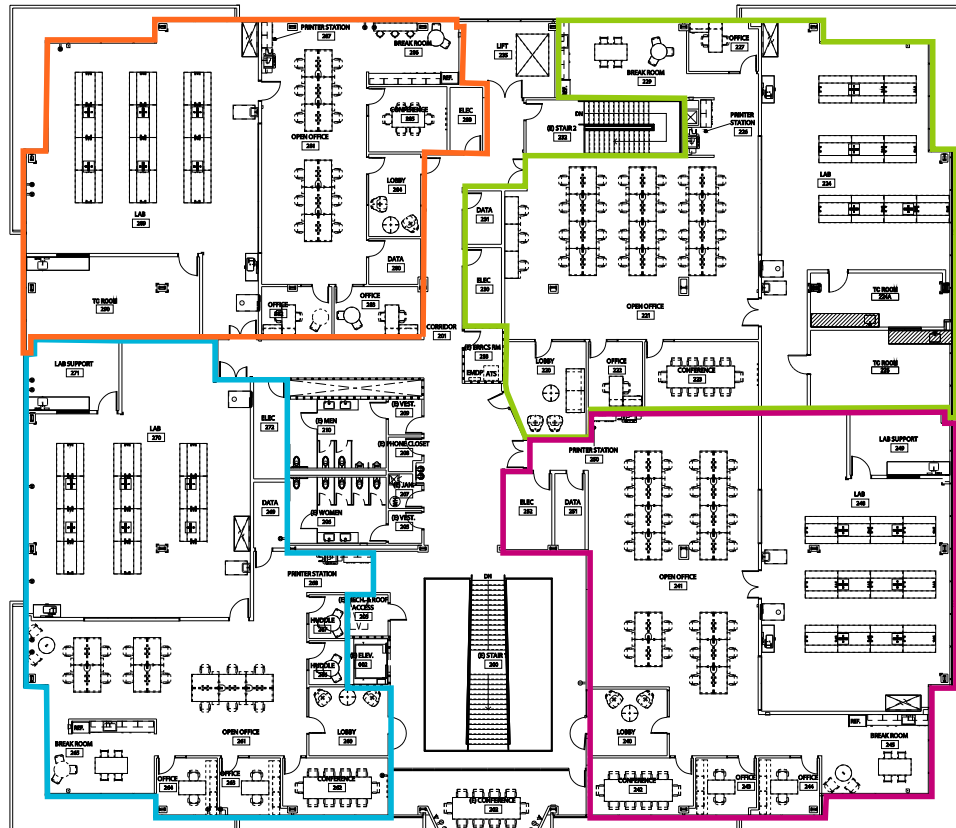

SUITE 201: ±6,451 SF

SUITE 204: ±6,699 SF

360° VIRTUAL TOUR

360° VIRTUAL TOUR

KEY PLAN

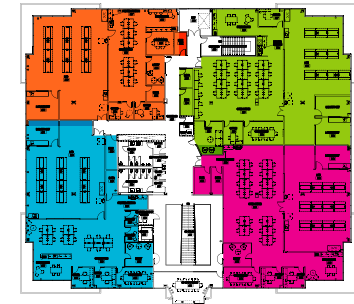

SITE PLAN

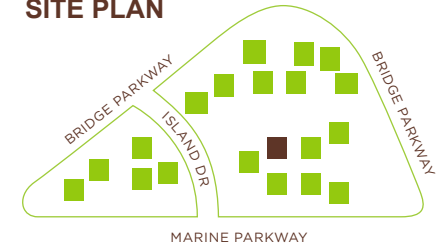

BEN PAUL
 Vice Chairman
 +1 650 401 2123
 ben.paul@cushwake.com
 LIC #01210872

MARC POPE
 Vice Chairman
 +1 650 401 2131
 marc.pope@cushwake.com
 LIC #01474483

NICK WALDSMITH
 Director
 +1 650 320 0244
 nick.waldsmith@cushwake.com
 LIC #02148008

