

FOR SUBLEASE | INDUSTRIAL PROPERTY

**13819 HUMPHREY RD.**

LAREDO, TX



## PROPERTY SPECIFICATIONS

Building Size:	230,900 SF
Available Sublease Space:	±46,300 - ±77,500 SF
Office Space:	±1,500 SF
OHD 9'X10':	18 Doors
OHD 12'X16':	1 Door
Clear Height:	32'
Dock Positions:	44
Zoning:	M-2

## PROPERTY OVERVIEW

±46,300 SF - ±77,500 SF sublease available inside new warehouse building in north Laredo, Texas inside Sophia Industrial Park. This space includes an office space with ±1,500 SF. Property specifications include, 18 OHD (9'x10'), 1 OHD (12'x16') with ramp, and a clear ceiling height of 32'.

## LOCATION OVERVIEW

This property is conveniently located on mile marker 13 inside Sophia Industrial Park with easy access to Interstate 35 and 10 miles from the World Trade Bridge.

**CARLO MOLANO, SIOR**  
carlom@forumcre.com  
M: 956.523.9403  
O: 956.717.9090

**ALFONSO JASSO**  
alfonsoj@forumcre.com  
M: 956.508.4203  
O: 956.717.9090

FOR LEASE | INDUSTRIAL PROPERTY

# 13819 HUMPHREY RD.

13819 HUMPHREY RD., LAREDO, TX 78045



**FORUM**  
CRE

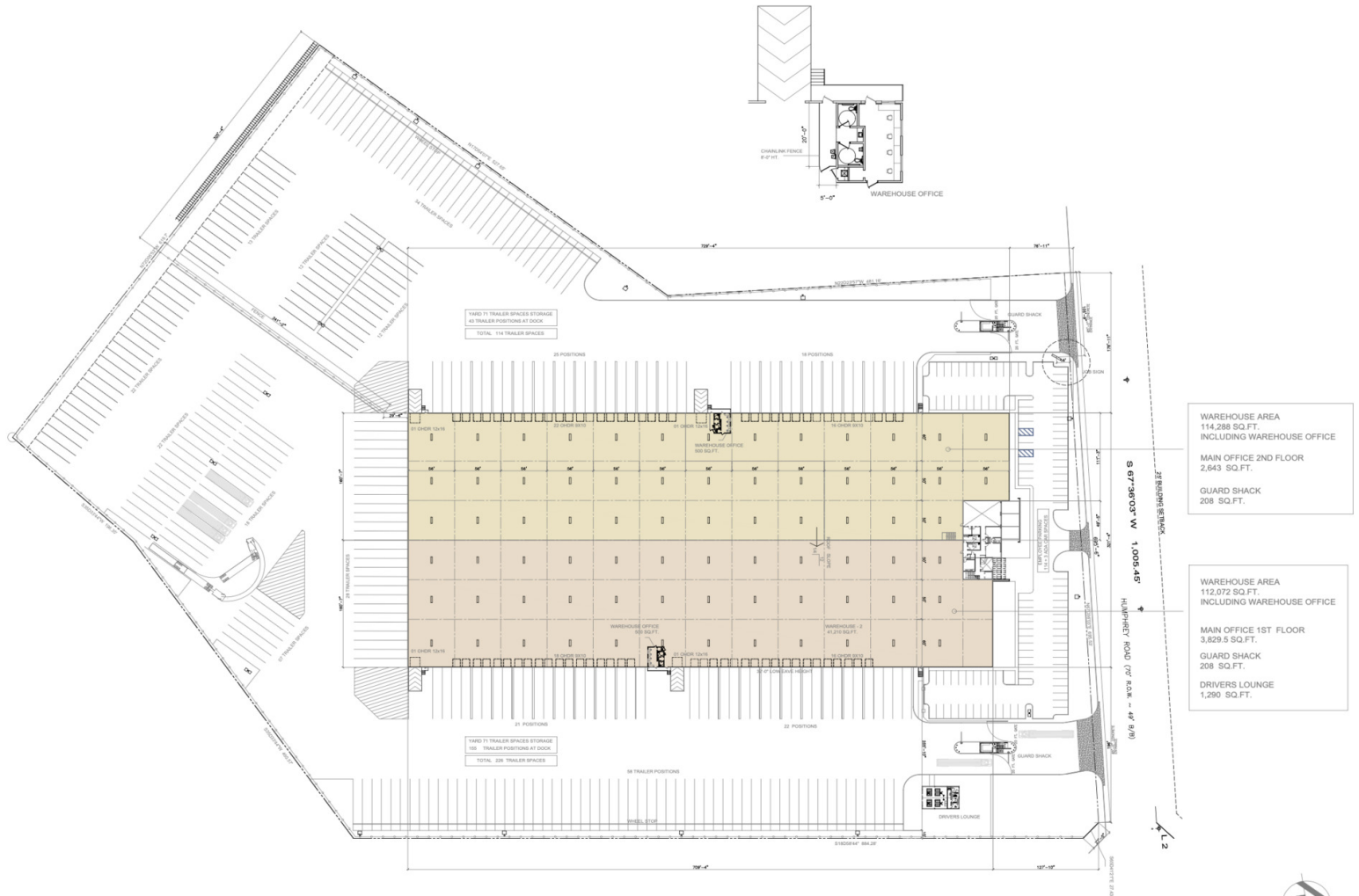

**LEGAL DESCRIPTION**  
LOT-2  
BLOCK - 2  
SOPHIA INDUSTRIAL PARK  
20.6 ACS

**GENERAL SITE PLAN**

NOTE: CONTRACTOR TO FIELD VERIFY ALL DIMENSIONS IN THE FIELD AND IS TO REPORT ANY DISCREPANCIES

SCALE 1/8" = 1'-0" 1

**CARLO MOLANO, SIOR**  
carlom@forumcre.com  
M: 956.523.9403  
O: 956.717.9090

**ALFONSO JASSO**  
alfonsoj@forumcre.com  
M: 956.508.4203  
O: 956.717.9090

FOR SUBLEASE | INDUSTRIAL PROPERTY

**13819 HUMPHREY RD.**

LAREDO, TX 78045



**FORUM  
CRE**



**CARLO MOLANO, SIOR**  
carlom@forumcre.com  
M: 956.523.9403  
O: 956.717.9090

**ALFONSO JASSO**  
alfonsoj@forumcre.com  
M: 956.508.4203  
O: 956.717.9090

FOR LEASE | INDUSTRIAL PROPERTY

# 13819 HUMPHREY RD.

LAREDO, TX 78045



FORUM  
CRE



Map data ©2025 Imagery ©2025 Airbus, CNES / Airbus, Maxar Technologies

**CARLO MOLANO, SIOR**  
carlom@forumcre.com  
M: 956.523.9403  
O: 956.717.9090

**ALFONSO JASSO**  
alfonsoj@forumcre.com  
M: 956.508.4203  
O: 956.717.9090

