

ATLANTA WEST DISTRIBUTION CENTER

FOR LEASE

± 292,310 SF

6300 Boat Rock Blvd.
Atlanta, GA 30336

LEASED BY



Building Highlights

- Full Building: 292,310 SF divisible
- 40' x 40' column spacing with 50' speed bays
- Three Suites A-C
- 9,321 SF of office total across 3 office pods
- 50 dock positions
 - 36 doors equipped with pit levelers
 - 2 doors equipped with Edge of Dock levelers
 - 15 doors equipped with Dok Loks
 - 37 doors equipped with dock seals
- 2 drive-in doors
- 157 auto parks
- Front Load Configuration
- 28' clear
- Truck Court depth: 140'
- ESFR sprinkler system
- LED lighting 30 FC at 36" AFF on open floor plan
- M1-A Zoning Fulton County within City of South Fulton
- Fully fenced and secured
- Full dock canopy
- Power: 5,500 A, 480/277 V
- 22 HVLS fans throughout

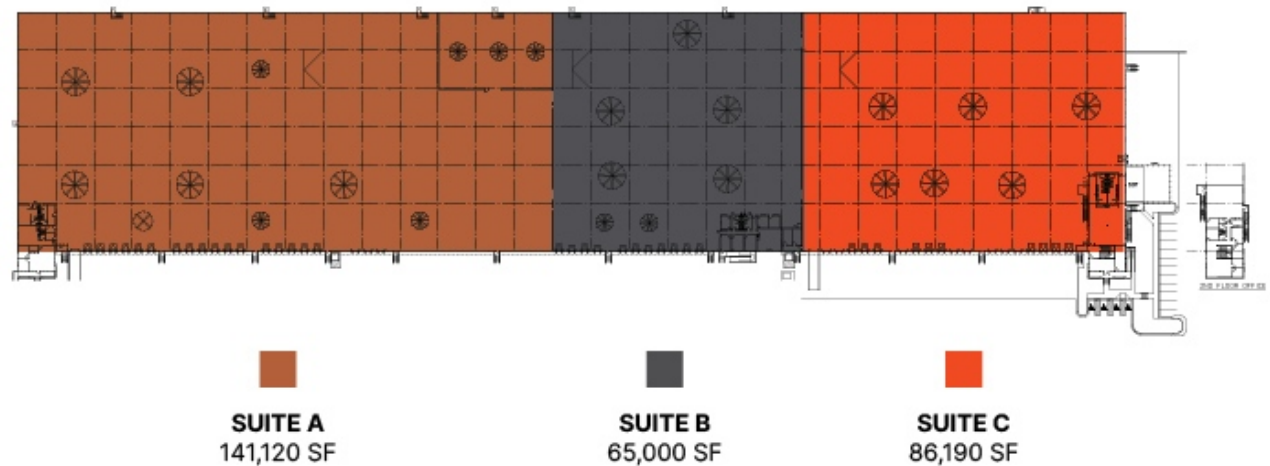

Suite A

141,120 SF

20 dock positions

15 doors equipped with pit levelers

2 door equipped with Edge of Dock levelers

12 doors equipped with Dok Loks

16 doors equipped with dock seals

7 docks equipped with swing lights

1 drive-in door

Office SF: 2,778 SF

Power: 3,000 A, 480/277 V service
shared with suite B

4 air changes per hour

Humidistat package on exhaust fans

LED lighting 30 FC at 36" AFF on open
floor plan

58 auto parks

12 knock out positions

9 HVLS fans

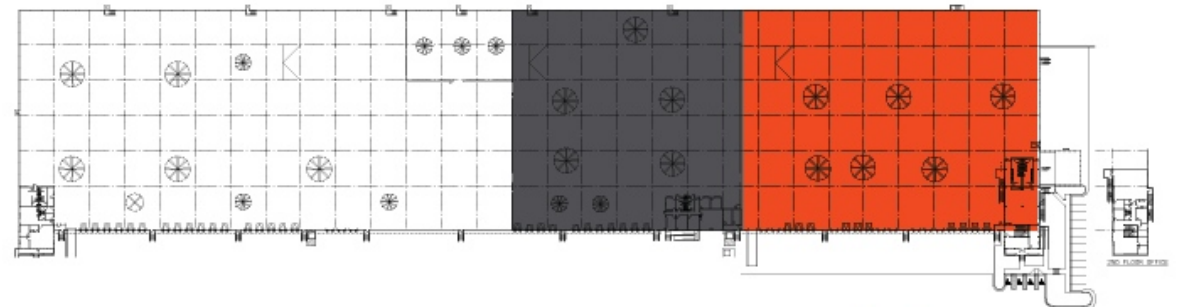
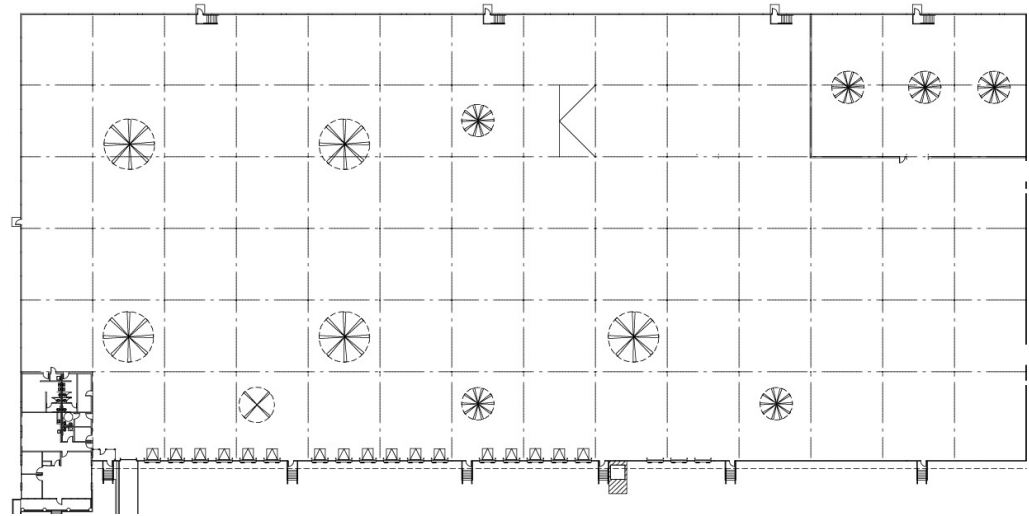

□
SUITE A
141,120 SF

■
SUITE B
65,000 SF

■
SUITE C
86,190 SF

Suite B

65,000 SF

11 dock positions

10 doors equipped with pit levelers

3 doors equipped with Dok Loks

10 doors equipped with dock seals

11 docks equipped with swing lights

Power: 3,000 A, 480/277 V service shared with suite A

Lighting: LED lighting 30 FC at 36" AFF on open floor plan

2,400 SF of office

23 auto parks

7 HVLS fans

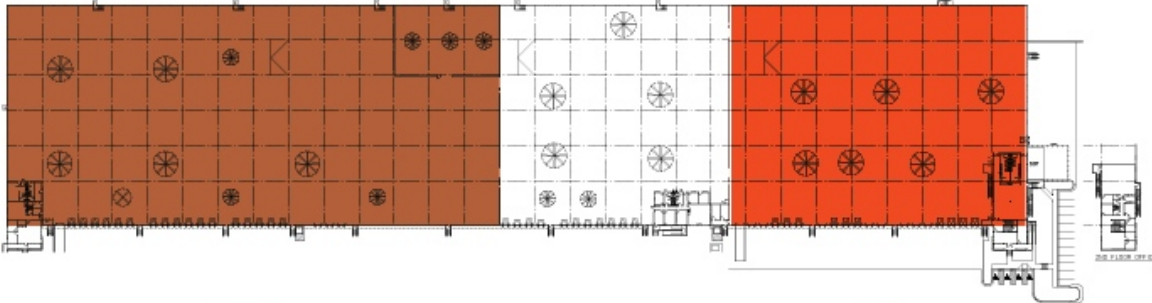
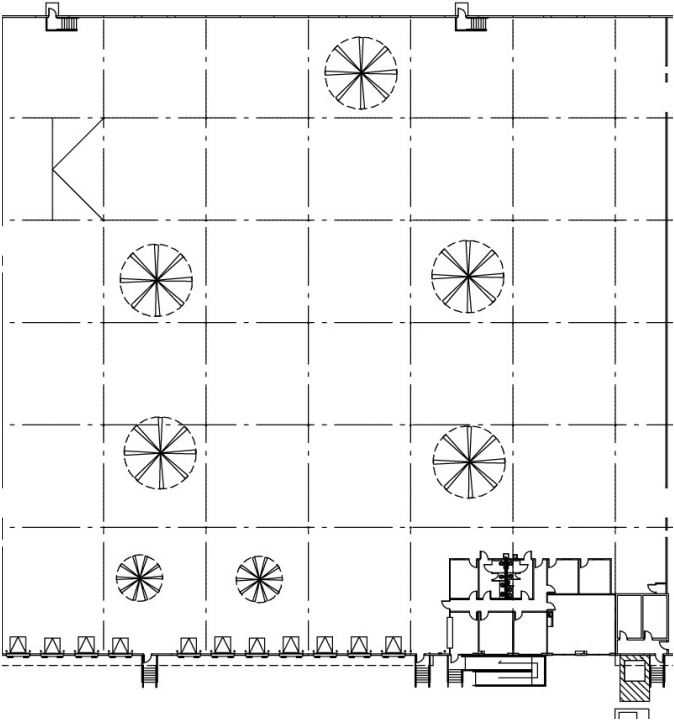

SUITE A
141,120 SF

SUITE B
65,000 SF

SUITE C
86,190 SF

Suite C

86,190 SF

19 dock positions

11 doors equipped with pit levelers

11 doors equipped with dock seals

3 docks equipped with swing lights

1 drive-in door

Power: 2,500 A, 480/277 V

Lighting: LED lighting 30 FC at 36" AFF on open floor plan

7,983 SF of office inclusive of 3,880 SF of mezzanine

76 auto parks

7 HVLS fans

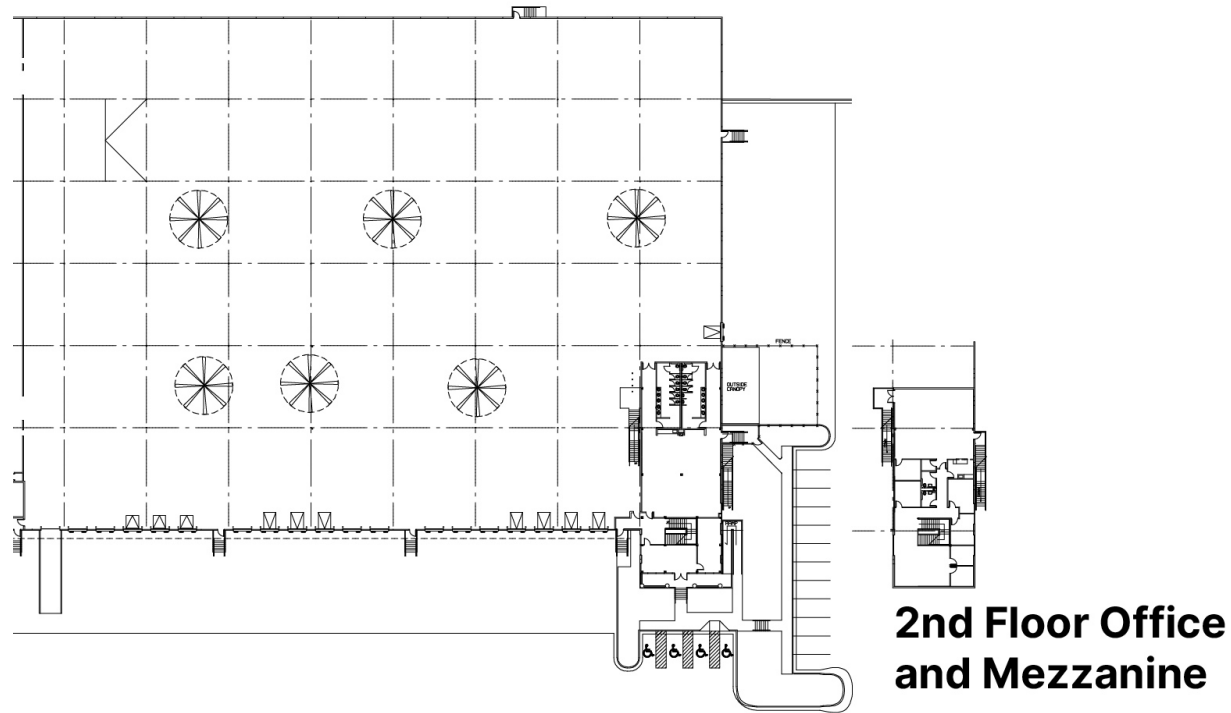

2nd Floor Office and Mezzanine

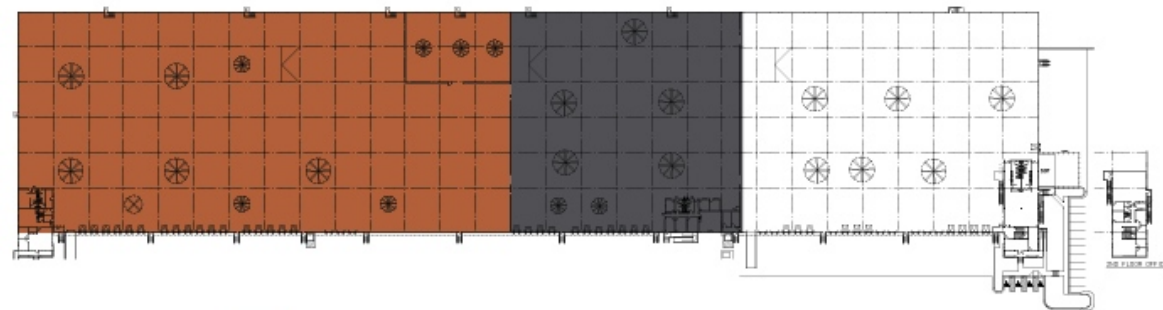

SUITE A
141,120 SF

SUITE B
65,000 SF

SUITE C
86,190 SF

Area Amenities

Dining, retail, and service amenities are located just moments from Atlanta West Distribution Center.

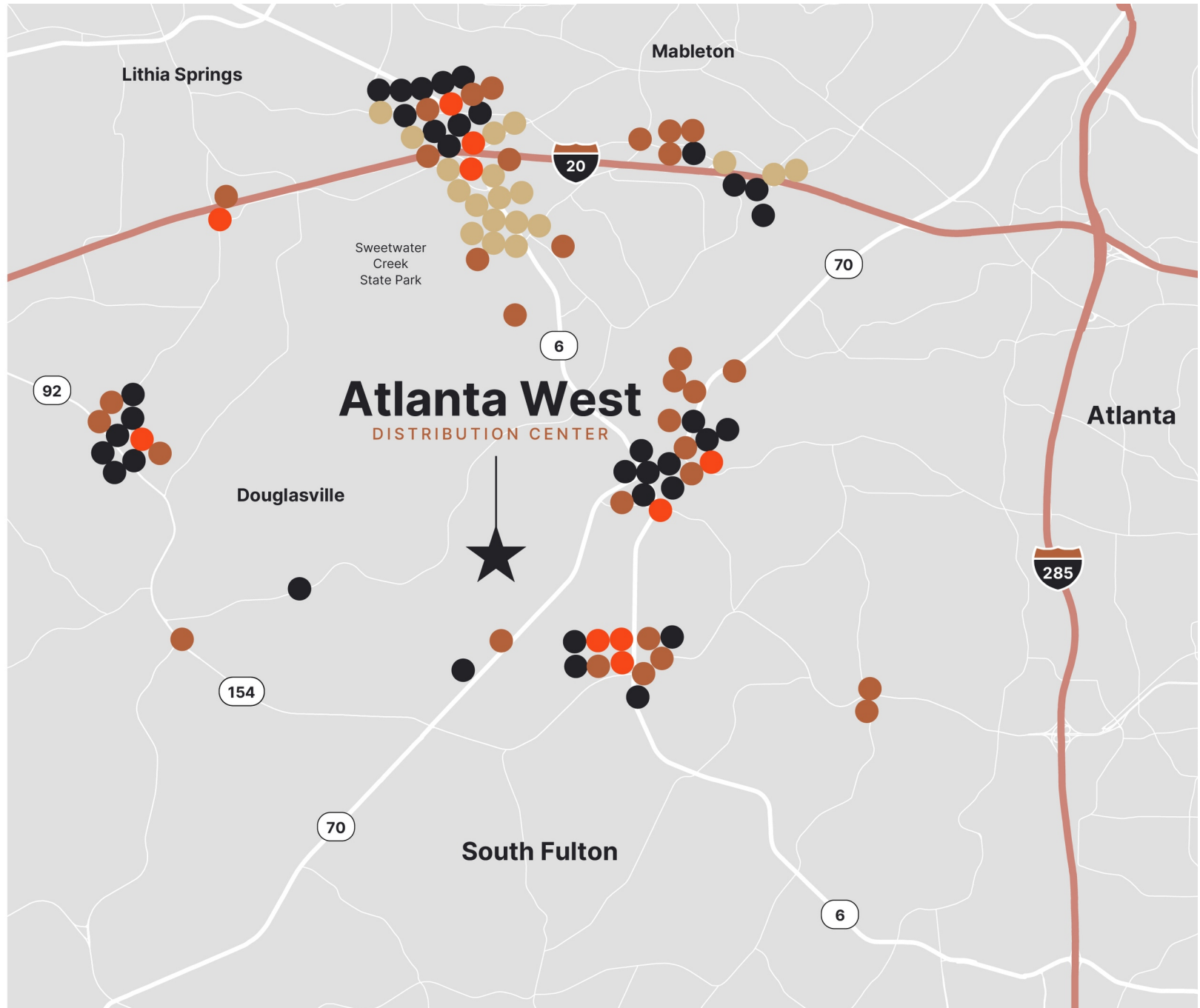

Location & Access

With convenient access to major interstates, ports, and airports, Atlanta West Distribution Center provides efficient connectivity for distribution and logistics operations.

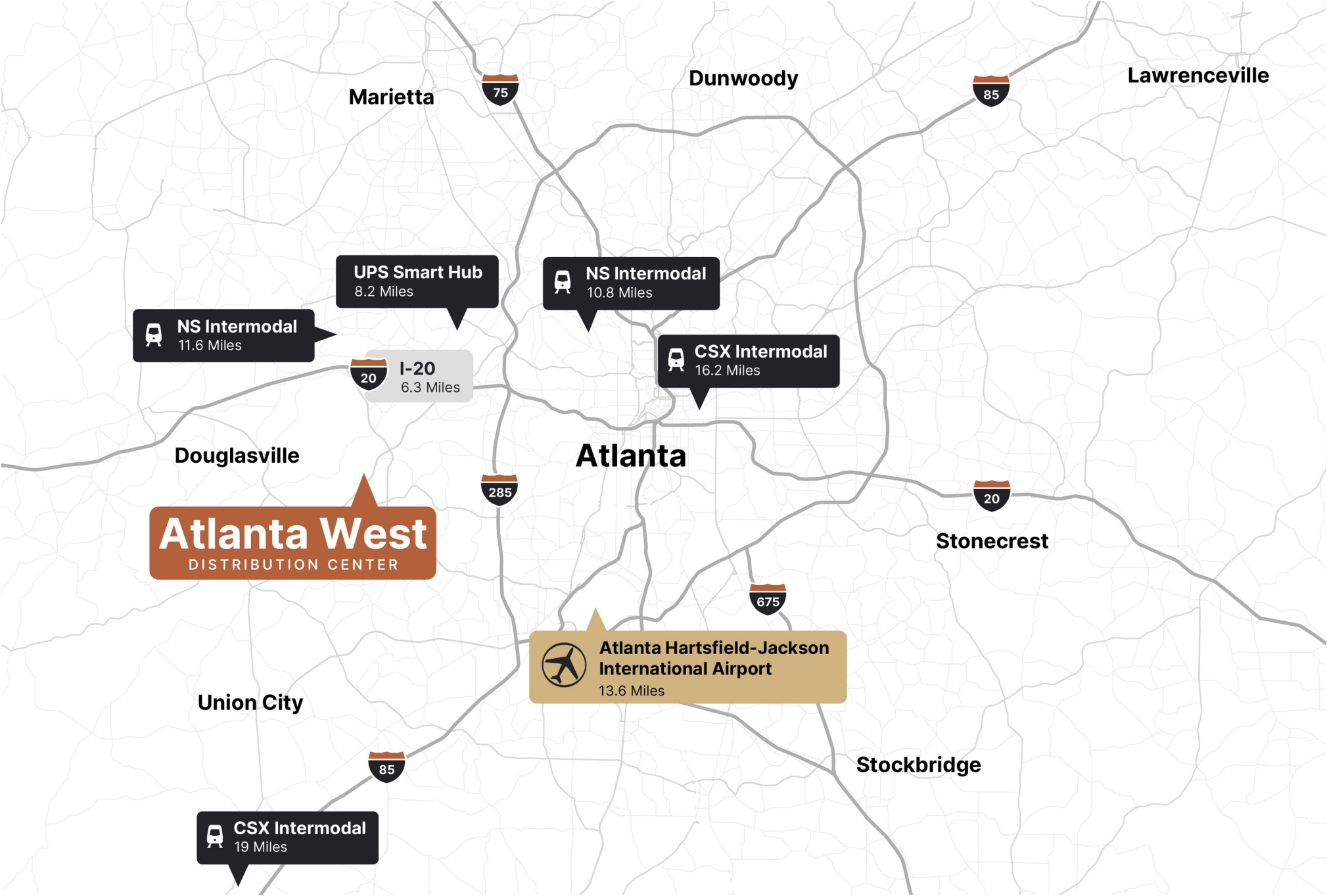

Corporate Neighbors



CONTACT INFORMATION

6300 Boat Rock Boulevard
Atlanta, GA 30336

JAMES PHILLPOTT

james.phillpott@cushwake.com
+1 404 259 7130

HELEN CAUTHEN

helen.cauthen@cushwake.com
+1 865 806 3561

CONNOR LARKIN

connor.larkin@cushwake.com
+1 404 683 3582

This document is for informational purposes only and does not constitute an offer or acceptance of a lease. Any lease agreement must be in writing and signed by the landlord. No representations or warranties are made except as expressly stated in a signed lease. Information is provided "as is" and may be subject to errors or change without notice.

©2026 Cushman & Wakefield. All rights reserved. The information contained in this communication is strictly confidential. This information has been obtained from sources believed to be reliable but has not been verified. no warranty or representation, express or implied, is made as to the condition of the property (or properties) referenced herein or as to the accuracy or completeness of the information contained herein, and same is submitted subject to errors, omissions, change of price, rental or other conditions, withdrawal without notice, and to any special listing conditions imposed by the property owner(s). any projections, opinions or estimates are subject to uncertainty and do not signify current or future property performance. PM CENTRAL COE – 3/31/26



LEASED BY

