



**3300 MISSION STREET** SAN FRANCISCO CA 94110

**± 776 SQUARE FOOT RETAIL SPACE FOR LEASE**

**EXCLUSIVELY LISTED BY:**

**DAVIS NGUYEN**

Davis@theDNgroupSF.com

415.418.4171

DRE 01509978

**LENA KWANG**

Lena@theDNgroupSF.com

714.313.0585

DRE 02156531

# EXECUTIVE SUMMARY

## 3300 MISSION STREET San Francisco CA 94110



Offered at \$48 PSF M.G.

Unit Size ± 776 Sq Ft

Zoning NCD

Cross Street 29th Street

Year Built 2025

Occupancy Date October 2026

3300 Mission Street is a newly constructed corner retail space located on the border of the Bernal Heights neighborhood and Mission District in San Francisco. The ±776 square foot space offers excellent visibility with strong frontage along the highly trafficked Mission Street, making it an ideal opportunity for businesses seeking prominent brand exposure.

Positioned in a vibrant commercial corridor, the property is zoned NCD and is suitable for a variety of retail or service-oriented uses. The space is surrounded by a mix of local retailers and popular restaurants, contributing to consistent foot traffic and neighborhood activity.

The location benefits from convenient access to major freeways and nearby public transportation, providing connectivity throughout the city and beyond. This is a rare opportunity to establish a presence in one of San Francisco's most sought-after communities.



# FLOOR PLAN

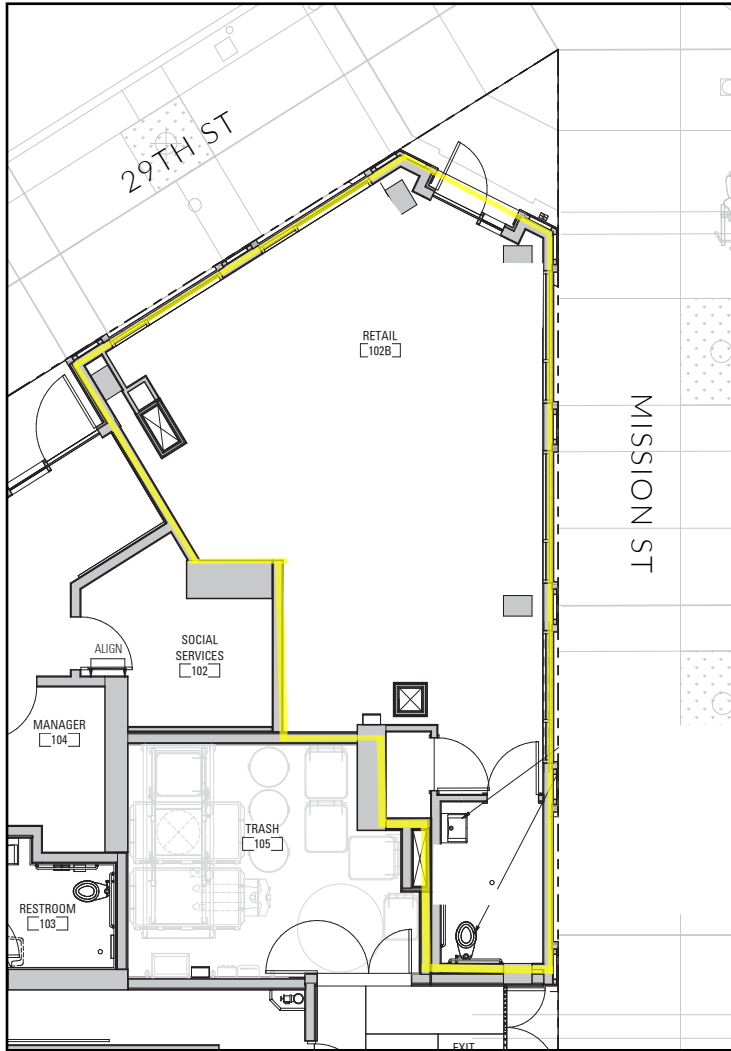

# LOCATION MAP

1. BART - 24th St & Mission St
2. Arizmendi Bakery
3. Synergy School
4. Salvation Army
5. CMPC Mission Bernal Campus
6. Cellarmaker House of Pizza
7. Blue Plate
8. Coleridge Mini Park
9. The UPS Store
10. Mitchell's Ice Cream
11. Safeway
12. Upper Noe Recreation Center
13. The Rabbit Hole
14. Dolores Huerta Elementary School
15. Shell
16. Pinhole Coffee
17. Bernal Heights Branch Library
18. Junipero Serra Early Elementary School
19. Holly Park
20. Arlington Community Garden

Prime **Mission District/Bernal Heights** location serving as a key westside gateway to the Mission Street commercial corridor to and from I-280.

Walk Score **97**

Transit Score **81**

Bike Score **77**

## Commute Times

SFO Airport **20m** by car

Bay Bridge **25m** by car

Golden Gate Bridge **30m** by car

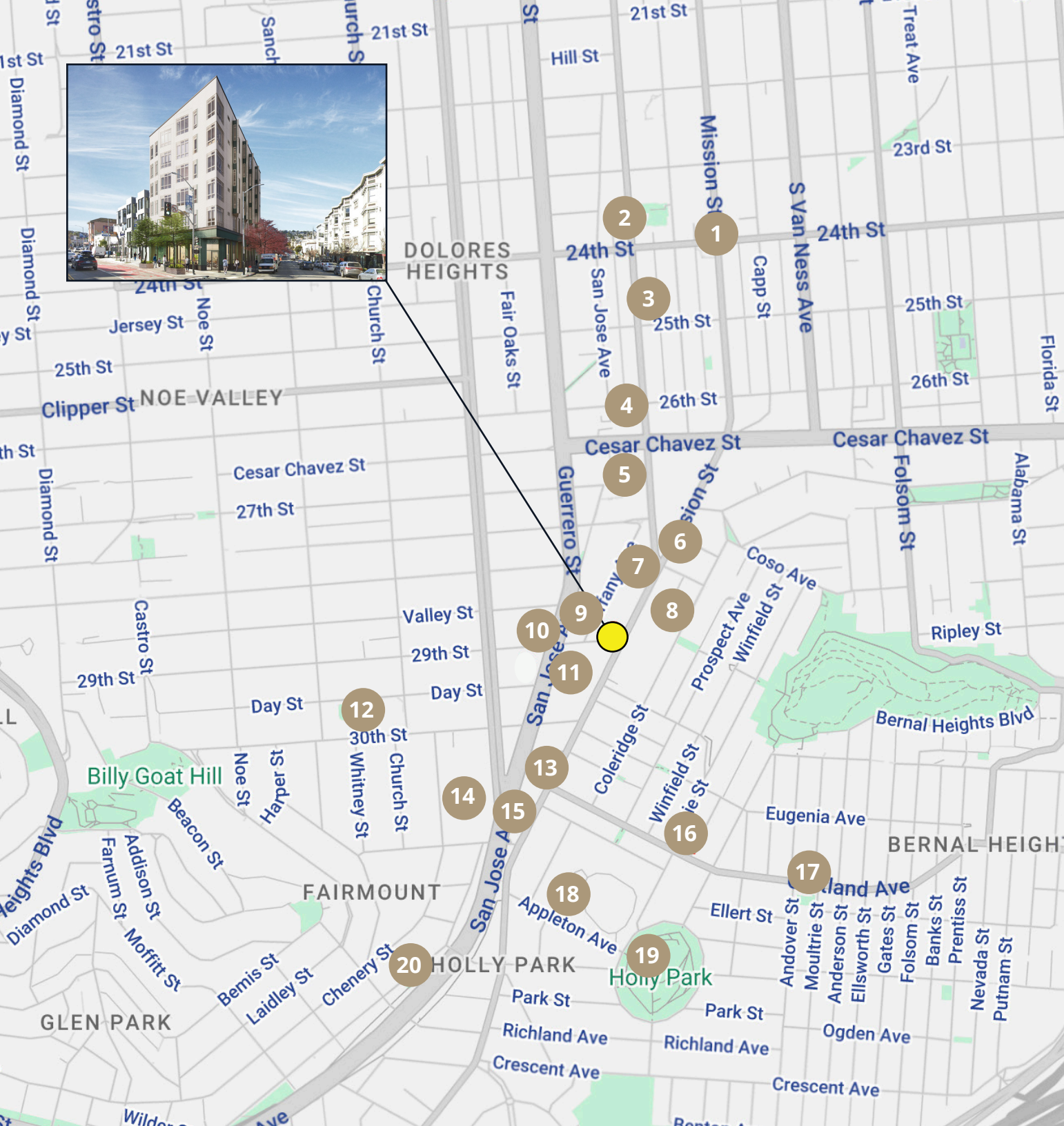

# CONFIDENTIALITY & DISCLOSURE

## COMPASS COMMERCIAL

All materials and information received or derived from Compass Commercial - San Francisco & Los Angeles its directors, officers, agents, advisors, affiliates and/or any third party sources are provided without representation or warranty as to completeness, veracity, or accuracy, condition of the property, compliance or lack of compliance with applicable governmental requirements, developability or suitability, financial performance of the property, projected financial performance of the property for any party's intended use or any and all other matters. Neither Compass Commercial - San Francisco & Los Angeles its directors, officers, agents, advisors, or affiliates makes any representation or warranty, express or implied, as to accuracy or completeness of the any materials or information provided, derived, or received. Materials and information from any source,

whether written or verbal, that may be furnished for review are not a substitute for a party's active conduct of its own due diligence to determine these and other matters of significance to such party. Compass Commercial - San Francisco & Los Angeles will not investigate or verify any such matters or conduct due diligence for a party unless otherwise agreed in writing.

EACH PARTY SHALL CONDUCT ITS OWN INDEPENDENT INVESTIGATION AND DUE DILIGENCE.

Any party contemplating or under contract or in escrow for a transaction is urged to verify all information and to conduct their own inspections and investigations including through appropriate third party independent professionals selected by such party. All financial data should be verified by the party including by obtaining and reading applicable documents and reports and consulting appropriate independent professionals. Compass Commercial - San Francisco & Los Angeles makes no warranties and/or representations regarding the veracity, completeness, or relevance of any financial data or assumptions. Compass Commercial - San Francisco & Los Angeles does not serve as a financial advisor to any party regarding any proposed transaction. All data and assumptions regarding financial performance, including that used for financial modeling purposes, may differ from actual data or performance. Any estimates of market rents and/or projected rents that may be provided to a party do not necessarily mean that rents can be established at or increased to that level. Parties must evaluate any applicable contractual and governmental limitations as well as market conditions, vacancy factors and other issues in order to determine rents from or for the property.

Legal questions should be discussed by the party with an attorney. Tax questions should be discussed by the party with a certified public accountant or tax attorney. Title questions should be discussed by the party with a title officer or attorney. Questions regarding the condition of the property and whether the property complies with applicable governmental requirements should be discussed by the party with appropriate engineers, architects, contractors, other consultants and governmental agencies. All properties and services are marketed by Compass Commercial - San Francisco & Los Angeles in compliance with all applicable fair housing and equal opportunity laws.



### Davis Nguyen

415.418.4171  
Davis@theDNgroupSF.com  
theDNgroupSF.com  
DRE #01509978

### Lena Kwang

714.313.0585  
Lena@theDNgroupSF.com  
theDNgroupSF.com  
DRE #02156531

