

1212 S PERSIMMON ST. | TOMBALL, TX 77375

KC BUSINESS PARK



±1,500 - 24,000 SF OFFICE/WAREHOUSE AVAILABLE FOR LEASE

JORDAN ENGER
Senior Associate
+1 713 577 1779
jordan.enger@cbre.com

NICK BERGMANN
Vice President
+1 713 577 1772
nick.bergmann@cbre.com

CBRE

KC BUSINESS PARK



±1,500 - ±24,000 SF
BUILDING SIZE RANGE



BTS
OFFICE SIZE



Grade Level
LOADING



21'
CLEAR HEIGHT



**600 Amps, 277/480V,
3 Phase**
POWER



Metal
CONSTRUCTION



Off-Site
DETENTION



City of Tomball
UTILITIES



5.00 Acres
TOTAL LAND SIZE



**Less than 3 Mi from SH 249
& 99 (Grand Parkway)**
ACCESS



2026
DELIVERING

BUILDING 1 - ±13,930 SF

BUILDING 1

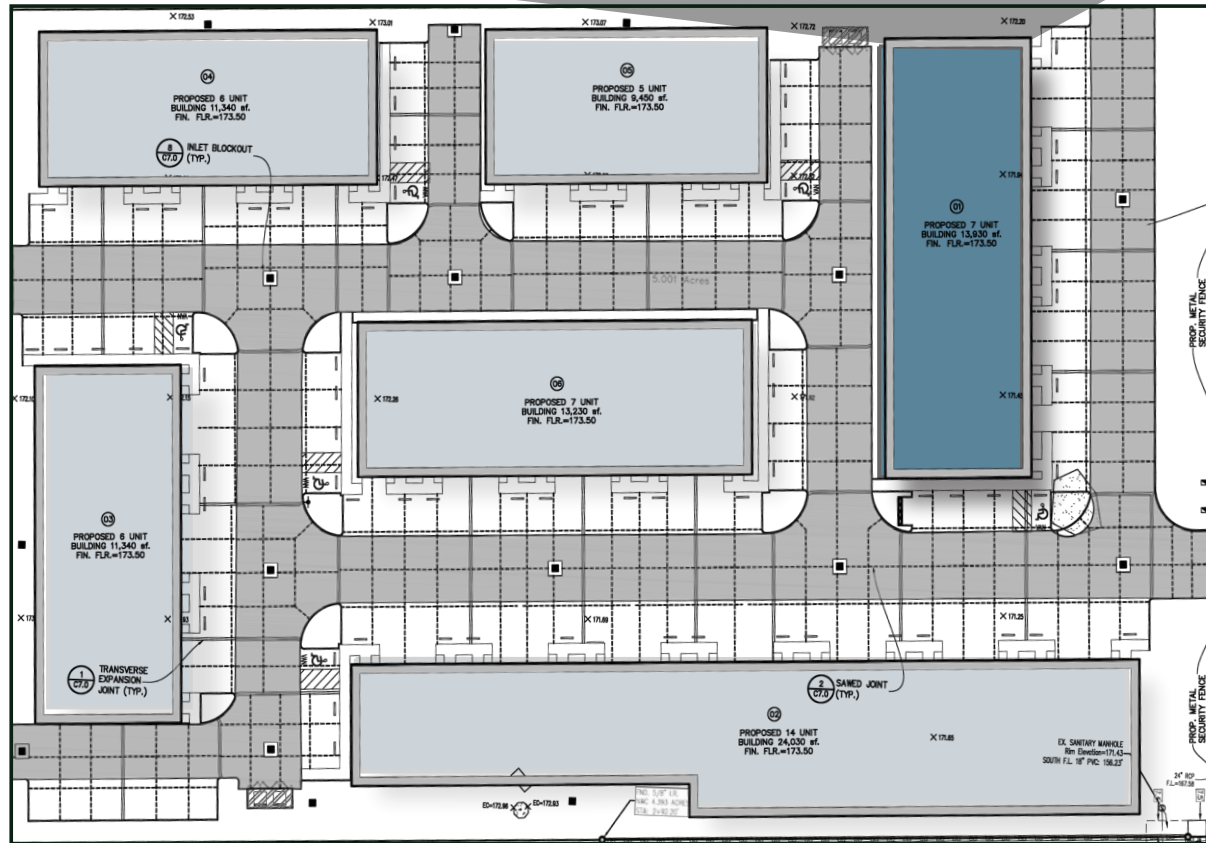
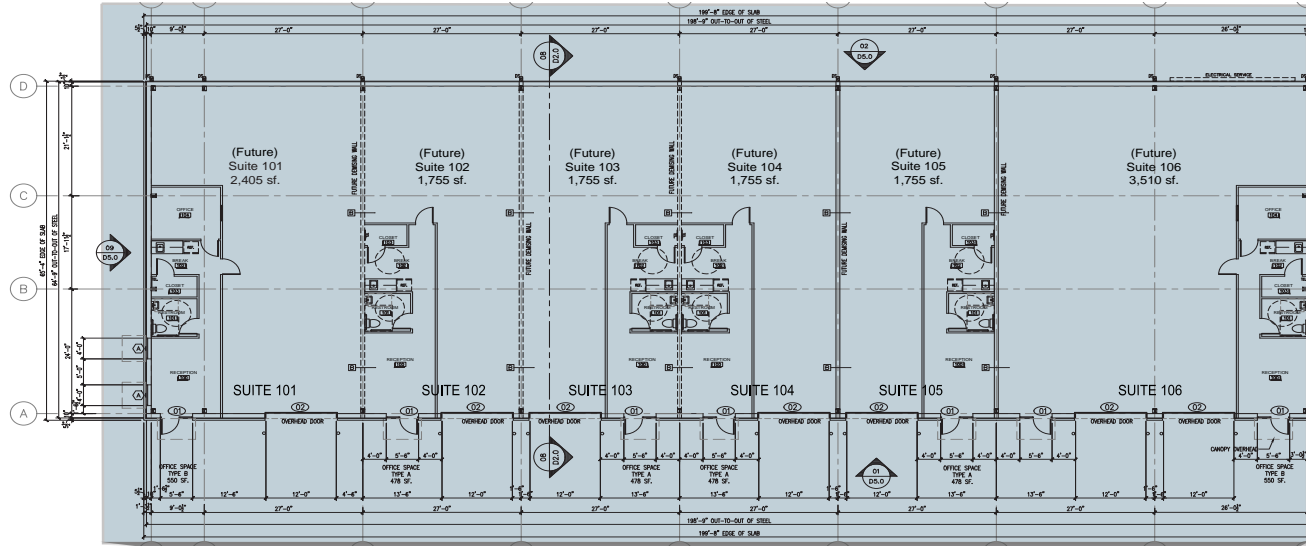

BUILDING 2 - ±24,030 SF

BUILDING 2

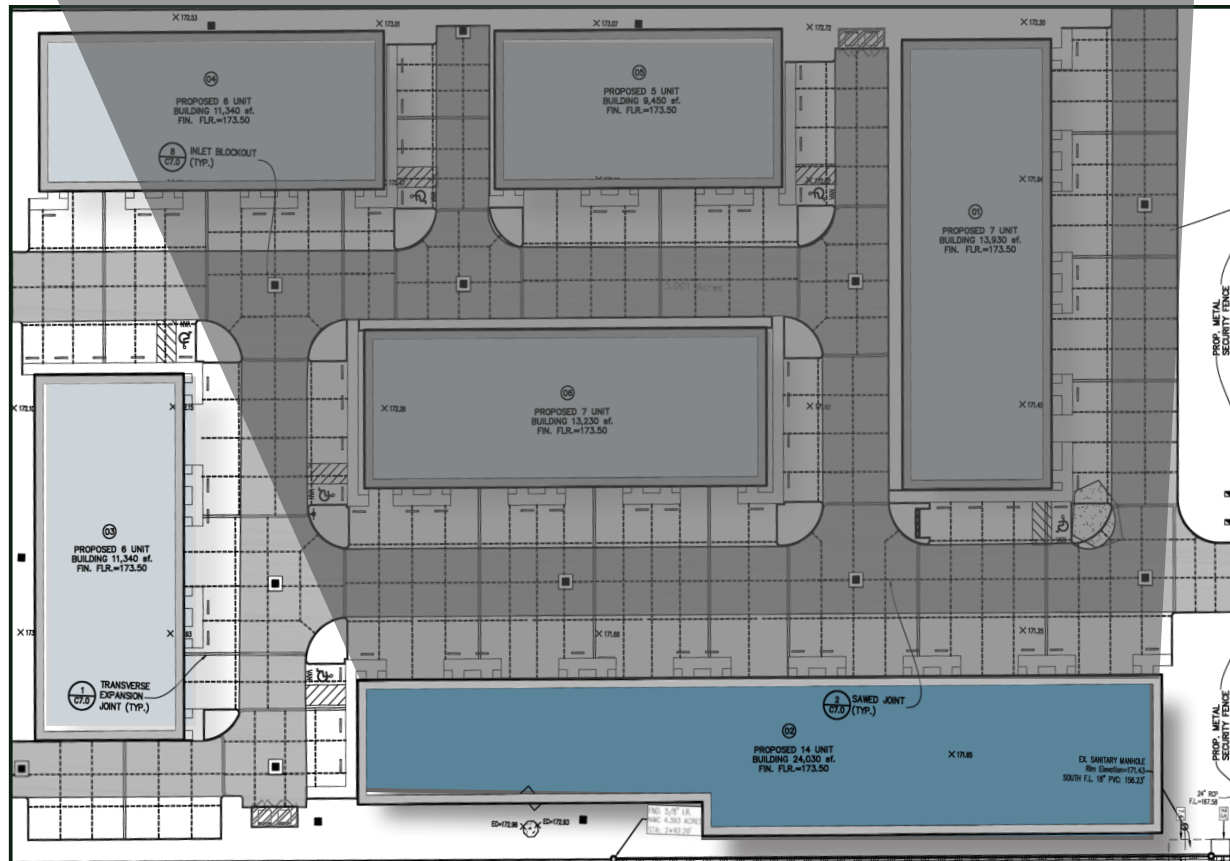
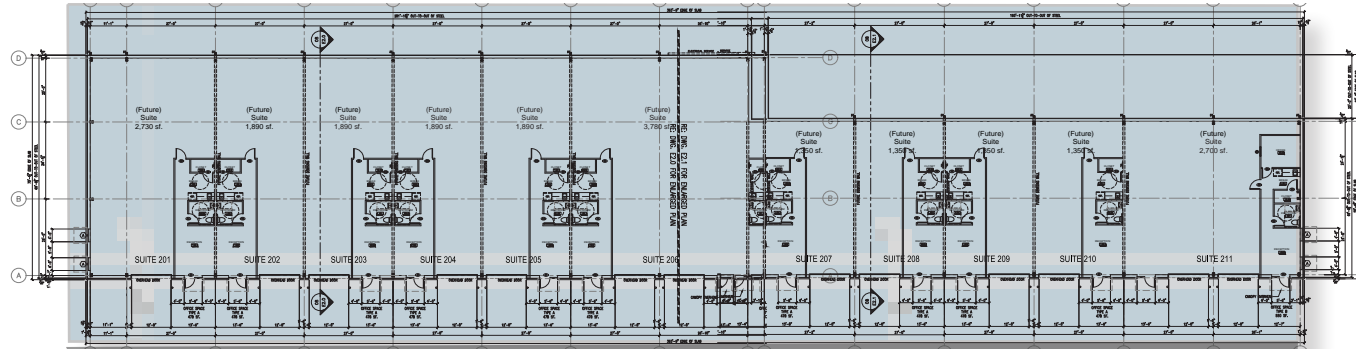

BUILDING 4 - ±11,340 SF

BUILDING 4

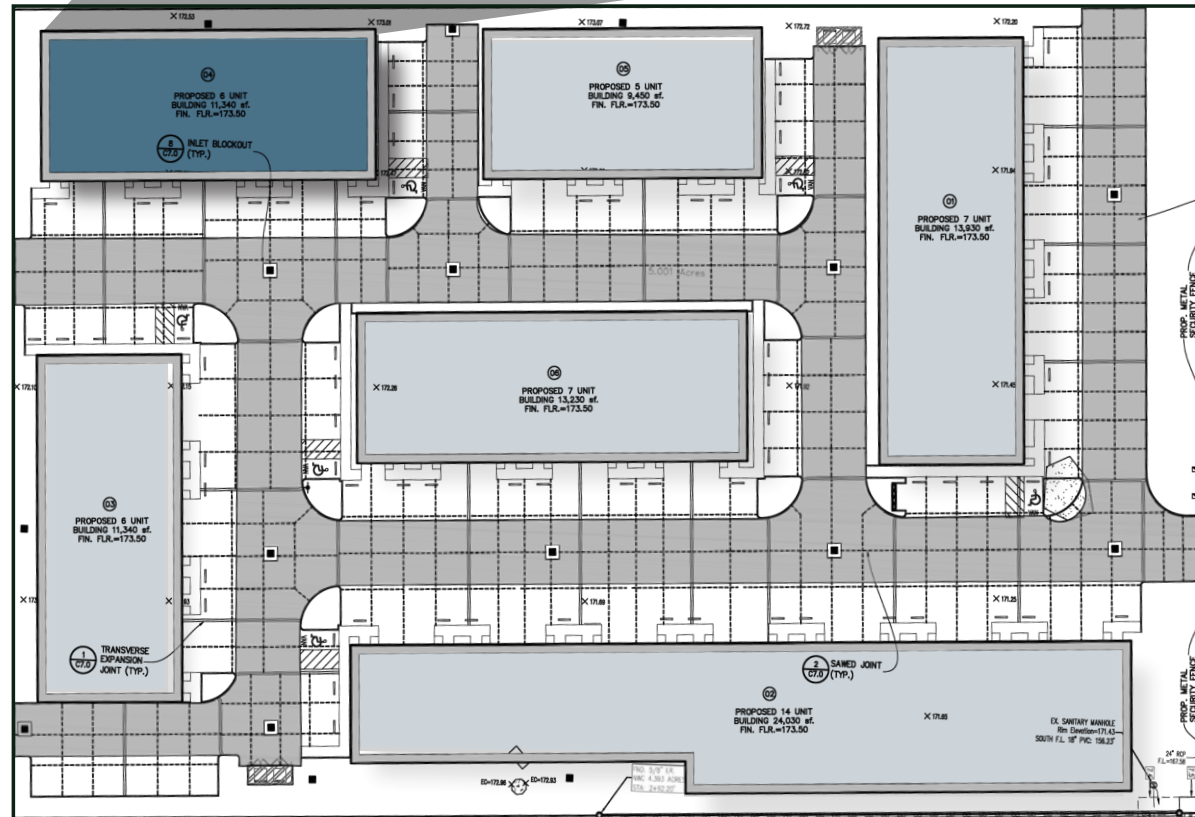
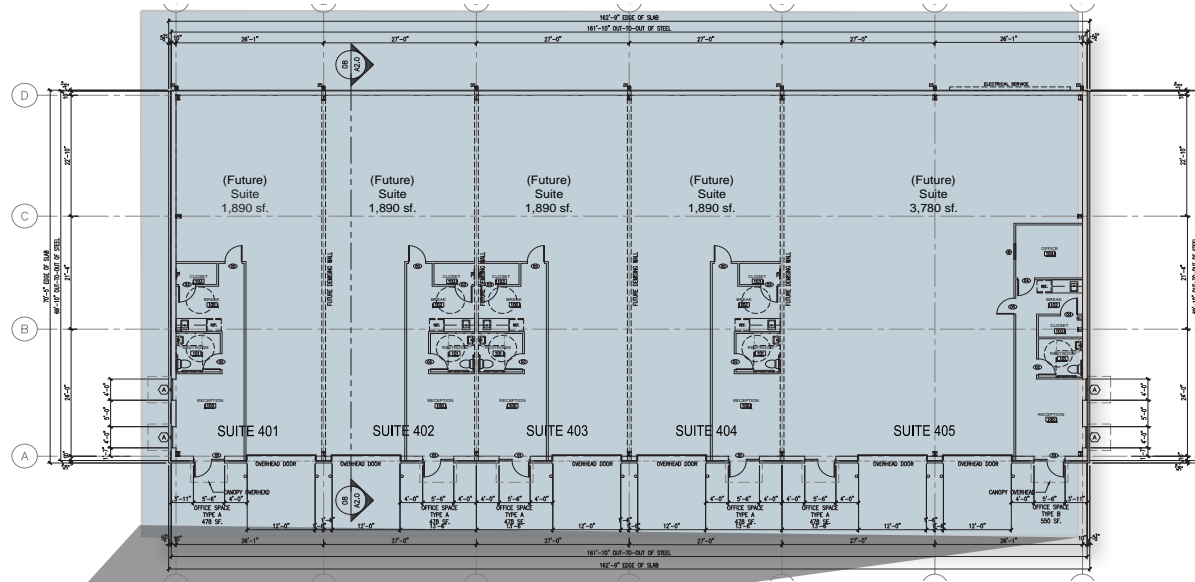

BUILDING 5 - ±9,450 SF

BUILDING 5

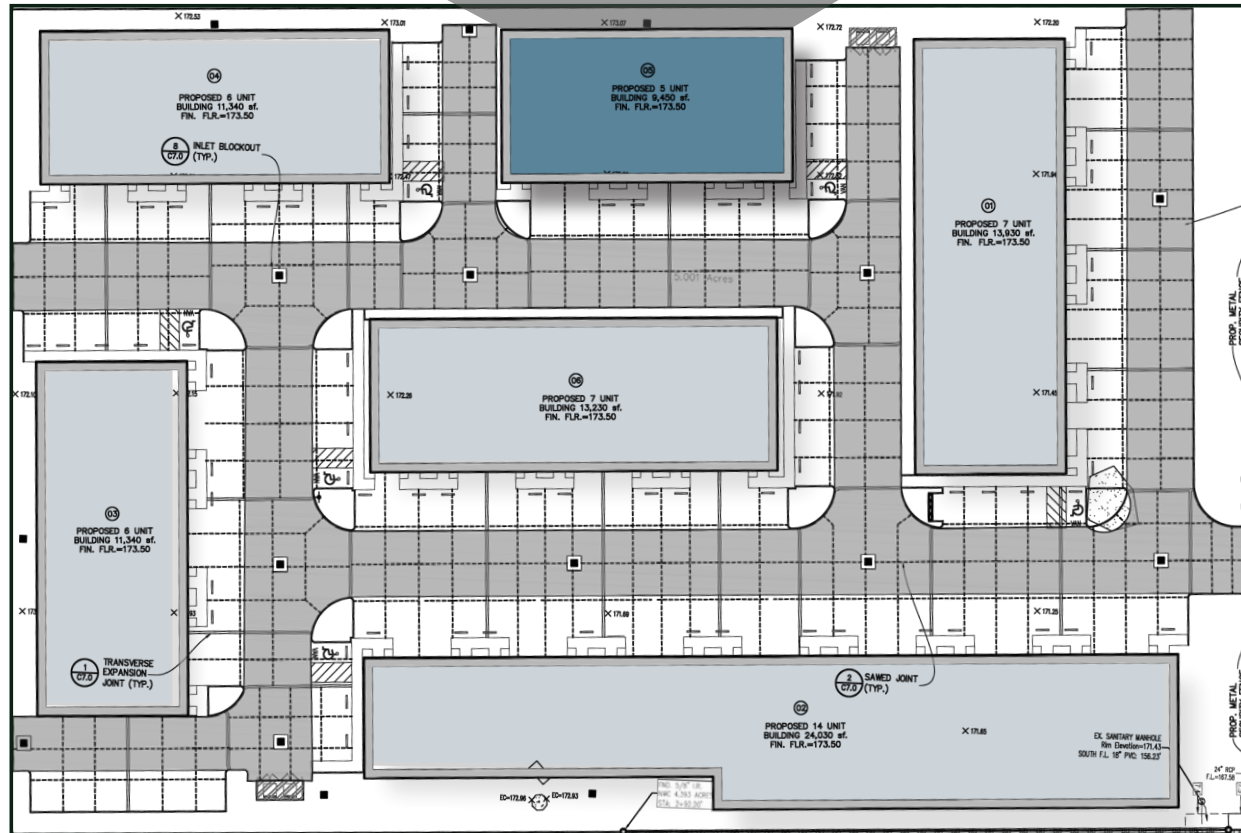
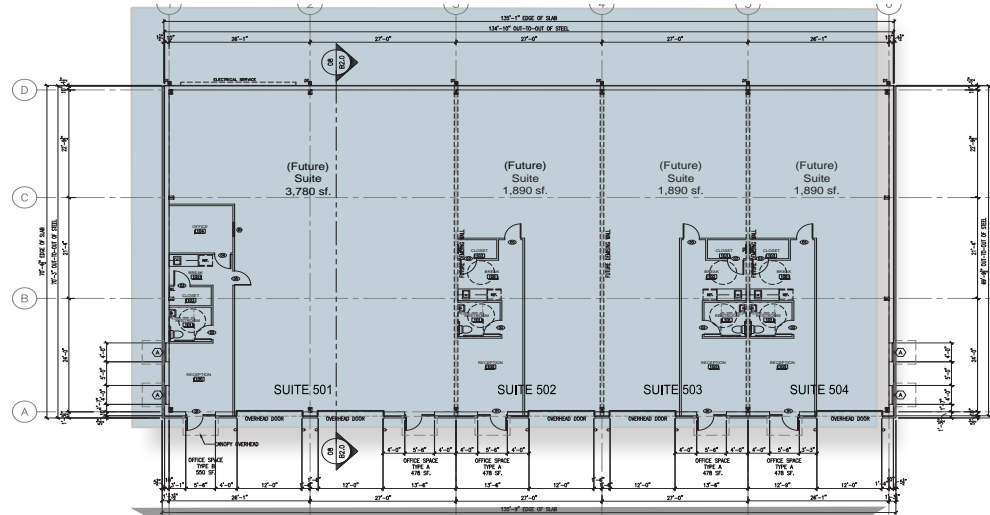

BUILDING 6 - ±13,230 SF

BUILDING 6

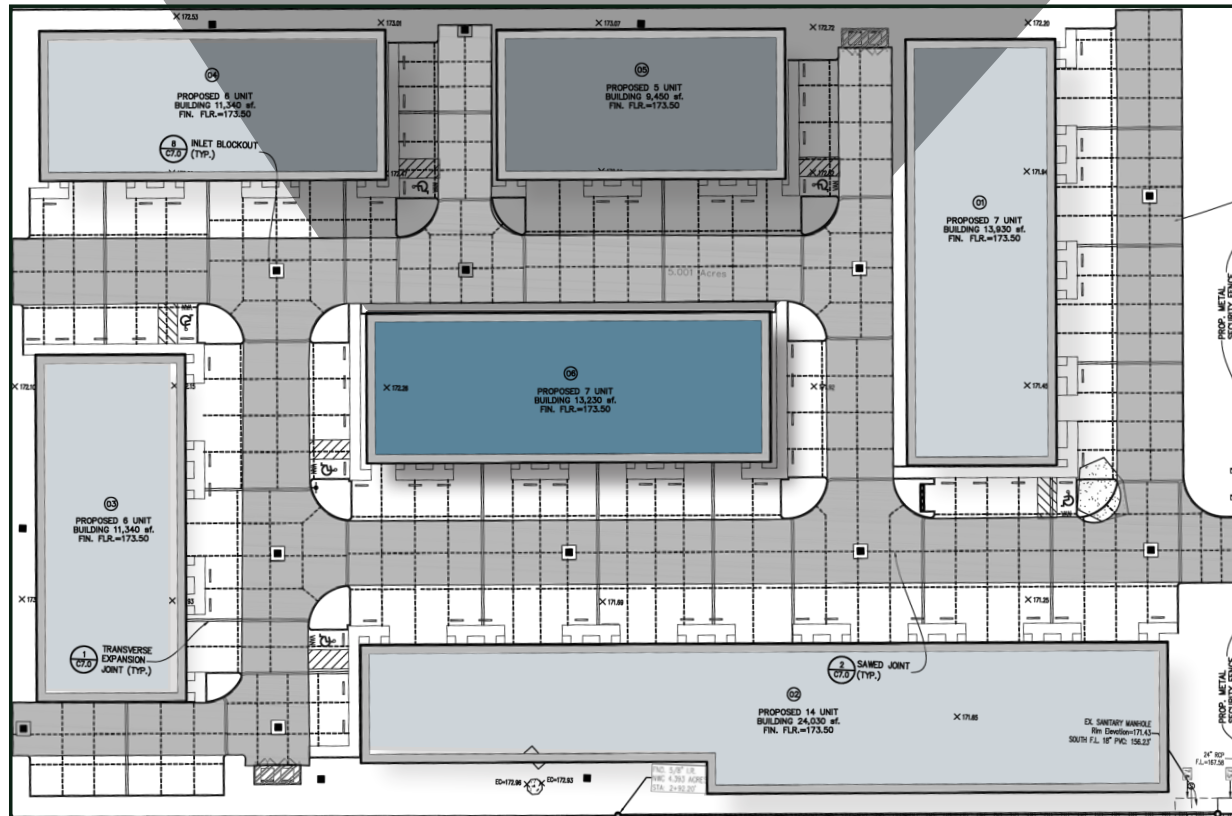
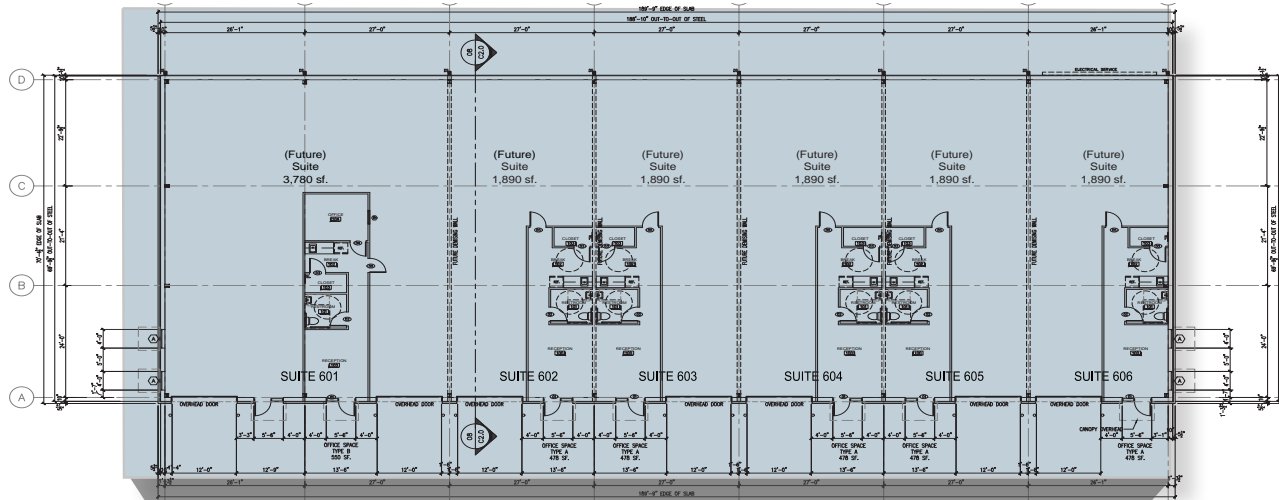

REGIONAL CONNECTIVITY





FOR LEASE

KC BUSINESS PARK

FOR MORE INFORMATION

JORDAN ENGER
Senior Associate
+1 713 577 1779
jordan.enger@cbre.com

NICK BERGMANN
Vice President
+1 713 577 1772
nick.bergmann@cbre.com

© 2025 CBRE, Inc. All rights reserved. This information has been obtained from sources believed reliable, but has not been verified for accuracy or completeness. You should conduct a careful, independent investigation of the property and verify all information. Any reliance on this information is solely at your own risk. CBRE and the CBRE logo are service marks of CBRE, Inc. All other marks displayed on this document are the property of their respective owners, and the use of such logos does not imply any affiliation with or endorsement of CBRE. Photos herein are the property of their respective owners. Use of these images without the express written consent of the owner is prohibited.PMStudio_January2025

CBRE