

These are the notes referred to on the following official copy

Title Number GM848232

The electronic official copy of the document follows this message.

This copy may not be the same size as the original.

Please note that this is the only official copy we will issue. We will not issue a paper official copy.

Transfer of part of registered title(s)

HM Land Registry

TP1

(if you need more room than is provided for in this panel, use continuation sheet CS and staple to this form)

1. Stamp Duty

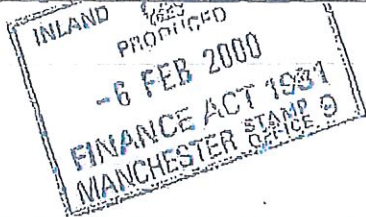

70 £2000

Place "X" in the box that applies and complete the box in the appropriate certificate

It is certified that this instrument falls within category in the Schedule to the Stamp Duty (Exempt Instruments) Regulations 1987

It is certified that the transaction effected does not form part of a larger transaction or of a series of transactions in respect of which the amount or value or the aggregate amount or value of the consideration exceeds the sum of

£ 250 000

2. Title number(s) out of which the Property is transferred (leave blank if not yet registered)

GM295270

3. Other title number(s) against which matters contained in this transfer are to be registered (if any)

4. Property transferred (insert address, including postcode, or other description of the property transferred. Any physical exclusions, e.g. mines and minerals, should be defined. Any attached plan must be signed by the transferor and by or on behalf of the transferee.)

940, 942, 944, 950/2, 954/6 Stockport Road Levenshulme Manchester



GM634394

The property is defined: (place "X" in the box that applies and complete the statement)

on the attached plan and shown (state reference e.g. "edged red")
edged red



SEQ48

on the Transferor's filed plan(s) and shown (state reference e.g. "edged and numbered 1 in blue")

5. Date 7th January 2000

6. Transferor (give full names and Company's Registered Number if any)

Colin Radiven Millicent Alice Radiven and Diane Bartle

7. Transferee for entry on the register (Give full names and Company's Registered Number if any; for Scottish Co. Reg. Nos., use an SC prefix. For foreign companies give territory in which incorporated.)

Dawood Ahmad

Unless otherwise arranged with Land Registry headquarters, a certified copy of the transferee's constitution (in English or Welsh) will be required if it is a body corporate but is not a company registered in England and Wales or Scotland under the Companies Acts.

8. Transferee's intended address(es) for service in the U.K. (including postcode) for entry on the register

90 Glenn Eagles Road
Heald Green Road
Cheadle
SK9 3EN

9. The Transferor transfers the Property to the Transferee.

10. Consideration (Place "X" in the box that applies. State clearly the currency unit if other than sterling. If none of the boxes applies, insert an appropriate memorandum in the additional provisions panel.)

The Transferor has received from the Transferee for the Property the sum of (in words and figures)
Two hundred thousand pounds (£200 000)
 (insert other receipt as appropriate)

The Transfer is not for money or anything which has a monetary value

11. The Transferor transfers with (place "X" in the box which applies and add any modifications)

full title guarantee limited title guarantee

12. Declaration of trust Where there is more than one transferee, place "X" in the appropriate box.

- The Transferees are to hold the Property on trust for themselves as joint tenants.
- The Transferees are to hold the Property on trust for themselves as tenants in common in equal shares.
- The Transferees are to hold the Property (complete as necessary)

13. Additional Provisions

1. Use this panel for:

- definitions of terms not defined above
- rights granted or reserved
- restrictive covenants
- other covenants
- agreements and declarations
- other agreed provisions
- required or permitted statements, certificates or applications.

2. The prescribed subheadings may be added to, amended, repositioned or omitted.

Definitions

"the Plan" means the plan annexed to this Transfer
"the Property" means the land edged red on the Plan

continued on continuation sheet

Rights granted for the benefit of the Property

1. A right of way on foot only at all times over the land coloured blue on the Plan
2. The right to free and uninterrupted passage and running of water soil gas electricity and other services from and to the Property through the sewers drains watercourses pipes cables and other conducting media now laid in under through or upon the Retained Land

10. Consideration (Place "X" in the box that applies. State clearly the currency unit if other than sterling. If none of the boxes applies, insert an appropriate memorandum in the additional provisions panel.)

- The Transferor has received from the Transferee for the Property the sum of (in words and figures)
Two hundred thousand pounds (£200 000)
 (insert other receipt as appropriate)
- The Transfer is not for money or anything which has a monetary value

11. The Transferor transfers with (place "X" in the box which applies and add any modifications)

- full title guarantee limited title guarantee

12. Declaration of trust Where there is more than one transferee, place "X" in the appropriate box.

- The Transferees are to hold the Property on trust for themselves as joint tenants.
 The Transferees are to hold the Property on trust for themselves as tenants in common in equal shares.
 The Transferees are to hold the Property (complete as necessary)

13. Additional Provisions

1. Use this panel for:

- definitions of terms not defined above
- rights granted or reserved
- restrictive covenants
- other covenants
- agreements and declarations
- other agreed provisions
- required or permitted statements, certificates or applications.

2. The prescribed subheadings may be added to, amended, repositioned or omitted.

Definitions

"the Plan" means the plan annexed to this Transfer
"the Property" means the land edged red on the Plan

continued on continuation sheet

Rights granted for the benefit of the Property

1. A right of way on foot only at all times over the land coloured blue on the Plan
2. The right to free and uninterrupted passage and running of water soil gas electricity and other services from and to the Property through the sewers drains watercourses pipes cables and other conducting media now laid in under through or upon the Retained Land

Rights reserved for the benefit of other land (the land having the benefit should be defined, if necessary by reference to a plan)

The right to free and uninterrupted passage and running of water soil gas electricity and other services from and to the the Retained Land through the sewers drains watercourses pipes cables and other conducting media now laid in under through or upon the Property

Restrictive covenants by the Transferee (include words of covenant)

The Transferee covenants (so as to bind the whole and every part of the Property) with the Transferor for the benefit of the Retained Land not to do or suffer to be done on the Property anything which may be or grow to be a nuisance or annoyance to the Transferor or its successors in title or owners for the time being of the Retained Land

Restrictive covenants by the Transferor (include words of covenant)

The Transferors and the Transferee hereby mutually agree that from the date of this Transfer that the Rentcharge shall be paid out of and charged on the Property

14. The Transferors and all other necessary parties (including the proprietors of all the titles listed in panel 3) should execute this transfer as a deed using the space below and sign the plan. Forms of execution are given in Schedule 3 to the Land Registration Rules 1925. If the transfer contains transferees' covenants or declarations or contains an application by them (e.g. for a restriction), it must also be executed by the Transferees.

SIGNED AS A DEED by the said)
COLIN RADIVEN)
in the presence of :

[Handwritten signature]

... M. White

address *109 Overstay Ct.
Greatlands Rd.
Sale M33 3QZ*

occupation *Housewife*

SIGNED AS A DEED by the said)
MILLICENT ALICE RADIVEN)
in the presence of :

[Handwritten signature]

... M. White

address *109 Overstay Ct.
Greatlands Rd.
Sale M33 3QZ*

occupation *Housewife*

continued on continuation sheet

Continuation sheet
for use with
application and
disposition forms

HM Land Registry

CS

1. Continued from Form TP1 Title number(s) GM295270

2. Before each continuation, state panel to be continued, e.g. "Panel 12 continued".

continued from panel 13

"The Rentcharge" means the balance of the rentcharge of £18.55 created by a Conveyance dated 22nd March 1848 and made between (1) Edmund Coston and (2) Francis Smith payable out of the land comprised in the title above mentioned taking into account previous apportionments

"the Retained Land" means the land edged green on the Plan to be retained by the Transferor

continued from panel 14

SIGNED AS A DEED by the said)
DIANE BARTLE)
in the presence of :

Diane Bartle

..... *M. White*

address *111... everley ct.
Brooklands, DD
Salisbury, Wiltshire, SP2 8JL*

occupation

SIGNED AS DEED by the said)
DAWOOD AHMAD)
in the presence of :

Dawood Ahmad

..... *[Signature]*

address *11 Ditchdown
2cs. Farnley
Hemel Hempstead*

occupation *[Signature]*

(insert sheet number and total number of continuation sheets e.g. "sheet 1 of 3")

H. M. LAND REGISTRY

NATIONAL GRID PLAN SJ 8794 SECTION P
GREATER MANCHESTER
MANCHESTER DISTRICT Scale 1:1250

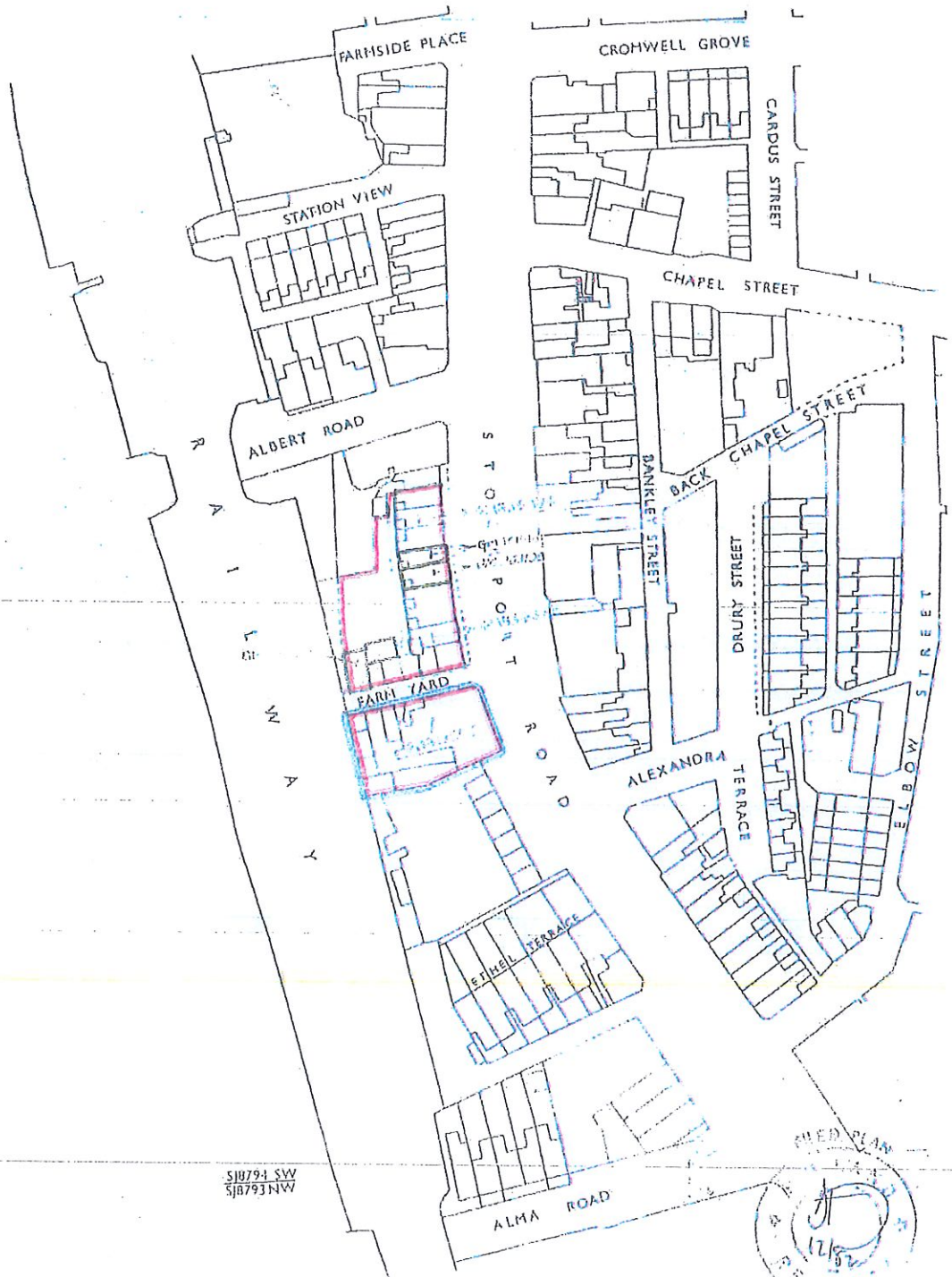

SJ8794 SW
SJ8793 NW

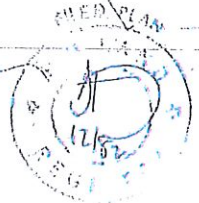

GM 848232

TITLE No. **GM 295270**

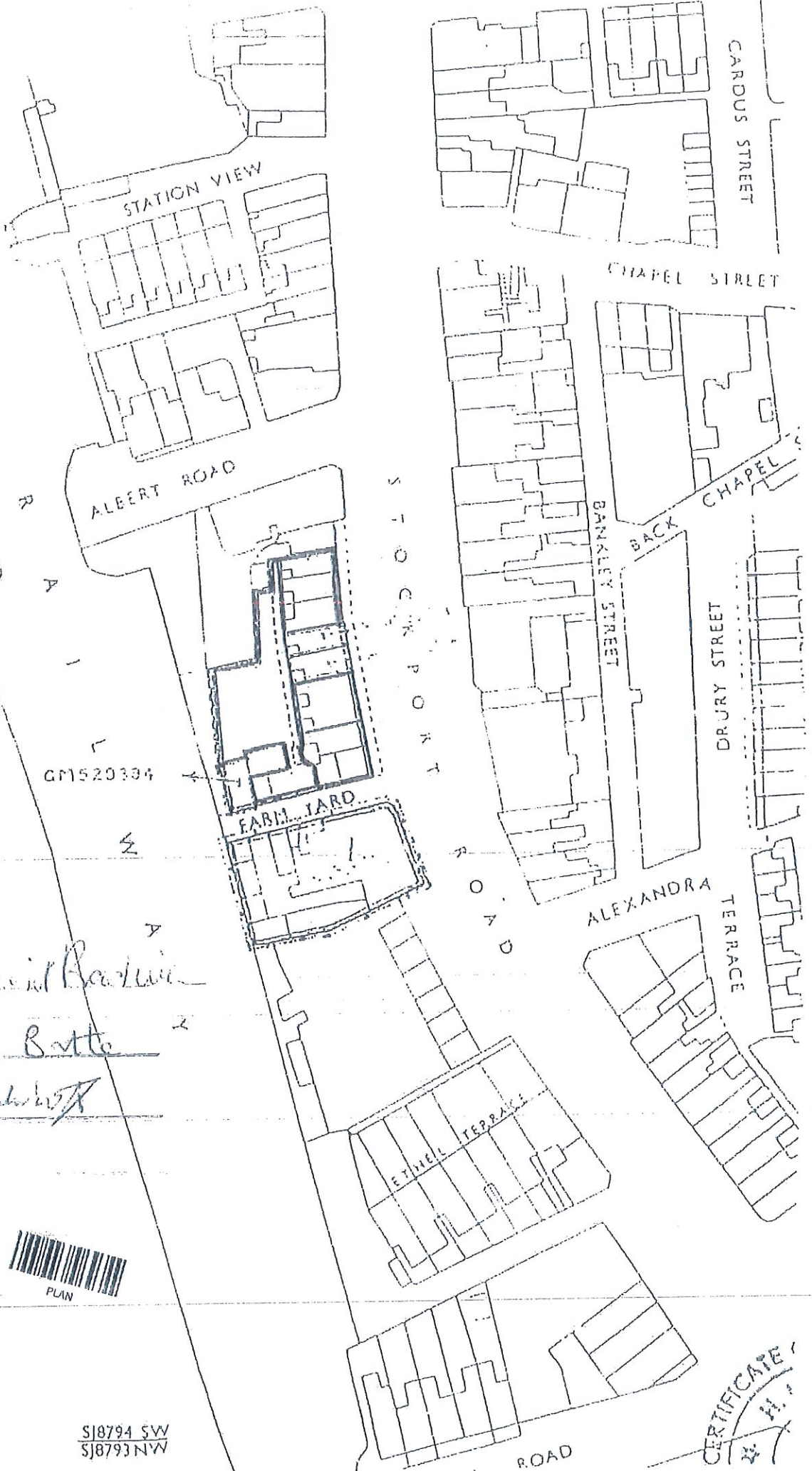

GM520304

Maxwell Barker
Prize Battle
Robert A



S18794 SW
 S18793 NW

CERTIFICATE
 H.P.

These are the notes referred to on the following official copy

The electronic official copy of the title plan follows this message.

Please note that this is the only official copy we will issue. We will not issue a paper official copy.

This official copy was delivered electronically and when printed will not be to scale. You can obtain a paper official copy by ordering one from HM Land Registry.

This official copy is issued on 10 June 2019 shows the state of this title plan on 10 June 2019 at 18:56:15. It is admissible in evidence to the same extent as the original (s.67 Land Registration Act 2002). This title plan shows the general position, not the exact line, of the boundaries. It may be subject to distortions in scale. Measurements scaled from this plan may not match measurements between the same points on the ground. This title is dealt with by the HM Land Registry, Fylde Office .

Crown copyright. Produced by HM Land Registry. Reproduction in whole or in part is prohibited without the prior written permission of Ordnance Survey. Licence Number 100026316.

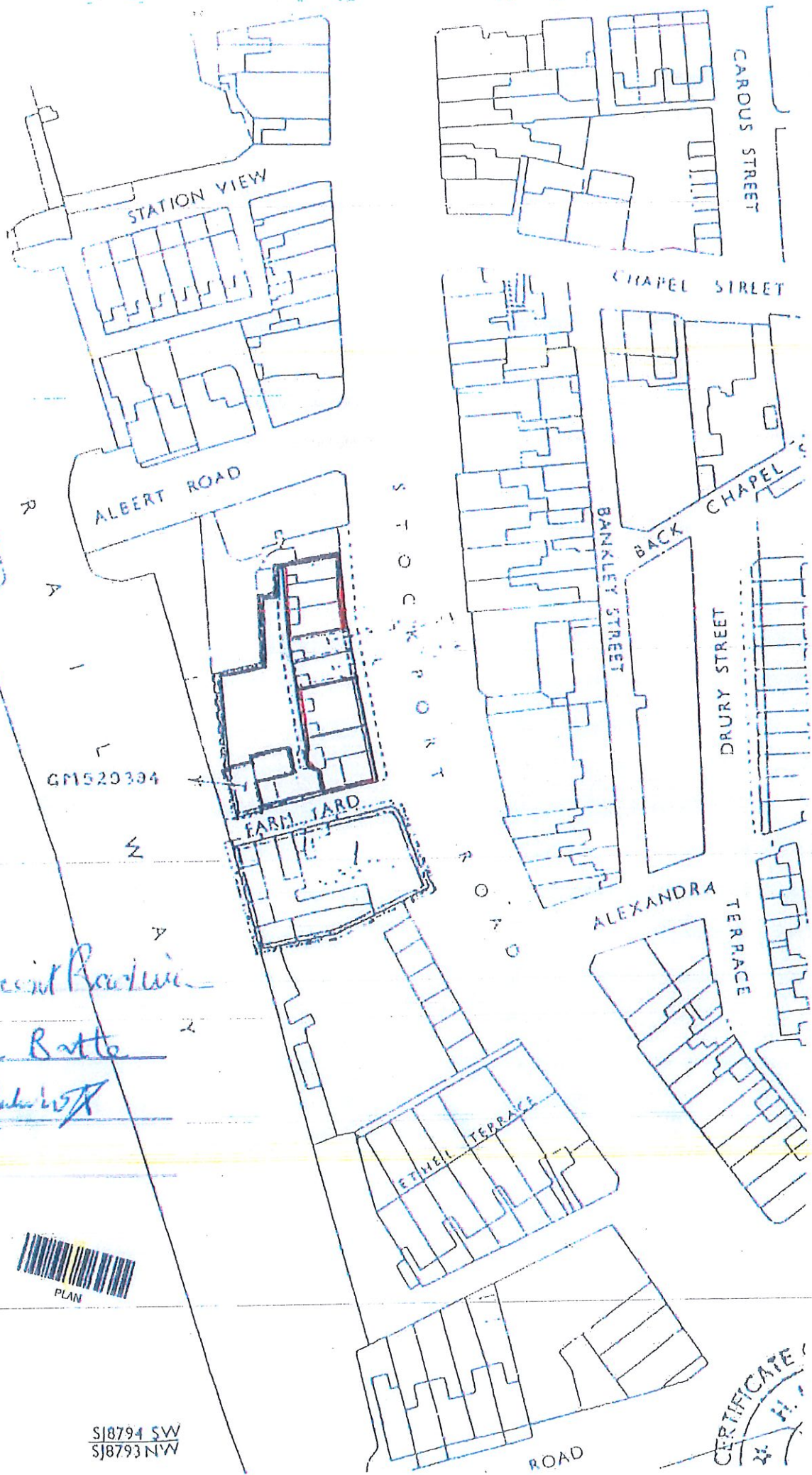

Melvin B. ...
Diana B. ...
Robert ...



SJ8794 SW
 SJ8793 NW

CERTIFICATE
 H. H.
 24

H. M. LAND REGISTRY

NATIONAL GRID PLAN SJ 8794 SECTION P
GREATER MANCHESTER
MANCHESTER DISTRICT Scale 1:1250

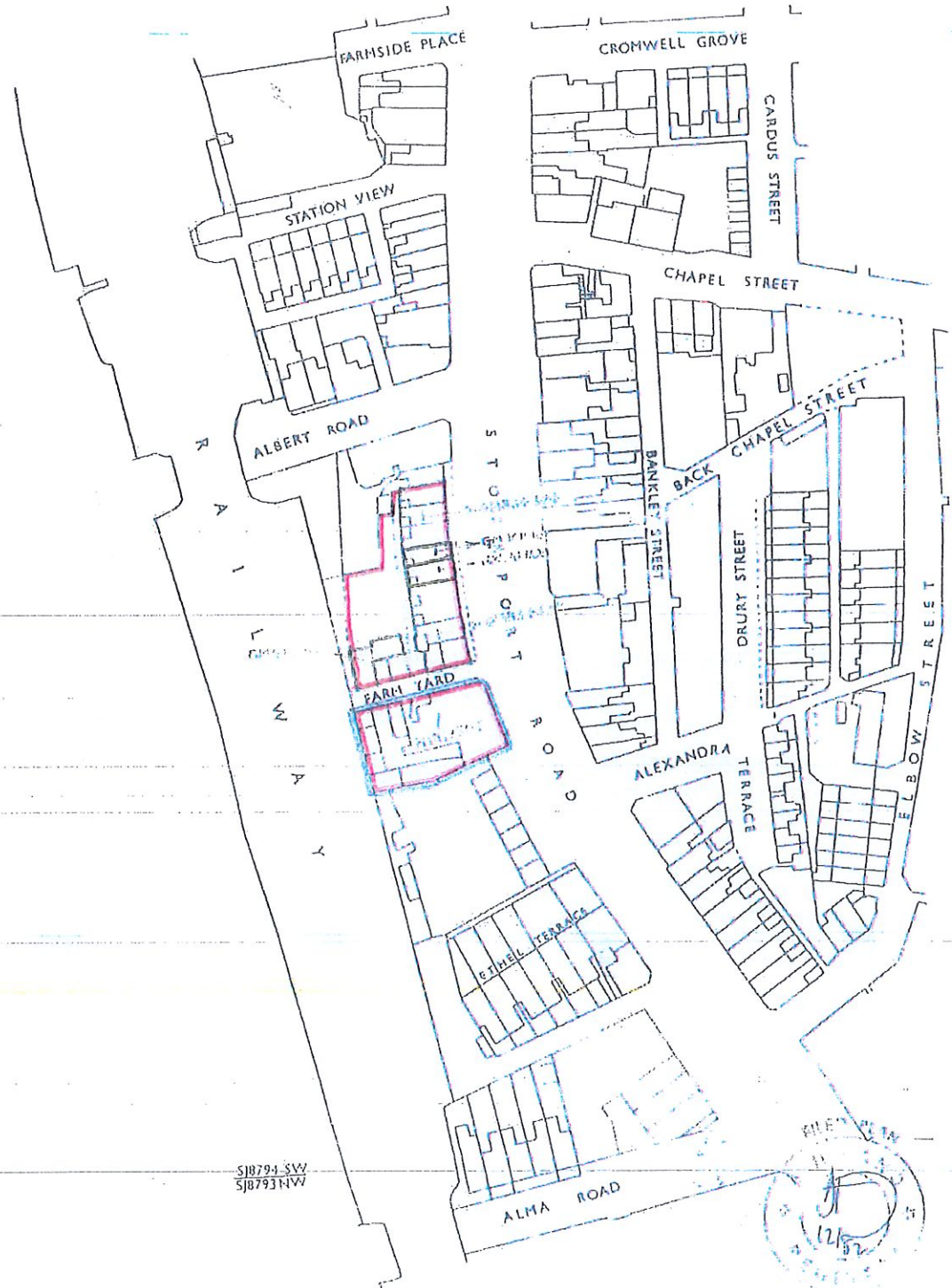

S18794-SW
S18794-NW

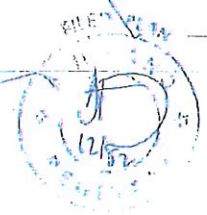

GM 848232

TITLE No. GM 29527A

© Crown Copyright 1973

TP CM 834-304

Transfer of part of registered title(s)

HM Land Registry

TP1

(if you need more room than is provided for in this panel, use continuation sheet GS and staple to this form)

1. Stamp Duty

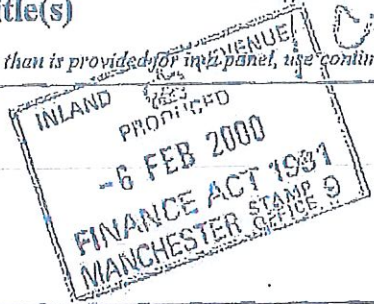

PD £2000

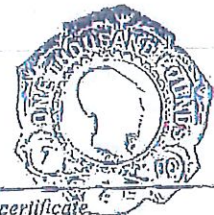

Place "X" in the box that applies and complete the box in the appropriate certificate

It is certified that this instrument falls within category in the Schedule to the Stamp Duty (Exempt Instruments) Regulations 1987

It is certified that the transaction effected does not form part of a larger transaction or of a series of transactions in respect of which the amount or value or the aggregate amount or value of the consideration exceeds the sum of

2. Title number(s) out of which the Property is transferred (leave blank if not yet registered)
GM295270

3. Other title number(s) against which matters contained in this transfer are to be registered (if any)

4. Property transferred (insert address, including postcode, or other description of the property transferred. Any physical exclusions, e.g. mines and minerals, should be defined. Any attached plan must be signed by the transferor and by or on behalf of the transferee.)
940, 942, 944, 950/2, 954/6 Stockport Road Levenshulme Manchester

The property is defined: (place "X" in the box that applies and complete the statement)

on the attached plan and shown (state reference e.g. "edged red")
edged red

on the Transferor's filed plan(s) and shown (state reference e.g. "edged and numbered 1 in blue")



GM634394

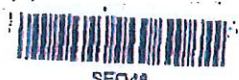

SEQ48

5. Date 7th January 2000

6. Transferor (give full names and Company's Registered Number if any)
Colin Radiven Millicent Alice Radiven and Diane Bartle

7. Transferee for entry on the register (Give full names and Company's Registered Number if any; for Scottish Co. Reg. Nos., use an SC prefix. For foreign companies give territory in which incorporated.)
Dawood Ahmad

Unless otherwise arranged with Land Registry headquarters, a certified copy of the transferee's constitution (in English or Welsh) will be required if it is a body corporate but is not a company registered in England and Wales or Scotland under the Companies Acts.

8. Transferee's intended address(es) for service in the U.K. (including postcode) for entry on the register
90 Glenn Eagles Road
Heald Green Road
Cheadle
SK9 3EN

9. The Transferor transfers the Property to the Transferee.

LRTPI/1

These are the notes referred to on the following official copy

Title Number GM848232

The electronic official copy of the document follows this message.

This copy may not be the same size as the original.

Please note that this is the only official copy we will issue. We will not issue a paper official copy.

10. Consideration (Place "X" in the box that applies. State clearly the currency unit if other than sterling, if none of the boxes applies, insert an appropriate memorandum in the additional provisions panel.)

The Transferor has received from the Transferee for the Property the sum of (in words and figures)
Two hundred thousand pounds (£200 000)

(Insert other receipt as appropriate)

The Transfer is not for money or anything which has a monetary value

11. The Transferor transfers with (place "X" in the box which applies and add any modifications)

full title guarantee limited title guarantee

12. Declaration of trust Where there is more than one transferee, place "X" in the appropriate box.

The Transferees are to hold the Property on trust for themselves as joint tenants.

The Transferees are to hold the Property on trust for themselves as tenants in common in equal shares.

The Transferees are to hold the Property (complete as necessary)

13. Additional Provisions

1. Use this panel for:

- definitions of terms not defined above
- rights granted or reserved
- restrictive covenants
- other covenants
- agreements and declarations
- other agreed provisions
- required or permitted statements, certificates or applications.

2. The prescribed subheadings may be added to, amended, repositioned or omitted.

Definitions

"the Plan" means the plan annexed to this Transfer
"the Property" means the land edged red on the Plan

continued on continuation sheet

Rights granted for the benefit of the Property

1. A right of way on foot only at all times over the land coloured blue on the Plan
2. The right to free and uninterrupted passage and running of water soil gas electricity and other services from and to the Property through the sewers drains watercourses pipes cables and other conducting media now laid in under through or upon the Retained Land

Rights reserved for the benefit of other land *(the land having the benefit should be defined, if necessary by reference to a plan)*

The right to free and uninterrupted passage and running of water soil gas electricity and other services from and to the the Retained Land through the sewers drains watercourses pipes cables and other conducting media now laid in under through or upon the Property

Restrictive covenants by the Transferee *(include words of covenant)*

The Transferee covenants (so as to bind the whole and every part of the Property) with the Transferor for the benefit of the Retained Land not to do or suffer to be done on the Property anything which may be or grow to be a nuisance or annoyance to the Transferor or its successors in title or owners for the time being of the Retained Land

Restrictive covenants by the Transferor *(include words of covenant)*

Continuation sheet
for use with
application and
disposition forms

HM Land Registry

CS

1. Continued from Form	TP1	Title number(s)	GM295270
------------------------	-----	-----------------	----------

2. Before each continuation, state panel to be continued, e.g. "Panel 12 continued".

continued from panel 13

"The Rentcharge" means the balance of the rentcharge of £18.55 created by a Conveyance dated 22nd March 1848 and made between (1) Edmund Coston and (2) Francis Smith payable out of the land comprised in the title above mentioned taking into account previous apportionments

"the Retained Land" means the land edged green on the Plan to be retained by the Transferor

continued from panel 14

SIGNED AS A DEED by the said)
DIANE BARTLE)
in the presence of :)

Diane Bartle

..... *M. White*

address *102... everley ct.
Brooklands, DO
Sale, M25 3QJ.*

occupation

SIGNED AS DEED by the said)
DAWOOD AHMAD)
in the presence of :)

Mahmood Ahmad

..... *[Signature]*

address *10 Dora Road
202, Pearvale
Manchester*

occupation *Partner*

Continuation sheet 1 of 1

(insert sheet number and total number of continuation sheets e.g. "sheet 1 of 3")

LRCS



GM520334

Mervin Burtin
Diane Bette
Robert



SJ8794 SW
 SJ8793 NW

CERTIFICATE
 11.11

LR

TITLE NUMBER
GM863355

GREATER MANCHESTER : MANCHESTER



ORDNANCE SURVEY MAP REFERENCE:

SJ07948W

SCALE 1:1250

©CROWN COPYRIGHT. Produced by HMLR. Further reproduction in whole or in part is prohibited without the prior written permission of Ordnance Survey. Licence Number GD 272730.



This office copy shows the state of the title plan on 2 April 2003 at 10:51:26. It may be subject to minor distortions in scale. Under s.113 of the Land Registration Act 1925, this copy is admissible in evidence to the same extent as the original. Issued on 2 April 2003. This title is dealt with by the Lytham District Land Registry.

