

# FOR LEASE

LIGHT INDUSTRIAL/WAREHOUSE SPACE  
3941 HOLLY DRIVE • SUITE B  
TRACY, CA

HOLLY  
BUSINESS CENTER



## PROPERTY FEATURES:

- ±2,375 sq. ft. insulated warehouse
- ±500 sq. ft. office with glass storefront
- One (1) 12' x 14' grade level door
- ±14' - 16' minimum clear height
- 100A, 3 phase power
- Fluorescent tube lighting
- One (1) restroom
- Close proximity to I-205
- 56 parking stalls; 1.66/1,000 sq. ft.
- Zoned M-1 (Light Industrial-City of Tracy) providing for a wide array of uses such as construction services, warehousing, distribution, and light manufacturing
- Lease rate: \$3,000 per month (Gross)

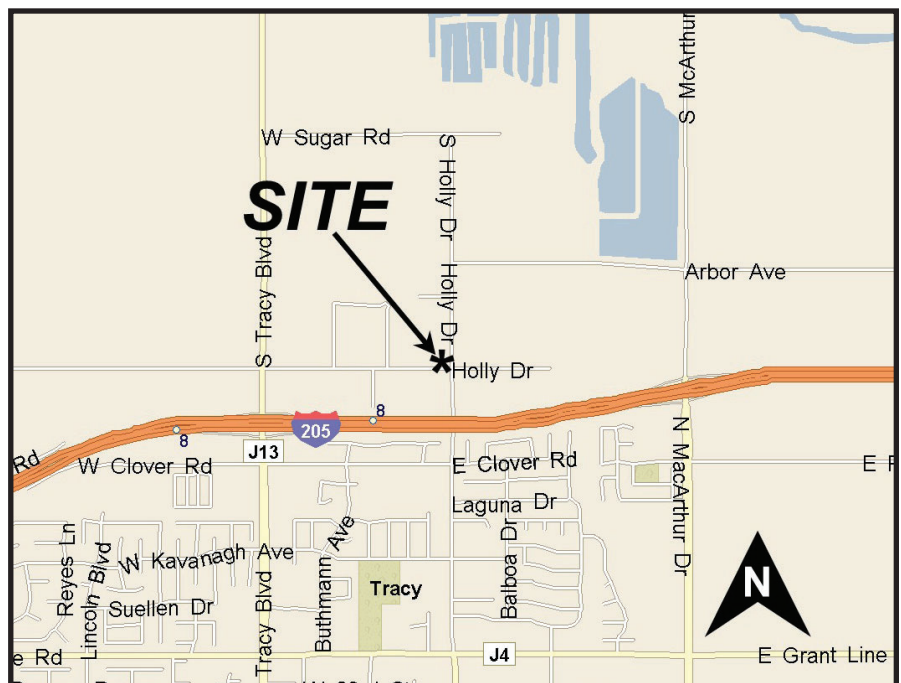

**SOUZA**  
**REALTY &**  
**DEVELOPMENT**

For further information, please contact:

**Mike Glazzy**  
**DRE #01204579**  
**mglazzy@souzard.com**

**672 West 11th Street • Suite 108 • Tracy, CA 95376**  
**(209) 229-7767**

The information provided herein has been secured from sources we believe to be reliable, but we make no representation or warranties, express or implied, as to the accuracy of the information. All information is subject to errors, omissions and changes and should be verified prior to sale or lease.

# HOLLY BUSINESS CENTER - SITE PLAN

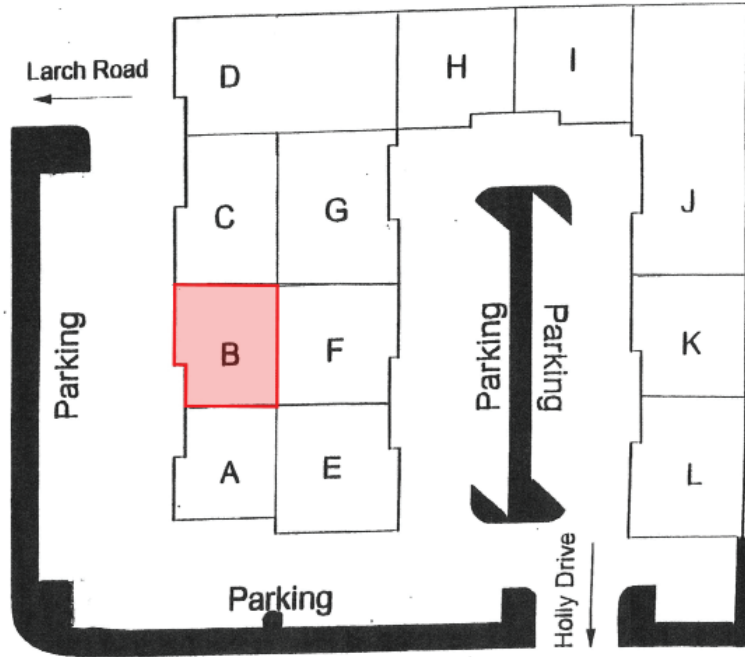

## SUITE B - FLOOR PLAN

