



# CAMP NORTH END

READY RIGHT NOW:  
GAMA GOAT'S SPEC  
SUITES

**TWO SPACES  
AVAILABLE FROM  
8,470 - 9,753 RSF**

GAMA GOAT  
BUILDING

1801 N GRAHAM





# SUITE 210 | 1801 N GRAHAM STREET

8,470 RSF

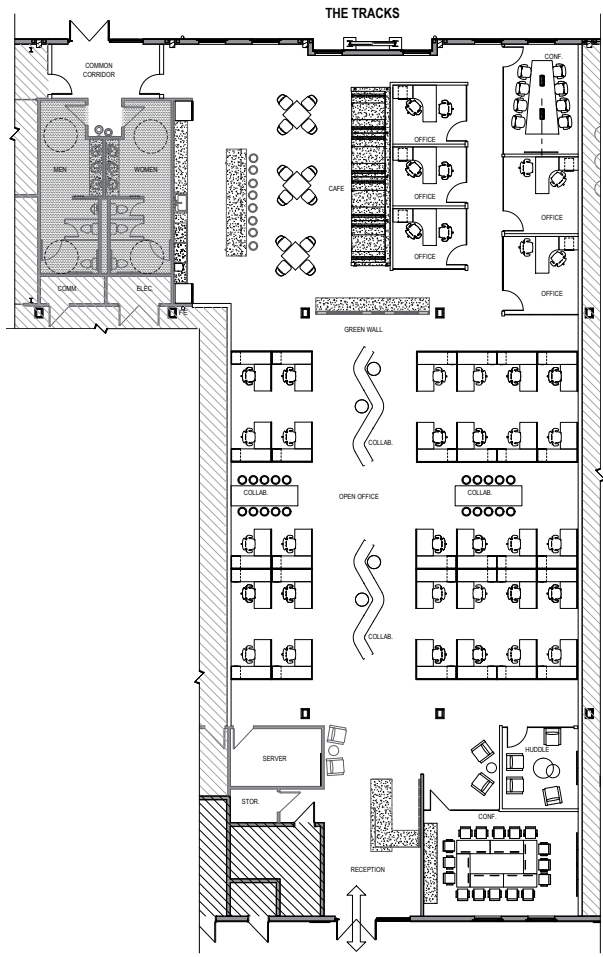
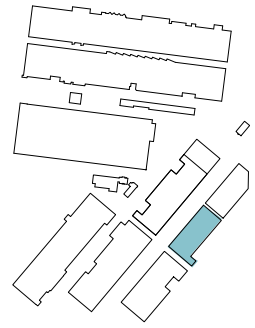

| GAMA GOAT SUITE 210 AREA CALCULATION |                                   |
|--------------------------------------|-----------------------------------|
| Room Type                            | Suite 210 (8,470 RSF)             |
| Workstation                          | 30                                |
| Office                               | 05                                |
| Reception                            | 01                                |
| <b>TOTAL</b>                         | <b>36</b><br><b>(1 : 235 RSF)</b> |
| Conference                           | 03                                |
| Huddle                               | 05                                |
| <b>TOTAL</b>                         | <b>08</b>                         |

**KEY PLAN**

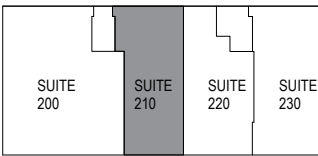

# SUITE 230 | 1801 N GRAHAM STREET

9,753 RSF

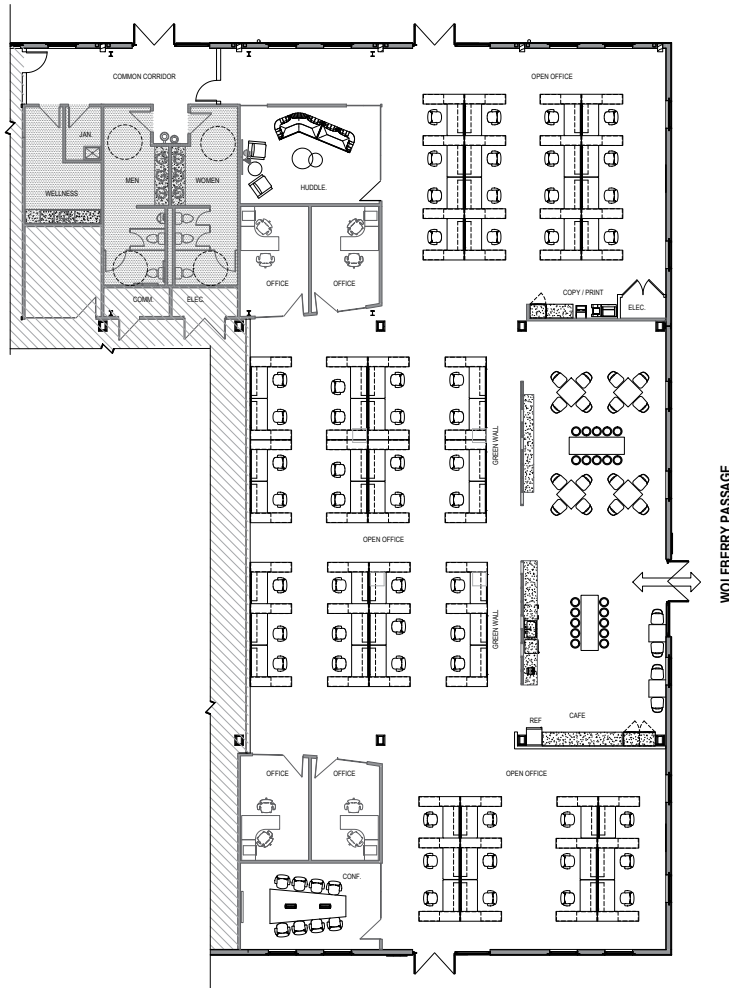
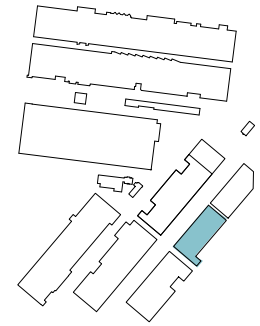

| GAMA GOAT SUITE 230 AREA CALCULATION |                            |
|--------------------------------------|----------------------------|
| Room Type                            | Suite 230 (9,753 RSF)      |
| Workstation                          | 56                         |
| Office                               | 04                         |
| Reception                            | 01                         |
| <b>TOTAL</b>                         | <b>61</b><br>(1 : 160 RSF) |
| Conference                           | 01                         |
| Huddle                               | 01                         |
| <b>TOTAL</b>                         | <b>02</b>                  |

## KEY PLAN

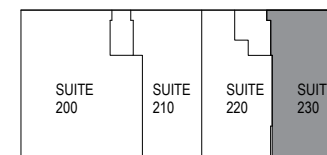

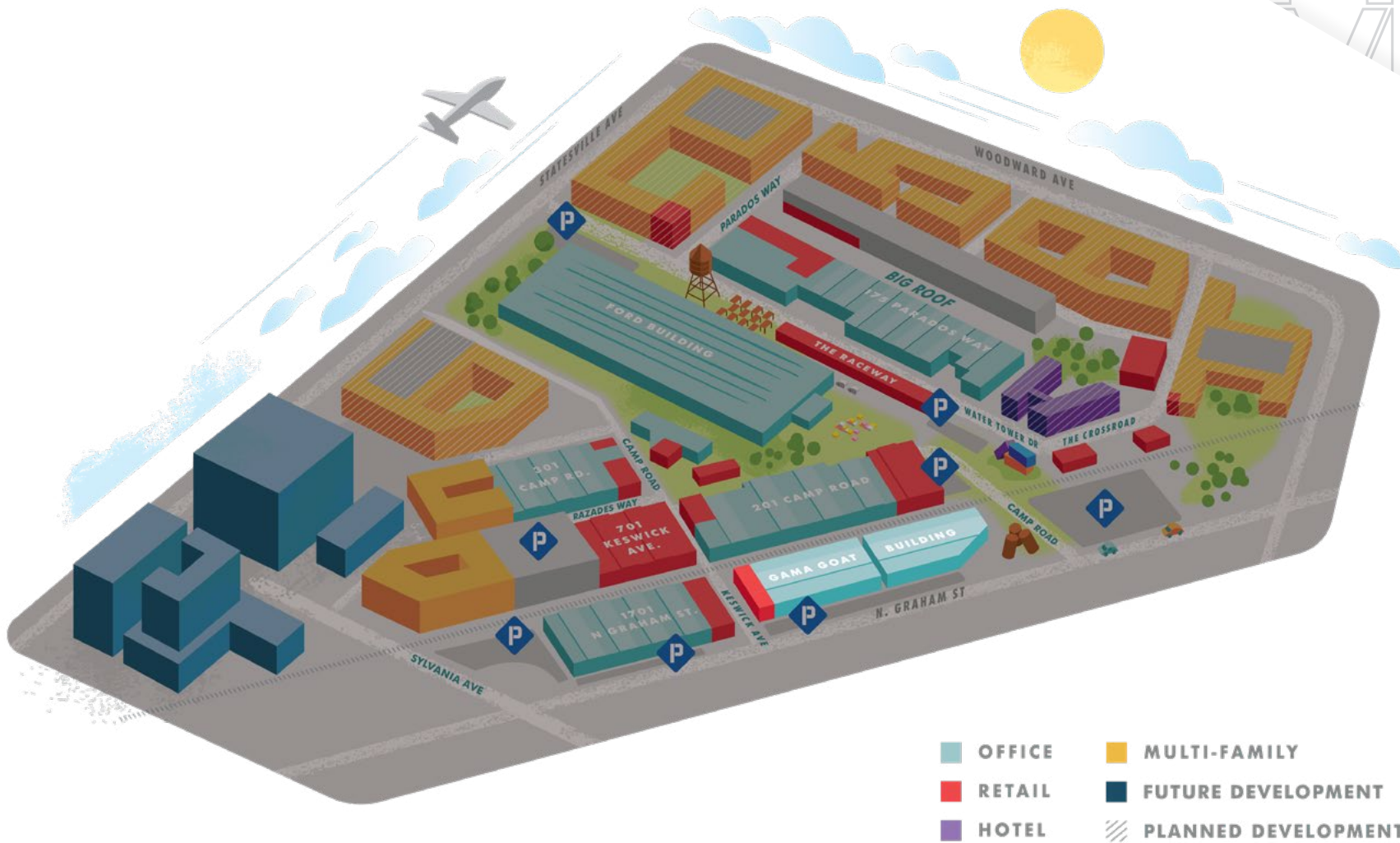

**76 ACRES OF EVENT SPACE**  
**TEAM GROWTH AND EXPANSION**  
**IMMERSIVE, ON-SITE RETAIL EXPERIENCE**  
**PRODUCT DEVELOPMENT AND TRAINING LABS**



**HISTORY IS MADE HERE.**

**CAMP NORTH END IS A DIVERSE COMMUNITY  
OF CREATORS AND INNOVATORS.**

# INNOVATION IS OUR IDENTITY, FORGED OVER A CENTURY

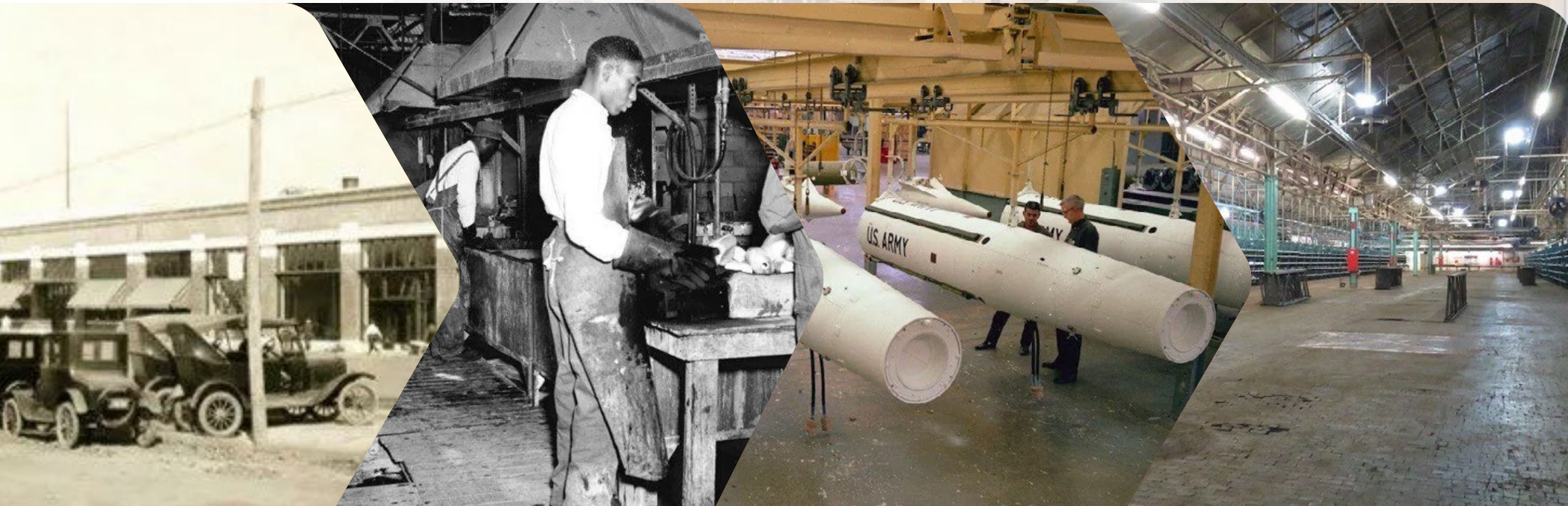

The grounds have been home to a Model-T factory that revolutionized assembly methods and a high-tech production facility for missiles and specialized vehicles for the U.S. Army.



## IT'S ALL HAPPENING HERE.

CAMP NORTH END IS CHARLOTTE'S  
DESTINATION FOR DIVERSE  
PROGRAMMING AND EVENTS.

Renowned chefs, trendsetting retail, and lively cultural, culinary, and arts festivals foster community and engagement across the campus for you and your entire team to enjoy.

Creative and engaged onsite community management team plans and executes over **20-30 events per week.**



# EVERYTHING YOUR EMPLOYEES NEED IS RIGHT HERE.



Pick up flowers at the farmers' market.



Grab lunch at a food stall.

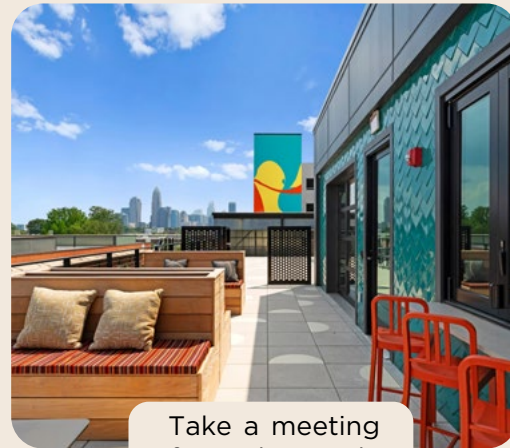

Take a meeting from The Perch.

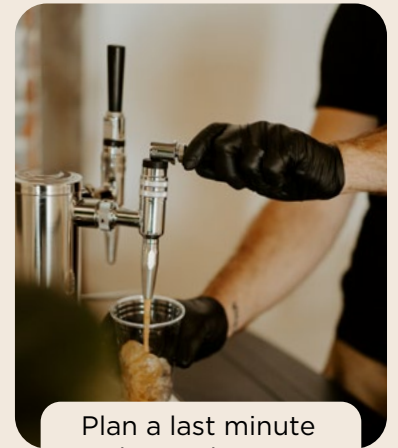

Plan a last minute happy hour.



Host a team gathering at Topsy Pickle, Charlotte's newest entertainment complex.

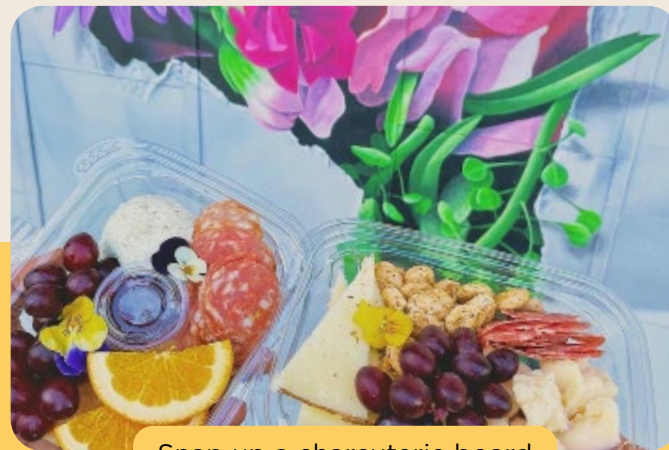

Snap up a charcuterie board after work on your way to a friends for drinks.



Impress clients at dinner at Room Service, Charlotte's premier spot for unique craft cocktails.



# CENTRALLY LOCATED AND EASILY ACCESSIBLE FROM ALL OVER CHARLOTTE.

PLENTY OF PARKING WITH NO TRAFFIC HASSLES.

There's nothing like our diverse community of some of the city's most notable restaurants, retailers, and experiences, a fantastic example of what makes Charlotte world-class.

Support your team with a campus of creators and innovators in the heart of Charlotte while standing out within Charlotte's business community.

# FOR LEASING INFORMATION CONTACT:

## OFFICE SPACE

Rhea Greene  
704.372.8822  
rdg@trinity-partners.com

Natalie Clayton  
704.975.4027  
nclayton@trinity-partners.com

## RETAIL SPACE

Chapman Chastain  
980.266.9292  
Chapman.Chastain@ascent.re

Aaron Ligon  
980.254.2747  
Aaron.Ligon@ascent.re



**CAMP  
NORTH  
END**

300 CAMP ROAD  
CHARLOTTE, NORTH CAROLINA  
CAMP.NC  
@CAMPNORTHEND