



Mona Lisa Plaza

Located at the NWC of West Ina Rd. & N Mona Lisa Rd.
2,170 SF Available



For more information, please contact
exclusive listing agents:

John Yarborough
JohnY@PaulAshCRE.com

David Carroll
DavidC@PaulAshCRE.com

Paul Ash Commercial Real Estate
3499 N. Campbell Ave., Suite 907
Tucson, AZ 85719
Main 520.795.2100
www.PaulAshCRE.com

License #LC509321000



The above information has been secured from sources we believe to be reliable, but we make no representation or warranties, expressed or implied, as to the accuracy of the information. References to square footage or age are approximate. We make no representations or warranties that the premises are free of environmental hazards or that the premises are suitable in all respects to your contemplated use. You should conduct an independent investigation of all pertinent property information. We bear no liability for any errors, inaccuracies, or omissions.

AERIAL



Available Spaces

Suite 101: 2,170 SF - Initial Lease Rate: \$23.00/SF Full Service Less Janitorial*

* Initial rate subject to 4% annual increases and pass-throughs over a Base Year

Lease Term & Remodeling Allowance:

For a long-term lease, Landlord will provide a remodeling allowance. Call agents for details.

Additional Highlights:

Located at the signalized intersection of Mona Lisa and Ina, this location is located one block west of the Foothills Mall, and just 5 minutes from I-10. Numerous common area improvements recently completed and the Building exterior was recently re-painted.

AERIAL

Ground Floor Site Plan

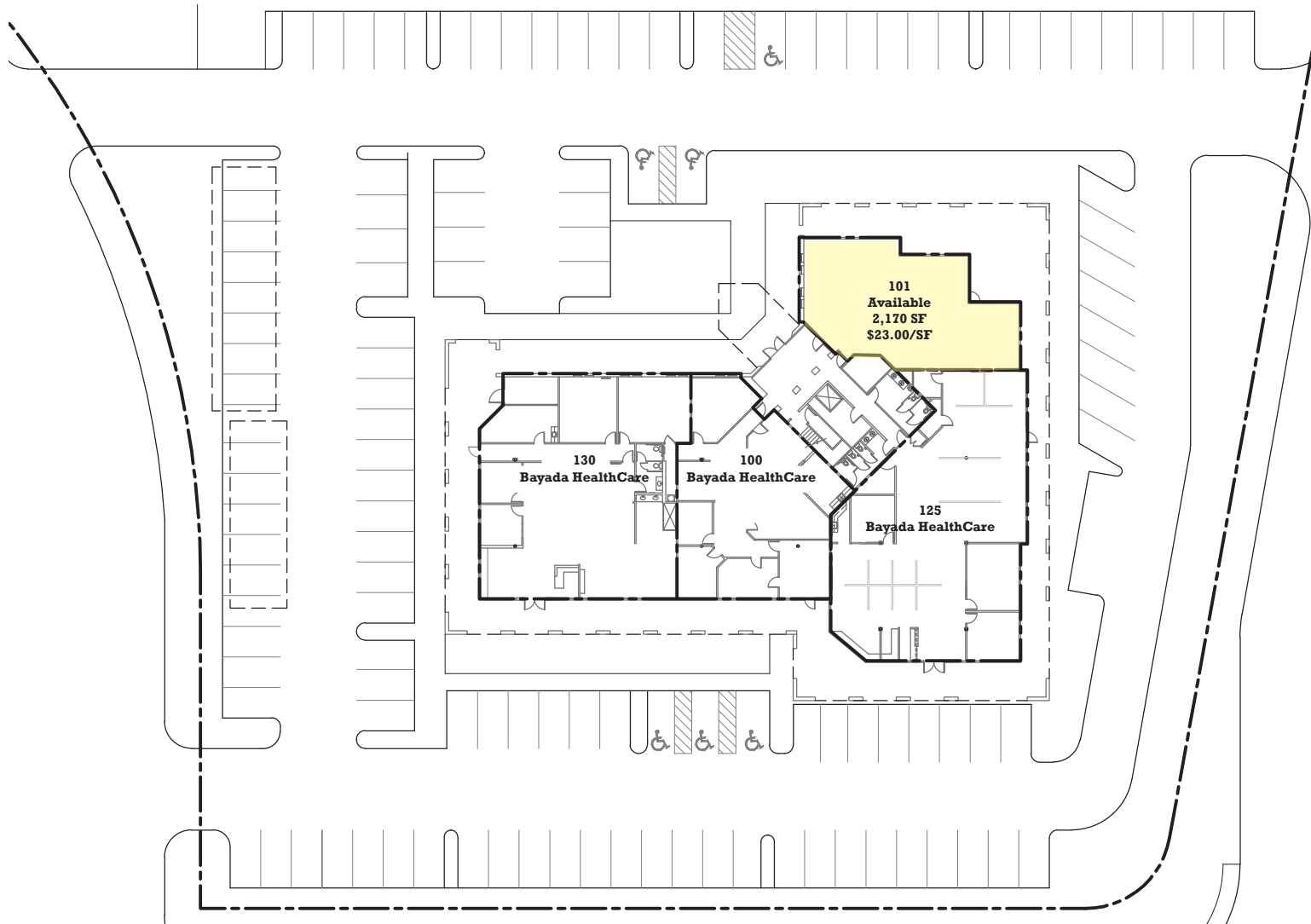

Mona Lisa Plaza
7225 N Mona Lisa

Initial Lease Rate: \$23.00/Square Foot, Full Service less interior janitorial service*

**Lease rate does not include interior janitorial service and is subject to 4% annual increases and pass-throughs of operating expenses over a base year*

Ground Floor Site Plan

Floor Plates

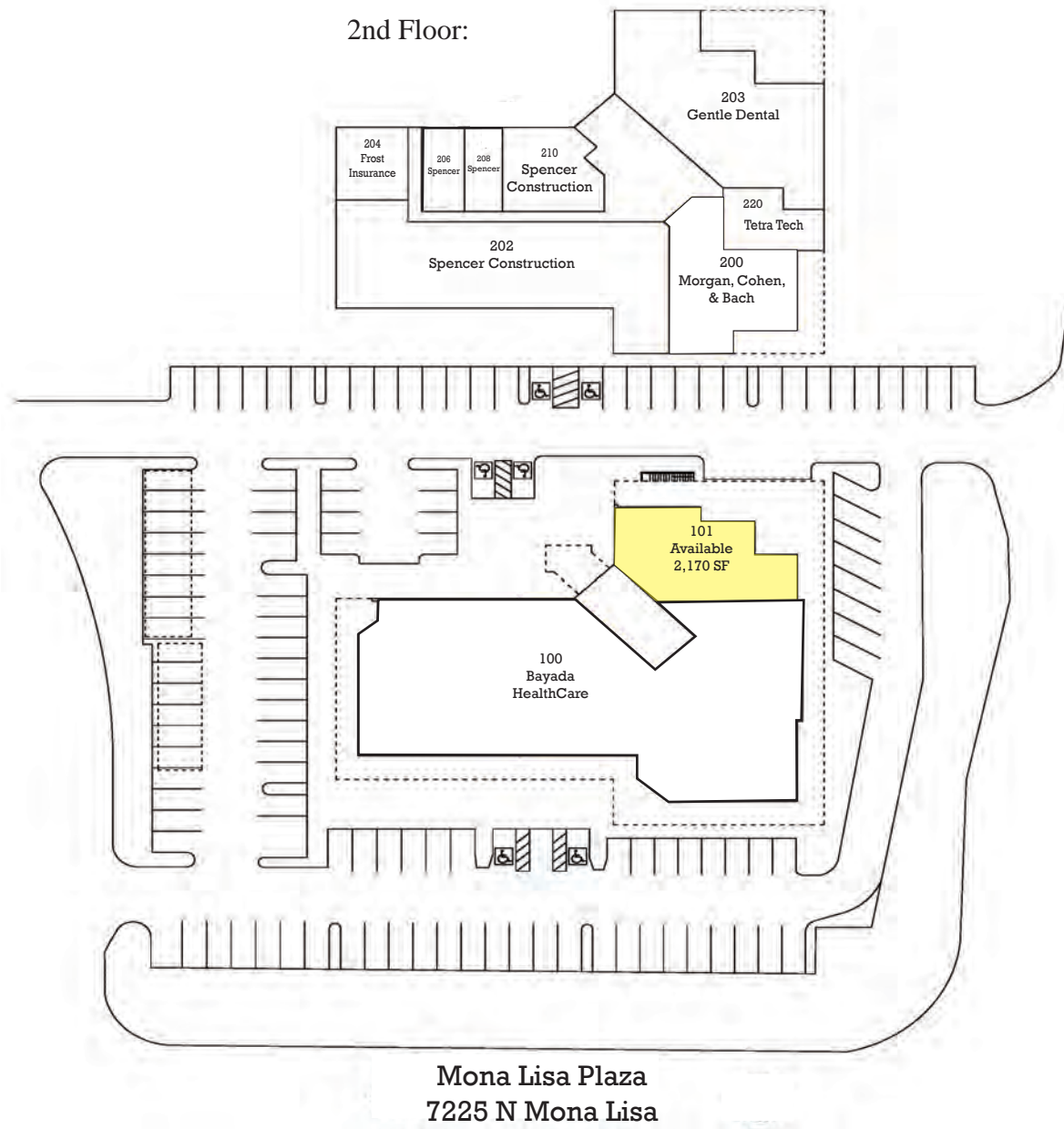

Floor Plates

Initial Lease Rate: \$23.00/Square Foot, Full Service less interior janitorial service*

**Lease rate does not include interior janitorial service and is subject to 4% annual increases and pass-throughs of operating expenses over a base year*

