

# PENN 95 COMMERCE CENTER

8210 Penn Randall Pl  
Upper Marlboro, MD 20772

## Industrial For Lease

30,000 - 66,606 SF



Leasing Information:  
410.659.1234

**Brent Prossner**    **Kyle Bell**  
410.659.1234 x122    410.659.1234 x117  
bprossner@lpc.com    kbell@lpc.com

# Lincoln

300 W Pratt Street  
Suite 520  
Baltimore, MD 21201

[www.lpc.com](http://www.lpc.com)

# PENN 95 COMMERCE CENTER

Industrial For Lease

30,000 - 66,606 SF

8210 Penn Randall Pl | Upper Marlboro, MD 20772



## Property Highlights

- 167,336 total square feet, warehouse building
- Class A warehouse/distribution space
- Immediate access to Rt 495
- Existing storefront
- Building signage available
- 14 docks plus 1 oversized drive-in
- 28' clear, fenced-in truck court
- Fire & Safety: ESFR
- Ready-to-go office, racking in place
- 800 amps with ability to upgrade
- 88 parking spaces

## Availabilities

## SF

## Date Available

Suite 100

30,000 - 66,606 SF

Immediately

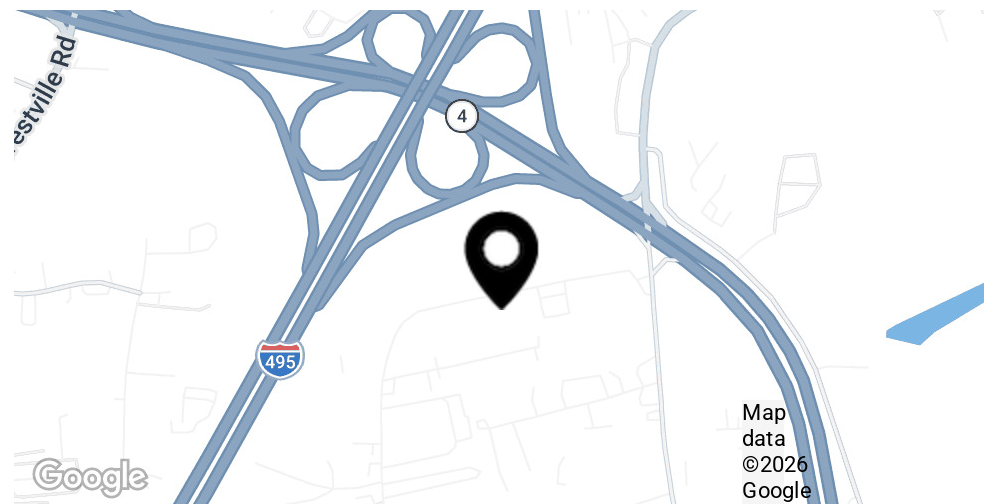

**Brent Prossner**

410.659.1234 x122  
bprossner@lpc.com

**Kyle Bell**

410.659.1234 x117  
kbell@lpc.com

**Lincoln**

# PENN 95 COMMERCE CENTER

8210 Penn Randall Pl | Upper Marlboro, MD 20772

Property Amenities

30,000 - 66,606 SF



**Brent Prossner**

410.659.1234 x122  
bprossner@lpc.com

**Kyle Bell**

410.659.1234 x117  
kbell@lpc.com

**Lincoln**

# PENN 95 COMMERCE CENTER

8210 Penn Randall Pl | Upper Marlboro, MD 20772

1st Floor

30,000 - 66,606 SF

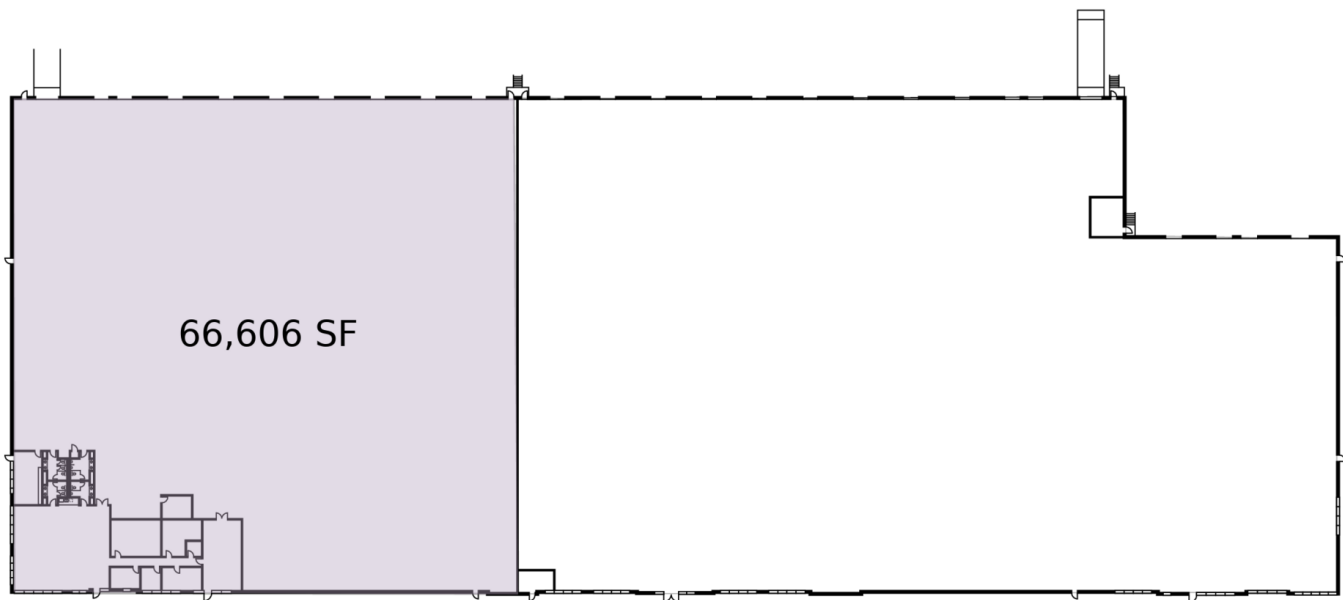

Suite	Size	Description
■ Suite 100	30,000 - 66,606 SF	Available immediately. Can be subdivided.

**Brent Prossner**  
410.659.1234 x122  
bprossner@lpc.com

**Kyle Bell**  
410.659.1234 x117  
kbell@lpc.com

**Lincoln**



# PENN 95 COMMERCE CENTER

8210 Penn Randall Pl  
Upper Marlboro, MD 20772

Leasing Information:  
410.659.1234

**Brent Prossner**  
410.659.1234 x122  
bprossner@lpc.com

**Kyle Bell**  
410.659.1234 x117  
kbell@lpc.com

## Lincoln

300 W Pratt Street  
Suite 520  
Baltimore, MD 21201

[www.lpc.com](http://www.lpc.com)