

# 254

## West Broadway Road

Mesa, Arizona 85210

AVAILABLE FOR SALE OR LEASE



**±71,707 SF Manufacturing & Distribution Building**  
**±4.12 Acres**

**GABE ORTEGA**  
480.561.0189  
gortega@camcre.com

**SHELBY TWOREK**  
602.491.1030  
stworek@camcre.com

**CHRIS GEROW**  
602.491.1041  
cgerow@camcre.com

2701 E. CAMELBACK RD., #170, PHOENIX, AZ 85016 | 602.489.7990 | WWW.CAMCRE.COM



Capital Asset  
Management



## PROPERTY OVERVIEW

**Purchase Price**

**\$13,930,000**

**Lease Rate**

Contact Agent

**Main Building**

±61,011 SF

**Building A**

±1,155 SF

**Building B**

±6,842 SF

**Building C**

±2,699 SF

**Total Building Area**

**±71,707 SF**

**Below Grade Storage**

±30,800 SF  
(not included in the Total Building Area)

**Land Area**

±4.12 AC

**Power**

3,000A (277/480v)

**Loading**

Dock platform, 5 positions  
9 grade-level doors (Main Bldg)  
14 grade-level doors (Bldgs A/B/C)

**Zoning**

DB-2, City of Mesa

**Opportunity Zone**

Yes

# SITE PLAN

The Site Plan as shown is Preliminary and Representative only, and may not represent the final layout, as it has not been approved by an architect or engineer

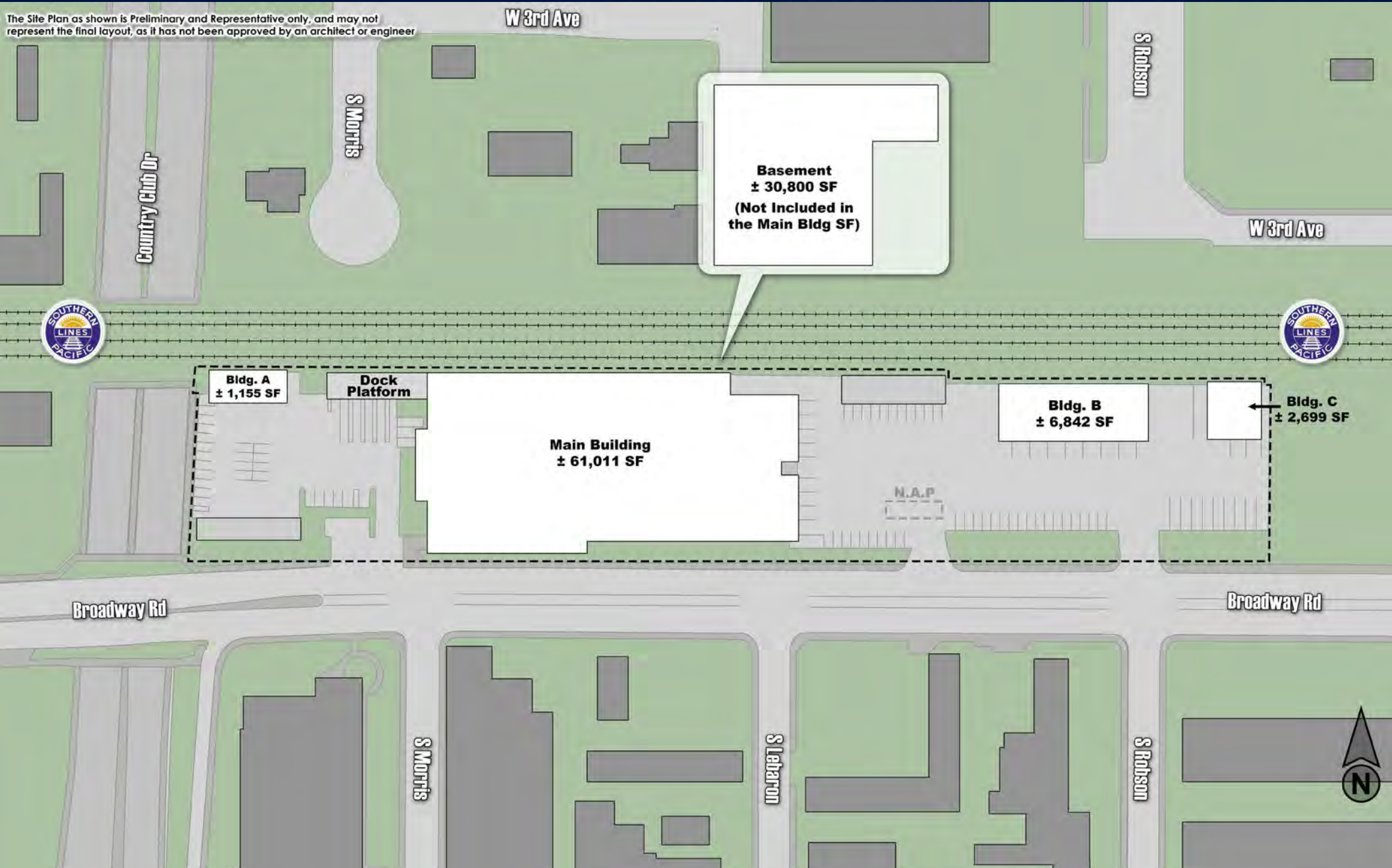

W 3rd Ave

Country Club Dr

S Morris

S Robson

W 3rd Ave



Bldg. A  
± 1,155 SF

Dock Platform

Main Building  
± 61,011 SF

Bldg. B  
± 6,842 SF

Bldg. C  
± 2,699 SF

N.A.P.

Broadway Rd

Broadway Rd

S Morris

S Lebaron

S Robson



## MAIN BUILDING

### DETAILS

- $\pm 6,040$  SF of modern office space
- $\pm 54,860$  SF of production/warehouse area
- Total of  $\pm 60,900$  SF, plus  $\pm 30,800$  SF of storage space below the office & warehouse

### Loading

Versatile layout with a dock platform on the west side of the building and 9 grade level doors on the east side of the building

### Electrical

3,000A (277/480v)

### Clear Height

12' on the western portion of the warehouse  
20-26' on the eastern side of the warehouse

### Cooling

HVAC for office, chiller system for warehouse



## MAIN BUILDING



- Showroom
- 2 conference rooms
- Open/shared workspace
- 5 private offices

- 2 restrooms for office
- 2 restrooms in warehouse
- 1 private restroom
- Fire sprinkler system



## MAIN BUILDING



### Warehouse (Eastern side)

- 20-26' clear height (slab to beam)

### Warehouse (Western side)

- 12' clear height (slab to truss)



# FLOOR PLAN

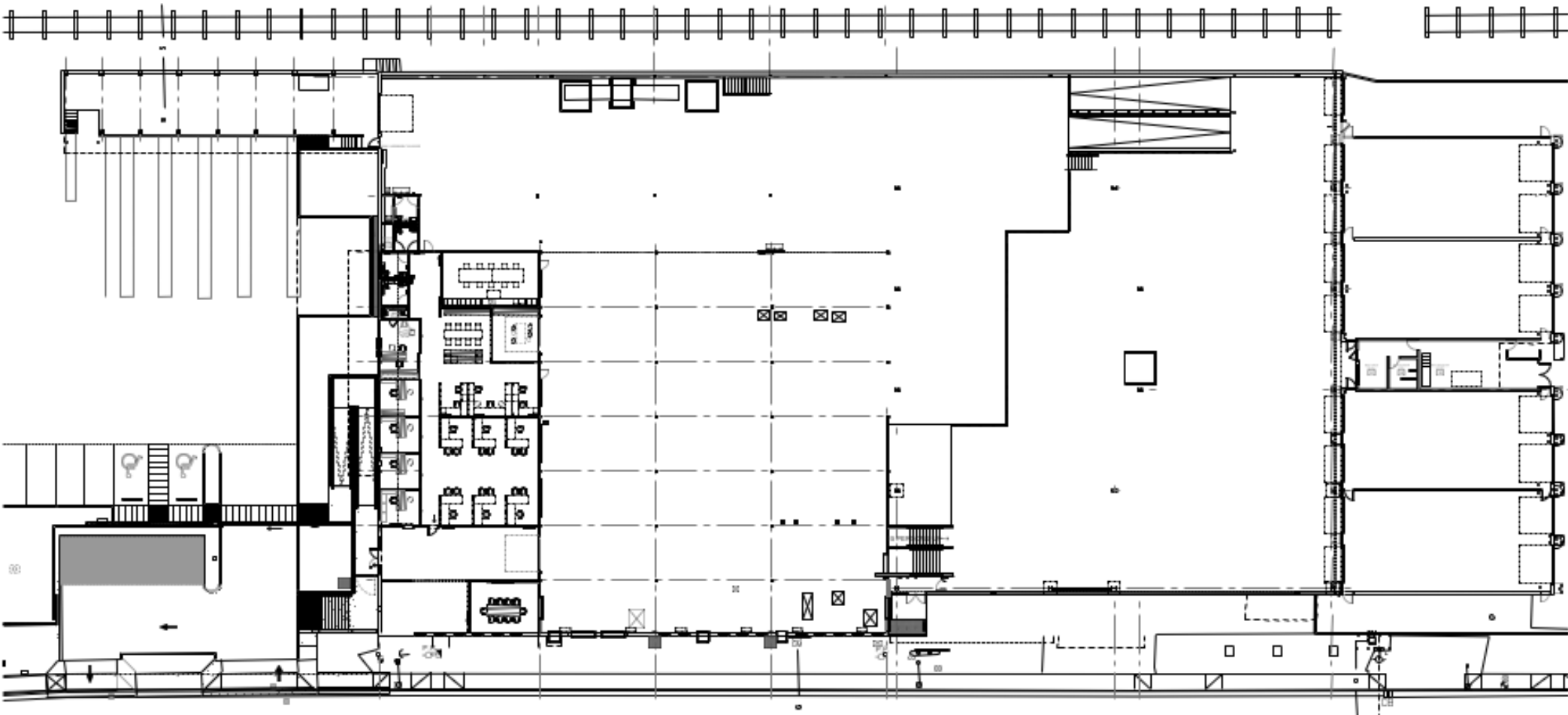

A 1 OVERALL EXITING PLAN MAIN LEVEL

MAIN BUILDING

## BUILDING A



## DETAILS

- ±1,155 SF of warehouse space
- +1,000 SF canopy area
- Covered parking with security gate

### Clear Height

12' on the western portion of the warehouse  
20-26' on the eastern side of the warehouse

### Loading

3 grade level doors

### Electrical

No electrical service

### Cooling

No cooling

## BUILDINGS B & C

### Building B

- ±2,500 SF detached canopy area
- 9 grade level doors
- Fenced yard
- No electrical service, no cooling

### Building C

- +2,699 SF of warehouse space
- 2 grade level doors
- Fenced yard
- No electrical service, no cooling



Building B

Building C

# 254

## West Broadway Road

Mesa, Arizona 85210

### FOR SALE OR LEASING INFORMATION CONTACT

**GABE ORTEGA**

DIR: (480) 561-0189

[gortega@camcre.com](mailto:gortega@camcre.com)

**CHRIS GEROW**

DIR: (602) 491-1041

[cgerow@camcre.com](mailto:cgerow@camcre.com)

**SHELBY TWOREK**

DIR: (602) 491-1030

[stworek@camcre.com](mailto:stworek@camcre.com)

**CONFIDENTIALITY STATEMENT** 2025 Capital Asset Management, LLC. All rights reserved. The information contained in this communication is strictly confidential. This information has been obtained from sources believed to be reliable but has not been verified. No warranty or representation, express or implied, is made as to the condition of the property (or properties) referenced herein or as to the accuracy or completeness of the information contained herein, and same is submitted subject to errors, omissions, change of price, rental or other conditions, withdrawal without notice, and to any special listing conditions imposed by the property owner(s). Any projections, opinions or estimates are subject to uncertainty and do not signify current or future property performance.

# CAMCRE.