



BUILDING INFORMATION

Building Size	105,485 SF (Divisible)
Office Space	To Suit
Clear Height	28'-0"
Bay Size	50'-6" x 50'-0" 60'-0" Speed Bay
Loading	11 Docks (Expandable) 2 Drive-In Doors 15 Trailer Spaces
Car Parking	94 Spaces
Lighting	High Bay LED Fixtures
Fire Protection	ESFR
Construction	Pre-Cast Panel
Power	1,500 Amps (Expandable)

AREA INFORMATION

Towne Corporate Park of Granville is a strategically positioned industrial park located within close proximity to I-41 & I-43 in Milwaukee County. Zilber Industrial 1 is an institutional-quality, speculative facility, designed to offer maximum operational flexibility to industrial users in the market, including: manufacturing, distribution and e-commerce.

ADDITIONAL INFORMATION

- Less than two miles to I-41 via HWY-100 Interchange
- Five Miles to I-43 & HWY 100 Interchange
- Access to metro Milwaukee skilled and unskilled workforce
- Local, professional ownership and property management

TRAVEL TIMES

- 10 minutes to Zoo Interchange (I-94 & I-41)
- 25 minutes to Downtown Milwaukee
- 30 minutes to Mitchell International Airport

For more information visit www.zilberpropertygroup.com

MICHAEL KLEBER
Director of Industrial Leasing
Michael.Kleber@Zilber.com
(414) 274-2628

ZILBER PROPERTY GROUP
9560 58th Place, Suite 350
Kenosha, WI 53144
(414) 274-2640

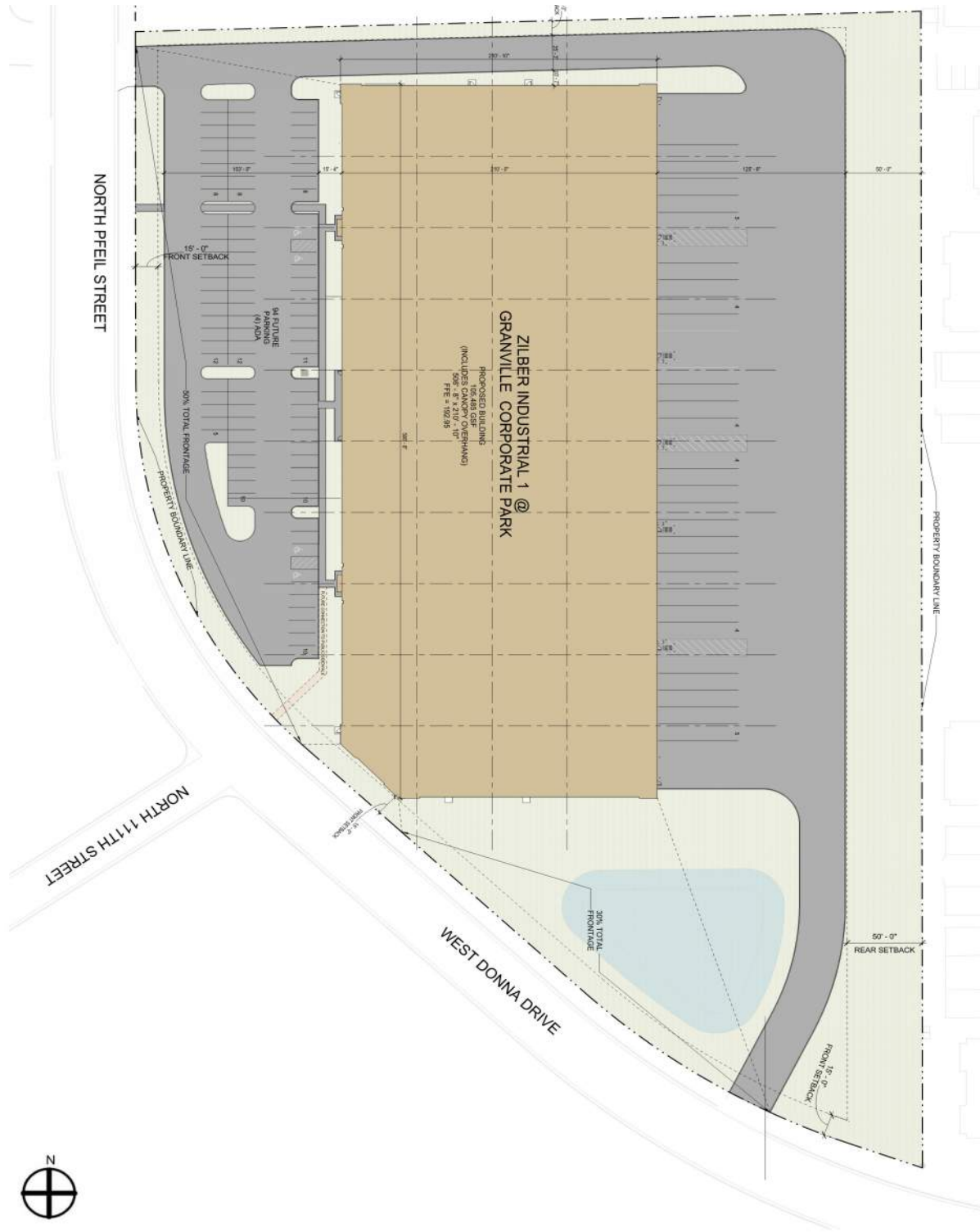

For more information visit www.zilberpropertygroup.com

MICHAEL KLEBER
Director of Industrial Leasing
Michael.Kleber@Zilber.com
(414) 274-2628

ZILBER PROPERTY GROUP
9560 58th Place, Suite 350
Kenosha, WI 53144
(414) 274-2640