

SUBLEASE OPPORTUNITY

6,722 RSF MIXED-USE OFFICE/LAB

12250 El Camino Real, Suite 140
San Diego, CA 92130



NEWMARK

PROPERTY OVERVIEW

12250 El Camino Real, Suite 140

Located in GENESIS-Del Mar, Suite 140 offers 6,722 SF of hyper efficient biology lab and office space. Ideally situated minutes from One Paseo and Del Mar Highlands Town Center, the campus provides immediate access to I-5 and SR-56, coastal amenities, and a wide range of dining and retail options.

On-site features include an open-air courtyard for collaboration, shared conference facilities, service elevator, backup generator, EV charging stations, and a 2.5/1,000 parking ratio, creating an efficient, connected environment that supports innovation and growth.

Monthly Base Rate

Negotiable

Sublease Term

Through December 31, 2028

Available

August 1, 2026





12250 El Camino Real



Project
Life Science and Office



Convenient Access
I-5 and SR-56



On-Site Amenities
EV Charging Stations, open courtyard with lounge furniture and free Wifi, and fully equipped shared conferencing



Amenity Rich Location
Walking distance to Del Mar Highlands, One Paseo and Piazza Carmel



Hospitals & Research Centers
Close to Sharp Rees-Stealy Carmel Valley, Scripps Clinic Del Mar and Kaiser Permanente Carmel Valley

FLOOR PLAN

12250 El Camino Real, Suite 140

Highlights

- ± 50/50 lab to office ratio
- Open office space, 2 private offices, 2 modular offices, and 1 conference room
- Existing FFE included
- On-site parking
- 2.5/1,000 SF parking ratio

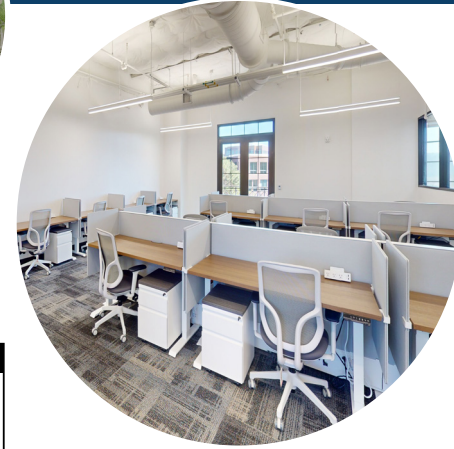

Lab Infrastructure

- 4 Benches
- 24 Bench Seats
- 3 Lab Support Rooms
- 16ft Chemical Fume Hood
- 3 Lab Support Sink with 2 RO/DI Systems

*Office Infrastructure

- 20 Workstations
- 2 Private Offices
- 2 Modular Offices
- 1 Conference Room
- 1 Break Room

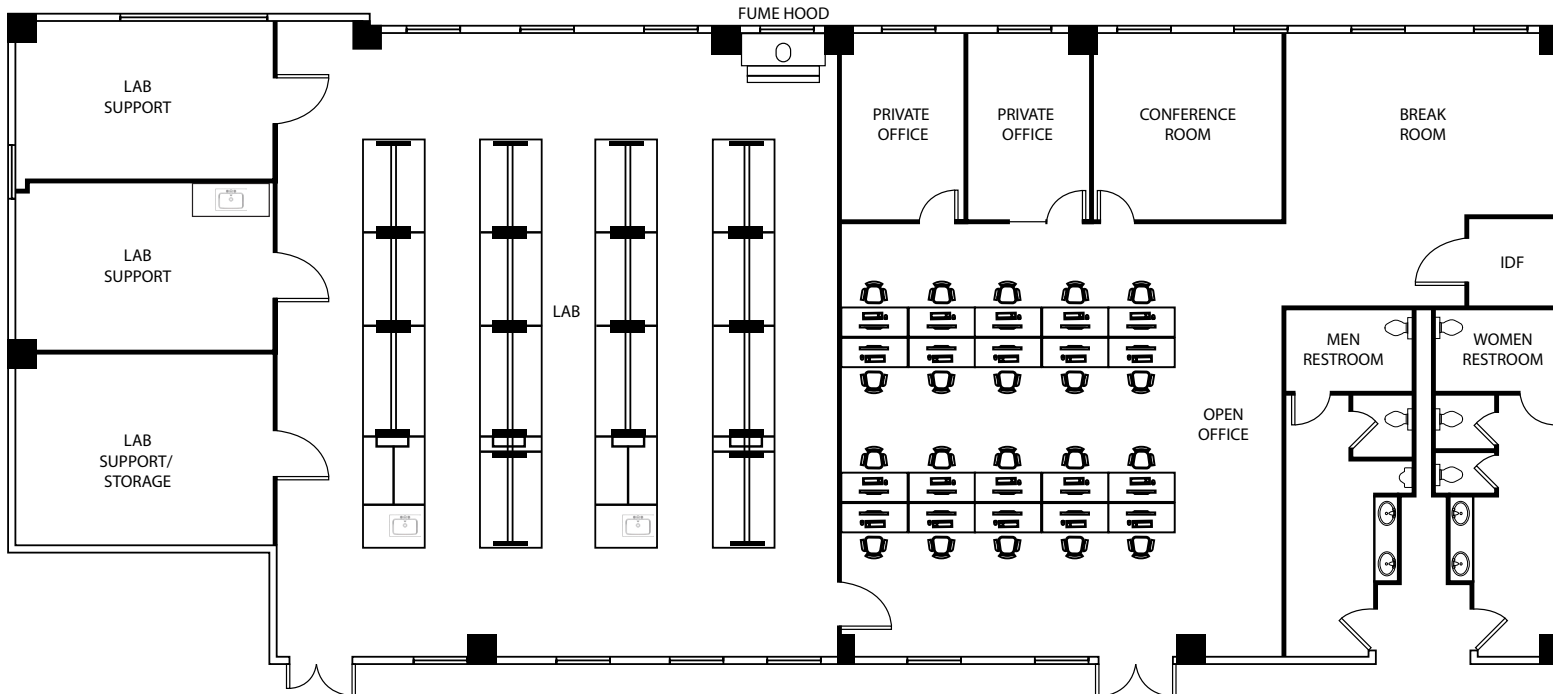

**Floor plan is hypothetical.
Space includes two modular
offices in the open office area.*



CONTACT US:



JOHN C. HUNDLEY
t 619-325-9110
john.hundley@nmrk.com
CA RE Lic. #01365206

JON ENGLE
t 858-692-3503
jon.ingle@nmrk.com
CA RE Lic. #01904111



4655 Executive Dr, Suite 800
San Diego, CA 92121
t 858-875-3600
Corporate License #01355491



nmrk.com

NEWMARK

Corporate License #01355491

The information contained herein has been obtained from sources deemed reliable but has not been verified and no guarantee, warranty or representation, either express or implied, is made with respect to such information. Terms of sale or lease and availability are subject to change or withdrawal without notice.

