



CINEMAS

ASSIGNMENT OF LEASE AND SALE OF FF&E

# TURNKEY UPSCALE ENTERTAINMENT VENUE OPPORTUNITY

69-201 WAIKOLOA BEACH DRIVE, STE G-1, WAIKOLOA, HI, 96738

# INVESTMENT HIGHLIGHTS

## ABOUT THE PROPERTY

Queens' Marketplace is a 133,600-square-foot open-air retail center serving as the commercial and social hub of the Kohala Coast on Hawai'i Island. Situated within the Waikoloa Beach Resort community, the property offers a well-balanced mix of national brands and regional retailers, along with dining and service-oriented businesses. The center draws a blend of first-time visitors, repeat luxury vacationers, seasonal residents, and the surrounding local community, positioning it as a primary gathering place within the resort corridor.

## UNIQUE LUXURY THEATER AND RESTAURANT OPPORTUNITY

This is a rare opportunity to assume and operate a fully built-out luxury cinema concept featuring three auditoriums, a full-service restaurant, and an on-site bar within a premier resort setting. Guests enter through a modern lobby where they can select films and reserve specific seats in advance or at the door. The experience is anchored by a concession area and full-service bar offering craft beer, wine, and tropical cocktails, along with the "Bistro at the Cinemas," an expansive open-air lanai restaurant serving appetizers, salads, hand-made pizzas, gourmet street tacos, and desserts, with live music enhancing the evening atmosphere. A dine-in service model allows food and beverages to be delivered directly to pre-reserved luxury leather loveseats. Each auditorium (approximately 85-100 seats) features state-of-the-art digital projection, Real 3-D capability, immersive surround sound with dedicated speaker systems and subwoofers, and excellent sightlines throughout. The venue is also well-suited for private events, concerts, and live performances, providing multiple revenue streams.

## LEASE DETAILS

### PREMIUM

Contact Agent

### EQUIPMENT LIST

Fully equipped and furnished.  
Full FF&E list available upon request.

### SIZE

9,761 SF - Theaters & Restaurant & Bar  
4,920 SF - Outdoor Patio Dining Area  
1,500 SF - Office  
16,181 SF - TOTAL

### BASE RENT

Contact Agent for details

### CAM

Contact Agent for details

### LEASE TERM

Contact Agent for details

### HIGHLIGHTS

- Unique turnkey upscale entertainment venue opportunity
- Three auditoriums with state-of-the-art digital projection and Real 3-D capability
- Dolby surround sound system
- Fully functioning in-house restaurant and bar with a full liquor license
- Large open-air dining patio perfect for private events, banquets, and live music

# GALLERY



# LEASE PLAN

## Directory



**DIRECTORY LEGEND**

- ATM
- Elevator
- Restrooms
- Family Restrooms



- FOOD OUTLETS**
- Da Ramen Kind F5
  - 808-238-0099
  - Dairy Queen/ Orange Julius F8
  - 808-886-1029
  - Gecko Girlz F1
  - L&L Hawaiian BBQ F3
  - 808-886-2430
  - Pono Pastries F4
  - Starbucks K1
  - 808-886-1888
  - Sushi HI F7
  - Waikoloa Pizza F9
  - Waikoloa Shrimp Co F6

- SERVICES**
- Hawaii Life E5
  - 808-883-3321
  - Hilton Grand Vacations Club K8
  - 808-886-0945
  - Kona Coast Vacations 2F11
  - 808-329-2140
  - KOR Salon D3
  - 808-886-8090
  - Pacific Skin Institute 2F13
  - Resortica Hawaii 2F14
  - 808-881-8222
  - Skin Factory Tattoo 2F16
  - 808-661-5511
  - Vacasa 2F17
  - 800-544-0300
  - Waikoloa Dental Clinic 2F15
  - 808-886-0891

- FASHION**
- Blue Ginger K2
  - 808-886-0022
  - Cariloha J9
  - 808-886-2608
  - Coconut Ave C5
  - 808-731-4024
  - Crocs K3
  - 808-886-0213
  - Kona Surf N' Sandals C4
  - 808-886-0898
  - Mahina K6
  - 808-886-4000
  - Malibu Shirts C2
  - 808-886-0003
  - Olivia Clare Boutique D7
  - 808-657-4307
  - OluKai J8
  - 808-731-4088
  - Oshima Surf & Skate F10
  - 808-339-7306
  - Reyn Spooner C3
  - 808-886-1162
  - Rip Curl K7
  - 808-731-8934
  - Tommy Bahama Store A1
  - 808-865-6750

- DINING**
- Aloha Wine Bar B1
  - 808-886-3500
  - Bistro at the Cinemas C1
  - 808-464-3009
  - Kona Biscuit Co. H1
  - Coming soon
  - Kuleana Rum Shack H7
  - 808-238-0786
  - Patina E1
  - Tommy Bahama Marlin Bar A1

- ART & JEWELRY**
- Genesis Galleries K4
  - 808-886-7770
  - Lava Light Galleries F13
  - 808-756-0778
  - Mashka Jewelry J10
  - 808-731-7310
  - Maui Divers Jewelry J11
  - 808-886-4817

- ENTERTAINMENT**
- Kozy's Comedy & Magic Show E3
  - 808-430-1957
  - Waikoloa Luxury Cinemas C1
  - 808-464-3009

- OFFICES**
- Shopping Center Management 2F1
  - 808-886-8822

- GROCERY**
- Island Gourmet Markets B1
  - 808-886-3577

- SPECIALTY AND GIFTS**
- Claire's J5
  - 808-886-8905
  - KoaWood Ranch F14
  - 808-238-0419
  - SoHa Keiki J4
  - 808-909-3888
  - SoHa Living K5
  - 808-464-4268
  - Sunglass Hut C1
  - 808-886-0274

- SPORT AND LIFESTYLE**
- Bike Works Beach & Sports F12
  - 808-886-5000
  - Snorkel Bob's D1
  - 808-238-0992

# FLOOR PLAN - MAIN LEVEL

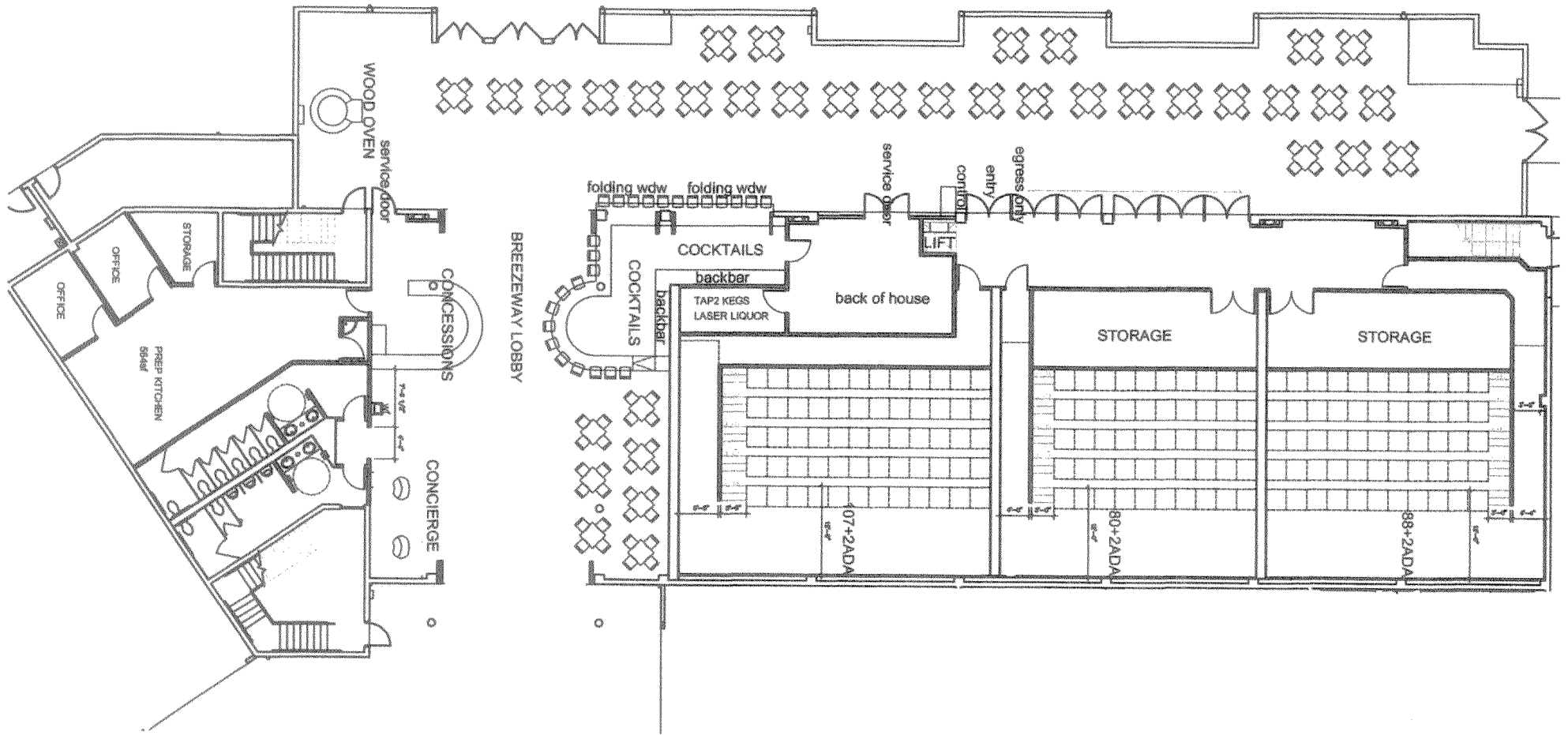

# FLOOR PLAN - MEZZANINE LEVEL

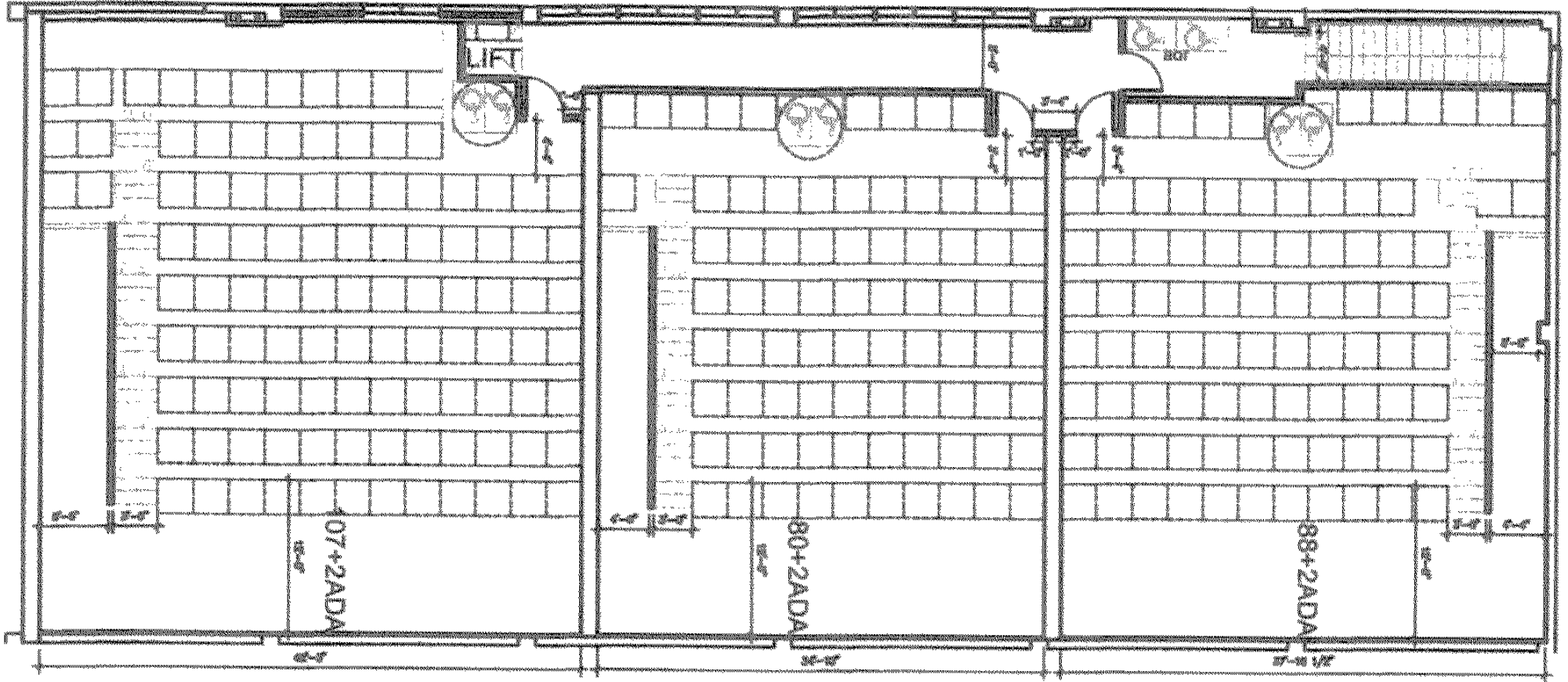

# MARKET OVERVIEW

**3,680**  
TOTAL UNITS



**BEALL CORP**  
RETAIL REAL ESTATE

1120 12TH AVENUE, SUITE 301  
HONOLULU, HI 96816  
WWW.THEBEALLCORPORATION.COM

Scan or visit [eepurl.com/c2rzHH](http://eepurl.com/c2rzHH)  
to sign up for The Beall Corporation  
Newsletters and stay on top of  
Hawaii's Commercial Real Estate News



This document has been prepared by The Beall Corporation for advertising and general information only. The Beall Corporation makes no guarantees, representations or warranties of any kind, expressed or implied, regarding the information including, but not limited to, warranties of content, accuracy and reliability. Any interested party should undertake their own inquiries as to the accuracy of the information. The Beall Corporation excludes unequivocally all inferred or implied terms, conditions and warranties arising out of this document and excludes all liability for loss and damages arising there from. This publication is the copyrighted property of The Beall Corporation and/or its licensor(s). © Copyright 2026. All rights reserved.