

PROPERTY DESCRIPTION

Development Associates is pleased to offer ±20,000 SF of Industrial/Flex space facility located in the established Westover Industrial Park.

This versatile space is well-suited for education, office, high-tech, manufacturing, service or lab uses with easy highway access.

Located just minutes from the Interstate 91 corridor and the Massachusetts Turnpike, the property provides excellent regional connectivity throughout Western Massachusetts and into Connecticut.

PROPERTY HIGHLIGHTS

- Attractive, functional masonry block building
- 20' clear height , Column free
- Fully Air-Conditioned
- Dock-height and drive-in overhead doors
- Excellent access to I-91 and I-90
- Located in Westover Industrial Park
- 150+ Parking Spaces



Developers and Brokers of Commercial Properties

200 Silver Street, Suite 201 | Agawam, MA 01001

DISCLOSURE: BROKER HAS A FINANCIAL INTEREST IN THIS PROPERTY.



KEN VINCUNAS
Licensed Broker in MA
(413) 789-3720

kvincunas@devassociates.com

www.Devassociates.com

134 Dulong Circle, Chicopee MA

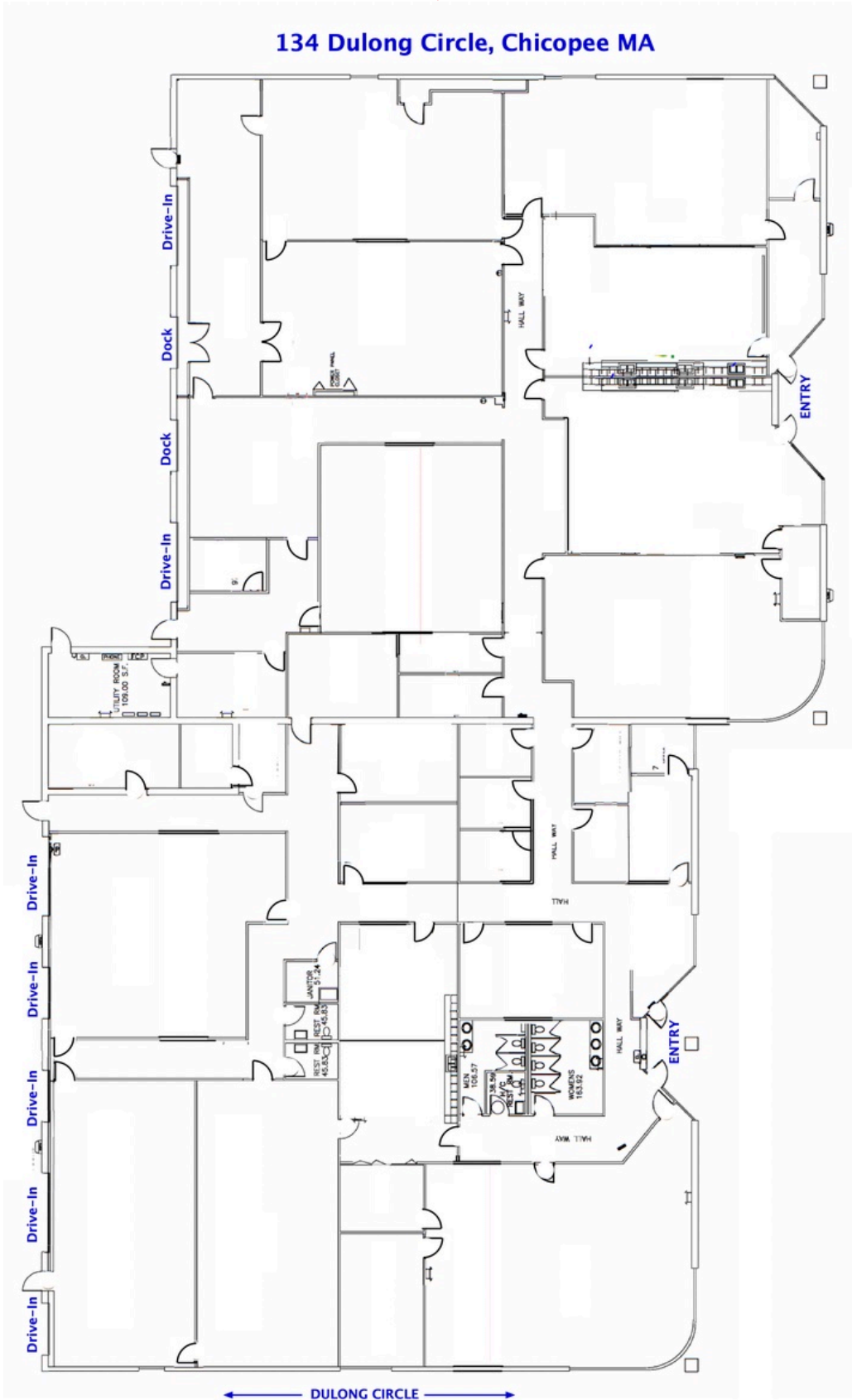

Developers and Brokers of Commercial Properties

200 Silver Street, Suite 201 | Agawam, MA 01001

DISCLOSURE: BROKER HAS A FINANCIAL INTEREST IN THIS PROPERTY.



KEN VINCUNAS
 Licensed Broker in MA
 (413) 789-3720

kvincunas@devassociates.com

www.Devassociates.com