

GARFIELD BUSINESS CENTER

3412-3418  
+ 3422  
Garfield  
Avenue

FOR LEASE:  
291,180 SF

3412

3412

3412

NEWMARK

AVAILABLE FOR LEASE

# 3412-3418 S Garfield Avenue Commerce, CA 90040



**For Lease: ±241,815 SF**  
COVERED, SPRINKLERED &  
SECURED RAIL DOCK INCLUDED  
IN AVAILABLE SF



**Professionally Managed  
Business Park**



**Fenced & Secured Yard**



**26 Dock High Positions  
3 Ground Level Via  
Ramps**



**20' - 22' Clearance**



**1200 Amps**



**±6,371 Office**  
Offices are in 3 Pods:  
3,916 SF, 1,964 SF  
& 490 SF

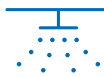

**.45/3000 Sprinklers**



**Immediate (5) Freeway  
Access**



3412-3418 GARFIELD AVENUE

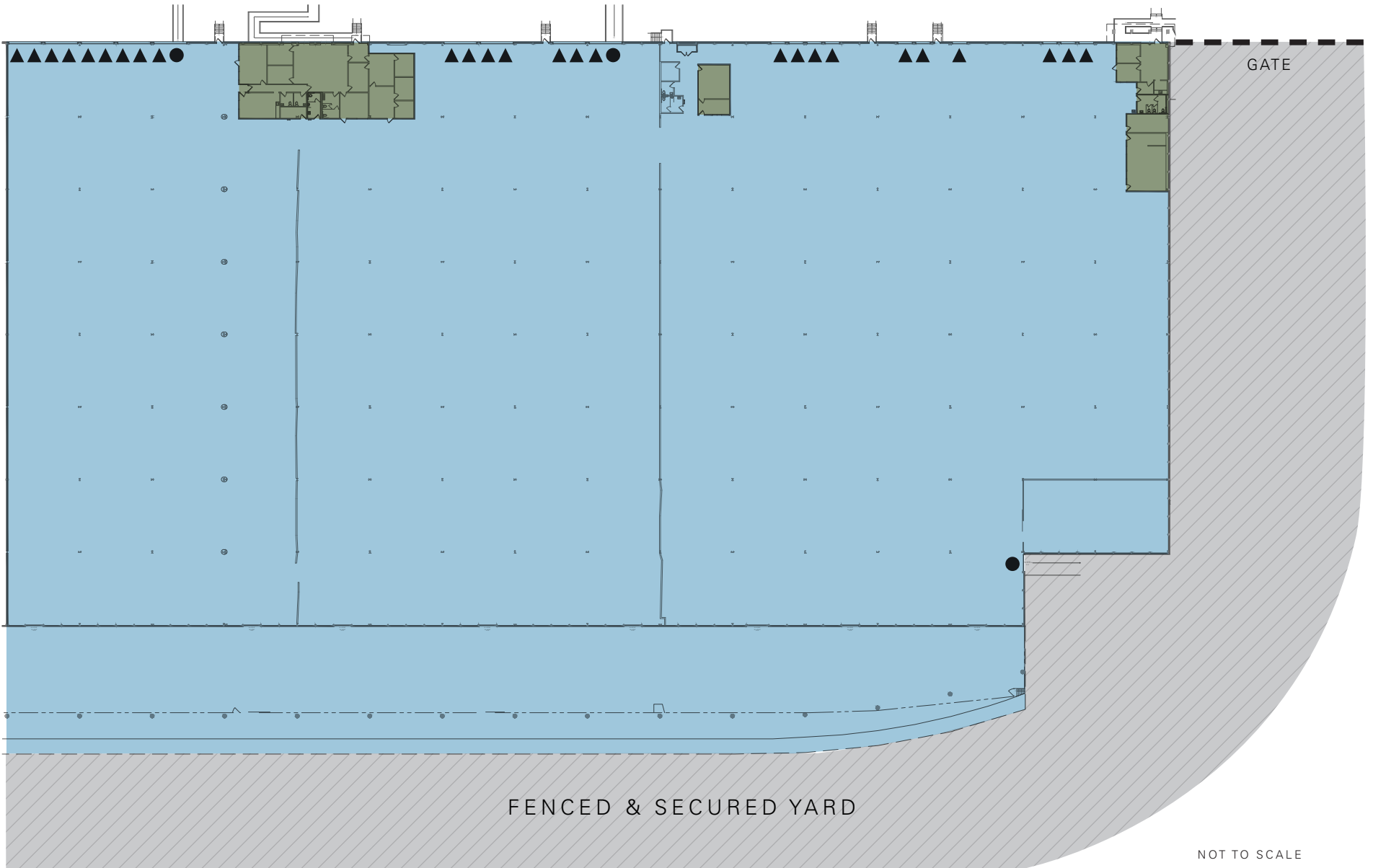

GATE

FENCED & SECURED YARD

NOT TO SCALE

- AVAILABLE
- OFFICE
- DOCK HIGH POSITION
- GROUND LEVEL DOOR
- NOT A PART
- YARD

NEWMARK

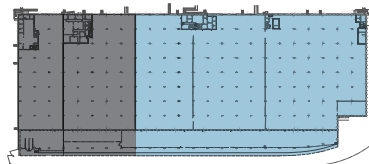

AVAILABLE FOR LEASE

# 3422 S Garfield Avenue Commerce, CA 90040



**For Lease: ±49,365 SF**

COVERED, SPRINKLERED & SECURED  
RAIL DOCK INCLUDED IN AVAILABLE SF.



**Professionally Managed  
Business Park**



**3 Dock High Positions  
1 Ground Level Via Ramp**



**20' - 22' Clearance**



**±4,916 Office**

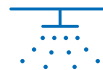

**.45/3000 Sprinklers**



**400 Amps**



**Immediate (5) Freeway  
Access**

**NEWMARK**

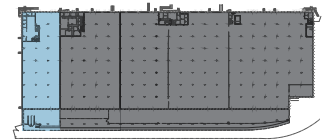
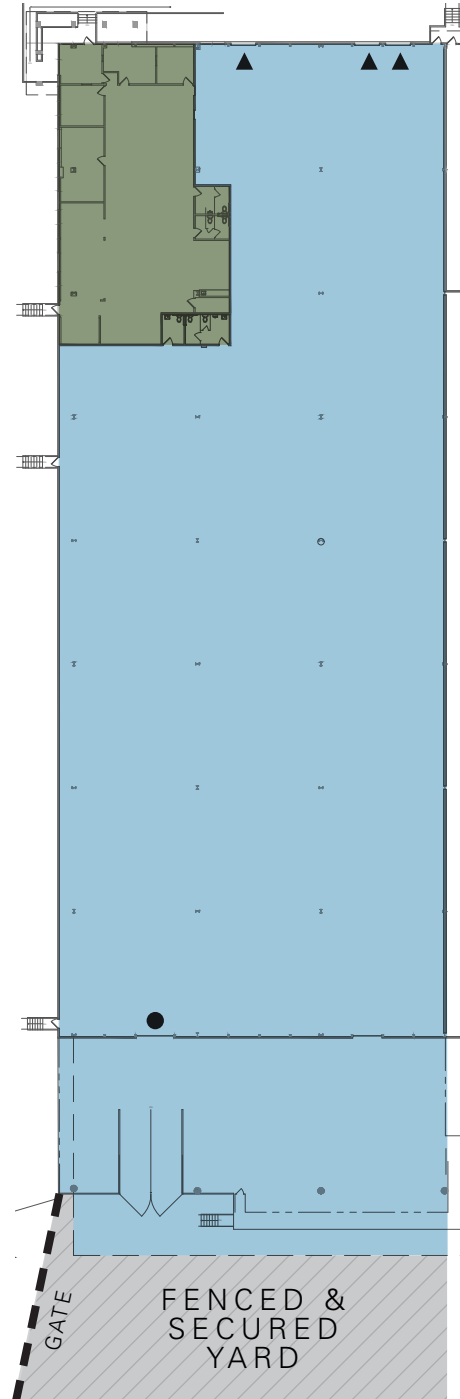

NOT TO SCALE

- AVAILABLE
- OFFICE
- DOCK HIGH POSITION
- NOT A PART
- YARD
- GROUND LEVEL DOOR

3412-3418 + 3422 GARFIELD AVENUE



3412-3418 + 3422 GARFIELD AVENUE

9 Miles

DOWNTOWN LOS ANGELES

17 Miles

PORT OF LONG BEACH

19 Miles

PORT OF LOS ANGELES

20 Miles

LOS ANGELES INTERNATIONAL AIRPORT

CONTACT

**Jeff Sanita**

*Executive Managing Director*

t 310-491-2003

jeff.sanita@nmrk.com

CA RE Lic. #01242202

**John McMillan**

*Vice Chairman*

t 310.491.2048

john.mcmillan@nmrk.com

CA RE Lic. #01103292

**Joey Farney**

*Associate*

t 310-491-2007

joey.farney@nmrk.com

CA RE Lic. #02218932

**Andrew Conroy**

*Transaction Manager*

t 310-491-2085

andrew.conroy@nmrk.com

CA RE Lic. #02143325

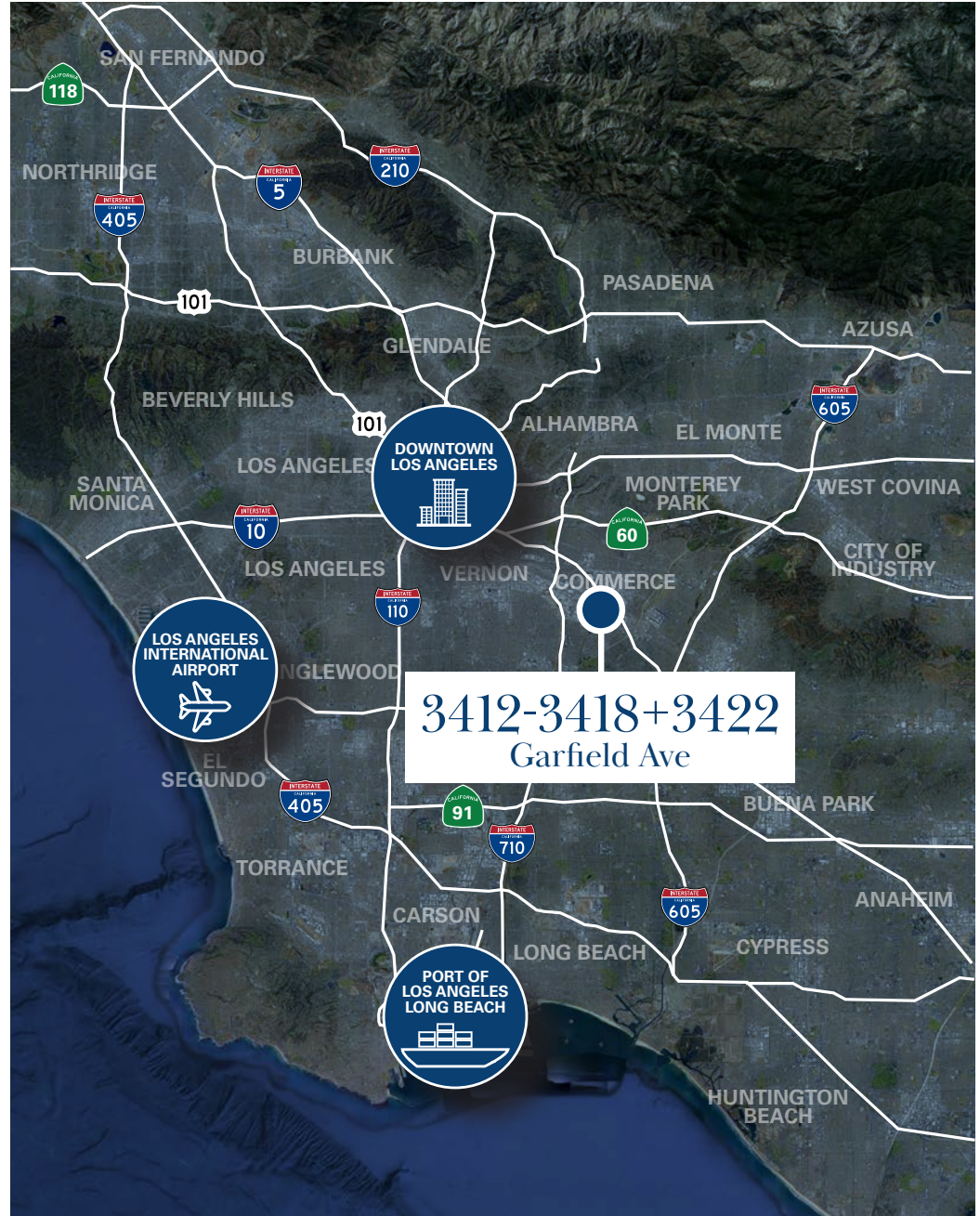

Corporate License #01355491

The information contained herein has been obtained from sources deemed reliable but has not been verified and no guarantee, warranty or representation, either express or implied, is made with respect to such information. Terms of sale or lease and availability are subject to change or withdrawal without notice.

**NEWMARK**