



Keegan & Coppin
COMPANY, INC.

SALE/LEASE

5570 SKYLANE BOULEVARD
SANTA ROSA, CA

**OFFICE BUILDING WITH
WAREHOUSE AVAILABLE**



Go beyond broker.

PRESENTED BY:

BRIAN KEEGAN, PARTNER
LIC # 01809537 (707) 528-1400, EXT. 249
BKEEGAN@KEEGANCOPPIN.COM

SHAWN JOHNSON, MANAGING PARTNER/SIOR
LIC # 00835502 (707) 528-1400, EXT. 238
SJOHNSON@KEEGANCOPPIN.COM



EXECUTIVE SUMMARY



5570 SKYLANE BOULEVARD
SANTA ROSA, CA

**OFFICE BUILDING
WITH WAREHOUSE
FOR SALE OR LEASE**

PROPERTY INFORMATION

HIGHLIGHTS

- Total building space 9,544 SQFT
- Suites available individually or all together for 9,544 SF*
 - Suite A: 1,990 SF
 - Suite B: 3,198 SF
 - Suite C: 4,356 SF
- 3.3/1,000 parking
- 16' ceiling height
- Located in Airport Business Center

**Currently combined for a single tenant user*

PROPERTY DESCRIPTION

The building includes, private offices along the window line, large conference rooms, storage/file rooms, and kitchenette. Private restrooms, large entry reception area, open work areas, and 2 small warehouses with roll up doors.

LEASE TERMS

Rate

of \$1.55 psf Modified Full Service

OFFERING

Sale Price **\$1,995,000**

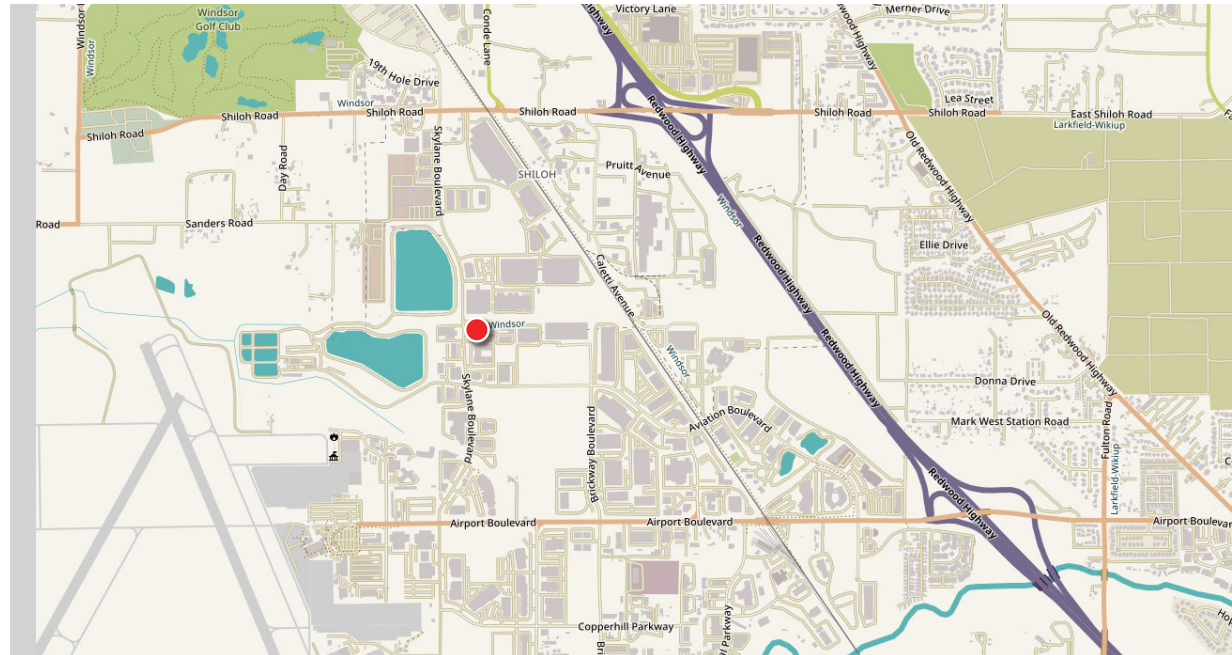

DESCRIPTION OF AREA

This property is located in the Airport Business Center which is ideally located in the heart of Sonoma County, one of California's 10 fastest growing counties. The Sonoma County Airport is blocks from 5570 Skylane Boulevard and now has convenient, direct flights to Los Angeles, Las Vegas, Portland and Seattle.

The Airport Business Center is located approximately three miles northwest of the City of Santa Rosa, west of U.S. Highway 101, the major north/ south freeway through Sonoma County. The Center is within the Sonoma County Airport Industrial Area Specific Plan, which will ultimately accommodate 603 acres of industrial development (412 acres of industrial park and 191 acres of heavy industrial) five acres of retail commercial and 140 acres of agricultural and open space. Approximately 220 acres are presently divided into industrial parks.

PRESENTED BY:

**BRIAN KEEGAN, PARTNER
KEEGAN & COPPIN CO., INC.
LIC # 01809537 (707) 528-1400, EXT. 249
BKEEGAN@KEEGANCOPPIN.COM**

**SHAWN JOHNSON, MANAGING PARTNER/SIOR
KEEGAN & COPPIN CO., INC.
LIC # 00835502 (707) 528-1400, EXT. 238
SJOHNSON@KEEGANCOPPIN.COM**



CURRENT FLOOR PLAN (SINGLE TENANT)



5570 SKYLANE BOULEVARD
SANTA ROSA, CA

**OFFICE BUILDING
WITH WAREHOUSE
FOR SALE OR LEASE**

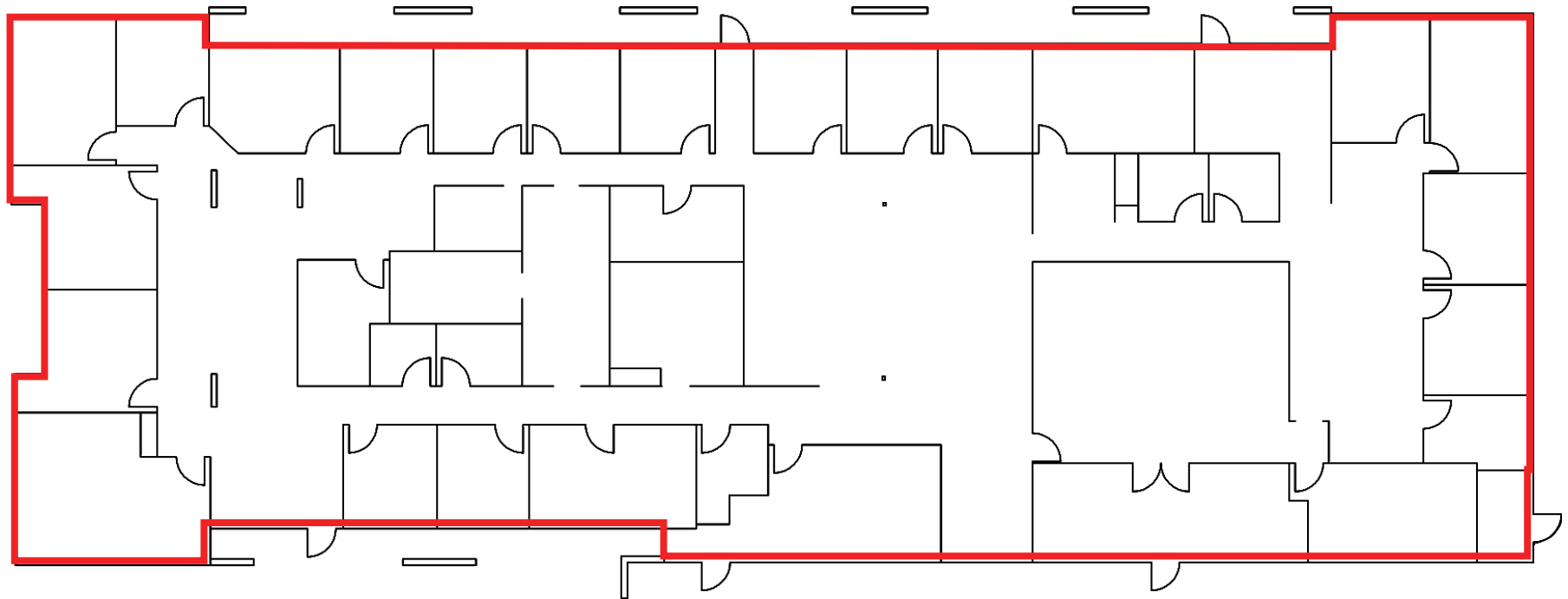

TOTAL SF: 9,544 SQFT AVAILABLE
SUITES AVAILABLE INDIVIDUALLY OR ALL TOGETHER

PRESENTED BY:

BRIAN KEEGAN, PARTNER
KEEGAN & COPPIN CO., INC.
LIC # 01809537 (707) 528-1400, EXT. 249
BKEEGAN@KEEGANCOPPIN.COM

SHAWN JOHNSON, MANAGING PARTNER/SIOR
KEEGAN & COPPIN CO., INC.
LIC # 00835502 (707) 528-1400, EXT. 238
SJOHNSON@KEEGANCOPPIN.COM



FLOOR PLAN

(MULTI-TENANT OPTION)



5570 SKYLANE BOULEVARD
SANTA ROSA, CA

**OFFICE BUILDING
WITH WAREHOUSE
FOR SALE OR LEASE**

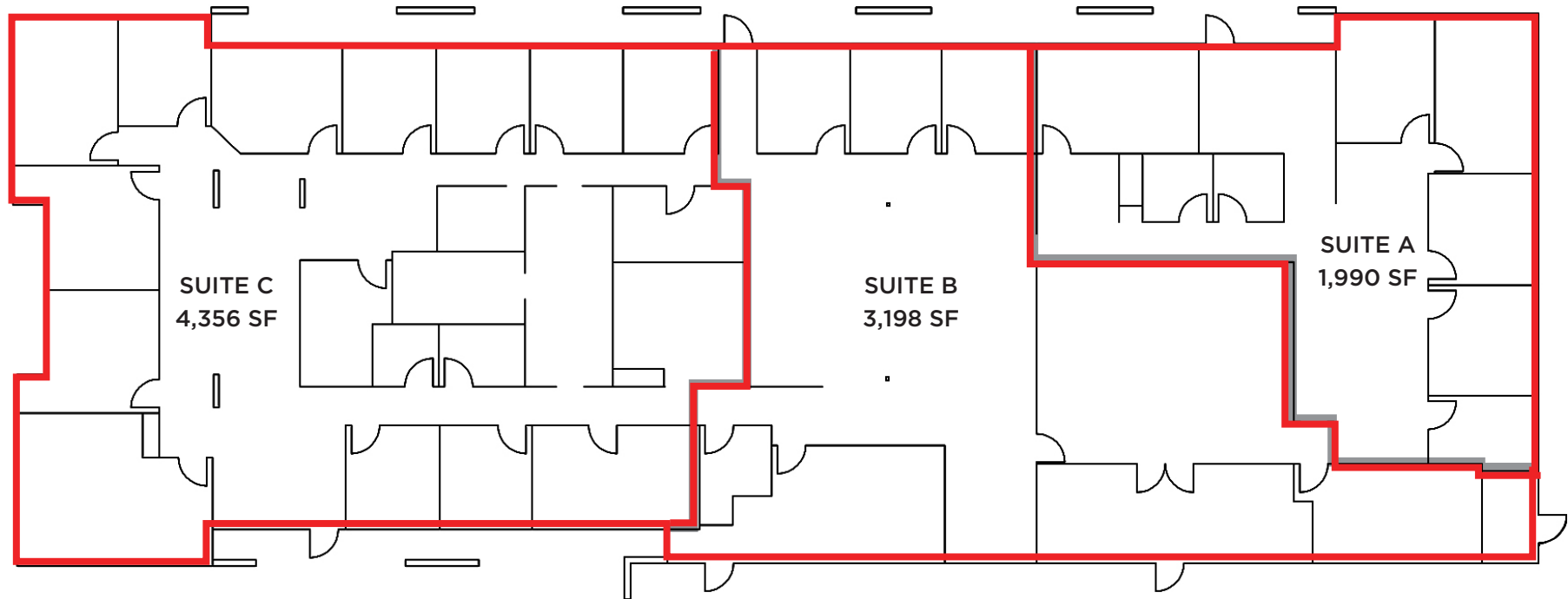

TOTAL SF: 9,544 SQFT AVAILABLE
SUITES AVAILABLE INDIVIDUALLY OR ALL TOGETHER

PRESENTED BY:

BRIAN KEEGAN, PARTNER
KEEGAN & COPPIN CO., INC.
LIC # 01809537 (707) 528-1400, EXT. 249
BKEEGAN@KEEGANCOPPIN.COM

SHAWN JOHNSON, MANAGING PARTNER/SIOR
KEEGAN & COPPIN CO., INC.
LIC # 00835502 (707) 528-1400, EXT. 238
SJOHNSON@KEEGANCOPPIN.COM



PROPERTY PHOTOS



5570 SKYLANE BOULEVARD
SANTA ROSA, CA

**OFFICE BUILDING
WITH WAREHOUSE
FOR SALE OR LEASE**



PRESENTED BY:

**BRIAN KEEGAN, PARTNER
KEEGAN & COPPIN CO., INC.
LIC # 01809537 (707) 528-1400, EXT. 249
BKEEGAN@KEEGANCOPPIN.COM**

**SHAWN JOHNSON, MANAGING PARTNER/SIOR
KEEGAN & COPPIN CO., INC.
LIC # 00835502 (707) 528-1400, EXT. 238
SJOHNSON@KEEGANCOPPIN.COM**



PROPERTY PHOTOS



5570 SKYLANE BOULEVARD
SANTA ROSA, CA

**OFFICE BUILDING
WITH WAREHOUSE
FOR SALE OR LEASE**



PRESENTED BY:

**BRIAN KEEGAN, PARTNER
KEEGAN & COPPIN CO., INC.
LIC # 01809537 (707) 528-1400, EXT. 249
BKEEGAN@KEEGANCOPPIN.COM**

**SHAWN JOHNSON, MANAGING PARTNER/SIOR
KEEGAN & COPPIN CO., INC.
LIC # 00835502 (707) 528-1400, EXT. 238
SJOHNSON@KEEGANCOPPIN.COM**



PROPERTY PHOTOS



5570 SKYLANE BOULEVARD
SANTA ROSA, CA

**OFFICE BUILDING
WITH WAREHOUSE
FOR SALE OR LEASE**



PRESENTED BY:

**BRIAN KEEGAN, PARTNER
KEEGAN & COPPIN CO., INC.
LIC # 01809537 (707) 528-1400, EXT. 249
BKEEGAN@KEEGANCOPPIN.COM**

**SHAWN JOHNSON, MANAGING PARTNER/SIOR
KEEGAN & COPPIN CO., INC.
LIC # 00835502 (707) 528-1400, EXT. 238
SJOHNSON@KEEGANCOPPIN.COM**



LOCATION MAP



5570 SKYLANE BOULEVARD
SANTA ROSA, CA

**OFFICE BUILDING
WITH WAREHOUSE
FOR SALE OR LEASE**



PRESENTED BY:

BRIAN KEEGAN, PARTNER
KEEGAN & COPPIN CO., INC.
LIC # 01809537 (707) 528-1400, EXT. 249
BKEEGAN@KEEGANCOPPIN.COM

SHAWN JOHNSON, MANAGING PARTNER/SIOR
KEEGAN & COPPIN CO., INC.
LIC # 00835502 (707) 528-1400, EXT. 238
SJOHNSON@KEEGANCOPPIN.COM



MARKET SUMMARY



5570 SKYLANE BOULEVARD
SANTA ROSA, CA

**OFFICE BUILDING
WITH WAREHOUSE
FOR SALE OR LEASE**



SANTA ROSA SUMMARY

Santa Rosa, California is the county seat of Sonoma County. It is the largest city in the North Bay Area and all of California's Wine Country. The city of Santa Rosa is the North Bay's premier location and as a business and service hub, Santa Rosa is the economic engine that drives the region.

As the largest city between Portland and San Francisco, Santa Rosa serves a four county region as the hub for technology and entrepreneurial businesses, retail, banking and employment. Santa Rosa has a dynamic and well-balanced economy, anchored by strengths in tourism, high-tech manufacturing and retail. Residents enjoy a superb quality of life while employers benefit from a skilled workforce. Santa Rosans have a deep appreciation for the arts, education, conscientious business development and quality living.

The city of Santa Rosa offers a one-stop permitting process, easy access to Economic Development program staff and Community Development staff, collaborative partnerships with key business players; from our local chambers of commerce, the higher education institutes, brokers, benchmark industries, and community organizations to a global venture community, just to name a few.

The city of Santa Rosa is conveniently located just 55 miles north of San Francisco via the Golden Gate Bridge. Santa Rosa is a main shopping hub for the

surrounding neighborhoods near and along the 101 corridor, such as Petaluma, Rohnert Park, Windsor, Sonoma, Healdsburg, and Sebastopol. Santa Rosa has several prominent shopping districts, including Downtown, Santa Rosa Avenue, and Montgomery Village, offering a variety of general retail, boutique shops, dining, and entertainment. There are two regional shopping malls, Coddington Mall and Santa Rosa Plaza.

Home to approx. 500,000 people, Sonoma County is a prime location for tourism as well as residence. Just a short drive from the San Francisco Bay Area, there are nine incorporated cities in the county, in addition to seventeen unincorporated areas. The city of Santa Rosa is the most populous area, home to approximately one-third of the county's population and was recently named as one of the nation's "most livable communities" by Partners for Livable Communities.

Sonoma County's unemployment rate is one of the lowest in California and the county continues to show long-term job growth in the health care, hospitality and business service sectors. For the leisure, hospitality, educational and health services, which includes trade schools, social workers and health care professionals, has seen employment growth improve on a year-over-year basis. And business and professional services jobs have increased from a year earlier. In addition, new housing continues to increase throughout the county, while job growth and taxable sales also continue to rise.

PRESENTED BY:

**BRIAN KEEGAN, PARTNER
KEEGAN & COPPIN CO., INC.
LIC # 01809537 (707) 528-1400, EXT. 249
BKEEGAN@KEEGANCOPPIN.COM**

**SHAWN JOHNSON, MANAGING PARTNER/SIOR
KEEGAN & COPPIN CO., INC.
LIC # 00835502 (707) 528-1400, EXT. 238
SJOHNSON@KEEGANCOPPIN.COM**



ABOUT KEEGAN & COPPIN



5570 SKYLANE BOULEVARD
SANTA ROSA, CA

**OFFICE BUILDING
WITH WAREHOUSE
FOR SALE OR LEASE**



Your partner in commercial real estate in the North Bay & beyond since 1976.

Keegan & Coppin Company, Inc. has served our communities in the North Bay for well over 40 years. But our unmatched local experience is only part of what makes us the area's most trusted name in commercial real estate. At Keegan & Coppin, we bring together a range of services that go beyond traditional brokerage. That depth of knowledge and diverse skillset allows us to clarify and streamline all aspects of your transaction, giving you the confidence of knowing that we can help with anything that comes up through all phases of a project.

Keegan & Coppin Company, Inc.

The above information, while not guaranteed, has been secured from sources we believe to be reliable. Submitted subject to error, change or withdrawal. An interested party should verify the status of the property and the information herein.



DISCLAIMER



5570 SKYLANE BOULEVARD
SANTA ROSA, CA

**OFFICE BUILDING
WITH WAREHOUSE
FOR SALE OR LEASE**

DISCLAIMER

This property is being offered on an as-is basis. While the Broker believes the information in this brochure to be accurate, no warranty or representation is made as to its accuracy or completeness. Interested parties should conduct independent investigations and reach conclusions without reliance on materials contained in this brochure.

This property owner requests that you do not disturb the Tenants, as the property will only be shown in coordination with the Listing Agent.

This brochure is presented under the terms and conditions of the Confidentiality Agreement. As such, the material contained in this brochure is confidential and is provided solely for the purpose of considering the purchase of the property described herein. Offers should be presented to the agent for the property owner. Prospective buyers are encouraged to provide buyer's background, source of funds and any other information that would indicate their ability to complete the transaction smoothly.

Keegan & Coppin Co., Inc.
1355 N Dutton Ave.
Santa Rosa, CA 95401
www.keegancoppin.com
(707) 528-1400

The above information, while not guaranteed, has been secured from sources we believe to be reliable. Submitted subject to error, change or withdrawal. An interested party should verify the status of the property and the information herein.

REPRESENTED BY:

BRIAN KEEGAN
PARTNER

LIC # 01809537 (707) 528-1400, EXT. 249

BKEEGAN@KEEGANCOPPIN.COM

SHAWN JOHNSON
MANAGING PARTNER/SIOR

LIC # 00835502 (707) 528-1400, EXT. 238

SJOHNSON@KEEGANCOPPIN.COM