

**WAREHOUSE SPACE FOR LEASE**



# 18,749 SF - 47,981 SF HIGH BAY WAREHOUSE

4 Energy Way, West Warwick, RI 02893

**GEORGE PASKALIS, SIOR**

Partner  
401.751.3200 x3303  
george@mgcommercial.com

**JULIE FRESHMAN, SIOR**

Vice President  
401.751.3200 x3309  
julie@mgcommercial.com

**MG COMMERCIAL**

365 Eddy Street, Penthouse Suite  
Providence, RI 02903  
401.751.3200 | mgcommercial.com

# PROPERTY SUMMARY

WAREHOUSE SPACE FOR LEASE

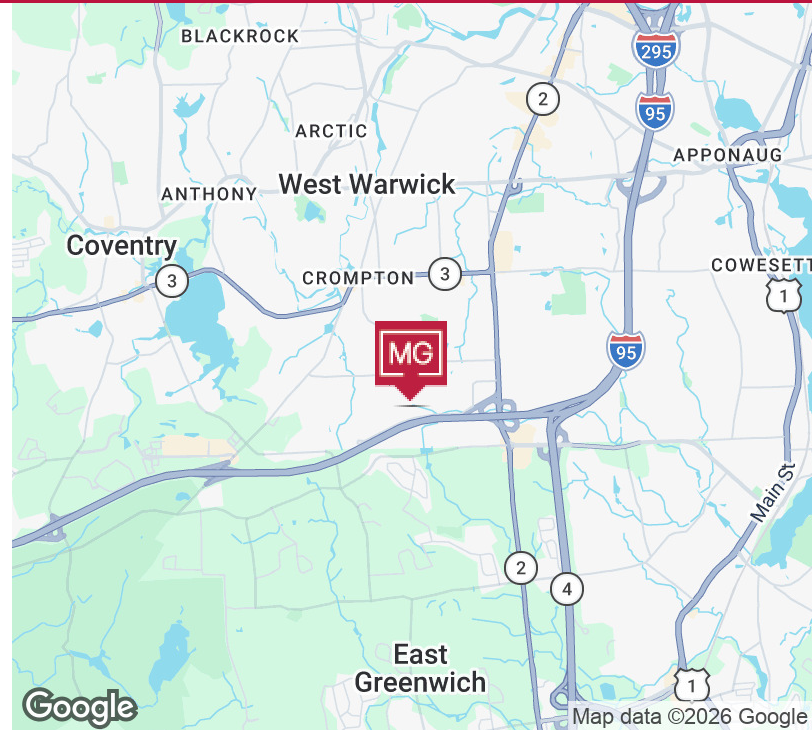

## PROPERTY DESCRIPTION

The subject building consists of 82,000 square feet +/- of total space, including approximately 8,000 square feet of highly functional mezzanine space and is situated on approximately 7.5 acres of land. The building is subdivided into 4 units, each with its own separate meters. The subject space comes with ample truck circulation and offers multiple docks.

## PROPERTY HIGHLIGHTS

- 18,749 SF - 47,981 SF High Bay Warehouse Space
- 14 Loading Docks
- 29' Clear Ceiling Height
- Close to I-95 On/Off Ramps at Exit 24

## LOCATION DESCRIPTION

Well located in the West Warwick Business Park, with convenient truck access in and out of the park on James P Murphy Highway and easily accessible to I-95 at Exit 24. The industrial park is well established and includes two hotels immediately within the business park. T.F. Green Airport is 8.5 miles away and Downtown Providence is 30 minutes away.

## OFFERING SUMMARY

Lease Rate:	\$7.95 SF/yr (NNN)
Available SF:	18,749 - 47,981 SF
Lot Size:	7.8 Acres
Building Size:	82,000 SF +/-

GEORGE PASKALIS, SIOR  
Partner  
401.751.3200 x3303  
george@mgcommercial.com

JULIE FRESHMAN, SIOR  
Vice President  
401.751.3200 x3309  
julie@mgcommercial.com

365 Eddy Street, Penthouse Suite  
Providence, RI 02903  
mgcommercial.com



# BUILDING/SPACE SPECIFICATIONS

WAREHOUSE SPACE FOR LEASE

## BUILDING/SPACE INFORMATION

Total Building Size:	82,000 SF +/-	Ceiling Height:	29' Clear
Available Space:	18,749 SF - 47,981 SF	Column Spacing:	50' x 30'
Warehouse:	18,749 SF - 42,012 SF	Loading Docks:	14
Mezzanine:	4,800 SF	Fire Safety System:	Dry Sprinkler System
1st Floor Office:	519 SF	Roof:	Rubber Membrane
2nd Floor Office:	650 SF	Lighting:	Motion Sensors
Land Area:	7.8 Acres	Floor:	Concrete
Construction:	Insulated Metal & Steel	Zoning:	BP (Business Park)



**GEORGE PASKALIS, SIOR**  
Partner  
401.751.3200 x3303  
george@mgcommercial.com

**JULIE FRESHMAN, SIOR**  
Vice President  
401.751.3200 x3309  
julie@mgcommercial.com

-----  
365 Eddy Street, Penthouse Suite  
Providence, RI 02903  
mgcommercial.com



# FLOOR PLAN

**WAREHOUSE SPACE FOR LEASE**

**4 Energy Way - Floor Plan -  
Liberty Moving Premises**

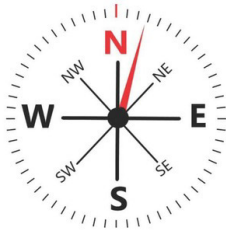

**TOTAL SF = 47,981**  
**CLEAR HEIGHT = 29'**  
**LOADING DOCKS = 14**

Warehouse Area (1) = 6,100 sf  
 Warehouse Area (2) = 12,649 sf  
 Warehouse Area (3) = 7,039 sf  
 Warehouse Area (4) = 16,224 sf  
**TOTAL Warehouse = 42,012 sf**

Mezzanine = 4,800 sf  
 Office 1st Floor = 519 sf  
 Office 2nd Floor = 650 sf

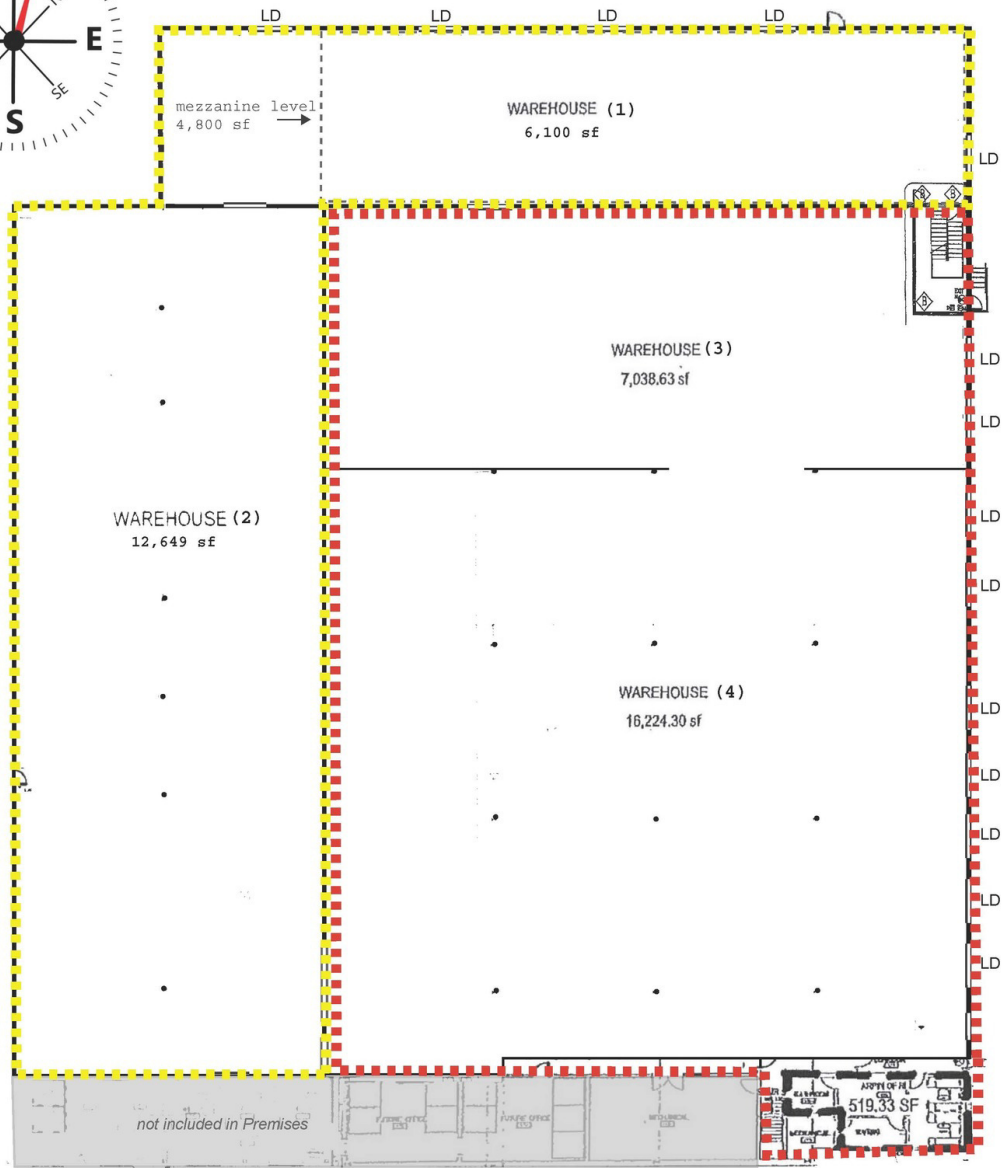

27

South East corner of building

**GEORGE PASKALIS, SIOR**  
 Partner  
 401.751.3200 x3303  
 george@mgcommercial.com

**JULIE FRESHMAN, SIOR**  
 Vice President  
 401.751.3200 x3309  
 julie@mgcommercial.com

365 Eddy Street, Penthouse Suite  
 Providence, RI 02903  
 mgcommercial.com

