

# CYPRESS CORPORATE PLAZA



Suite: 165

Date Available NOW

Lease Rate (FSG) \$2.25

Size (RSF) 2,532 Rentable Square Feet

Description: Waiting Area, Cafeteria Style  
Kitchen and Presentation  
Room/Conference Center

**NAI Capital**  
COMMERCIAL REAL ESTATE SERVICES, WORLDWIDE

**NAI Capital Commercial**  
1920 Main St., Suite #100  
Irvine, CA 92614 949-854-6600  
naicapital.com

**10805 Holder Street**  
Cypress, CA 90630

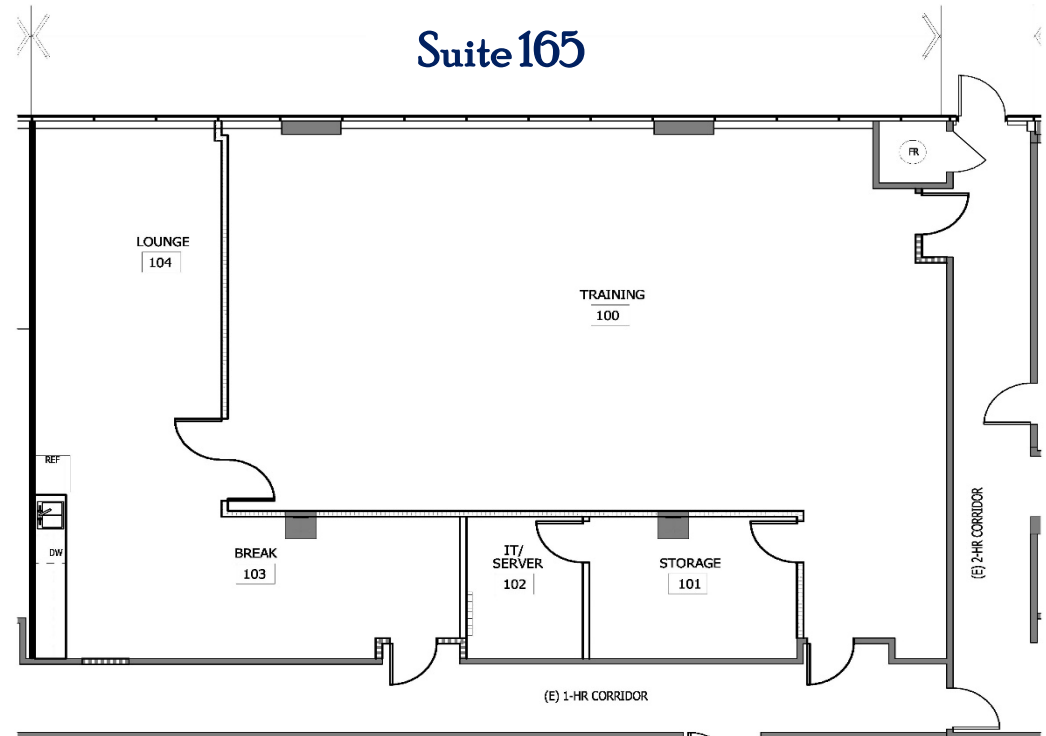

For more information, please contact:

**Steve Ehrich**  
Senior Vice President  
Orange County Office  
949.468.2328  
sehricht@naicapital.com  
Cal DRE Lic #01092019

**John Bosko**  
Executive Vice President  
Orange County Office  
949.468.2323  
Johnbosko@naicapital.com  
Cal DRE Lic #00967775

No warranty, express or implied, is made as to the accuracy of the information contained herein. This information is submitted subject to errors, omissions, change of price, rental or other conditions, withdrawal without notice, and is subject to any special listing conditions imposed by our principals. Cooperating brokers, buyers, tenants and other parties who receive this document should not rely on it, but should use it as a starting point of analysis, and should independently confirm the accuracy of the information contained herein through a due diligence review of the books, records, files and documents that constitute reliable sources of the information described herein. Logos are for identification purposes only and may be trademarks of their respective companies. NAI Capital, Inc. Cal DRE Lic. #02130474.